

The limited warranty set forth below is given by Precision Products, Incorporated with respect to new merchandise purchased and used in the United States, its possessions and territories.

Precision Products, Incorporated warrants the product (s) listed against defects in material and workmanship, and will at our option, repair or replace, free of charge, any part found to be defective in materials or workmanship. This limited warranty shall only apply if this product has been assembled, operated, and maintained in accordance with the owner's manual furnished with the product, and has not been subject to misuse, abuse, neglect, accident, improper maintenance, alteration, vandalism, theft, fire, water, or damage because of other peril or natural disaster.

Normal wear parts or components thereof are subject to separate terms as follows: All normal wear parts or component failures will be covered on the product for a period of one year. Parts found to be defective within the warranty period will be replaced at our expense. Our obligation under this warranty is expressly limited to the replacement or repair, at our option, of parts found to be defective in material and workmanship.

Contacting Service

Warranty parts replacements are available, only with **Proof of Purchase**, through our Customer Service Department. Call **1 (800) 225-5891**

This limited warranty does not provide coverage in the following cases:

1. Routine maintenance items such as lubricants and filters.
2. Normal deterioration of the exterior finish due to use or exposure.
3. Transportation and/or labor charges.

No implied warranty, including any implied warranty of merchantability of fitness for a particular purpose, applies after the applicable period of expressed written warranty above as to the part as identified below. No other expressed warranty whether written or oral, except as mentioned above, given by any person or entity, including a dealer or retailer, with respect to any product, shall bind Precision Products, Inc. During the period of the warranty, the exclusive remedy is repair or replacement of the product as set forth above.

The provisions as set forth in this warranty provide the sole and exclusive remedy arising from the sale.

Precision Products, Inc. will not be liable for incidental or consequential loss or damage including, without limitation, expenses incurred for substitute or replacement lawn care services or for rental expenses to temporarily replace a warranted product.

Some states do not allow the exclusion or limitation of incidental or consequential damages, or limitations on how long an implied warranty lasts, so the above exclusions or limitations may not apply to you.

During the warranty period, the exclusive remedy is replacement of the part. In no event shall recovery of any kind be greater than the amount of the purchase price of the product sold. Alteration of safety features of the product shall void this warranty. You assume the risk and liability for loss, damage, or injury to you and your property and/or to others and their property arising out of the misuse or inability to use this product.

This limited warranty shall not extend to anyone other than the original purchaser or to the person for whom it was purchased as a gift.

Local Law to this Warranty

This limited warranty gives you specific legal rights, and you may also have other rights which vary from state to state.

Warranty Period

The Warranty period stated below begins with the **Proof of Purchase**. Without the proof of purchase, the Warranty period begins from the date of manufacture.

Barn Cart Warranty Period

The warranty period for this unit is as follows: All part are covered for one year from date of sale.

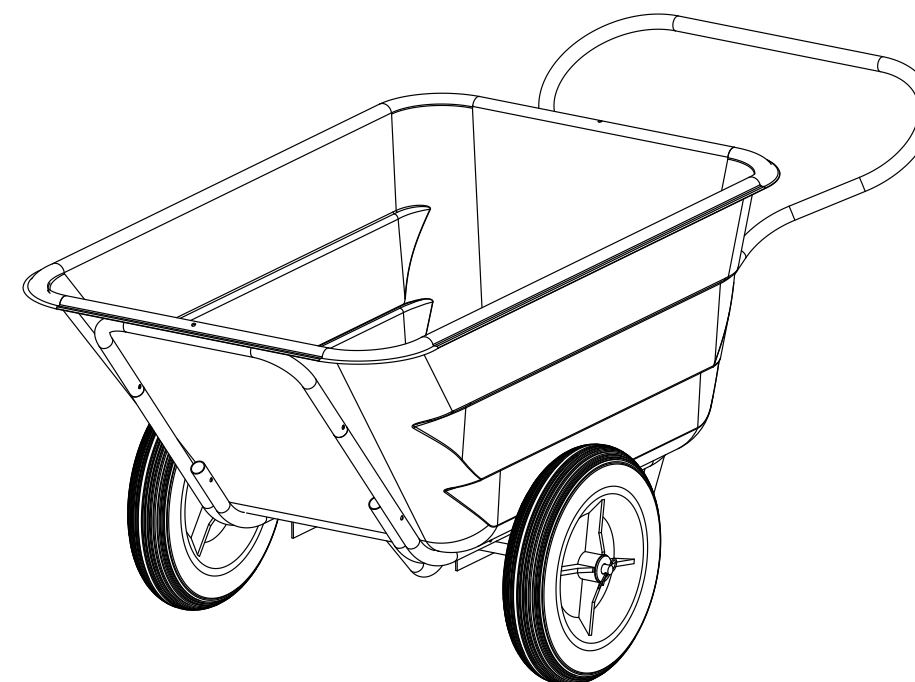

Tread pattern on tires may vary.

Manual Contents

Safety Instructions	2
Parts	3
Assembly	4-6
Operation	6
Maintenance	6
Warranty	8

Your New Barn Cart

Congratulations on your purchase of a new Precision Products, Inc. Barn Cart. Your Barn Cart has been engineered and built to give you the most dependable and best performing product possible.

If you experience any problem you can not easily resolve, please feel free to contact our knowledgeable and helpful customer service department toll-free at **1 (800) 225-5891**.

Caution: Carefully read all rules and instructions for safe operation.

! Rules for Safe Operation

The following safety precautions are suggested. This Trailer Dump Cart is designed, engineered and tested to offer reasonably safe and effective service, provided that it is operated in strict accordance with these instructions. Failure to do so may result in personal injury. Always observe the rules of safe operation. Please read and retain this manual.

- Do not allow anyone to ride or sit on Cart during operation.
- Be alert for holes in the terrain and other hazards. This could cause you to lose control of the cart and lawn tractor.
- Follow maintenance and lubrication instructions as outlined in this manual.
- Always wear substantial footwear. Do not wear loose fitting clothing that may get caught in moving parts.

Carton Contents

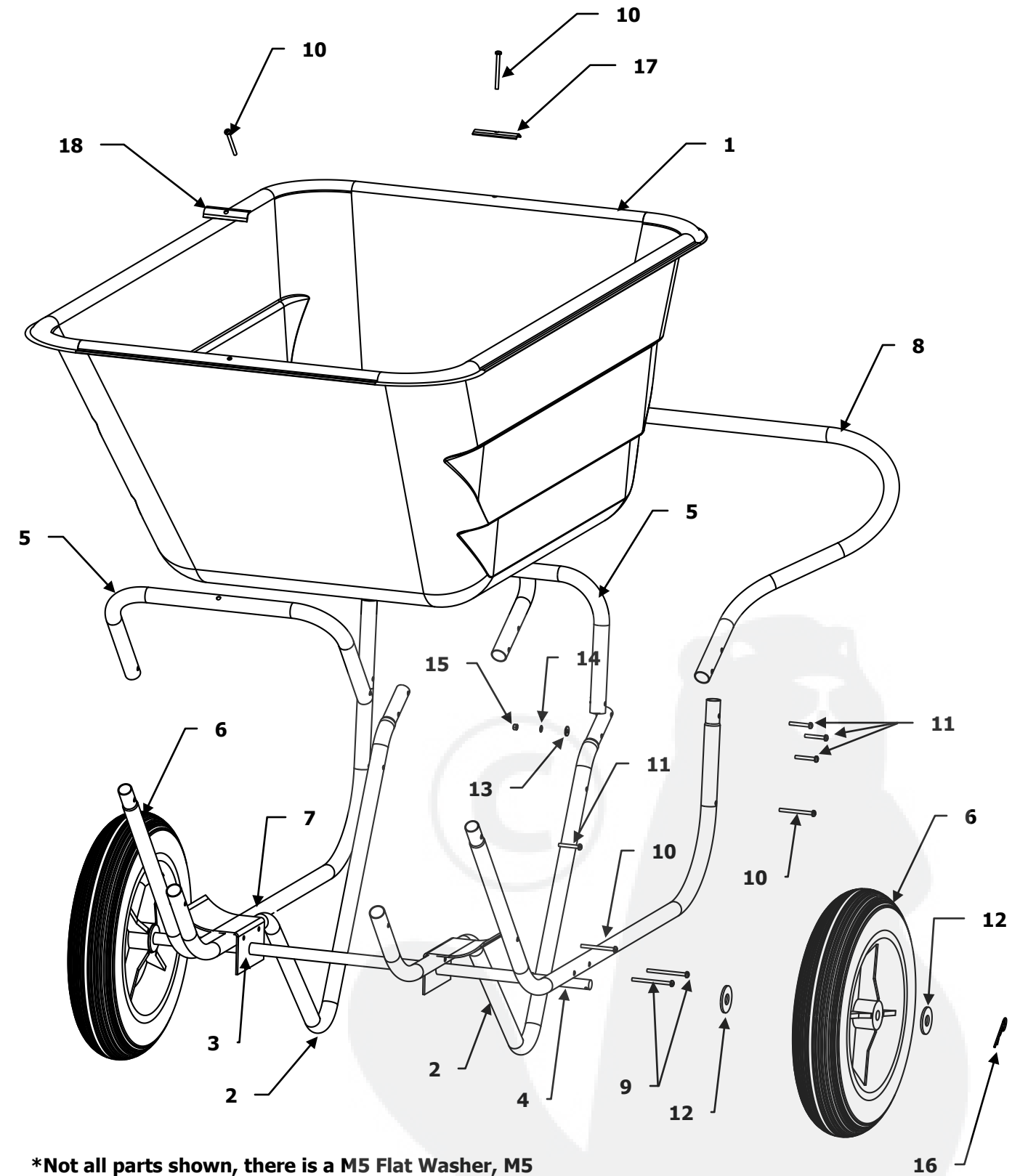
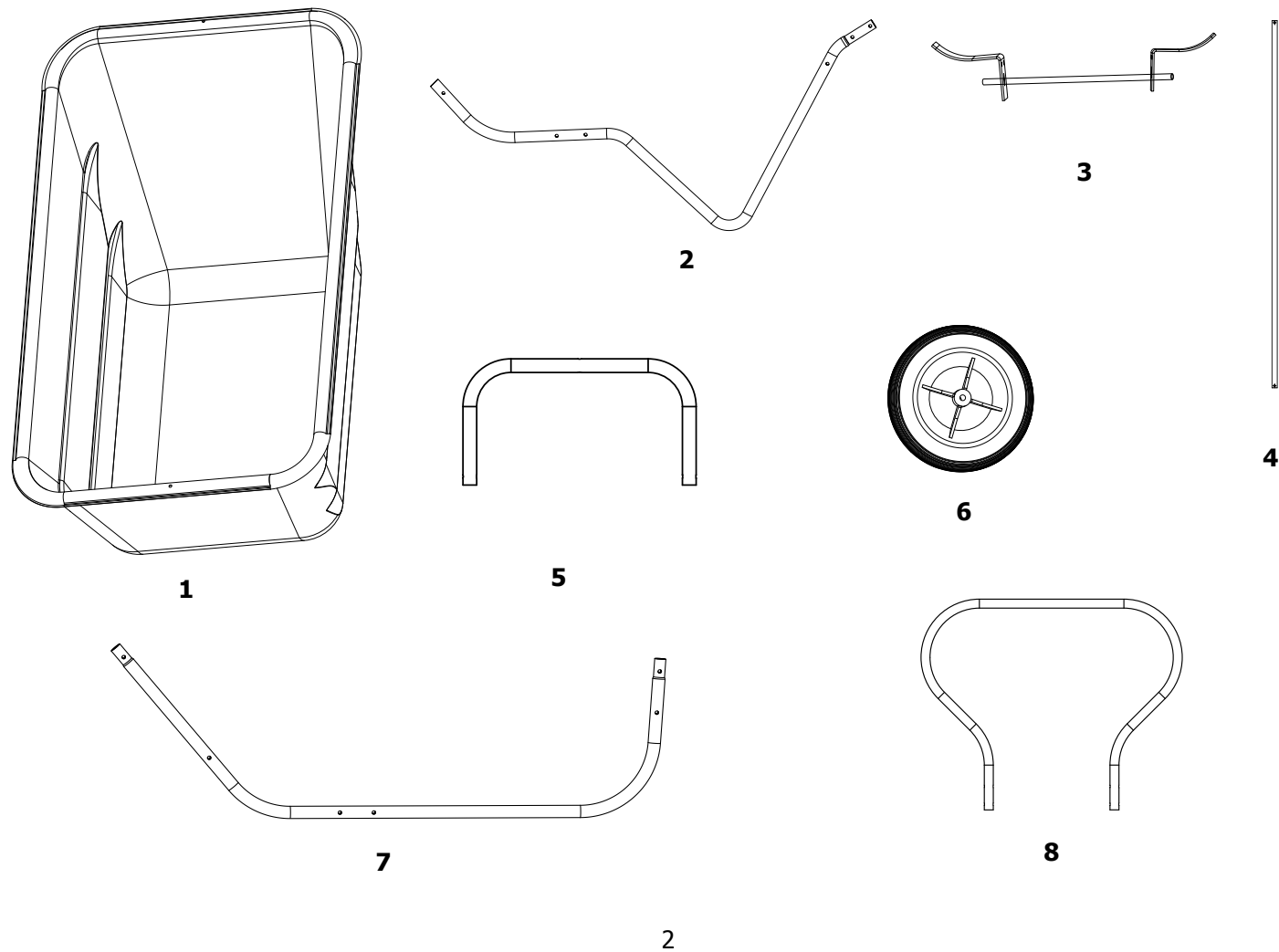

***Not all parts shown, there is a M5 Flat Washer, M5 Lock Washer and a M5 Hex Head Nut attached to each Slot Pan Bolt.**

Operation

1. Never carry passengers in this cart. It is designed for carrying materials only.
2. Be careful on any grade (hill) and stay off of steep grades.
3. Use caution when loading cart to avoid tipping.
4. Avoid large holes and ditches when transporting loads.

Maintenance Instructions

- Keeping the cart clean and dry will prolong the unit's life.
- Lubricate Wheels at regular intervals, at least once every six months, more frequently if used regularly.
- Should rust develop, sand lightly.

Parts and Support

STOP *Please do not return this product to the store prior to contacting Precision.*

At Precision Products, Inc. our goal is to deliver quality, value and outstanding service. If for any reason our product does not meet your expectations, please contact us and we will take care of any problem you may have with this unit.

When ordering replacement parts please have the model number, part description, part number, inspector number and date on carton, available so that we can best serve you.

1 (800) 225-5891

www.precisionprodinc.com

**Precision Products Inc.
316 Limit St.
Lincoln IL 62656**

Ref No.	Part No.	Qty.	Description
1	40026	1	Body
2	40028	2	Leg Support Tube
3	40032	1	Axle Support
4	40031	1	Axle
5	40029	2	U-Brace Tube
6	40033	2	Wheel
7	40027	2	Tube Base
8	40030	1	Tube, Handle with grip
9	40037	4	Slot Pan Bolt M5x68
10	40038	6	Slot Pan Bolt M5x58
11	40039	8	Slot Pan Bolt M5x34
12	R19212016	4	Washer
13	40040	18	Flat Washer M5
14	40041	18	Lock Washer M5
15	40042	18	Hex Head Nut M5
16	43343	2	Hitch Pin Clip
17	40036	1	Rear Clamp (Narrow)
18	40035	1	Front Clamp (Wide)

Shown Full Size

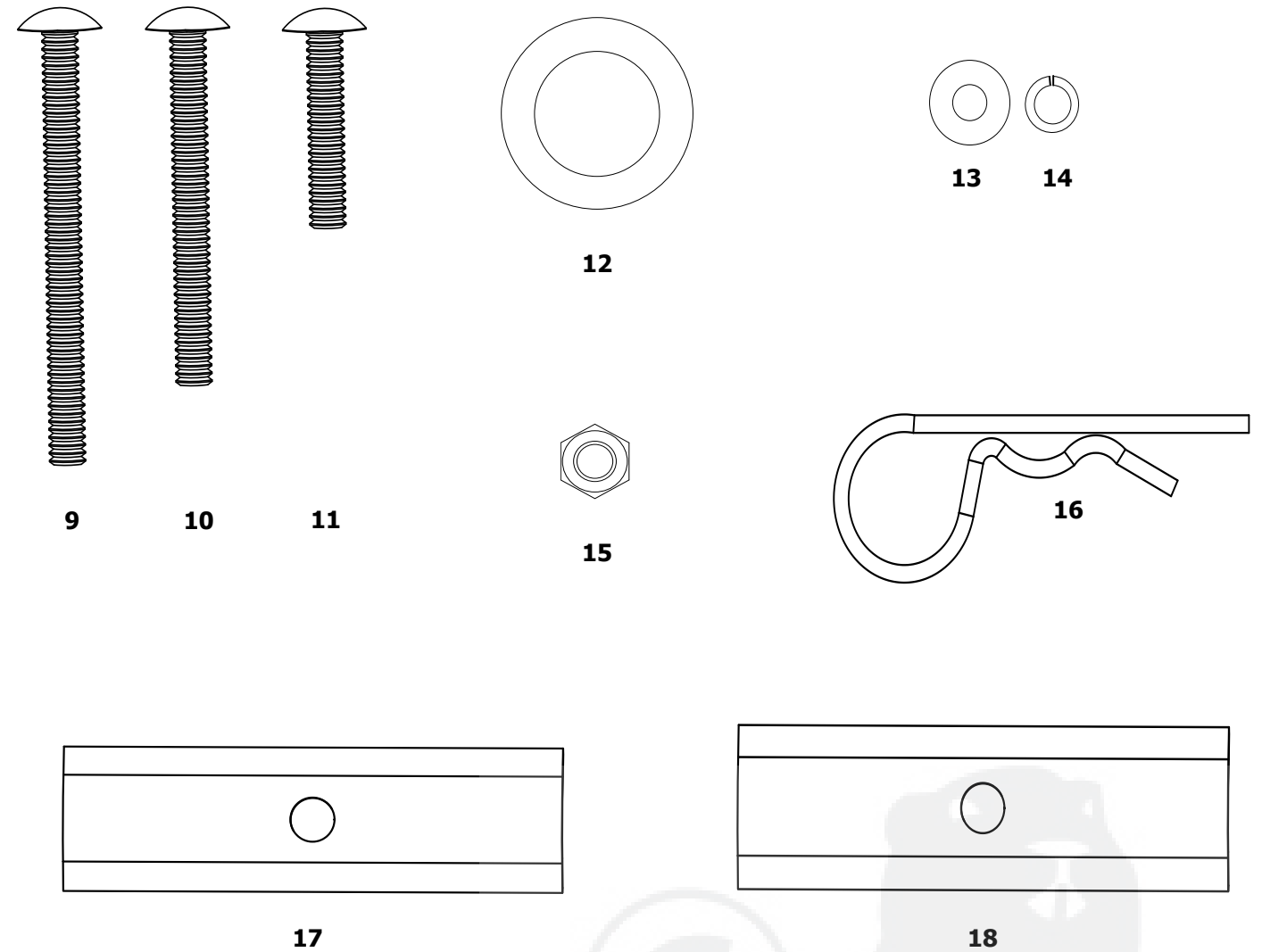

Ref.	Qty.	Description
1	1	Body
2	2	Tube, Leg Support
3	1	Axle Support
4	1	Axle
5	2	Tube, U Brace
6	2	Wheel
7	2	Tube Base
8	1	Tube, Hand w/grip
9	4	Bolt, Slot Pan M5x68
10	6	Bolt, Slot Pan M5x58
11	8	Bolt, Slot Pan M5x34
12	4	Large Washer
13	18	Washer, Flat M5
14	18	Washer, Lock M5
15	18	Nut, Hex Head M5
16	2	Hitch Pin Clip
17	1	Clamp, Rear (Narrow)
18	1	Clamp, Front (wide)

Assembly Instructions

Tools Needed For Cart Assembly

- (1) Screwdriver
- (1) M10 Wrench or Adjustable Wrench

Remove from Carton

Remove all parts and hardware packages from the carton. Lay out all parts and hardware and identify them using the illustrations pages 2 and 3.

1. Attach one Leg Support Tube to a Base Tube using two M5x58 Slot Pan Bolts (10), one M5 Flat Washer, one M5 Lock Nut. Do not use middle holes. See Figure 1.
2. Repeat first step, assembling second Leg Support Tube to opposite side of second Base Tube. See Figure 1.

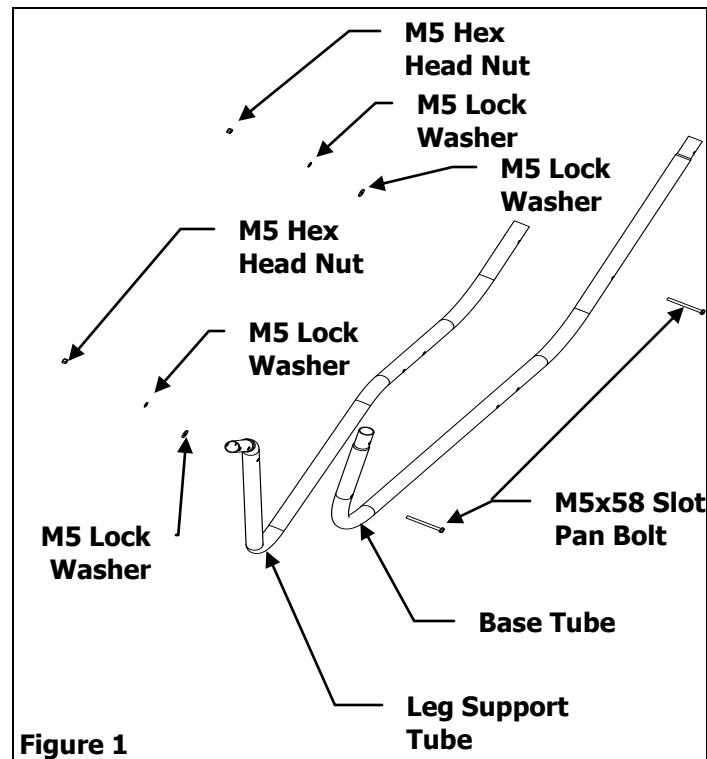

3. Attach assembled tubes and to each side of the Axle Support Assembly, with Leg Support Tubes on the outside. Use two M5x68 Bolts, M5 Flat Washer, M5 Lock Washer and secure with M5 Hex Head Nut. See Figure 2.

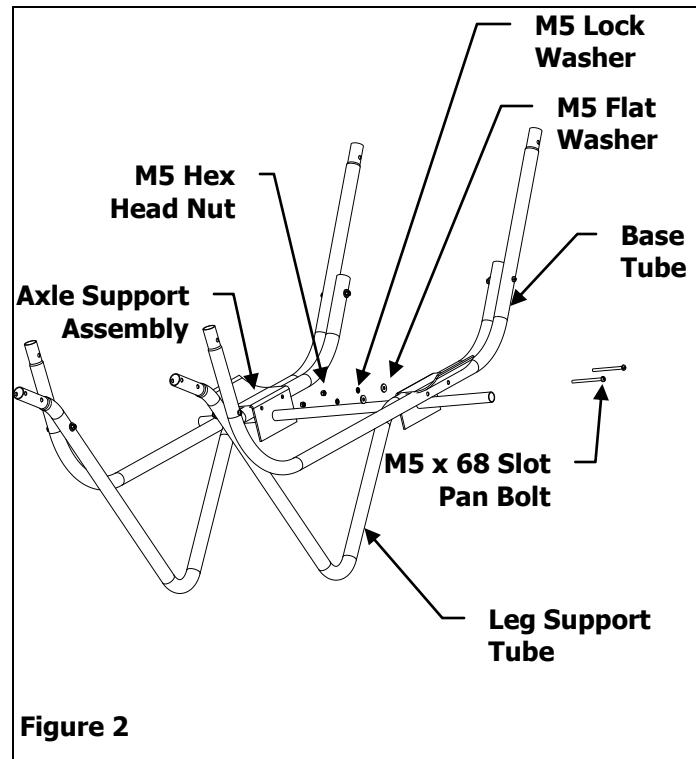

4. Attach a U-Brace Tube to each end of Base Tube using four M5x34 Slot Pan Bolts, M5 Flat Washer, M5 Lock Washer and secure with a M5 Hex Head Bolt. See Figure 3.

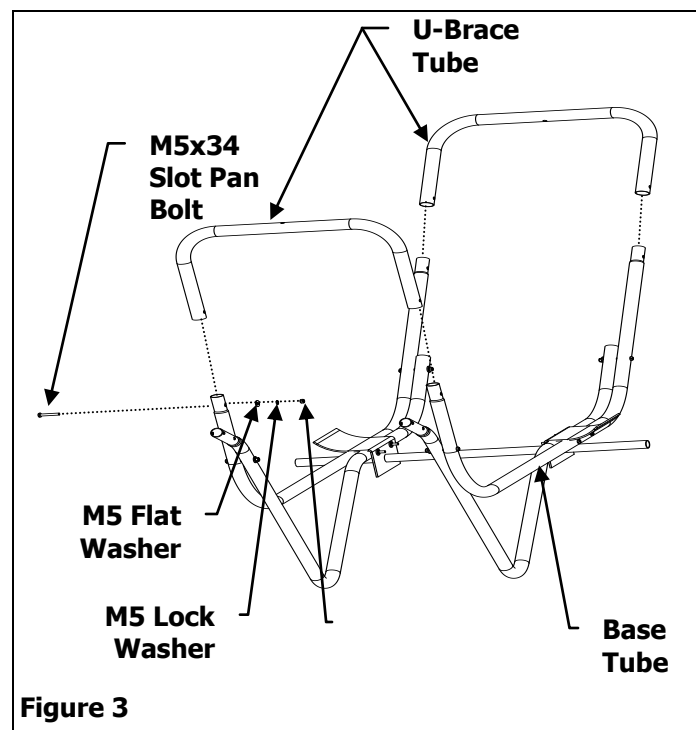

5. Attach Handle Tube to Leg Support Tube, using two M5x34 Slot Pan Bolt, M5 Flat Washer, M5 Lock Washer and secure with a M5 Hex Head Nut. See Figure 4.

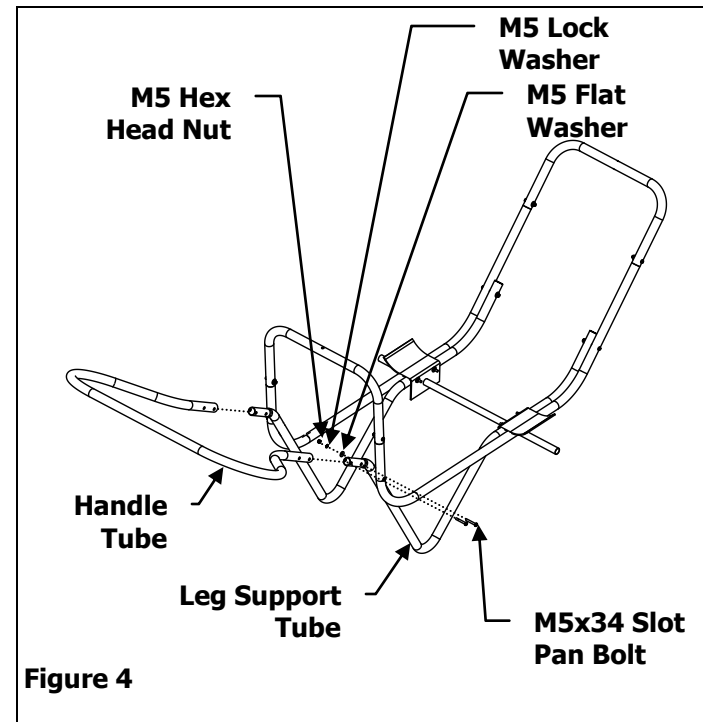

6. Attach Body to front U-Brace Tube using M5x58 Slot Pan Bolt, attach Wide Front Clamp, M5 Flat Washer, M5 Lock Washer and M5 Hex Head Bolt. Repeat for rear U-Brace Tube using Narrow Rear Clamp. Tighten nuts and bolts in Body. See Figure 5.
7. Tighten all other nuts and bolts.

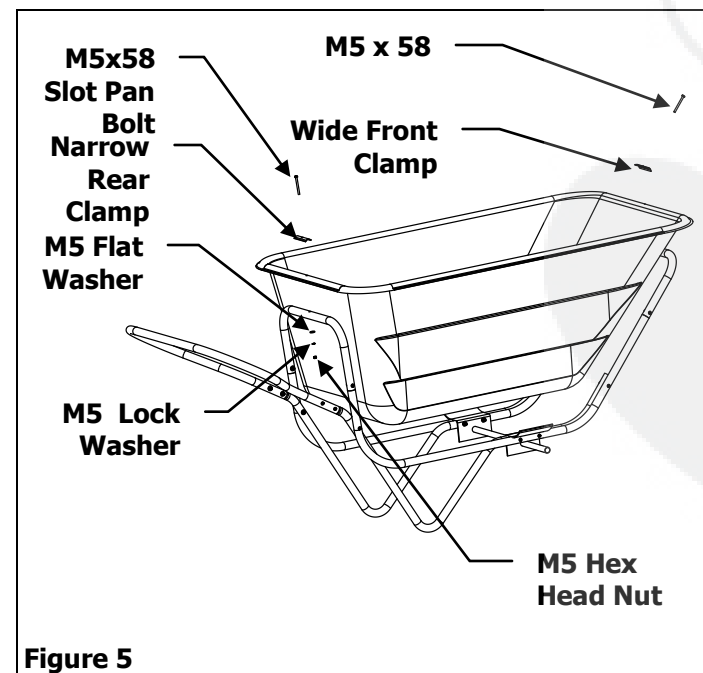

Figure 5

8. Slide Axle into Axle Support Assembly. See Figure 6.

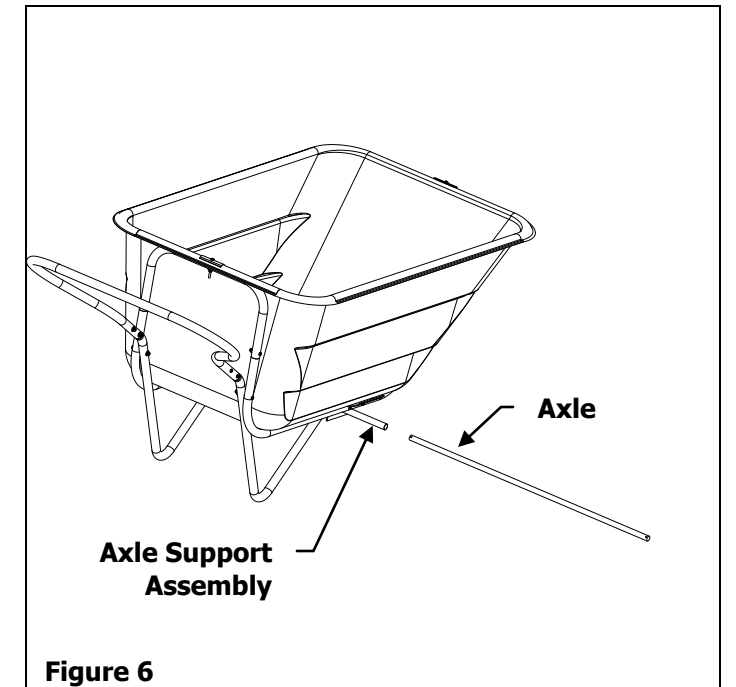

Figure 6

9. Place a Large Flat Washer onto Axle, then a Wheel and then another Flat Washer and secure with a Hitch Pin Clip. Repeat on other side. See Figure 7.

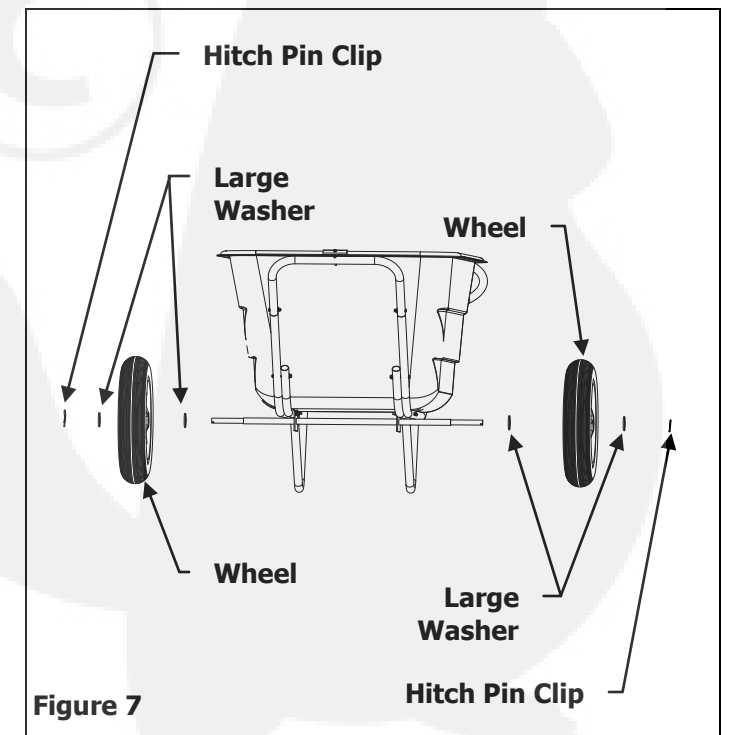

Figure 7