

**PA42 PARTS DRAWING**

OLD

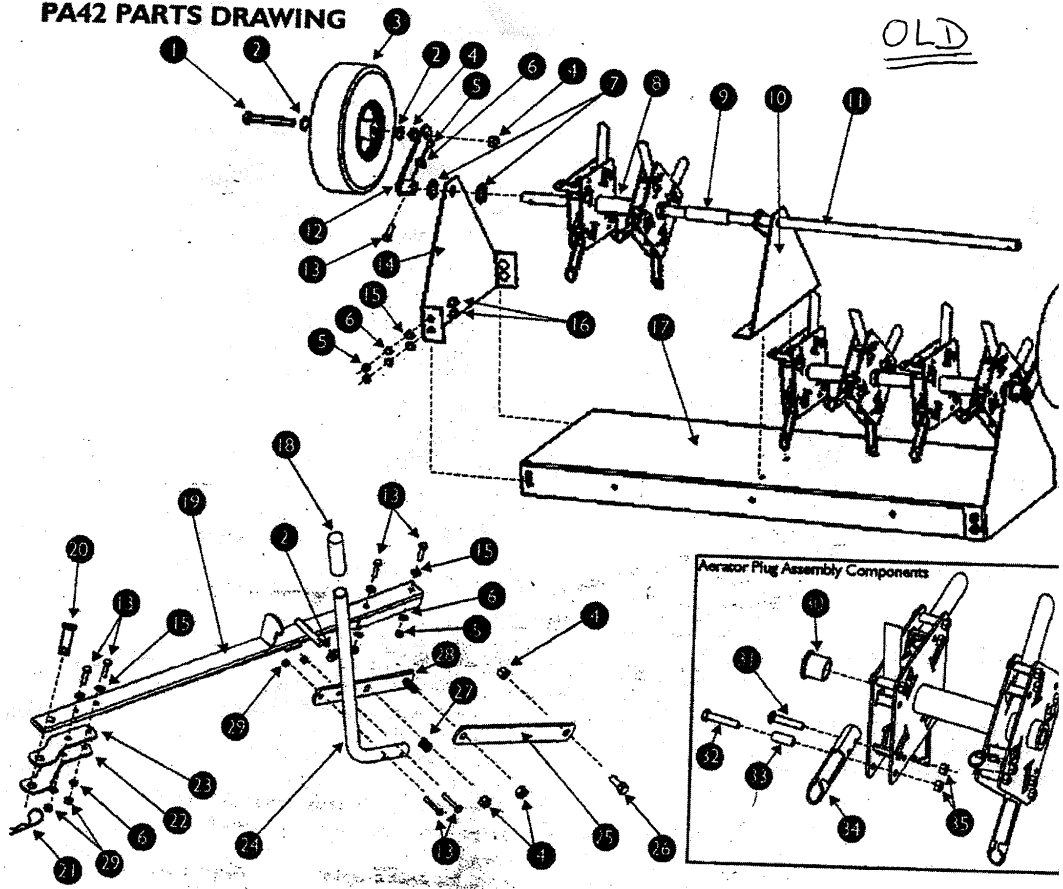

Ref. No.	Part No.	Part Description	Part Qty.	Ref. No.	Part No.	Part Description	Part Qty.
1	4280	1/2"-13 x 4" Hex Head Bolt	2	20	4279	Clevis Pin 5/8" x 3-1/2"	1
2	1506	1/2" Flat Washer	5	21	1042	#14 Hitch Ptn Clip	1
3	4223	Wheel 3.5 x 4-1/2"	2	22	4265	Clevis #1	1
4	1638	1/2" Reverse Lock Nut	7	23	4266	Clevis #2	1
5	1275	5/16" Hex Head Nut	12	24	4262B	Handle	1
6	1276	5/16" Lock Washer	16	25	4240B	Linkage Bar	1
7	1264	3/4" Flat Washer	4	26	4278	1/2"-13 x 1-1/4" Hex Head Bolt	1
8	4220	Aerator Plug Assembly	4	27	4272	Compression Spring	1
9	4283	1" x 3-7/8" Metal Spacer	2	28	4263B	Lever Link	1
10	4227X	Aerator Center Plate	1	29	1557	5/16" Reverse Lock Nut	4
11	4287	Axle Assembly	1	30	4232	Flange Bearing	8
12	4269	Wheel Bracket Assembly	2	31	1417	1/4" x 1-1/2" Carriage Bolt	32
13	4014	5/16" x 1-1/2" Hex Head Bolt	8	32	6129	1/4" x 1-1/2" Hex Head Bolt	32
14	4226X	Aerator End Plate	2	33	4219	1/4" x 15/16" Metal Spacer	32
15	1044	5/16" Flat Washer	12	34	4248	Plug Tine	32
16	1314	5/16" x 3/4" Carriage Bolt	8	35	1778	1/4" Lock Nut	64
17	4225X	Aerator Top Plate	1				
18	3042	1" Handle Grip	1				
19	4229	Tow Bar Weld Assembly	1				

**GUARANTEE**

The merchandise you have purchased from us has been carefully Engineered and manufactured under PRECISION PRODUCTS rigid quality standards and should give you satisfactory, dependable operation. However, like all mechanical merchandise, it may occasionally require adjustment or maintenance.

**PA42 & PA42G  
PARTS DRAWING**

Aerator Plug Assembly Components

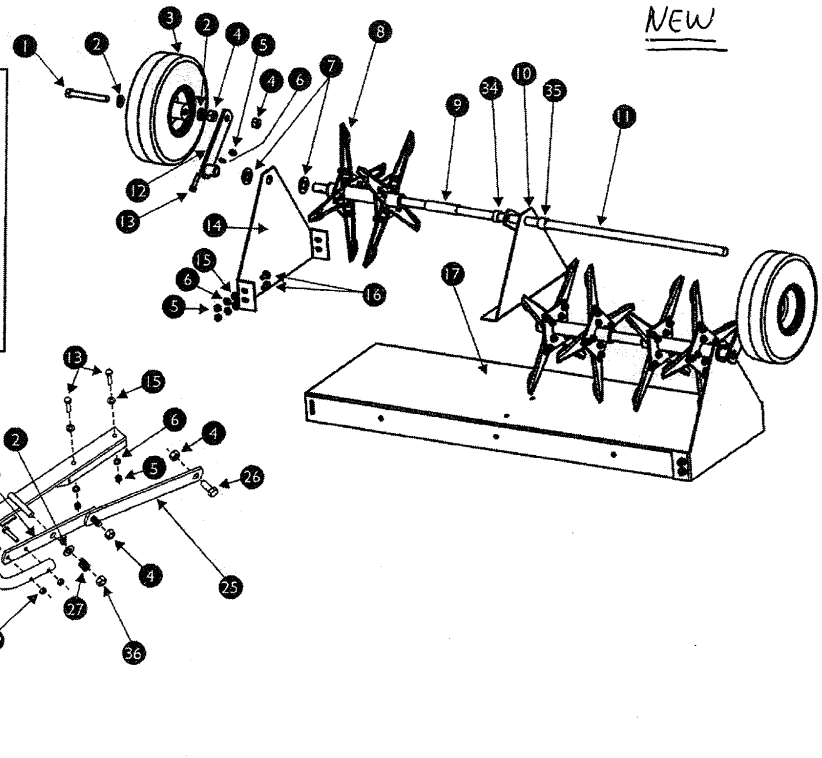
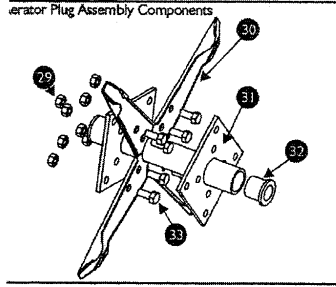

**PA42 Parts List**

Ref. No.	Part No.	Part Description	Part Qty.
1	4280	1/2"-13 x 4" Hex Head Bolt	2
2	1506	1/2" Flat Washer	5
3	4223	Wheel 3.5 x 4-1/2"	2
4	1638	1/2" Reverse Lock Nut	6
5	1275	5/16" Hex Head Nut	12
6	1276	5/16" Lock Washer	14
7	1264	3/4" Flat Washer	4
8	4298B	Aerator Plug Assembly	4
9	4297	1" x 3-1/2" Metal Spacer	2
10	4227B	Aerator Center Plate	1
11	4287B	Axle Assembly	1
12	4269B	Wheel Bracket Assembly	2
13	4014	5/16" x 1-1/2" Hex Head Bolt	8
14	4226B	Aerator End Plate	2
15	1044	5/16" Flat Washer	12
16	1314	5/16" x 3/4" Carriage Bolt	8
17	4225B	Aerator Top Plate	1
18	3042	1" Handle Grip	1
19	4229B	Tow Bar Weld Assembly	1
20	4279	Clevis Pin 5/8" x 3-1/2"	1
21	1042	#14 Hitch Pin Clip	1
22	4265B	Clevis #1	1
23	4266B	Clevis #2	1
24	4262B	Handle	1
25	4240B	Linkage Bar	1
26	4278	1/2"-13 x 1-1/4" Hex Head Bolt	1
27	4272	Compression Spring	1
28	4263B	Lever Link	1
29	1557	5/16" Reverse Lock Nut	68
30	4201B	Plug Tine	32
31	4202B	Aerator Spindle Assembly	4
32	4232	Oilite Bushing	8
33	1248	5/16" x 3/4 Hex Head Bolt	64
34	4295B	1 x 1/2 Metal Spacer	1
35	4296B	1 x 3/4 Metal Spacer	1
36	2311	1/2-13 Nylon Lock Nut	1

**PA42G Parts List**

Ref. No.	Part No.	Part Description	Part Qty.
1	4280	1/2"-13 x 4" Hex Head Bolt	2
2	1506	1/2" Flat Washer	5
3	4223	Wheel 3.5 x 4-1/2"	2
4	1638	1/2" Reverse Lock Nut	6
5	1275	5/16" Hex Head Nut	12
6	1276	5/16" Lock Washer	14
7	1264	3/4" Flat Washer	4
8	4298G	Aerator Plug Assembly	4
9	4297	1" x 3-1/2" Metal Spacer	2
10	4227G	Aerator Center Plate	1
11	4287G	Axle Assembly	1
12	4269G	Wheel Bracket Assembly	2
13	4014	5/16" x 1-1/2" Hex Head Bolt	8
14	4226G	Aerator End Plate	2
15	1044	5/16" Flat Washer	12
16	1314	5/16" x 3/4" Carriage Bolt	8
17	4225G	Aerator Top Plate	1
18	3042	1" Handle Grip	1
19	4229G	Tow Bar Weld Assembly	1
20	4279	Clevis Pin 5/8" x 3-1/2"	1
21	1042	#14 Hitch Pin Clip	1
22	4265G	Clevis #1	1
23	4266G	Clevis #2	1
24	4262G	Handle	1
25	4240G	Linkage Bar	1
26	4278	1/2"-13 x 1-1/4" Hex Head Bolt	1
27	4272	Compression Spring	1
28	4263G	Lever Link	1
29	1557	5/16" Reverse Lock Nut	68
30	4201G	Plug Tine	32
31	4202G	Aerator Spindle Assembly	4
32	4232	Oilite Bushing	8
33	1248	5/16" x 3/4 Hex Head Bolt	64
34	4295G	1 x 1/2 Metal Spacer	1
35	4296G	1 x 3/4 Metal Spacer	1
36	2311	1/2-13 Nylon Lock Nut	1

**GUARANTEE**

The merchandise you have purchased from us has been carefully Engineered and manufactured under PRECISION PRODUCTS rigid quality standards and should give you satisfactory, dependable operation. However, like all mechanical merchandise, it may occasionally require adjustment or maintenance.