



			FC150V	GXV160	FC150V	GXV160		
1	80-1035-221-00	Handle	1	1	1	1		
2	83-1035-411-00	Grip(21.7)	2	2	2	2		Yes
3	Discontinued	Blade Lever	1	1	1	1	REMARK 6	
	Discontinued	Blade Lever	1	1	1	1	*7) REMARK 6	
	80-1035-251-20	Blade Lever (RED)	1	1	1	1	*8	No
4	89-2521-000082	E-Type Stopper 8	2	2	2	2		
5	80-1020-262-00	Control Lever Shaft	2	2	2	2		
6	89-1711-120002	Washer 12	2	2	2	2		
7	80-1020-263-00	Control Lever Shaft Spring	2	2	2	2		
8	80-1020-264-00	Control Washer	1	1	1	1		
9	80-1020-261-00	Throttle Lever (K)	1		1			
	80-1020-265-00	Throttle Lever (H)		1		1		
10	80-1022-260-00	Driving Change Lever	1	1	1	1		Yes
11	80-1020-270-00	Inner Collar	1	1	1	1		
12	89-1133-080302	Hexagonal Bolt (PWSW) M8*30	1	1	1	1		
	89-1232-080302	Mini Hexagonal Bolt (SW) M8*30	1	1	1	1		
13	80-1035-260-10	Change Lever	1	1	1	1		
14	80-1515-262-	Arm Grip	1	1	1	1		

	00							
15	83-1020-355-00	Thrust Washer 12*24*1.0	1	1	1	1		
16	80-1035-261-00	Collar 10A-L8	1	1	1	1		
17	89-1711-080002	Washer 8	1	1	1	1		
18	89-1132-080162	Hexagonal Bolt (SW) M8*16	1	1	1	1		
	89-1232-080162	Mini Hexagonal Bolt (SW) M8*16	1	1	1	1		
19	Discontinued	Driving Lever	1	1	1	1	REMARK 7	
	Discontinued	Driving Lever	1	1	1	1	*7) REMARK 7	
	80-1035-241-20	Driving Lever	1	1	1	1	*8	No
20	80-1035-231-00	Control Cover	1	1	1	1		
21	89-1137-060152	Hexagonal Bolt (PW) M6*15	2	2	2	2		
22	80-1516-251-00	Handle Fix Washer	1	1	1	1		
23	80-1516-108-00	Knob Bolt M12*30	1	1	1	1		
24	80-1020-968-10	Blade Spring	2	2	2	2		
	80-1035-941-00	Blade Spring	2	2	2	2	*8	
25	83-1035-945-00	Blade Wire	1	1	1	1		
26	89-2181-060162	Flat Headed Pin 6*16	3	3	3	3		
27	89-2120-200152	Pin 2*15	3	3	3	3		
28	83-1024-952-	Throttle	1		1			

	00	Wire V(K)						
	83-1022-955-10	Throttle Wire (H)		1		1		
29	80-1020-967-00	Drive Change Spring	1	1	1	1		
30	83-1035-937-00	Differential Lock Wire	1	1	1	1		
31	80-1035-162-00	Differential Lock Return Spring	1	1	1	1		
32	83-1035-936-00	Change Wire	1	1	1	1		
33	89-2181-060162	Flat Headed Pin 6*16	1	1	1	1		
34	89-2131-080002	Snap Pin 8	1	1	1	1		
35	83-1035-932-00	Driving Wire	1	1	1	1		
36	80-1035-713-00	Rotery Cover	1	1			*9	
	80-1035-713-10	Rotery Cover			1	1	*2	No
37	80-1035-781-00	Rear Flapper	1	1			*9	
38	80-1035-782-00	Rear Flapper Holder	1	1			*9	
39	89-1137-060152	Hexagonal Bolt (PW) M6*15	4	4				
40	83-1575-189-00	Flange Cap Nut M6	4	4				
41	80-1035-783-00	Rear Flapper Holder			1	1	*2	
42	80-1035-785-00	Rear Flapper			1	1	*2	
43	80-1035-784-00	Rear Flapper Holder			1	1	*2	

		Spring						
44	83-1035-786-00	Rear Flapper Shaft			1	1	*2	
45	80-1035-986-00	Grip Stopper 5			2	2	*2	
46	89-1113-060162	Hexagonal Bolt (8T) M6*16			2	2	*2	
47	89-1750-060002	Spring Washer 6			2	2	*2	
48	80-1035-735-00	Front Flapper Setting	1	1	1	1		
49	83-1035-734-00	Front Flapper	1	1	1	1		
50	80-1035-736-00	Front Flapper Holder	1	1	1	1		
51	89-1137-060152	Hexagonal Bolt (PW) M6*15	4	4	4	4		
52	83-1575-189-00	Flange Cap Nut M6	4	4	4	4		
53	80-1035-737-00	Flapper Shaft Receiver	2	2	2	2		
54	89-1137-060152	Hexagonal Bolt (PW) M6*15	2	2	2	2		
55	89-1133-080162	Hexagonal Bolt (PWSW) M8*16	6	6	6	6		
	89-1233-080162	Mini Hexagonal Bolt (PWSW) M8*16	6	6	6	6		
56	80-1035-916-00	Knife Label	1	1	1	1	Since Nov.97	
57	80-1035-915-00	Driving Label	1	1	1	1		

58	80-1020-911-00	Throttle Label (K)	1		1			
	80-1020-913-00	Throttle Label (H)		1		1		
59	80-1035-918-00	Differential Lock Label	1	1	1	1		
60	80-1035-912-00	Change Label	1	1	1	1		
62	80-1488-926-00	Attention Mark for Blade (13062)	1	1	1	1		
63	80-1035-906-00	Label Main (Small)	1	1	1	1		

**M E M O**

- \*1)Serial Number : XP96M00004-
- \*2)Serial Number : XP97B00001-
- \*3)Serial Number : XP97L00321-
- \*4)Serial Number : XP98B00001-
- \*5)Serial Number : XP98G00201-
- \*6)Serial Number : XP99M00356-
- \*7)Serial Number : XP00A00001-
- \*8)Serial Number : XP00M00287-
- \*9)Serial Number : -XP97B00000

REMARK 1: -XP97M00420 Supplied Parts 80-1035-100-10

REMARK 2: -XP97M00420

REMARK 3: -XP97M00420 Supplied Parts 80-1035-128-10

REMARK 4: XP98B00001-

The Parts of Transmission Case ASSY(80-1035-100-10) are 1-18, 19(2), 21-28,34-41, 43-59, 64-70.

REMARK 5: -XP98B00200 Supplied Parts 80-1035-148-10(2 pces)

REMARK 6: -XP99M00425 the 80-1035-251-20 and 80-1035-941-00 are one set

REMARK 7: -XP99M00425 the 80-1035-241-20 and 80-1035-941-00 are one set

REMARK 8: XP00M00287- 83-1035-323-00 and 80-1035-837-00 are discontinued.



			FC150V	GXV160	FC150V	GXV160		
1-59	80-1035-100-00	Transmission Case ASSY	1	1			REMARK 1	
1-59	80-1035-100-10	Transmission Case ASSY			1	1	*4) REMARK 4	
1	80-1035-101-00	Transmission Case (Down)	1	1	1	1		
2	80-1035-103-00	Transmission Case (Upper)	1	1	1	1		
3	89-3115-060004	Bearing 6000 2RS	1	1	1	1		
4	89-1712-100000	Washer 10	1	1	1	1		
5	89-3111-062004	Bearing 6200	1	1	1	1		
6	83-1020-351-00	Thrust Washer 10*18*1.0	1	1	1	1		
7	80-1035-117-00	Pinion Bebel 13T	1	1	1	1		
8	80-1035-122-00	B Shaft	1	1	1	1		
9	89-2150-040100	Key 4*10	1	1	1	1		
10	80-1035-116-00	Bebel 35T	1	1	1	1		
11	80-1035-112-00	Shift Key	1	1	1	1		
12	80-1035-114-00	Shift Key Spring	1	1	1	1		
13	80-1035-111-00	Shift Collar	1	1	1	1		
14	80-1035-126-00	B Shaft Gear 28T	1	1	1	1		
15	80-1035-125-00	B Shaft Gear 22T	1	1	1	1		
16	80-1035-124-00	B Shaft Gear 16T	1	1	1	1		
17	80-1035-127-00	Thrust Washer 12*21*1.0	4	4	4	4		



18	80-1035-129-00	B Shaft N Collar	1	1	1	1		
19-1	80-1035-128-00	B Shaft Sprocket 15T	1	1			REMARK 3	
19-2	80-1035-128-10	B Shaft Sprocket 15T			1	1	*4	
20	Discontinued	Spacer 12*18*2	1	1			REMARK 3	
21	83-1020-351-00	Thrust Washer 10*18*1.0	2	2	2	2		
22	80-1035-171-00	Bush 10	1	1	1	1		
23	89-6512-015040	Chain # 15H-40	1	1	1	1		
24	80-1035-151-00	Differential Case	1	1	1	1	DU 12.15(2 pce)	
24a	89-3510-012150	DU Bush 12.15	2	2	2	2		
25	80-1035-154-00	Bevel Gear (Right Output) 14T	1	1			REMARK 2	
25	80-1035-154-00	Bevel Gear (Right Output) 14T			2	2	*4	
26	80-1035-153-00	Differential Bevel Gear 14T	2	2	2	2		
27	80-1035-157-00	Differential Shaft	1	1	1	1		
28	83-1020-355-00	Thrust Washer 12*24*1.0	4	4	4	4		
29	80-1035-156-00	Bevel Gear (Left Output) 14T	1	1			REMARK 2	
30	83-1310-371-00	Thrust Washer 20*30*1.0	1	1			REMARK 2	
31	80-1035-152-00	Differential Case Cap	1	1			REMARK 2	
32	83-1035-142-00	Hexagonal Bolt M5*12	1	1			REMARK 2	

33	80-1035-146-00	Drive Shaft(L)	1	1			REMARK 2	
34	80-1035-147-00	Drive Shaft(R)	1	1	1	1		
35	89-2511-000100	Shaft Ring 10	2	2	2	2		
36	80-1035-133-00	Differential Case Gear 24T	1	1	1	1		
37	80-1035-132-00	Differential Case Gear 30T	1	1	1	1		
38	80-1035-131-00	Differential Case Gear 36T	1	1	1	1		
39	80-1035-138-00	Differential Case Sprocket 30T	1	1	1	1		
40	83-1783-376-00	Thrust Washer 25*34*1.0	2	2	2	2		
41	80-1035-139-00	Differential Case Collar	1	1	1	1		
42	80-1035-143-00	Driving Clutch	1	1			REMARK 2	
43	83-1020-355-00	Thrust Washer 12*24*1.0	2	2	2	2		
44	80-1035-172-00	Bush 12	2	2	2	2		
45	89-5130-122204	Oil Seal KE 12.22.4	2	2	2	2		
46	80-1035-108-00	Shift Folk	1	1	1	1		
47	89-2521-000080	E-Type Ring 8	1	1	1	1		
48	80-1035-160-00	Notch Ball Spring	1	1	1	1		
49	89-3410-050000	Ball 5	1	1	1	1		
50	80-1035-110-00	Notch Plate	1	1	1	1		
51	80-1035-113-	Clutch Folk	1	1	1	1		

	00							
52	89-5221-010000	O Ring P10	2	2	2	2		
53	80-1035-193-00	Shift Arm	1	1	1	1		
54	80-1035-192-00	Differential Clutch Arm	1	1	1	1		
55	89-1541-080002	Hexagonal Nut (SW) M8	2	2	2	2		
56	83-1035-148-00	Tap Tight M6*18	7	7	7	7		
57	80-1035-191-00	Differential Lock Wire Setting	1	1	1	1		
58	89-1111-060252	Hexagonal Bolt M6*25	2	2	2	2		
59	89-1541-060002	Hexagonal Nut (SW) M6	2	2	2	2		
60	89-2150-030180	Key 3*18	1	1	1	1		
61	80-1035-521-00	Pulley	1	1	1	1		
62	89-1712-100000	Washer 10	1	1	1	1		
63	89-1541-100002	Hexagonal Nut (SW) M10	1	1	1	1		
	89-1631-100002	Flange Mini Hexagonal Nut M10	1	1	1	1		
64	80-1035-158-00	Differential Lock Collar			1	1	*4	
65	83-1830-368-00	Thrust Washer 18*26*1			1	1	*4	
66	80-1035-152-10	Differential Case Cap			1	1	*4	
67	83-1035-144-00	Hexagonal Bolt M5*16			2	2	*4	
68	89-2511-000120	Shaft Ring 12			2	2	*4	
69	80-1035-143-	Differential			1	1	*4	

	10	Lock Men						
70	80-1035-146-10	Drive Shaft(L)			1	1	*4	
71	89-1713-060002	Washer 6			1	1		
72	83-1020-148-00	Hexagonal Tap Tight M6*14			1	1		





			500	500	500A	500A		
			FC150V	GXV160	FC150V	GXV160		
1	80-1035-301-00	Frame	1	1				
	80-1035-301-10	Frame			1	1	*2	Yes
	80-1035-301-10	Frame			1	1	*6	Yes
2	89-1750-100002	Spring Washer 10	4		4			
	89-1750-080002	Spring Washer 8		4		4		
3	89-1113-100252	Hexagonal Bolt (8T) M10*25	4		4			
	83-1482-116-00	Hexagonal Bolt UNF5/16-24*25		4		4		
4	80-1020-892-00	Key 4*16	1	1	1	1		
5	80-1035-514-00	Engine Pulley (K)	1					
	80-1035-514-10	Engine Pulley (K)			1		*2	
	80-1035-515-20	Engine Pulley (H)		1		1	Since Dec.99	Yes
6	80-1035-512-00	Engine Pulley Collar 15	1				*9	
	80-1035-513-00	Engine Pulley Collar 20		1			*9	
	80-1035-516-00	Engine Pulley Collar 10			1	1	*2	

7	83-1020-323-00	Washer 10*30*4.5	1	1	1	1		
8	89-1750-100002	Spring Washer 10	1	1	1	1		
9	83-1020-118-00	Hexagonal Bolt UNF3/8-24*32	1		1			
	89-1254-100252	Flange Bolt(Slender) M10*25 P1.25		1		1		
10	80-1035-561-00	Engine Driving Belt Holder	1	1	1	1		
11	89-1531-100042	Hexagonal Nut M10			1	1		
12	83-1020-148-00	Tap Tight M6*14		1				
	89-1133-080162	Hexagonal Bolt (PWSW) M8*16	1					
	83-1515-148-00	Tap Tight M6*22				1		
	89-1133-080302	Hexagonal Bolt (PWSW) M8*30			1			
	89-1233-080302	Mini Hexagonal Bolt (PWSW) M8*30			1			
13	80-1035-755-00	Rear Cover	2	2	2	2		
14	89-1131-060122	Hexagonal Bolt (PW) M6*12	1	1	1	1		
15	80-1035-527-00	Transmission Pulley Belt Holder	1	1	1	1		
16	89-1133-	Hexagonal Bolt (PWSW) M8*16	1	1	1	1		

	080162							
	89-1233-080162	Mini Hexagonal Bolt (PWSW) M8*16	1	1	1	1		
17	80-1035-100-00	Trasmission Case ASSY	1	1				
	80-1035-100-10	Trasmission Case ASSY			1	1		
18	89-2511-000120	Snap Ring 12	2	2	2	2		
19	89-2150-030180	Key 3*18	1	1	1	1		
20	80-1035-521-00	Trasmission Pulley	1	1	1	1		
21	89-1711-100002	Washer 10	1	1	1	1		
22	89-1541-100002	Hexagonal Nut (SW) M10	1	1				
	89-1631-100002	Flange Mini Hexagonal Nut M10			1	1		
23	83-1020-143-00	Tap Tight M8*18	2	2				
	83-1482-143-00	Tap Tight M8*25			1	1		
24	89-6111-002500	V Belt M25	1	1	1	1		
	89-6111-002501	V Belt RM25	1	1	1	1	*7	
25	80-1035-341-00	Rear Wheel Arm Receiver	2	2	2	2	*10	
25a	80-	Rear Wheel			1	1	*8	



	1035-341-10	Arm Receiver(L)						
25b	80-1035-342-00	Rear Wheel Arm Receiver(R)			1	1	*8	
26	89-3511-025300	DU Bush 25.30.36F	2	2	2	2		
26a	89-3511-025100	DU Bush 25.10.36F			2	2	*8	
26b	89-3510-025120	DU Bush 25.12			2	2	*8	
27	89-1541-060002	Hexagonal Nut (SW) M6	4	4	4	4		
28	89-1113-060162	Hexagonal Bolt (8T) M6*16	4	4	4	4		
29	80-1035-547-00	Blade Tension Arm	1	1				
30	80-1035-547-10	Blade Tension Arm			1	1	*1	
31	89-3511-015150	DU Bush 15.15.23F	1	1	1	1		
32	89-3510-015150	DU Bush 15.15	1	1	1	1		
33	89-3115-062024	Bearing 6202 2RS	1	1	1	1		
34	83-1420-754-00	Tension Pulley	1	1	1	1		
35	89-2512-000350	Snap Ring 35	1	1	1	1		
36	89-2511-000150	Snap Ring 15	1	1	1	1		

37	80-1035-985-00	Rubber Cap 35-4	1	1	1	1		
38	89-1113-060252	Hexagonal Bolt (8T) M6*25	1	1	1	1		
39	89-1511-060042	Hexagonal Nut M6	1	1	1	1		
40	80-1035-546-00	Spring 30			1	1	*1	
41	80-1035-548-00	Blade Brake			1	1	*1	
42	89-2521-000122	E-Type Ring 12	1	1	1	1		
43	80-1035-373-00	Blade Brake Spring	1	1	1	1		
44	80-1035-543-00	Driving Tension Arm	1	1	1	1		
45	89-3510-012100	DU Bush 12.10	1	1	1	1		
46	89-3511-012150	DU Bush 12.15.20F	1	1	1	1		
47-49	80-1035-760-00	Tension Pulley Assy	1	1	1	1	Since May 2000	
47	89-2512-000280	Snap Ring 28	1	1	1	1		
48	89-3115-060014	Bearing 6001 2RS	1	1	1	1		
49	83-1035-765-10	Tension Pulley	1	1	1	1		
50	89-2511-	Snap Ring 12	1	1	1	1		

	000120							
51	83-1035-679-00	Cap 25.7	1	1	1	1		
52	80-1035-552-00	Spring 26	1	1	1	1		
53	83-1020-355-00	Thrust Washer 12*24*1.0	1	1	1	1		
54	89-2511-000120	Snap Ring 12	1	1	1	1		
55	89-6122-003201	V Belt SA32	1	1	1	1		
	89-6122-003202	V Belt SA32(W400P)	1	1	1	1	*7	
56	80-1035-601-00	Blade Shaft Case	1	1	1	1		
57	89-3115-062054	Bearing 6205 2RS	2	2	2	2		
58	83-1415-662-00	Oil Seal AP 35.55.8	1	1	1	1		
59	80-1035-641-00	Blade Shaft	1	1	1	1		
	80-1035-641-10	Blade Shaft			1	1	Since May 2000	Yes
60	89-1132-080202	Hexagonal Bolt (SW) M8*20	4	4	4	4		
	89-1232-080202	Mini Hexagonal Bolt (SW) M8*20	4	4	4	4		
61	89-2151-050200	Key 5*20	1	1	1	1		
62	80-	Knife Pulley	1	1	1	1		

	1035-571-00							
63	83-1415-312-00	Washer 8*30*3.2	1	1	1	1		
64	89-1750-080002	Spring Washer 8	1	1	1	1		
65	89-1113-080202	Hexagonal Bolt (8T) M8*20	1	1	1	1		
	89-1253-080202	Flange Hexagonal Bolt (8T) M8*20	1	1	1	1		
66	80-1035-813-00	Knife Shaft Collar	1	1	1	1		
67	80-1035-833-10	Knife Bracket	1	1	1	1	*8) REMARK 8	Yes
68	80-1035-836-00	Knife Neck Guard	1	1	1	1		
69	83-1035-323-00	Washer 10*30*3.2	1	1	1	1	*10)	
70	89-1254-100252	Flange Bolt(Slender) M10*25 P1.25	2	2	2	2		
71	80-1035-837-00	Knife Bracket Spacer	1	1	1	1	*10)	
72	80-1035-821-00	Blade	1	1	1	1		
73	89-1254-100252	Flange Bolt(Slender) M10*25 P1.25	2	2	2	2		
74	80-1035-502-10	Front Bonnet	1	1	1	1		
75	89-1133-060152	Hexagonal Bolt (PWSW) M6*15	2	2	2	2		

76	80-1035-149-00	Drive Shaft Joint	2	2	2	2		
77	89-1711-080002	Washer 8			1	1		
78	80-1035-988-00	Spacer Rubber			1	1		
79	80-1035-751-00	Rear Guard			1	1	*2	
80	80-1035-752-00	Rear Guard Flapper			1	1	*2	
81	80-1035-753-00	Rear Guard Flapper Holder			1	1	*2	
82	89-1137-060152	Hexagonal Bolt (PW) M6*15			3	3	*2	
83	83-1575-189-00	Flange Cap Nut M6			3	3	*2	
84	89-1711-060002	Washer 6			2	2	*2	
85	89-1132-060162	Hexagonal Bolt (SW) M6*16			2	2	*2	
86	80-1751-591-00	Rubber			2	2	*2	
87	80-1035-905-00	Main Label (Large)	1	1	1	1		
88	83-1260-908-00	Attention Mark for Reversing	1	1	1	1		
89	83-1415-912-00	Attention Mark against Scattering Obstacles	1	1	1	1		
90	Not for	Name Plate	1	1	1	1		

	Sele							
92	80-1035-904-00	Label (FL500A)			1	1		
93	80-1484-A47-00	Label, Caution (Large)			1	1		
94	80-1035-917-00	Label Cutting Height Adjusting			1	1		
96	83-1415-909-00	Sticker for Engine(Z18-6)			1	1		
97	83-1415-913-00	Label, Protection for Eyes			1	1		
98	80-1488-928-00	Label, Caution for Belt Involving						
99	83-1415-975-00	Grease Nipple M6			2	2	*8	
*10) Discontinued since Dec. 2000								



Fig. 4 Tire

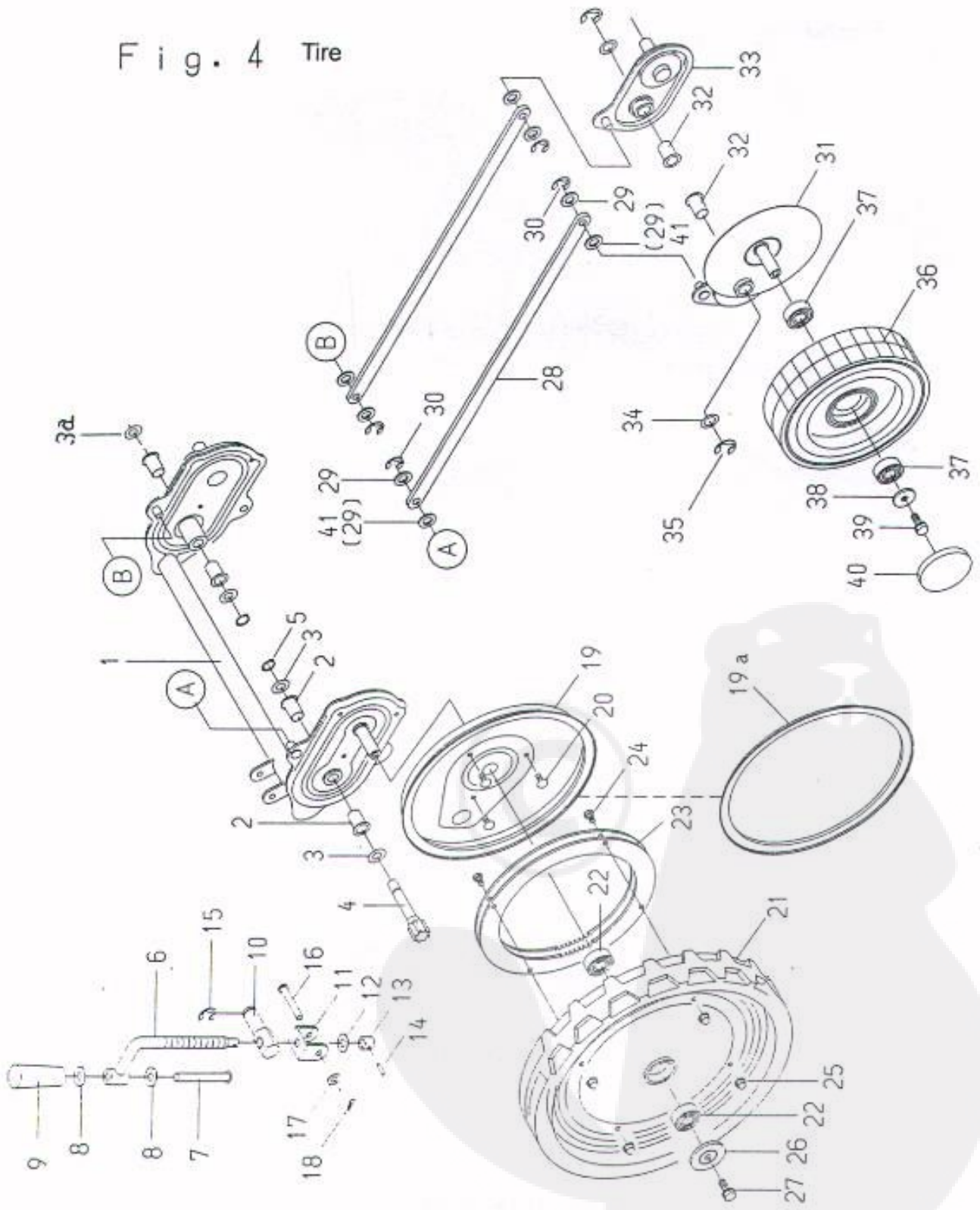

Ref.	Parts	Parts Name	Qty.	Remarks	Int.
------	-------	------------	------	---------	------

	No.		FL	FL	FL	FL		
			500	500	500A	500A		
			FC150V	GXV160	FC150V	GXV160		
1	80-1035-415-10	Rear Wheel Arm	1	1	1	1	*5	
2	89-3511-012150	DU Bush 12.15.20F	4	4	4	4		
3	83-1020-355-00	Thrust Washer 12*24*1.0	4	4	4	4		
	83-1020-355-00	Thrust Washer 12*24*1.0			2	2		
3a	80-1035-907-00	Thrust Washer 12*30*1.0			2	2	*8	
4	80-1035-148-00	Drive Gear 8T	2	2			REMARK 5	
	80-1035-148-10	Drive Gear 9T			2	2	*5	
5	89-2511-000120	Shaft Ring 12	2	2	2	2		
6	80-1035-743-00	Cutting Height Adjustment Screw	1	1	1	1		
7	83-1713-166-00	Pin 10*80	1	1	1	1		
8	89-1711-100002	Washer 10	2	2	2	2		
9	83-1210-425-00	Lever Grip 10	1	1	1	1		
10	80-1035-742-00	Cutting Height Adjustment Shaft	1	1	1	1		



11	80-1035-745-00	Screw Setting	1	1	1	1		
12	83-1020-351-00	Thrust Washer 10*18*1.0	1	1	1	1		
13	80-1035-744-00	Cutting Height Screw Stopper	1	1	1	1		
14	89-2111-040018	Spring Pin 4*18	1	1	1	1		
15	89-2521-000120	E-Type Ring 12	1	1	1	1		
16	83-1131-152-00	Flat Headed Pin 8*53	1	1	1	1		
17	89-1711-080002	Washer 8	1	1	1	1		
18	89-2131-080002	Snap Pin 8	1	1	1	1		
19	80-1035-418-00	Driving Gear Cover	2	2	2	2		
19a	80-1035-419-00	Rubber	2	2	2	2		
20	83-1035-149-00	Truss Tapping Screw M6*10	6	6	6	6		
21	80-1035-408-00	Tire 350*54	2	2	2	2	*5	
22	89-3115-062024	Bearing 6202 2RS	4	4	4	4		
23	80-1035-421-00	Driven Gear 95T	4	4	4	4		
24	80-1035-	Knok Bolt M6*16	8	8	8	8		

	971-00							
25	83-1575-189-00	Flange Cap Nut M6	8	8	8	8		
26	80-1035-411-00	Bearing Cover	2	2	2	2		
27	89-1132-080202	Hexagonal Bolt (SW) M8*20	2	2	2	2		
28	80-1035-416-00	Translation Bar	2	2	2	2		
29	89-1711-100002	Washer 10	8	8	8	8		
29	89-1711-100002	Washer 10			4	4	*3	
30	89-2521-000080	E-Type Ring 8	4	4	4	4		
31	80-1035-405-00	Front Wheel Arm(R)	1	1	1	1		
32	89-3511-015250	DU Bush 15.25.23F	2	2	2	2		
33	80-1035-404-00	Front Wheel Arm(L)	1	1	1	1		
34	83-1020-361-00	Thrust Washer 15*24*1.0	2	2	2	2		
35	89-2521-000120	E-Type Ring 12	2	2	2	2		
36	80-1020-407-00	Front Wheel	2	2	2	2		
37	89-3115-062024	Bearing 6202 2RS	4	4	4	4		
38	83-	Washer	2	2	2	2		

	1415-312-00	8*30*3.2						
39	89-1132-080202	Hexagonal Bolt (SW) M8*20	2	2	2	2		
40	80-1020-441-00	Wheel Cap	2	2	2	2		
41	80-1035-991-00	Rubber Washer 11*24*3			4	4	*3	

