

ZC-DMBB-4DDC-2RPX

Service Schematic

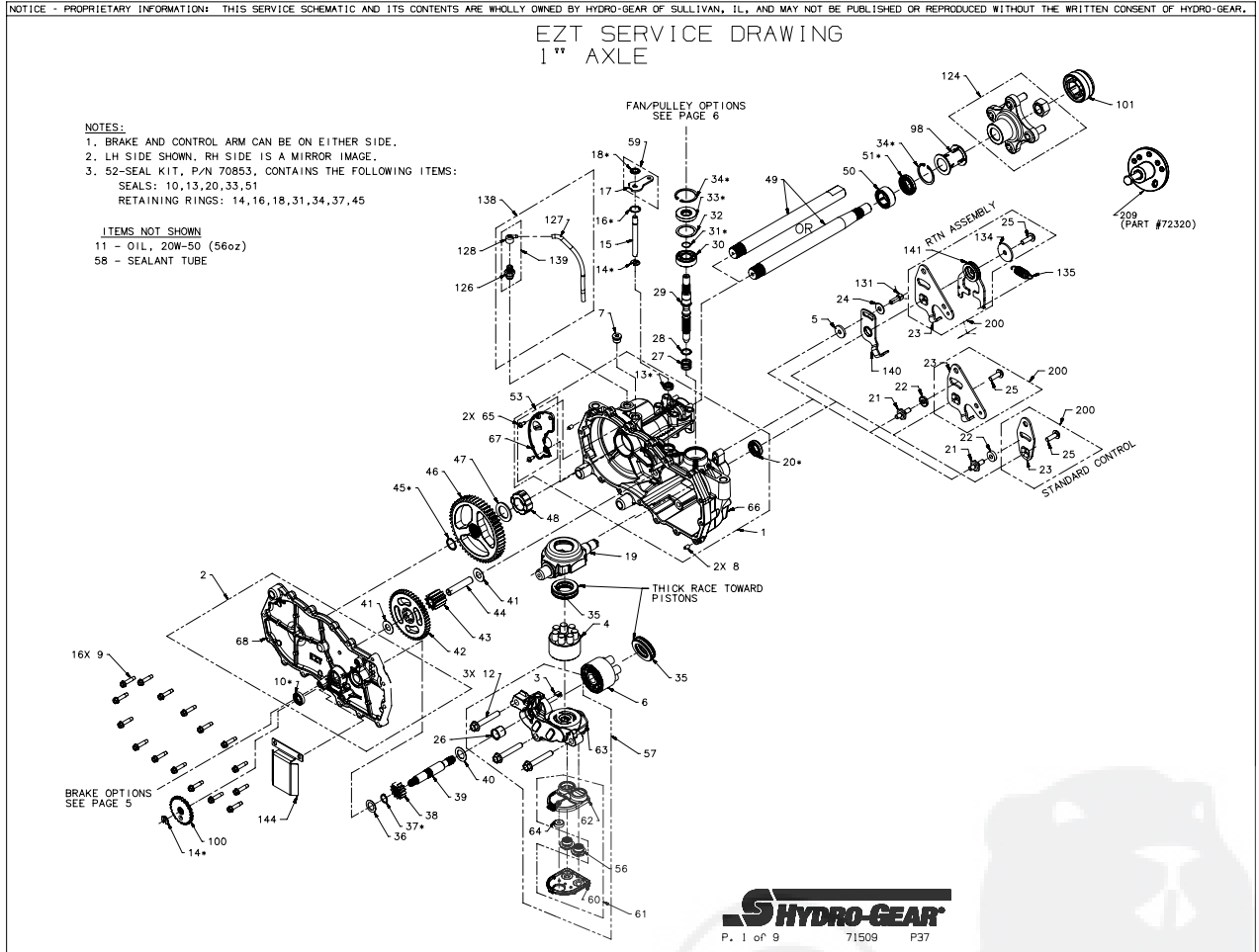

Service Schematic

#	PART #	DESCRIPTION	QTY	Note
1	70862L	KIT, MAIN HOUSING-LH	1	
2	70863L	KIT, SIDE HOUSING LH	1	
4	70723	ASSY, BLOCK 7 PISTON	1	
5	54315	SPACER 0.320 ID X 1.005 OD X 0.1495 THK	1	
6	70331	KIT, BLOCK, 10CC CYLINDER	1	
7	9005110-5600	PLUG 9/16-18 METAL	1	
9	53246	SCREW 1/4-20 X 1.125 HEX WASHER	16	
15	51625	ROD BYPASS	1	
19	51048	TRUNNION, SWASHPLATE	1	
24	44130	WASHER .34 X .88 X .06	1	
27	2003014	SPRING, BLOCK	1	
28	2003017	WASHER .59 X .79 X .04 FLAT	1	
29	51062	SHAFT INPUT	1	
30	50315	BEARING 17X40X12 BALL OPEN 6203	1	
32	50951	WASHER 1.23 X 1.57 X .04	1	
35	50551	BEARING 30X52X13 BALL THRUST	2	
36	44371	WASHER .63 X 1.0 X .05 FLAT	1	
37	44145	RETAINING RING, MOTOR SHAFT	1	
38	51130	GEAR, 13T PINNION	1	
39	51632	SHAFT MOTOR	1	
40	51069	WASHER .71 X 1.16 X .04 FLAT	1	
41	50132	WASHER .51 X 1.10 X .03 FLAT	2	
42	51129	GEAR, 10T/48T	1	
43	51043	GEAR, 10T JACKSHAFT	1	
44	51083	JACK SHAFT (PIN)	1	
46	52541	GEAR, 52T BULL	1	
47	52532	WASHER 1.013 X 1.750 X .105 FLAT	1	
48	52542	SLEEVE BEARING (INBOARD)	1	
49	52545	SHAFT 1.00 X 11.70 DD AXLE	1	
50	51517	BUSHING 1.003X1.571X.625	1	
52	70853	KIT, SEALS AND RETAINING RINGS	1	
10		SEAL, LIP ,625 X 1.000 X ,250	1	
		SEAL, LIP ,50 X ,88 X ,25	1	
13		SEAL, LIP ,375 X ,75 X ,25	1	
14		RING, RETAINING ,375 EXT	2	
16		RING, RETAINING ,750 INT	1	
18		RING, RETAINING ,375 EXT (PUSHNUT)	1	
20		SEAL, LIP 18 X 32 X 7	1	
31		RING, RETAINING WIRE ,561 ID	1	
33		SEAL, LIP 17 X 40 X 7	1	
34		RING, RETAINING	2	
37		RING, RETAINING	1	
45		RING, SPIRAL RETAINING	1	
51		SEAL, LIP 1.00 X 1.57 X ,25	1	
		SEAL, LIP ,375 X ,75 X ,25	1	
53	70868L	KIT, EXPANSION PLATE LH	1	

Service Schematic

#	PART #	DESCRIPTION	QTY	Note
57	71529	KIT, CENTER SECTION W/ FILTER - LH	1	
(63)		CENTER SECTION, LH, 7P	1	
(3)		PLATE, BYPASS	1	
(26)		BUSHING, .711 X .789 X .778	1	
(12)		BOLT, HEX FLANGE3/8-24 X 2.5	3	
(60)		ASSEMBLY, COVER	1	
(62)		FILTER, BASE	1	
(64)		MAGNET	1	
(56)		CHECK PLUG ASSEMBLY, .027, WASHER	2	
58	50928	SEALANT TUBE	1	
59	71006	KIT, BYPASS ARM	1	
61	71497	KIT, FILTER	1	
(60)		ASSEMBLY, COVER	1	
(62)		FILTER, BASE	1	
(64)		MAGNET	1	
100	51635	DISC, COG BRAKE	1	
131	71341	KIT, RTN SCREWS	1	
135	51833	SPRING EXT .56 X 2.05	1	
138	71510	KIT, BREATHER	1	
(126)		ASSEMBLY, FITTING 9/16	1	
(127)		HOSE, EXP TANK	1	
(128)		CAP, BARBED VENT	1	
139	71524	KIT, BREATHER	1	
(128)		CAP, BARBED VENT	1	
(126)		ASSEMBLY, FITTING 9/16	1	
140	51946	ARM, NEUTRAL LEFT	1	
200	71592	KIT, RTN, BIDIRECTIONAL	1	
209	72320	KIT HUB PULLER	1	

Fans, Pulleys, and Fan & Pulley Kits

NOTICE - PROPRIETARY INFORMATION: THIS SERVICE SCHEMATIC AND ITS CONTENTS ARE WHOLLY OWNED BY HYDRO-GEAR OF SULLIVAN, IL, AND MAY NOT BE PUBLISHED OR REPRODUCED WITHOUT THE WRITTEN CONSENT OF HYDRO-GEAR.

EZT SERVICE DRAWING
1" AXLE

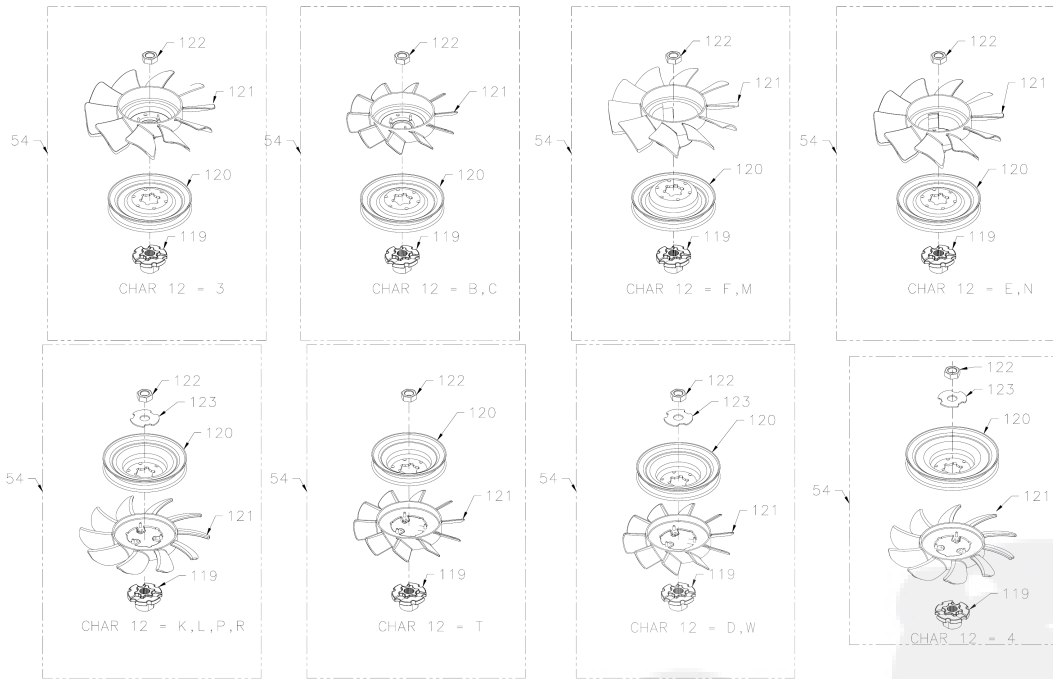

Fans, Pulleys, and Fan & Pulley Kits

#	PART #	DESCRIPTION	QTY	Note
54	72134	KIT, FAN & PULLEY	1	[1]

PART NOTES:

[1] - Includes items: 119-123

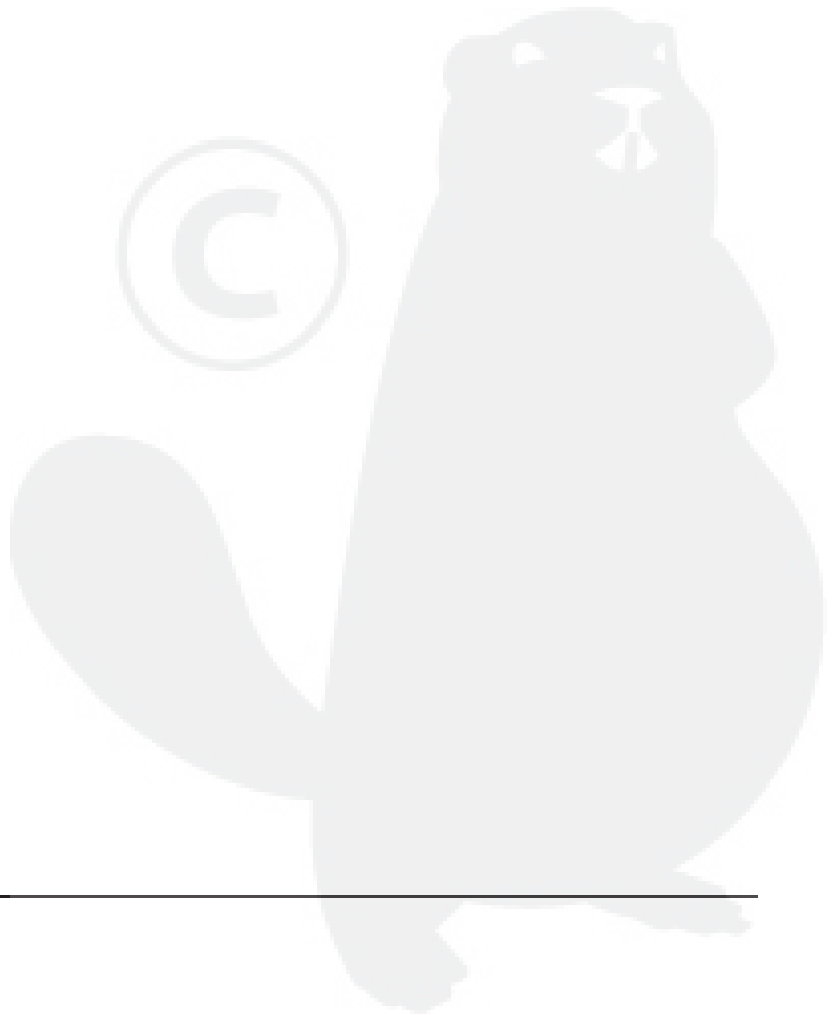

ZC-DMBB-4DDC-2RPX

Brake Assembly

NOTICE - PROPRIETARY INFORMATION: THIS SERVICE SCHEMATIC AND ITS CONTENTS ARE WHOLLY OWNED BY HYDRO-GEAR OF SULLIVAN, IL, AND MAY NOT BE PUBLISHED OR REPRODUCED WITHOUT THE WRITTEN CONSENT OF HYDRO-GEAR.

EZT SERVICE DRAWING
1" AXLE

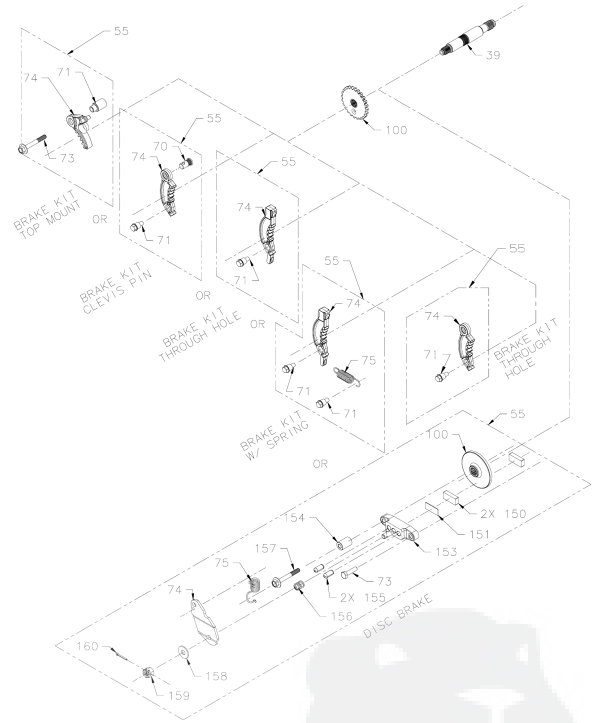

HYDRO-GEAR
P. 5 of 9 71509 P37

Brake Assembly

#	PART #	DESCRIPTION	QTY	Note
39	51632	SHAFT MOTOR	1	
55	71356	KIT, BRAKE ARM	1	
(74)		ARM, BRAKE	1	
(75)		SPRING, EXTENSION	1	
(71)		BOLT, 1/4-20X1 SHOULDER W/PATCH	2	
100	51635	DISC, COG BRAKE	1	

