

1015-1057R

# Parts Breakdown

NOTICE - PROPRIETARY INFORMATION: THIS SERVICE SCHEMATIC AND ITS CONTENTS ARE WHOLLY OWNED BY HYDRO-GEAR OF SULLIVAN, IL., AND MAY NOT BE PUBLISHED OR REPRODUCED WITHOUT THE WRITTEN CONSENT OF HYDRO-GEAR.

HYDRO-GEAR MODEL 1015-1057R  
CUSTOMER MODEL 5103963

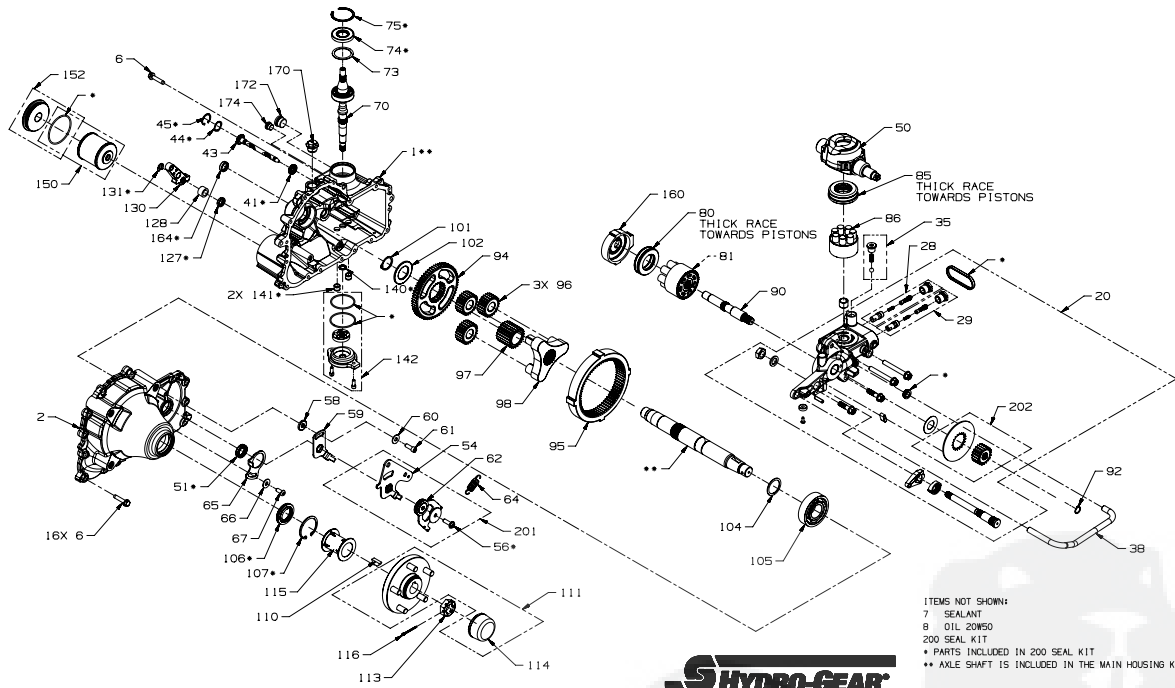

**HYDRO-GEAR**  
P. 1 of 2 72510R P2

## Parts Breakdown

#	PART #	DESCRIPTION	QTY	Note
1	72690	KIT, HOUSING, MAIN, RH	1	
		HOUSING, MAIN, RH MACHINE	1	
		BUSHING 17 X 20.2 X 15	1	
		BEARING, BALL 6205R-1 25.4 X 52 X 15	1	
		PIN	2	
		PLUG	2	
		BUSHING, 35 X 39 X 20	1	
		LABEL, ZT-5400 POWERTRAIN	1	
		SCREW, HEX FLANGE, 5/1618 X 1.5	1	
		BUSHING, STEEL, 15 X 17 X 12	1	
		SHAFT, AXLE	1	
		SERVICE BULLETIN	1	
2	71949	KIT, HOUSING, SIDE, RH	1	
		HOUSING, SIDE RH MACHINE	1	
		BUSHING, 35 X 39 X 20	1	
		INSERT, THREADED, LOCKING 1/2-13 X 1.00	4	
		SCREW, HEX FLANGE, 5/16-18 X 1.5	1	
6	53987	SCREW 5/16-18 X 1.5 HEX WASHER	17	
7	50928	SEALANT TUBE	1	
8		OIL, 20W50	1.2 gal	
20	71996	KIT, CENTER SECTION	1	
		CENTER SECTION, RH	1	
		BOLT, HEX FLANGE 3/8-16 X 3.00	2	
		SCREW, HEX FLANGE HEAD 3/8-16 1.5	2	
		BUSHING, 22.2 X 25.4 X 22.2	1	
		BUSHING 17 X 20.2 X 15	1	
		SEAL, PLUG 1.375 X .250 X 3.477	1	
		ASSEMBLY, SEAT, CHECK	2	
		SHOCK VALVE ASSEMBLY	1	[1]
		SHOCK VALVE ASSEMBLY	1	[1]
		RETAINER, CHECK SPRING	2	
		SPRING, COMPRESSION SHOCK CHECK	2	
		GROMMET	1	
		MAGNET, RING	1	
		BOLT, SELF TAPPING 10-32 X .5	1	
		PIN, HARDENED GROUND PROD DOWEL 1/4 X 1	1	
		SHAFT, BRAKE	1	
		CAM, SPLINED	1	
		PUCK, CAM	1	
		ROTOR, BRAKE	1	
		PUCK, BRAKE	1	
		WASHER, FLAT .63 X 1.0 X 1.25	1	
		NUT, HEX 5/8-18 W/PATCH	1	
		WASHER, .89 X 1.50 X .04	1	
		GEAR, 19T	1	
28	71952	KIT, SHOCK VALVE	1	

## Parts Breakdown

#	PART #	DESCRIPTION	QTY	Note
		SHOCK VALVE ASSEMBLY	1	[1]
		ASSEMBLY, SEAT, CHECK	1	
		RETAINER, CHECK SPRING	1	
		SPRING	1	
29	71952	KIT, SHOCK VALVE	1	
		SHOCK VALVE ASSEMBLY	1	[1]
		ASSEMBLY, SEAT, CHECK	1	
		RETAINER, CHECK SPRING	1	
		SPRING	1	
35	71999	KIT, CHARGE RELIEF	1	
		BALL 3/8	1	
		SPRING, HELICAL COMPRESSION	1	
		SCREW, 5/8-11 X .50	1	
38	52983	TUBE, FILTER RH	1	
41	53197	SEAL 12 X 24 X 5 LIP	1	
43	54335	ASSEMBLY ACTUATOR BYPASS	1	
44	53321	SPRING WAVE	1	
45	53322	RING RET 102 INT	1	
50	52972	SWASHPLATE 16CC MACHINED	1	
51	52989	SEAL 22 X 32 X 7 LIP TC	1	
54	53221	ARM, CONTROL, RH	1	
56	51812	SCREW 5/16-24 X 1.00 TWHCS PATCH	1	[2]
58	54315	SPACER 0.320 ID X 1.005 OD X 0.1495 THK	1	
59	51945	ARM, NEUTRAL RIGHT	1	
60	44130	WASHER .34 X .88 X .06	1	
61	51616	SHCS 5/16-24 X .875	1	[2]
62	52432	ASSEMBLY, RTN BI-DIRECTIONAL	1	[3]
64	52401	SPRING EXT .63 X 2.05	1	
65	53189	PLATE, STOP, RH	1	
66	44130	WASHER .34 X .88 X .06	1	
67	53519	SCREW 5/16-18 X .75 HBHCS	1	
70	71941	KIT, INPUT SHAFT	1	
		SHAFT, INPUT	1	
		BEARING, BALL 25.4 X 52 X 15	1	
		RING, RETAINING WIRE .902 ID	1	
73	51279	WASHER 1.559 X 1.944 X .040	1	
74	51280	SEAL 25 X 52 X 7 LIP	1	
75	52650	RING RET 206 INT	1	
80	53341	BEARING (21) 42X68X16 PLASTIC THRUST	1	
81	72159	KIT, BLOCK 21CC CYLINDER, PW SERIES	1	[4]
		BLOCK, CYLINDER 21cc	1	
		WASHER, THRUST	7	
		PISTON	7	
		SPRING, HELICAL COMPRESSION	7	
85	52991	BEARING 35X70X21.6 THRUST	1	
86	72158	KIT, BLOCK 16CC CYLINDER, PR-SERIES	1	[5]

## Parts Breakdown

#	PART #	DESCRIPTION	QTY	Note
		BLOCK, CYLINDER 16cc	1	
		SPRING, COMPRESSION	7	
		PISTON	7	
		WASHER, THRUST	7	
90	52992	SHAFT MOTOR	1	
92	44145	RING RET 62 EXT	1	
94	52996	GEAR, 65T/22T	1	
95	53988	GEAR, RING, 68T	1	
96	54483	GEAR, PLANET, 23T	3	
97	53000	GEAR, 22T	1	
98	53001	CARRIER	1	
100	53002	BALL .75	1	
101	53003	RING RET 125 EXT	1	
102	53004	SPACER, THRUST, AXLE, 1.31 X 2.50 X .13	1	
104	53006	WASHER 1.40 X 1.75 X .05	1	
105	53007	BEARING 35X80X21 BALL 6307	1	[6]
106	53008	SEAL 1.375 X 2.062 X .25 LIP	1	
107	50859	RING, RETAINING 206 INTERNAL	1	
110	51796	KEY 5/16 X 1 WOODRUFF	1	
111	72102	KIT, HUB 5 BOLT	1	[7]
		HUB, TAPER 1.25 5 BOLT	1	
		STUD, 1/2-20 X 1.55	5	[7]
		CAP, AXLE	1	
113	51821	NUT 1-20 HEX SLOTTED	1	
114	53724	CAP AXLE	1	
116	51822	PIN 9/64 X 2 COTTER EXTENDED PRONG	1	
127	53015	SEAL .562 X .875 X .187 LIP	1	
128	53356	SPACER .57 X .86 X .53	1	
130	53018	HANDLE, ACTUATING	1	
131	53019	RING RET 43 EXT KLIPRING	1	
140	53020	SEAL .500 X .688 X .094 LIP	1	
141	52157	TUBE PUSH O-RING .500 X .450	2	
142	71942	KIT, CHARGE COVER	1	
		GEROTOR ASSEMBLY	1	[8]
		O-RING, 139 .103 X 2.175	1	
		HOUSING, CHARGE PUMP	1	
		SHCS 1/4-20X.625	2	
		O-RING -137 .103 X 2.050	1	
150	71943	KIT, FILTER	1	
		FILTER, INTERNAL	1	
		O-RING -148, 2.737 X .103 X 2.881	1	
152	71944	KIT, FILTER PLUG	1	
		PLUG, FILTER	1	
		O-RING -148, 2.737 X .103 X 2.881	1	
160	53026	SWASHPLATE MOTOR	1	
164	53031	SEAL .945 X .250 PLUG	1	

## Parts Breakdown

#	PART #	DESCRIPTION	QTY	Note
170	9005200-8700	PLUG, SHIPPING 7/8-14	1	
172	9005110-8700	PLUG 7/8-14 STR THREAD SOCKET HEAD	1	
174	9005110-5600	PLUG 9/16-18 METAL	1	
200	71945	KIT, OVERHAUL SEAL	1	
		SEAL, PLUG 1.375 X .250 X 3.477	1	
		GROMMET	1	
		SEAL, LIP 12 X 24 X 5	1	
		O-RING -010 .070 X .239	2	
		SPRING, WAVE	1	
		RING, RETAINING, HO-100	1	
		SEAL, LIP 22 X 32 X 7 TC	1	
		TWHCS 5/16-24 X 1.00	1	[2]
		SEAL, LIP 25 X 52 X 7 TC	1	
		RING, RETAINING INTERNAL	1	
		SEAL, LIP 1.375 X 2.062 X .250	1	
		RING, RETAINING	1	
		PIN, COTTER, 9/64 X 2 EXTENDED PRONG	1	
		SEAL, LIP .562 X .875 X .187	1	
		RING, RETAINING EXTERNAL .438	1	
		SEAL, LIP .500 X .688 X .094	1	
		TUBE, PUSH, O-RING, .500 X .450	2	
		O-RING, -139 .103 X 2.175	1	
		O-RING -137 .103 X 2.050	1	
		O-RING -148, 2.737 X .103 X 2.881	1	
		SEAL, LIP 15 x 24 x 7	1	
		SEAL, PLUG .945 X .250	1	
201	71951	KIT RTN BIDIRECTIONAL	1	
		ARM, CONTROL, RH	1	
		TWHCS, 5/16-24 X 1.00	1	[2]
		ASSEMBLY, RTN, BI-DIRECTIONAL	1	
		WASHER, FLAT .34 x 1.50 x .12	1	
202	72748	KIT, BRAKE ROTOR, GEAR	1	
		GEAR, 19T	1	
		ROTOR, BRAKE	1	

## PART NOTES:

- [1] - 200 BAR
- [2] - PATCH
- [3] - CW
- [4] - 21cc
- [5] - 16cc
- [6] - 6307
- [7] - RIB NECK
- [8] - 3.7 cc/rev