

Service Schematic

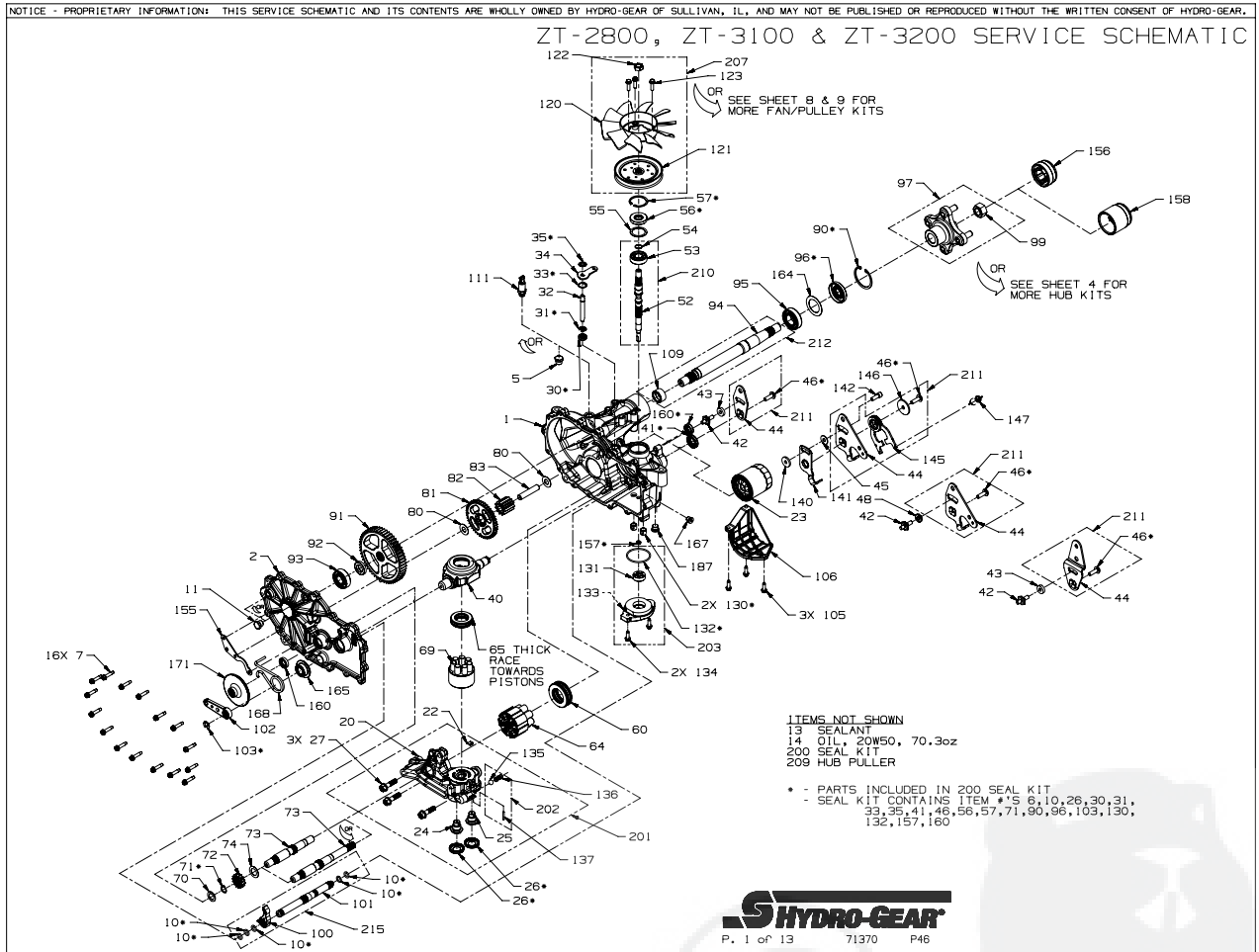

Service Schematic

#	PART #	DESCRIPTION	QTY	Note
1	71413	KIT, MAIN HOUSING, RH, CHRGR, CNTL	1	
2	71572	KIT, COVER, SIDE, RH	1	
7	53246	SCREW 1/4-20 X 1.125 HEX WASHER	16	
10	51804	O-RING -111 .103 X .424	4	
11	54730	PLUG, EXTERNAL, HEX	1	
13	50928	SEALANT TUBE	1	
14		OIL, 20W50	70.30Z	
22	51448	PLATE, BYPASS	1	
23	52114	FILTER, OIL	1	
26	52162	SEAL 1.375 X .250 PLUG	2	
27	52137	SCREW 3/8-16 X 1.50 HFH	3	
30	51626	SEAL .375 X .75 X .25 LIP	1	
31	51628	RING RET 37 EXT KLIPRING	1	
32	52136	ROD BYPASS	1	
33	51627	RING RET 75 INT	1	
34	51629	ARM, BYPASS	1	
35	51630	RING RET 37 EXT PUSH	1	
40	51048	TRUNNION, SWASHPLATE	1	
41	51140	SEAL 18 X 32 X 7 LIP	1	
45	44130	WASHER .34 X .88 X .06	1	
46	51812	SCREW 5/16-24 X 1.00 TWHCS PATCH	1	
55	50951	WASHER 1.23 X 1.57 X .04	1	
56	51161	SEAL 17 X 40 X 7 LIP	1	
57	50329	RING RET 156 INT	1	
60	51462	BEARING 35X62X16 BALL THRUST	1	
64	71579	KIT, 16CC CYLINDER BLOCK ASSEMBLY	1	
65	50551	BEARING 30X52X13 BALL THRUST	1	
69	70723	ASSY, BLOCK 7 PISTON	1	
70	44371	WASHER .63 X 1.0 X .05 FLAT	1	
71	44145	RING RET 62 EXT	1	
72	52109	GEAR, 14T	1	
73	52150	SHAFT MOTOR	1	
74	51069	WASHER .71 X 1.16 X .04	1	
80	50132	WASHER .51 X 1.10 X .03 FLAT	2	
81	52110	GEAR, 45T	1	
82	52583	GEAR, 11T	1	
83	51083	JACK SHAFT (PIN)	1	
90	50859	RING, RETAINING 206 INTERNAL	1	
91	52108	GEAR, 54T	1	
92	53336	SPACER, .75 X 1.32 X .257	1	
93	72749	KIT, BEARING	1	
95	53656	BEARING 25.4X52X15 BALL 6205R-1	1	
96	53699	SEAL 1.0 X 2.06 X .38 LIP TC4	1	
97	71446	KIT, HUB 4 BOLT	1	
99	53768	NUT 3/4-16 HEX LOCK	1	
100	52766	PAWL, BRAKE	1	

Service Schematic

#	PART #	DESCRIPTION	QTY	Note
101	72046	KIT, BRAKE SHAFT	1	
102	53973	HANDLE, ACTUATING	1	
103	53019	RING RET 43 EXT KLIPRING	1	
105	50752	SCREW 1/4-20 X .75 HF	3	
106	53655	GUARD FILTER RH	1	
111	71393	KIT 1/2 BEADED 9/16 SAE FITTING	1	
130	54501	TUBE CHARGE TRIPLE O-RING	2	
131	50273	GEROTOR TANGX1.15X.39 (1.9CC)	1	
132	52250	O-RING -137 .103 X 2.050	1	
133	53738	HOUSING CHARGE PUMP	1	
134	50752	SCREW 1/4-20 X .75 HF	2	
140	54315	SPACER 0.320 ID X 1.005 OD X 0.1495 THK	1	
141	51945	ARM, NEUTRAL RIGHT	1	
142	51616	SHCS 5/16-24 X .875	1	
147	52401	SPRING EXT .63 X 2.05	1	
157	72291	KIT GEROTOR SEAL	1	
158	53501	CAP,AXLE	1	
164	53514	SPACER 1.719 X 2.039 X.021	1	
200	71410	KIT SEAL	1	
201	71561	KIT, CENTER SECTION RH, CHRG	1	[1]
202	71436	KIT, CHARGE RELIEF	1	[2]
203	72274	KIT CHARGE	1	[3]
209	72320	KIT HUB PULLER	1	
210	71442	KIT, INPUT SHAFT	1	[4]
211	71588	KIT, RTN, BIDIRECTIONAL	1	[5]
212	71569	KIT, SHAFT, AXLE	1	
215	72753	KIT, OUTBOARD RH ROT "A" / LH ROT "B"	1	

PART NOTES:

- [1] - CONTAIN ITEMS 20, 22, 24, 25, 26, 27, 135, 136, 137
- [2] - CONTAIN ITEMS 135, 136, 137
- [3] - CONTAIN ITEMS 131, 132, 133, 134
- [4] - CONTAIN ITEMS 52, 53, 54
- [5] - CONTAIN ITEMS 44, 46, 145

Fans, Pulleys, and Fan & Pulley Kits

NOTICE - PROPRIETARY INFORMATION: THIS SERVICE SCHEMATIC AND ITS CONTENTS ARE WHOLLY OWNED BY HYDRO-GEAR OF SULLIVAN, IL., AND MAY NOT BE PUBLISHED OR REPRODUCED WITHOUT THE WRITTEN CONSENT OF HYDRO-GEAR.

ZT-2800, ZT-3100 & ZT-3200 SERVICE SCHEMATIC

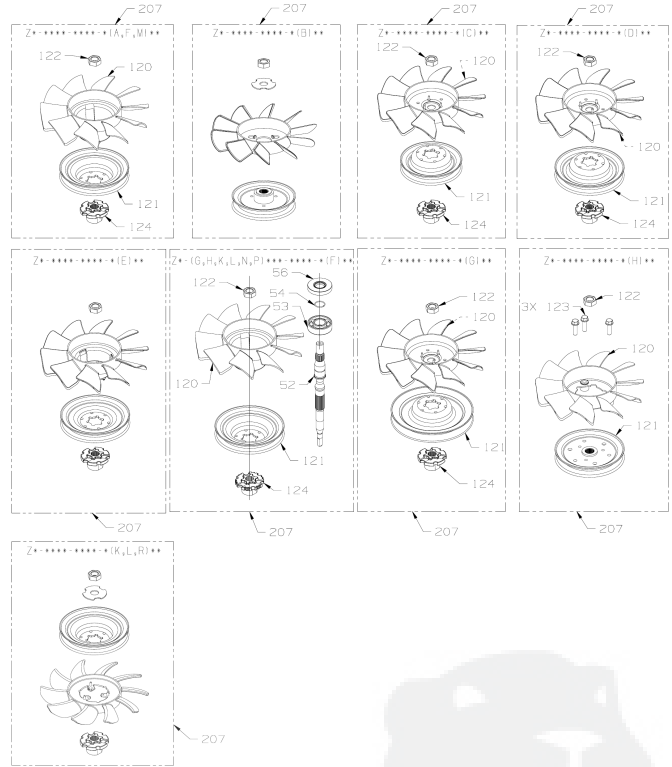

HYDRO-GEAR
P. 8 of 13 71370 P46

Fans, Pulleys, and Fan & Pulley Kits

#	PART #	DESCRIPTION	QTY	Note
207		N/A		

