

Service Schematic

NOTICE / Proprietary Information: This service schematic and its contents are wholly owned by Hydro-Gear of Sullivan, IL, and may not be published or reproduced without the written consent of Hydro-Gear.

EZT SERVICE DRAWING 1" AXLE

NOTES:

1. BRAKE AND CONTROL ARM CAN BE ON EITHER SIDE.
2. LH SIDE SHOWN. RH SIDE IS A MIRROR IMAGE.
3. 52-SEAL KIT, P/N 70853, CONTAINS THE FOLLOWING ITEMS:
SEALS: 10,13,20,33,51
RETAINING RINGS: 14,16,18,31,34,37,45

ITEMS NOT SHOWN

- 11 - OIL, 20W-50 (56oz)
- 58 - SEALANT TUBE

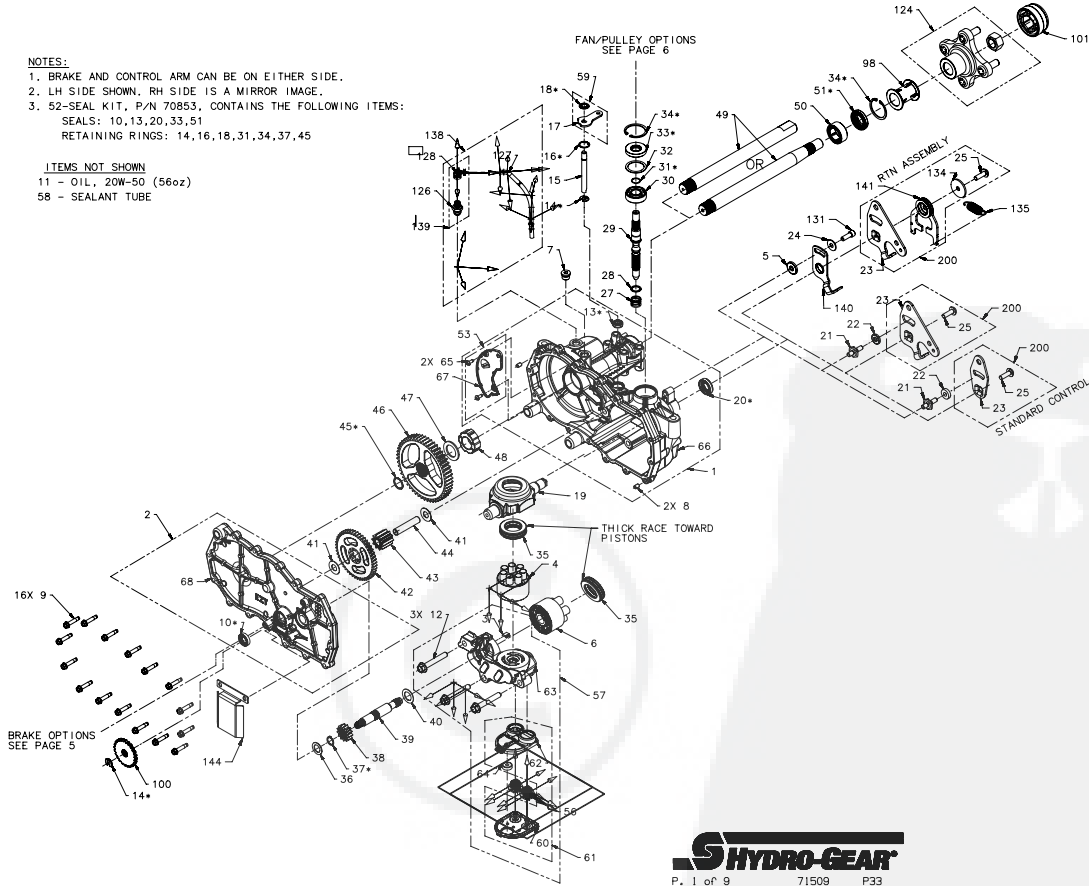

Service Schematic

#	PART #	DESCRIPTION	QTY	Note
1	70862R	KIT, MAIN HOUSING-RH	1	
2	70863R	KIT, SIDE HOUSING RH	1	
4	70723	ASSY, BLOCK 7 PISTON	1	
6	70331	KIT, BLOCK, 10CC CYLINDER	1	
7	9005110-5600	PLUG 9/16-18 METAL	1	
9	53246	SCREW 1/4-20 X 1.125 HEX WASHER	16	
15	51625	ROD BYPASS	1	
19	51048	TRUNNION, SWASHPLATE	1	
21	50426	STUD 5/16-24X1.5 SHORT	1	
22	52298	WASHER .31 X .80 X.21 PLASTIC	1	
27	2003014	SPRING, BLOCK	1	
28	2003017	WASHER .59 X .79 X .04	1	
29	51062	SHAFT INPUT	1	
30	50315	BEARING 17X40X12 BALL OPEN 6203	1	
32	50951	WASHER 1.23 X 1.57 X .04	1	
35	50551	BEARING 30X52X13 BALL THRUST	2	
36	44371	WASHER .63 X 1.0 X .05 FLAT	1	
37	44145	RING RET 62 EXT	1	
38	51130	GEAR, 13T PINNION	1	
39	51632	SHAFT MOTOR	1	
40	51069	WASHER .71 X 1.16 X .04	1	
41	50132	WASHER .51 X 1.10 X .03 FLAT	2	
42	51129	GEAR, 10T/48T	1	
43	51043	GEAR, 10T JACKSHAFT	1	
44	51083	JACK SHAFT (PIN)	1	
46	52541	GEAR, 52T BULL	1	
47	52532	WASHER 1.013 X 1.750 X .105 FLAT	1	
48	52542	SLEEVE BEARING (INBOARD)	1	
49	72182	KIT, AXLE, LONG	1	
50	51517	BUSHING 1.003X1.571X.625	1	
52	70853	KIT, SEALS AND RETAINING RINGS	1	
10		SEAL. LIP .625 X 1.000 X .250	1	
		SEAL. LIP .50 X .88 X .25	1	
13		SEAL. LIP .375 X .75 X .25	1	
14		RING RETAINING .375 EXT	2	
16		RING RETAINING .750 INT	1	
18		RING RETAINING .375 EXT (PUSHNUT)	1	
20		SEAL. LIP 18 X 32 X 7	1	
31		RING RETAINING WIRE .561 ID	1	
33		SEAL LIP 17 X 40 X 7	1	
34		RING RETAINING	2	
37		RING RETAINING	1	
45		RING SPIRAL RETAINING	1	
51		SEAL LIP 1.00 X 1.57 X .25	1	
		SEAL LIP .375 X .75 X .25	1	
53	70868R	KIT, EXPANSION PLATE RH	1	

Service Schematic

#	PART #	DESCRIPTION	QTY	Note
57	71530	KIT, CENTER SECTION W/ FILTER - RH	1	
		CENTER SECTION, RH, 7P	1	
		PLATE, BYPASS	1	
		BOLT, HEX FLANGE 3/8-24 X 2.5	3	
		ASSEMBLY, COVER	1	
		FILTER, BASE	1	
		MAGNET	1	
		CHECK PLUG ASSEMBLY, .027, WASHER	2	
58	50928	SEALANT TUBE	1	
59	71006	KIT, BYPASS ARM	1	
61	71497	KIT, FILTER	1	
		ASSEMBLY, COVER	1	
		FILTER, BASE	1	
		MAGNET	1	
98	53731	TUBE AXLE 1.835	1	
100	51635	DISC, COG BRAKE	1	
101	53088	CAP, AXLE	1	
124	72182	KIT, AXLE, LONG	1	
138	71510	KIT, BREATHER	1	
		ASSEMBLY, FITTING 9/16	1	
		HOSE, EXP TANK	1	
		CAP, BARBED VENT	1	
139	71524	KIT, BREATHER	1	
		CAP, BARBED VENT	1	
		ASSEMBLY, FITTING 9/16	1	
200	71633	KIT, CONTROL ARM	1	
209	71241	ASSEMBLY, HUB PULLER	1	

Brake Assembly

NOTICE / Proprietary Information: This service schematic and its contents are wholly owned by Hydro-Gear of Sullivan, IL, and may not be published or reproduced without the written consent of Hydro-Gear.

EZT SERVICE DRAWING
1" AXLE

MODEL NUMBER:
CHARACTER #:

Z	-	*	-	*	*	-	*	*	-	11	12	13	14
1	2	3	4	5	6	7	8	9	10				

COG BRAKE KITS

CHAR 3	CHAR 7	CHAR 8	ITEM #	COMPONENT #	DESCRIPTION	QTY
A, B	2	A, C, K, M	55	71069	KIT, BRAKE ARMW/CLEVIS PIN, LH	1
			(74)		ARM, BRAKE	1
			(70)		PIN, CLEVIS	1
			(71)		BOLT, 1/4-20X1 SHOULDER W/PATCH	1
			55	71070	KIT, BRAKE ARMW/CLEVIS PIN, RH	1
			(74)		ARM, BRAKE	1
		B, D, J, L	(70)		PIN, CLEVIS	1
			(71)		BOLT, 1/4-20X1 SHOULDER W/PATCH	1
			55	71069	KIT, BRAKE ARMW/CLEVIS PIN, LH	1
			(74)		ARM, BRAKE	1
			(70)		PIN, CLEVIS	1
			(71)		BOLT, 1/4-20X1 SHOULDER W/PATCH	1
D	B, D, J, L	55	71069	KIT, BRAKE ARMW/CLEVIS PIN, LH	1	
		(74)		ARM, BRAKE	1	
		(70)		PIN, CLEVIS	1	
		(71)		BOLT, 1/4-20X1 SHOULDER W/PATCH	1	
		55	71070	KIT, BRAKE ARMW/CLEVIS PIN, RH	1	
		(74)		ARM, BRAKE	1	
A, B, D	3	A, C, K, M	55	70885	KIT, BRAKE ARM, THROUGH HOLE	1
			(74)		ARM, BRAKE	1
		B, D, J, L	(71)		BOLT, 1/4-20X1 SHOULDER W/PATCH	1
			55	71356	KIT, BRAKE ARM W/ SPRING	1
			(74)		ARM, BRAKE	1
			(75)		SPRING, EXTENSION	1
A, B, D	4	A, C, K, M	55	71560	KIT, BRAKE ARM, TOP MOUNT	1
			(71)		SPACER	1
		B, D, J, L	(74)		ARM, BRAKE	1
			(73)		HFCS 1/4-20 X 2.0 (PATCH)	1

COG/MOTOR SHAFTS

CHAR 7	CHAR 8	ITEM #	COMPONENT #	DESCRIPTION	QTY	
2, 3, 4	A-D	39	51632	SHAFT, MOTOR	1	
		100	51635	DISC, COG BRAKE	1	
	J-M	39	51845	SHAFT, MOTOR	1	
		100	51635	DISC, COG BRAKE	1	
	X, B	J, Z	39	52580	SHAFT, MOTOR	1
		A	39	52579	SHAFT, MOTOR	1
5	W	39	51845	SHAFT, MOTOR	1	
		100	51635	DISC, COG BRAKE	1	

DISC BRAKE

CHAR 7	ITEM #	COMPONENT #	DESCRIPTION	QTY
B	55	71646	KIT, BRAKE	1
C	55	71892	KIT, BRAKE	1
D	55	71893	KIT, BRAKE	1
E	55	72082	KIT, BRAKE	1

KITS INCLUDE ITEMS: 73, 74, 75, 100, 150, 151, 153, 154, 155, 156, 157, 158, 159, 160

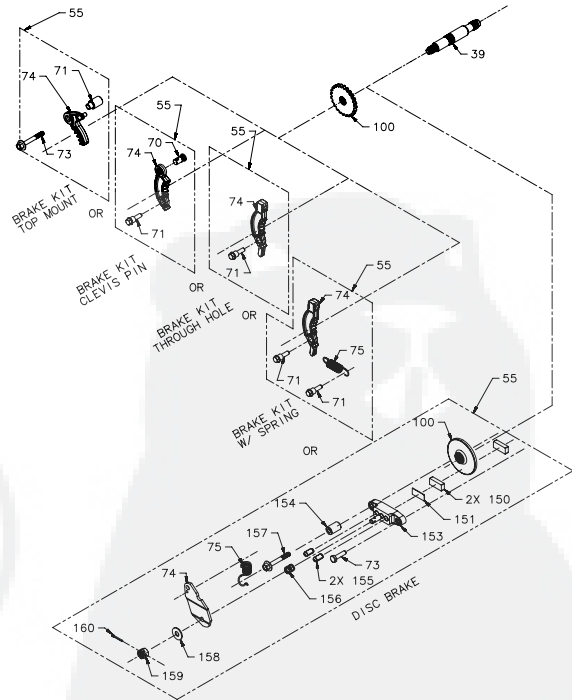

ZC-AHBB-3D5A-2CPX

Brake Assembly

#	PART #	DESCRIPTION	QTY	Note
39	51632	SHAFT MOTOR	1	
55	70865	KIT, BRAKE ARM	1	
(74)		ARM, BRAKE	1	
(71)		BOLT, 1/4-20X1 SHOULDER W/PATCH	1	
100	51635	DISC, COG BRAKE	1	

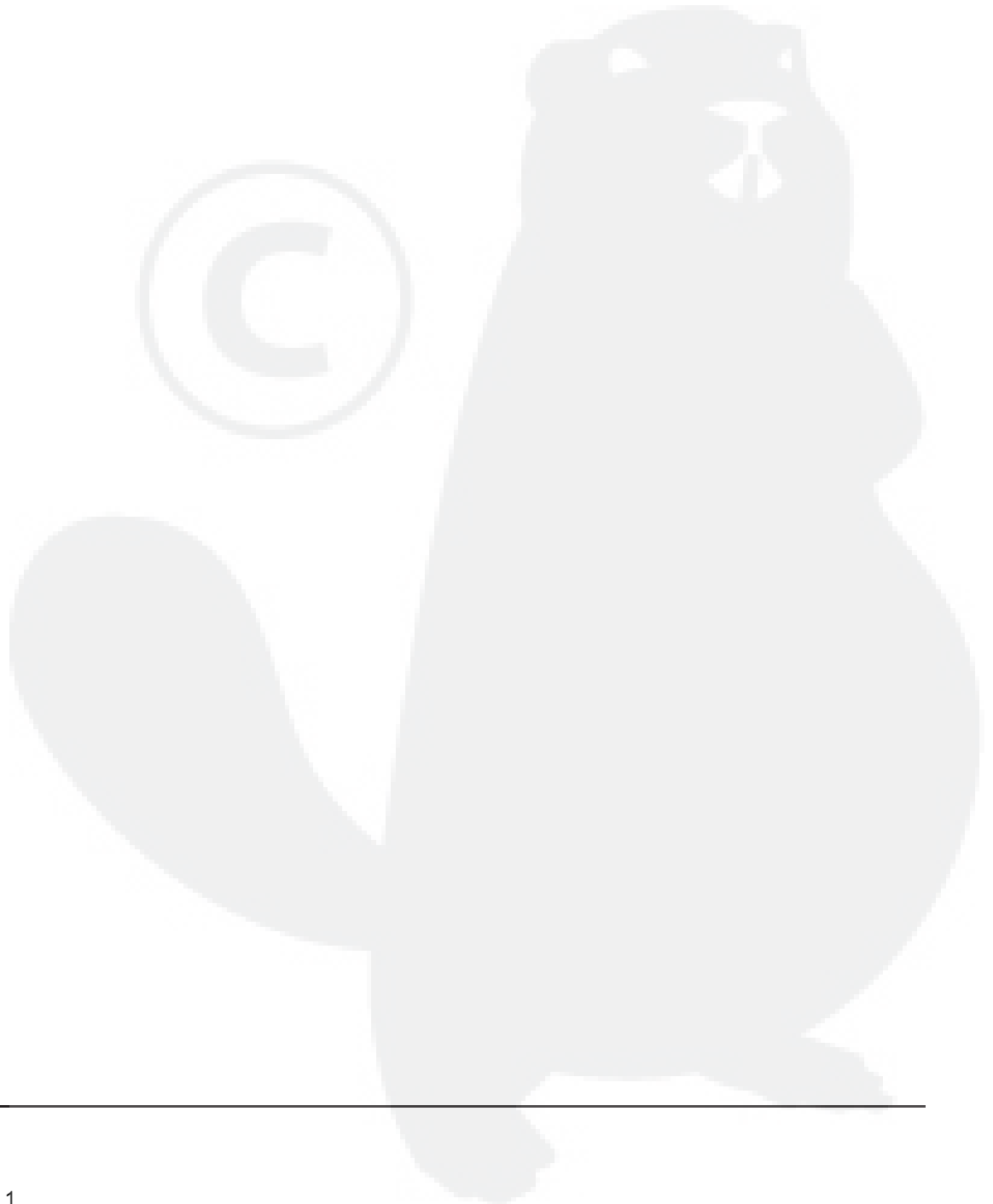
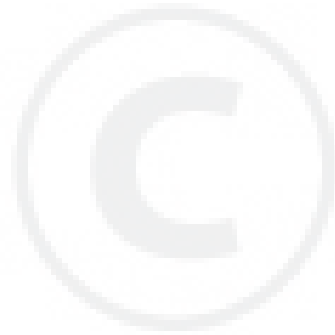

Brake Assembly

ZC-AHBB-3D5A-2CPX_1

Fans, Pulleys, and Fan & Pulley Kits

NOTICE / Proprietary Information: This service schematic and its contents are wholly owned by Hydro-Gear of Sullivan, IL, and may not be published or reproduced without the written consent of Hydro-Gear.

EZT SERVICE DRAWING
1" AXLE

MODEL NUMBER:
CHARACTER #:

Z		-									*					
1	2	-	3	4	5	6	-	7	8	9	10	-	11	12	13	14

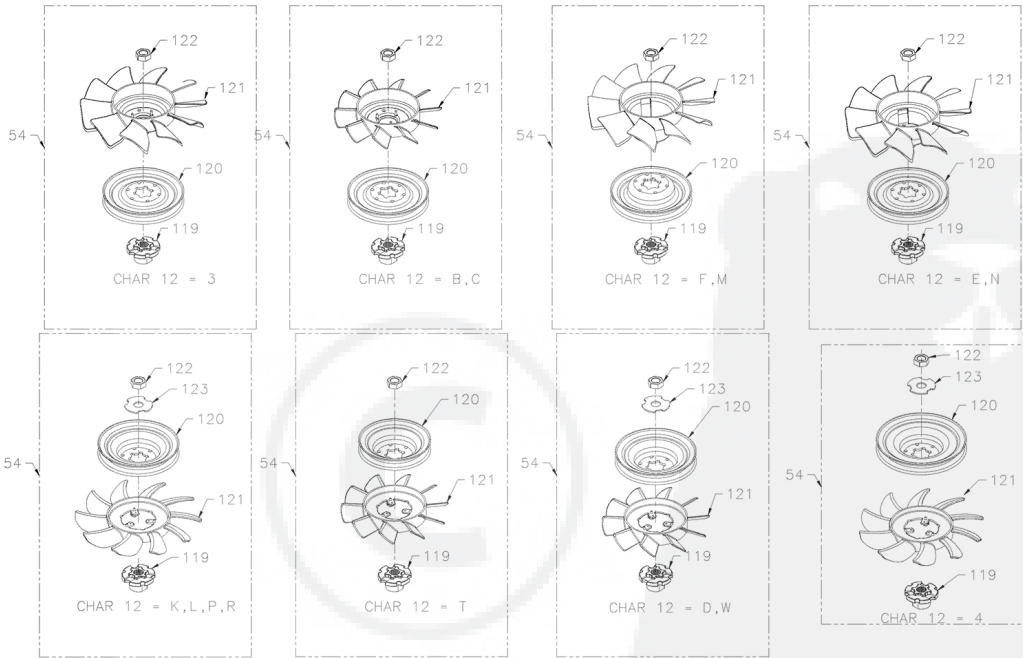

P. 7 of 9 71509 P33

Fans, Pulleys, and Fan & Pulley Kits

#	PART #	DESCRIPTION	QTY	Note
54	72128	KIT, FAN/PULLEY	1	[1]

PART NOTES:

[1] - Includes items: 119-122

