

310-0750

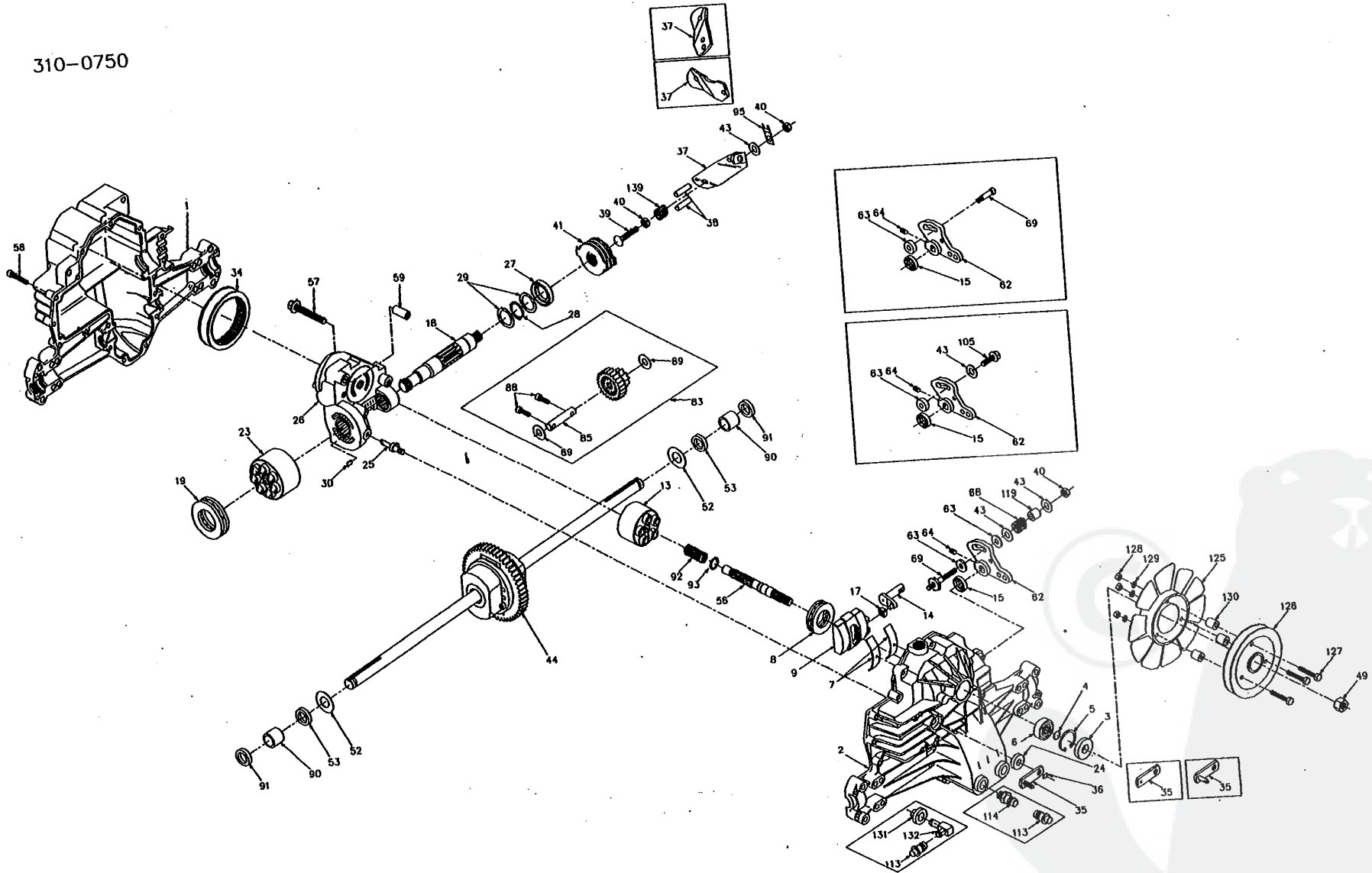

UNIT #	LOWER HSG	UPPER HSG ASSY	CENTER SECTION ASSY	BYPASS ARM	BRAKE ARM	DIFF. ASSY	INPUT SHAFT	BREATHER	CONTROL ARM	OEM CROSS REF NO.
312-0750	50074RM	70159	70214	50270	23710	70130	50005	70109,70110	50254	036273
313-0750	50074RM	70125	70214	50126	50130	70131	50005	NONE	45007	718-0255
318-0750	50074RM	70125	70214	44866	50131	70130	2003021	NONE	50400	83-3878
318-0750	50074RM	70125	70214	44866	23710	70130	50005	70109,50133,50308	50254	8350
318-0750	50074RM	70125	70214	50270	23710	70130	50005	70109,70110	50254	144436
320-0750	50074RM	70159	70214	50126	50438	70130	50005	70109,70110	NONE	K112211112
321-0750	50298	70125	70214	50126	50445	70130	50005	NONE	50254	321-0750
322-0750	50074RM	70125	70214	50126	50130	70130	50005	70109,70110	50254	47893800
325-0750	50074RM	70159	70214	50270	23710	70130	50005	70109,70110	45007	036488

ITEM NO.	HYDRO-GEAR PART NO.	DESCRIPTION
1	50074RM	LOWER HSG
	50298	
2	70125	UPPER HSG ASSEMBLY
	70159	
3	9008000-0128	LIP SEAL
4	2003018	WIRE RETAINING RING
5	2003052	RETAINING RING
6	2003043	SHAFT BALL BEARING
7	2003023	CRADLE BEARING
8	50551	THRUST BEARING 30 X 52 X 13
9	2003087	VARIABLE SWASHPLATE
13	70079	CYLINDER BLOCK ASSEMBLY
14	2003005	TRUNNION ARM
15	9008000-0128	LIP SEAL
17	2000015	SLOT GUIDE
18	50449	MOTOR SHAFT
19	50552	THRUST BEARING 42 X 68 X 18
23	70082	CYLINDER BLOCK ASSEMBLY
24	45074	LIP SEAL
25	2003555	BYPASS ACTUATOR
26	70214	CENTER SECTION ASSEMBLY
27	45075	LIP SEAL
28	50007	RETAINING RING
29	44872	WASHER
30	2003554	BYPASS PLATE
34	44864	OIL FILTER ELEMENT
35	44866	BYPASS ARM
	50126	
	50270	
36	44870	RETAINING RING
37	23710	BRAKE ARM
	50130	
	50131	
	50438	
	50445	
38	44891	ACTUATING PIN
39	50318	BOLT-5/16-24 X 1-3/4
40	50317	HEX LOCK NUT 5/16-24
41	70135	BRAKE ROTOR/STATOR ASSEMBLY
43	44130	WASHER-7/16 X 7/8 X .060
44	70130	DIFFERENTIAL ASSEMBLY
	70131	
49	44133	NUT, 1/4-20 HEX HEAD JAM
52	50152	WASHER-3/4 X 1.5 X .03
53	45076	SEAL-.75 X 1.25 X .250

ITEM NO.	HYDRO-GEAR PART NO.	DESCRIPTION
56	2003021	INPUT SHAFT
	50005	
57	50018	BOLT, 3/4-24 X 2.5
58	44876	TORX HEAD CAP SCREW
59	50002	PIN
62	45007	CONTROL ARM
	50254	
	50400	
63	50034	DAMPENER PUCK
	50281	
	50156	SPACER
64	50018	SET SCREW
65	44123	BOLT, 1/4-20 X 1.38
68	50277	SPRING
69	50284	5/16-24 STUD
	50428	5/16-24 STUD
83	70132	JACK SHAFT/PINION GEAR ASSEMBLY
85	50559	JACK SHAFT
88	50154	LEVELER
89	50132	LEVELER SPRING
90	50118	PULLEY
91	50119	SEAL-WIPER
92	2003014	BLOCK SPRING
93	2003017	BLOCK THRUST WASHER
105	50282	FLANGE HEAD SCREW, 5/16-24 X 1
113	70109	CAP-VENT ASSEMBLY
114	70110	FITTING-O RING ASSEMBLY
119	50278	SPACER
124	9005110-5600	PLUG, STRAIGHT THREAD
125	50307	FAN
126	50302	PULLEY
127	44276	SCREW, 1/4-20 X 1-1/2
128	43178	NUT, 1/4-20
129	43177	LOCK WASHER
130	50259	SPACER
131	50133	VENT-BUSHING
132	50308	METAL VENT
134	44142	SLOTTED NUT
135	44101	COTTER PIN
136	50384	EXTENSION SPRING
137	50383	DRIVE PIN
138	23770	SPACER
139	50431	COMPRESSION SPRING
140	50289	HEX, NUT 5/16-24