

# PN6200爆炸图

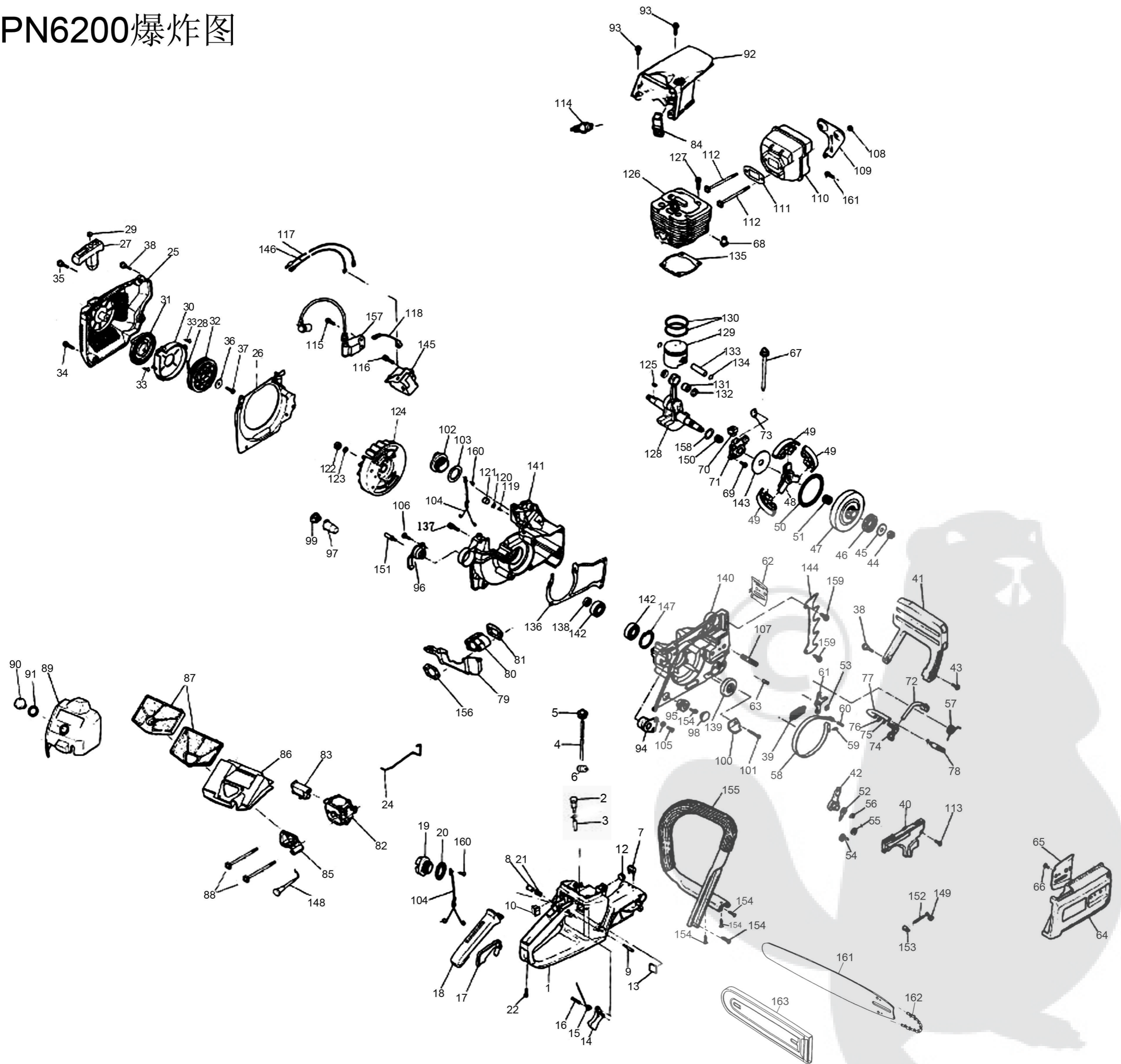

PN6200		
REF	Description	qty
PN6200-1	FUEL TANK ASSY	1
PN6200-2	balancer	1
PN6200-3	hose-balancer	1
PN6200-4	hose-fuel	1
PN6200-5	PAD-HOSE FUEL	1
PN6200-6	FUEL FILTER	1
PN6200-7	BUMPER-RUBBER (FRONT)	1
PN6200-8	BUTTON-THROTTLE ADVANCE	1
PN6200-9	LATCH-TRIGGER	1
PN6200-10	SWITCH	1
PN6200-11	PIN-SWITCH	1
PN6200-12	PAD BUMPER-RUBBER	1
PN6200-13	PAD	1
PN6200-14	TRIGGER	1
PN6200-15	SPRING-TRIGGER	1
PN6200-16	PIN-TRIGGER	1
PN6200-17	LEVER-SAFETY TRIGGER	1
PN6200-18	COVER-REAR HANDLE	1
PN6200-19	FUEL CAP	1
PN6200-20	GASKET FUEL CAP	1
PN6200-21	SPRING-THROTTLE ADVANCE	1
PN6200-22	SCREW ST4.8*19	1
PN6200-23	RETAINER SWITCH	1
PN6200-24	ROD-THROTTLE	1
PN6200-25	HOUSING-STARTER	1
PN6200-26	BAFFLE-FAN	1
PN6200-27	HANDLE-STARTER	1
PN6200-28	ROPE-STARTER	1
PN6200-29	WASHER-ROPE STARTER	1
PN6200-30	SPRING-STARTER CASE	1
PN6200-31	SPRING STARTER	1
PN6200-32	PULLEY STARTER	1
PN6200-33	SCREW ST2.9*9.5	2
PN6200-34	SCREW M5*14	2
PN6200-35	SCREW M5*20	1
PN6200-36	GASKET- PULLEY STARTER	1
PN6200-37	SCREW ST4.8*16	1
PN6200-38		1
PN6200-39	SPRING - BRAKE	1
PN6200-40	COVER-SPRING BRAKE	1

PN6200-41	LEVER-CHAIN BRAKE	1
PN6200-42	PLATE-BARKE	1
PN6200-43	SCREW M5*14	1
PN6200-44	SCREW M8*1	1
PN6200-45	GASKET-CLUTCH	1
PN6200-46	SPROKET	1
PN6200-47	DRUM-CLUTCH	1
PN6200-48	HOLDING-CLUTCH	1
PN6200-49	CLUTCH	3
PN6200-50	SPRING CLUTCH	1
PN6200-51	NEEDLE BEARING BALL -CLUTCH	1
PN6200-52	DRIVE SHAFT	1
PN6200-53	SPRING	2
PN6200-54	PIN	1
PN6200-55	GROMMET-PIN	1
PN6200-56	SPRING	1
PN6200-57	SPRING-BRAKE LEVER	1
PN6200-58	BAND-BRAKE	1
PN6200-59	PIN-BRAKE	1
PN6200-60	PIN-BAND BRAKE	1
PN6200-61	LEVERAGE-BRAKE	1
PN6200-62	GASKET-BAR	1
PN6200-63	SCREW M4*10	1
PN6200-64	BRAKE HOUSING	1
PN6200-65	PLATE-BAR	1
PN6200-66	SCREW ST4.2*9.5	1
PN6200-67	OIL-LEVER AJUSTOR	1
PN6200-68	RUBBER -LEVER AJUSTOR	1
PN6200-69	SCREW M5*20	3
PN6200-70	PAD-OIL PUMP	1
PN6200-71	OIL PUMP	1
PN6200-72	HOSE-OIL OUTLET	1
PN6200-73	GASKET-OIL PUMP	1
PN6200-74	CONNECTOR-OIL OUTLET	1
PN6200-75	CONNECTOR-OIL INTLET	1
PN6200-76	“O“ RING GASKET	1
PN6200-77	HOSE-OIL INLET	1
PN6200-78	OIL FILTER	1
PN6200-79	SUPPORT CARBURETOR	1
PN6200-80	BOOT-INTAKE	1
PN6200-81	GASKET-INTAKE	1
PN6200-82	CARBURETOR	1
PN6200-83	LH GROMMET-OUTER	1

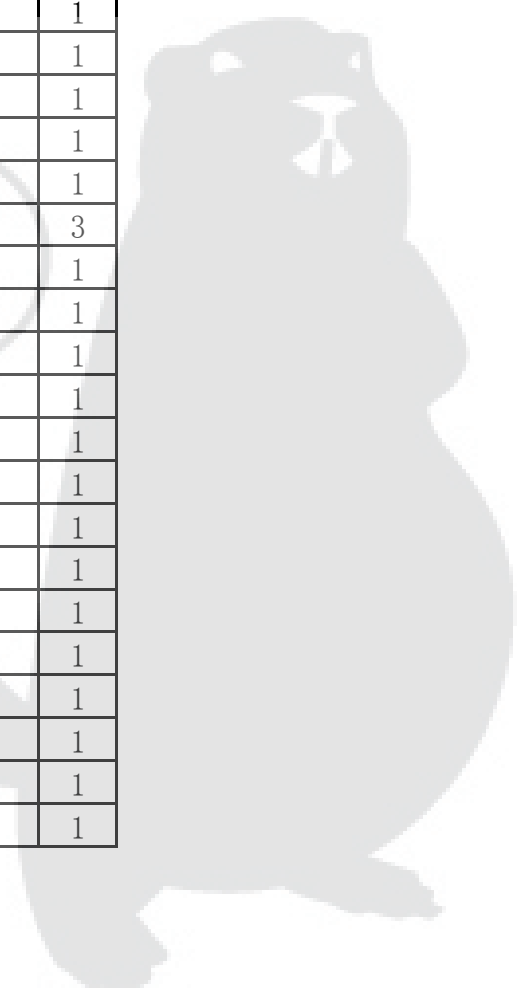

PN6200-84	COVER-AIR INLET	1
PN6200-85	GROMMET-INTER	1
PN6200-86	AIR FILTER CASE	1
PN6200-87	AIR FILTER	1
PN6200-88	BOLT-CARBURETOR	1
PN6200-89	TOP COVER-AIR FILTER	1
PN6200-90	KNOB-AIR FILTER	1
PN6200-91	GASKET-AIR FILTER	1
PN6200-92	TOP COVER	1
PN6200-93	SCREW M5*14	3
PN6200-94	RIGHT BUMPER-RUBBER (BIG)	1
PN6200-95	BUMPER-RUBBER (SMALL)	1
PN6200-96	LEFT BUMPER-RUBBER (BIG)	1
PN6200-97	BUMPER-RUBBER (LONG)	1
PN6200-98	PLUG-PAD	1
PN6200-99	LOCK PLUG-PAD	2
PN6200-100	PAD-CATCHER	1
PN6200-101	SCREW	1
PN6200-102	OIL CAP	1
PN6200-103	GASKET-OIL CAP	1
PN6200-104	HOLDING-OIL CAP	1
PN6200-105	SCREW M5*10	2
PN6200-106	SCREW M5*12	2
PN6200-107	BOLT	2
PN6200-108	NUT M5	2
PN6200-109	SHIELD-MUFFLER	1
PN6200-110	MUFFLER	1
PN6200-111	GASKET-MUFFLER	1
PN6200-112	BOLT	2
PN6200-113	SCREW M5*14	2
PN6200-114	SPARK PLUG	1
PN6200-115	SCREW M4*16	2
PN6200-116	SCREW M5*15	2
PN6200-117	WIRE-SWITCH	2
PN6200-118	WIRE	1
PN6200-119	VENT-OIL TANK	1
PN6200-120	SPONGE-VENT	1
PN6200-121	SPRING-VENT	1
PN6200-122	SCREW M10*1	1
PN6200-123	GASKET	1
PN6200-124	FLY WHEEL	1
PN6200-125	KEY -FLYWHEEL	1
PN6200-126	CYLINDER	1

PN6200-127	SCREW M5*20	4
PN6200-128	CRANK SHAFT ASSY	1
PN6200-129	PISTON	1
PN6200-130	PISTON RING	2
PN6200-131	NEEDLE BEARING BALL 11X15X12.	1
PN6200-132	WASHER-SPACER PISTON	2
PN6200-133	PIN-PISTON	1
PN6200-134	RING-SNAP	2
PN6200-135	GASKET-CYLINDER	1
PN6200-136	GASKET-CRANK CASE	1
PN6200-137	SCREW M5*20	5
PN6200-138	SEAL OIL LEFT	1
PN6200-139	SEAL OIL RIGHT	1
PN6200-140	LEFT CRANK CASE	1
PN6200-141	RIGHT CRANK CASE	1
PN6200-142	BEARING BALL 6202	2
PN6200-143	RING-CLUTCH	1
PN6200-144	SPIKE	1
PN6200-145	ELECTRIC IGNITION	1
PN6200-146	WIRE-IGNITION	1
PN6200-147	RING-SNAP	1
PN6200-148	CHOKE KNOB	1
PN6200-149	TOOTH CHAIN ADJUSTING	1
PN6200-150	GEAR WORM	1
PN6200-151	SCREW M6*14	2
PN6200-152	BOLT CHAIN ADJUSTING	1
PN6200-153	SPROCKET-CHAIN ADJUSTING	1
PN6200-154	SCREW ST4.8*16	5
PN6200-155	HANDLE-FRONT	1
PN6200-156	GASKET-CARBURETOR	1
PN6200-157	WIRE	1
PN6200-161	BAR	1

