

No.11

Group: Trimmers/Brushcutters

Model: SRM-4605

Section: Gear Case (Loop Handle Type), Nylon Line Cutting Head (11)

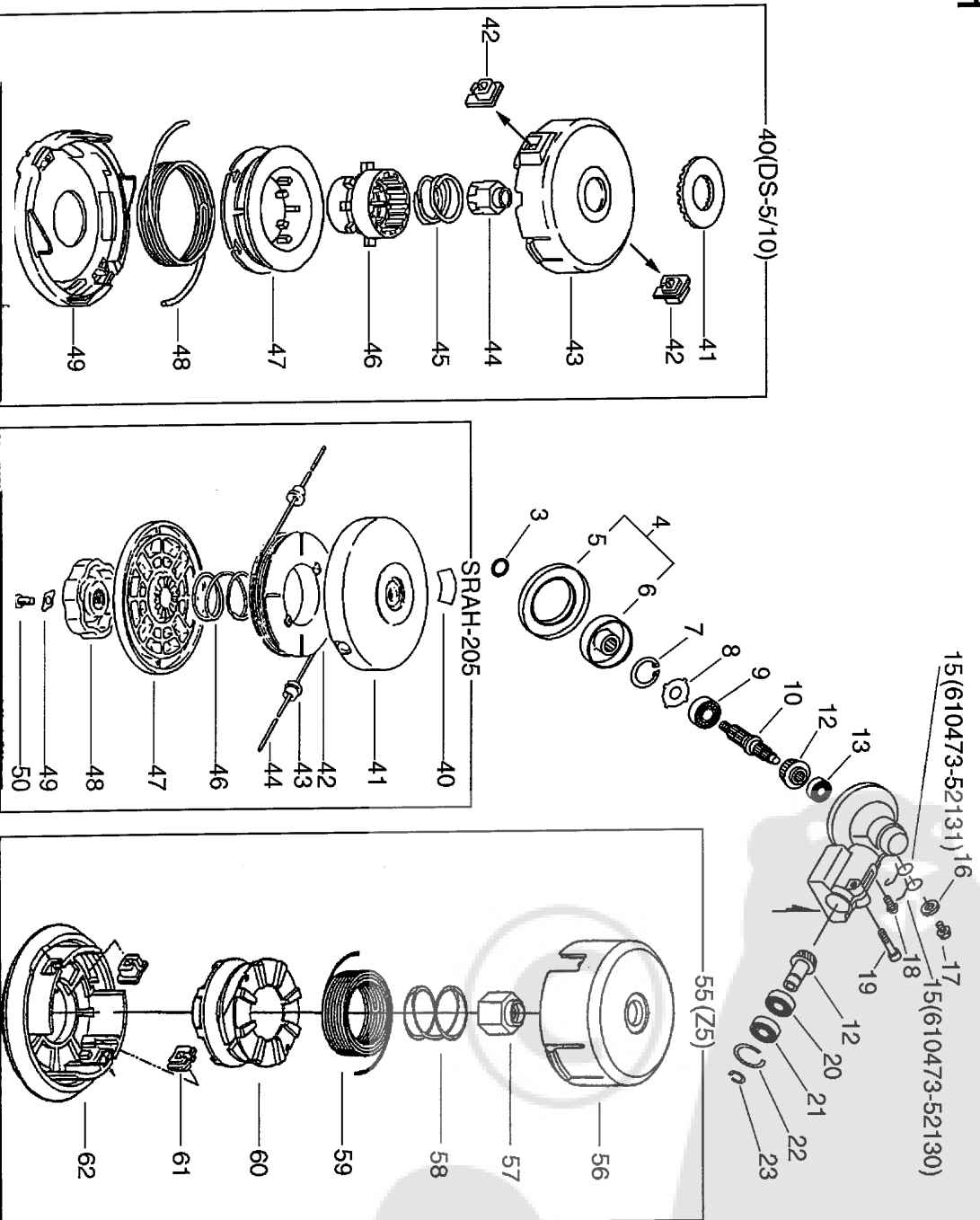

X047000230

X047000331

P a r t s L i s t

Group: Trimmers/Brushcutters Model: SRW-4605 Section: Gear Case (Loop Handle Type), Nylon Line Cutting Head(11)

Date: 5-10-2011 Page: 1

Key	Lv	Part Number	Qty	Description	Remarks	Note
3		900720-00012	1	O-RING 12		
4		610313-52930	1	PLATE, ADAPTER (U)	Sus. by C535-000001	
4		C535-000000	1	FIXTURE, BRAD	Sus. by C535-000001	
4		C535-000001	1	FIXTURE, BRAD		
5 +		610352-56830	1	PLATE, CUP		
6 +		C535-000010	1	FIXTURE, BRAD	Sus. by C535-000011	
6 +		C535-000011	1	FIXTURE, BRAD		
7		900702-00032	1	CIRCLIP 32		
8		610444-56830	1	WASHER		
9		900812-06201	1	BEARING, BALL 6201		
10		610310-56930	1	SHAFT, P.T.O.		
12		610300-56930	1	GEAR SET		
13		900810-00629	1	BEARING, BALL 629		
15		610473-52130	1	SPRING, TORSION	Drive Shaft Sr/Nr 024886 and before	
15		610473-52131	1	SPRING, TORSION	Drive Shaft Sr/Nr 024887 and after	
16		900603-50008	1	WASHER		
17		610434-50030	1	BOLT 8* 6	Sus. by 610434-50031	
17		610434-50031	1	BOLT 8* 8		
18		900242-05010	1	SCREW 5*10		
19		900162-06030	1	BOLT, H.S. 6*30		
20		900800-06001	1	BEARING, BALL 6001		
21		900807-06001	1	BEARING, BALL 6001	Drive Shaft Sr/Nr 024886 and before	
21		900803-06001	1	BEARING, BALL 6001	Drive Shaft Sr/Nr 024887 and after	
22		900702-00028	1	CIRCLIP 28		
23		900701-00012	1	CIRCLIP 12		
40		890617-46730	1	LABEL, CAUTION	Drive Shaft Sr/Nr 047087 and before	
41		696210-56930	1	DRUM, REEL	Drive Shaft Sr/Nr 047087 and before	
42		696214-06830	1	REEL, CORD	Drive Shaft Sr/Nr 047087 and before	

P a r t s L i s t

Group: Trimmers/Brushcutters Model: SRM-4605 Section: Gear Case (Loop Handle Type), Nylon Line Cutting Head(11)

Date: 5-10-2011 Page: 2

Key	Lv	Part Number	Q'ty	Description	Remarks	Note
43		696212-06032	2	EYELET	Drive Shaft Sr/Nr 047087 and before	
44		696215-22830	2	CORR, NYLON(2.4*2.5)	Drive Shaft Sr/Nr 047087 and before	
46		696216-06030	1	SPRING	Drive Shaft Sr/Nr 047087 and before	
47		696206-28232	1	COVER, DRUM (BL)	Drive Shaft Sr/Nr 047087 and before	
48		696219-28231	1	NUT (BL)	Drive Shaft Sr/Nr 047087 and before	
49		696220-06030	1	STOPPER, NUT	Drive Shaft Sr/Nr 047087 and before	
50		900220-06010	1	SCREW 6*10	Drive Shaft Sr/Nr 047087 and before	
40		X047-000070	1	CUTTER, ASM LINE	Sus. by X047-000330	
40		X047-000220	1	CUTTER, ASM LINE	Sus. by X047-000330	
41		V332-000000	1	WASHER, CIRCULAR 24	Drive Shaft Sr/Nr 047088 and after	
42		P022-000710	2	EYELET	Drive Shaft Sr/Nr 047088 and after	
43		X470-000000	1	DRUM, REEL	Sus. by P022-005040	
43		P022-005040	1	HOUSING	Drive Shaft Sr/Nr 047088 and after	
44		P022-001160	1	NUT	Drive Shaft Sr/Nr 047088 and after	
45		P022-001200	1	SPRING	Drive Shaft Sr/Nr 047088 and after	
46		P022-001310	1	TAP KNOB	Drive Shaft Sr/Nr 047088 and after	
47		P022-001180	1	BOBBIN	Drive Shaft Sr/Nr 047088 and after	
48		P022-000730	1	NYLON CODE	Sus. by P022-006200	
48		P022-006200	1	NYLON CODE	Drive Shaft Sr/Nr 047088 and after	
49		P022-001190	1	COVER	Sus. by P022-005030	
49		P022-005030	1	COVER	Drive Shaft Sr/Nr 047088 and after	
55		X047-000330	1	CUTTER, ASM LINE		
56		P022-010420	1	HOUSING		
57		P022-010390	1	NUT		
58		P022-010370	1	SPRING		
59		P022-010380	1	NYLON CODE		
60		P022-010400	1	BOBBIN		
61		P022-000710	2	EYELET		

