

# 80LB TOW-BEHIND SPREADER

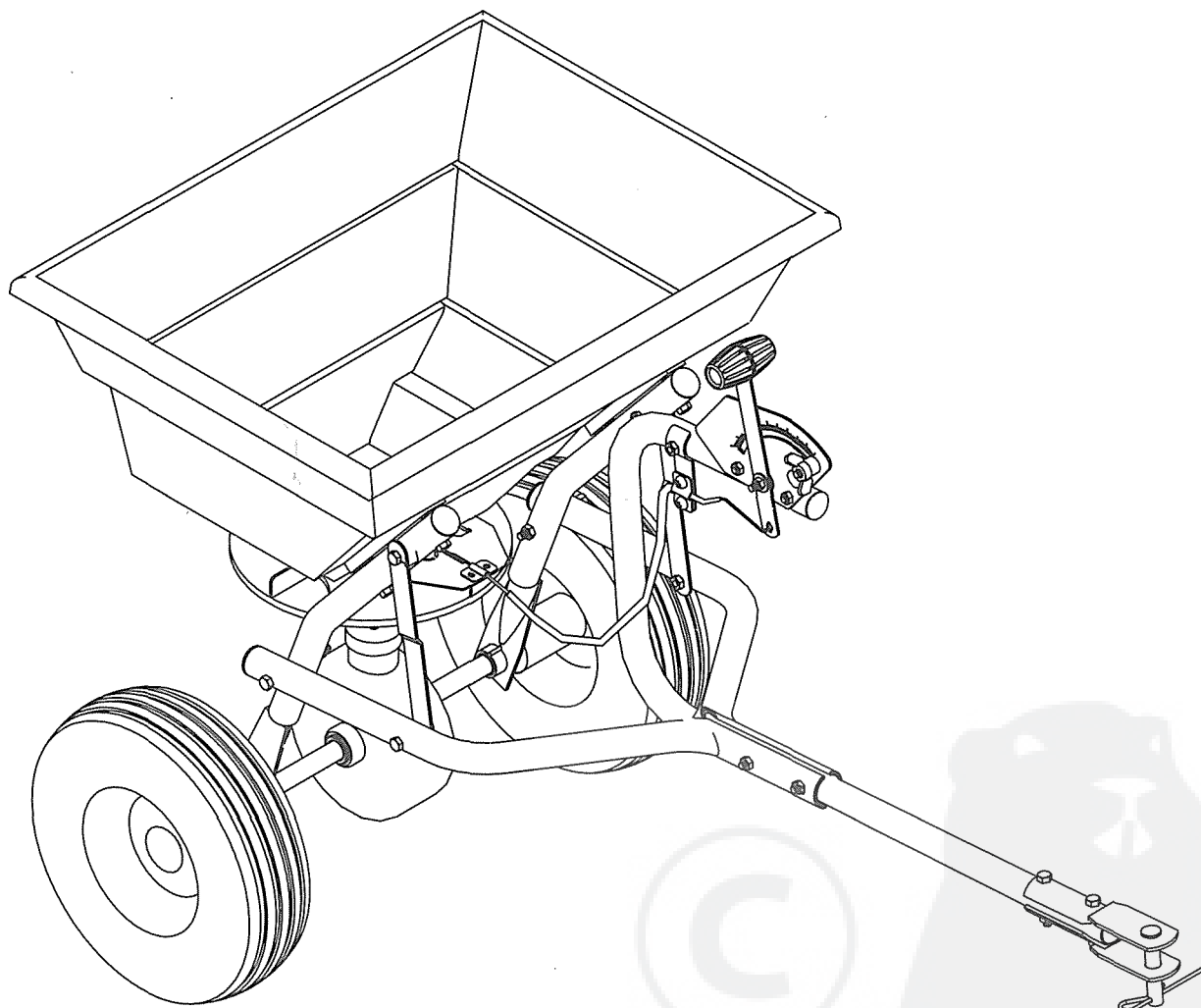

**ASSEMBLY AND OPERATION INSTRUCTION**

## 1. SAFETY RULES

### READ THE DIRECTIONS BEFORE ASSEMBLY

- Read the towing vehicle owners manual and towing vehicle safety rules. Know how to operate your tractor before using the tow-behind spreader.
- Read the chemical label instructions and cautions for handling and applying the chemicals purchased for spreading.
- Wear eye and hand protection when handling and when applying lawn or garden chemicals.
- Never operate tractor and spreader attachment without wearing substantial footwear, and do not allow anyone to ride or sit on spreader attachment frame.
- Never allow children to operate the tractor or spreader attachment, and do not allow adults to operate without proper instructions.
- Always begin with the transmission in first (low) gear and with the engine at low speed, and gradually increase speed as conditions permit.
- When towing spreader do not drive too close to a creek or ditch and be alert for holes and ether hazards which could cause you to loose control of the spreader and tractor.
- Before operating vehicle on any grade (hill) refer to the safety rules in the vehicle owner's manual concerning safe operation on slopes. Stay off steep slopes!

## 2. Remove and identify loose parts from carton and bag.

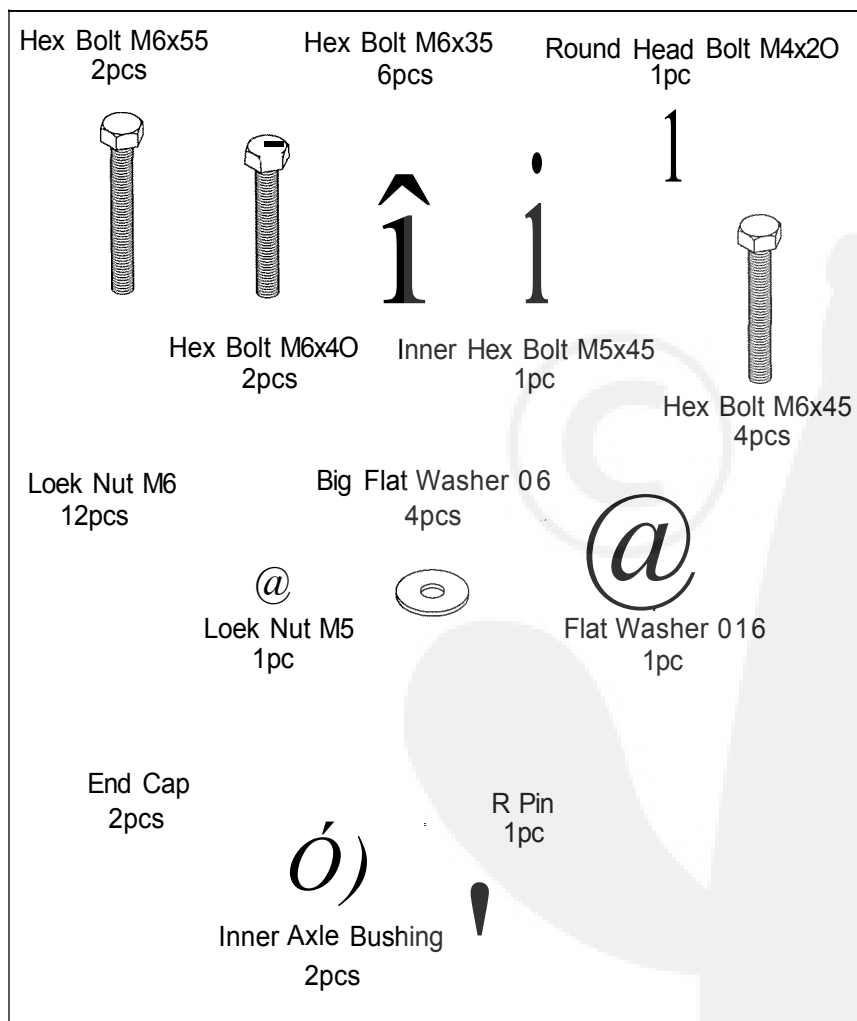

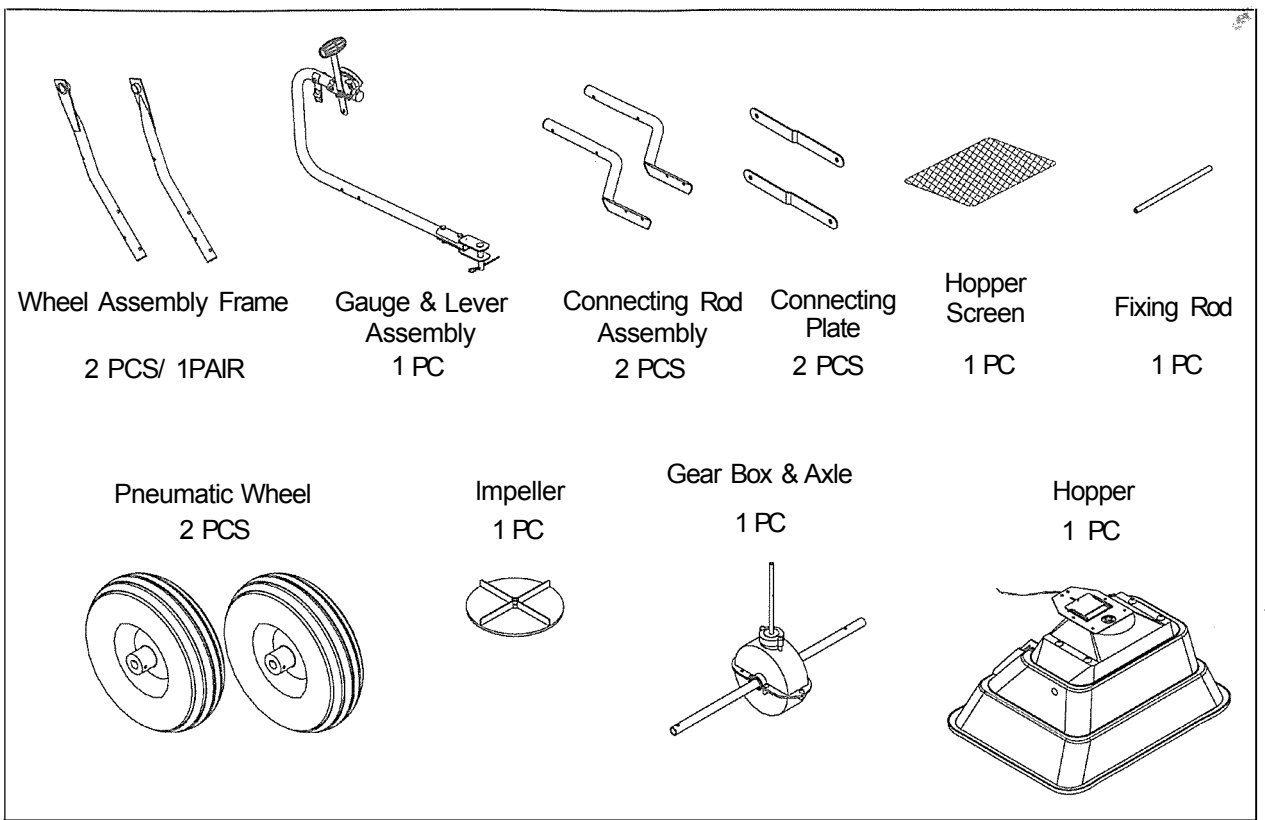

**STEP1 :** Install Impeller onto the Gear Box & Axle Assembly. Insert Round Head Bolt M4x20 through impeller then through Gear Box Axle.

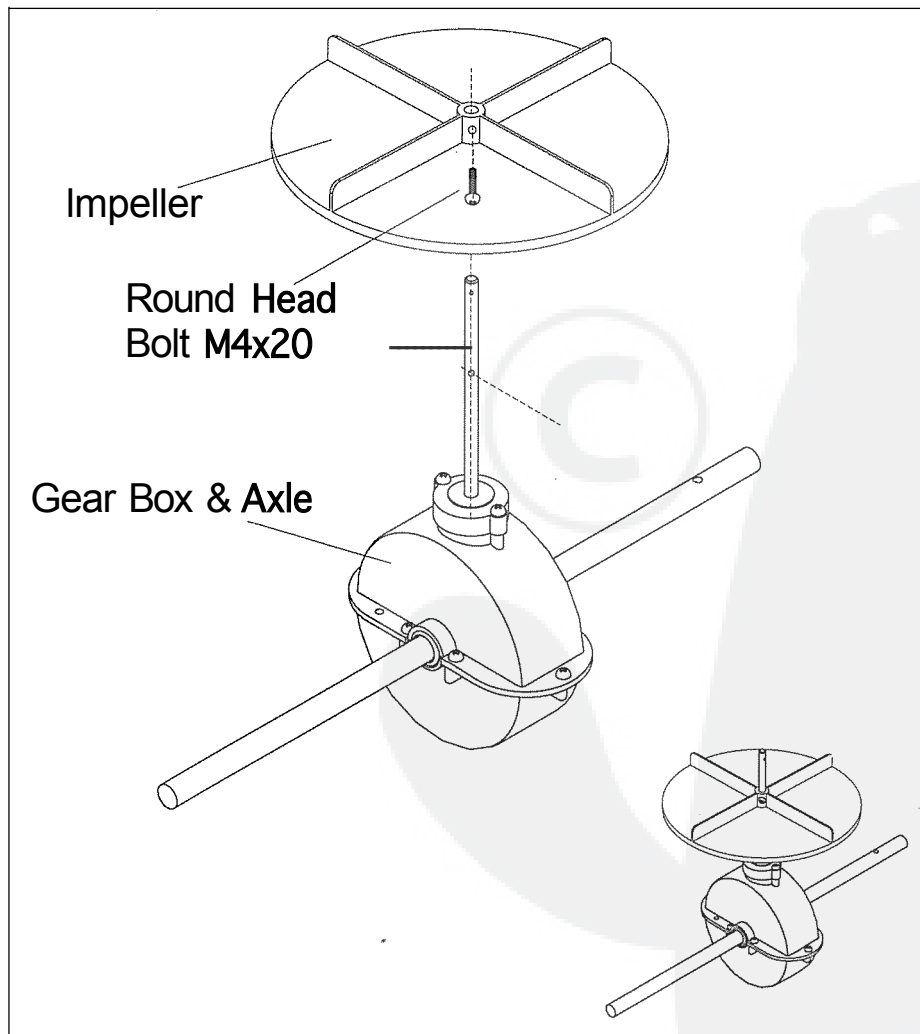

**STEP 2** Attach the Wheel Assembly Frame on each side of the Gear Box Axle and Fixing Connecting Rod, insert two balts M6x35 into the Fixing Connecting Rod through Wheel Assembly Frame. Make sure the hole on Axle of Gear Box is to be on the right side when assembly as shown. Attach Wheel Assembly Frames and Support Leg onto Hopper using balts M6x45, loek nuts M6 and Big Flat Washers 06. Note: The balts and nuts needn't be tightened yet.

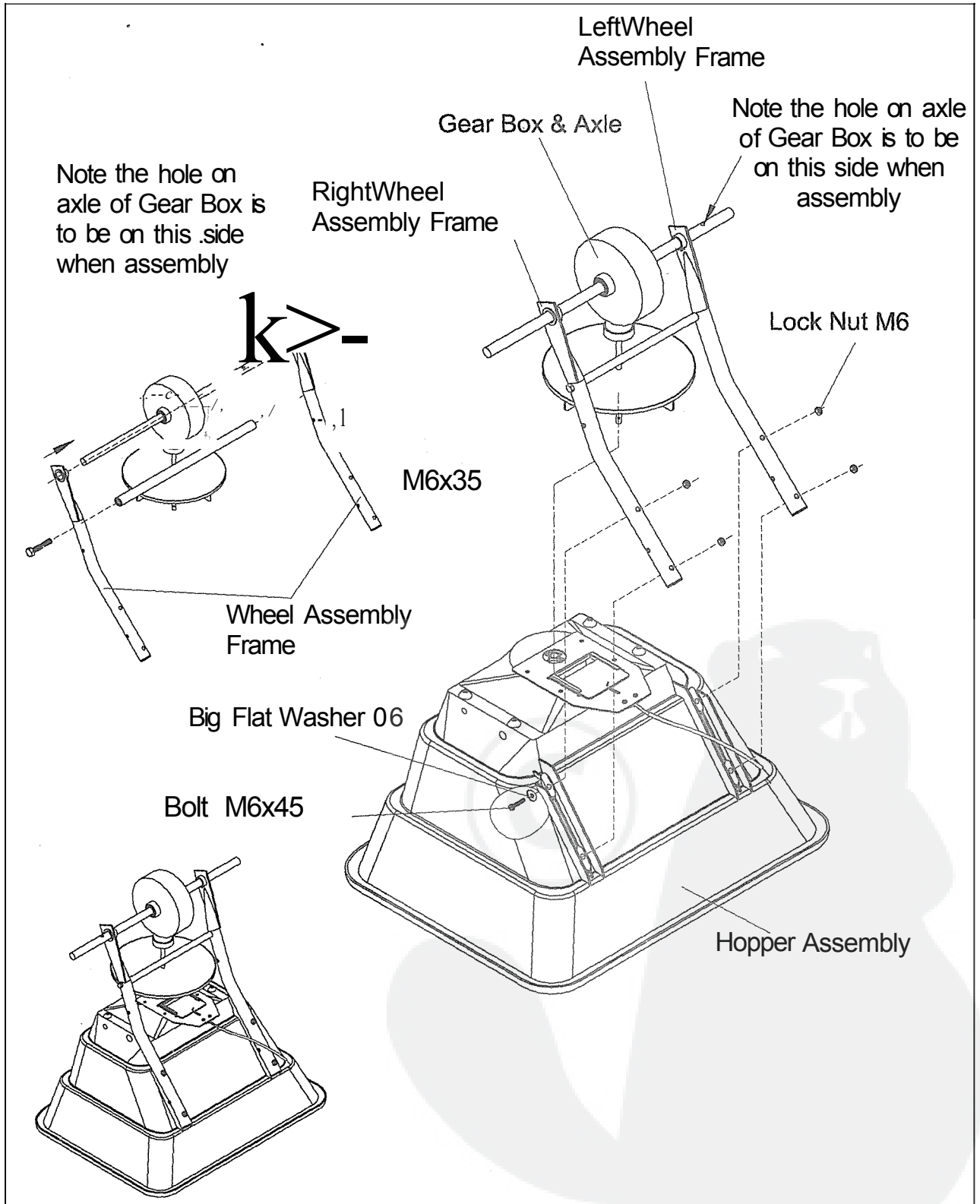

**STEP3:** Install one end of the connecting plate on the wheel frame by Bolt M6x35 and Lock Nut M6. Then install the connecting rod on the wheel frame by Bolt M6x55 and Lock Nut M6 and fix the connecting plate with connecting rod by Bolt M6x35. Note: The Bolt and Nuts needn't be tightened.

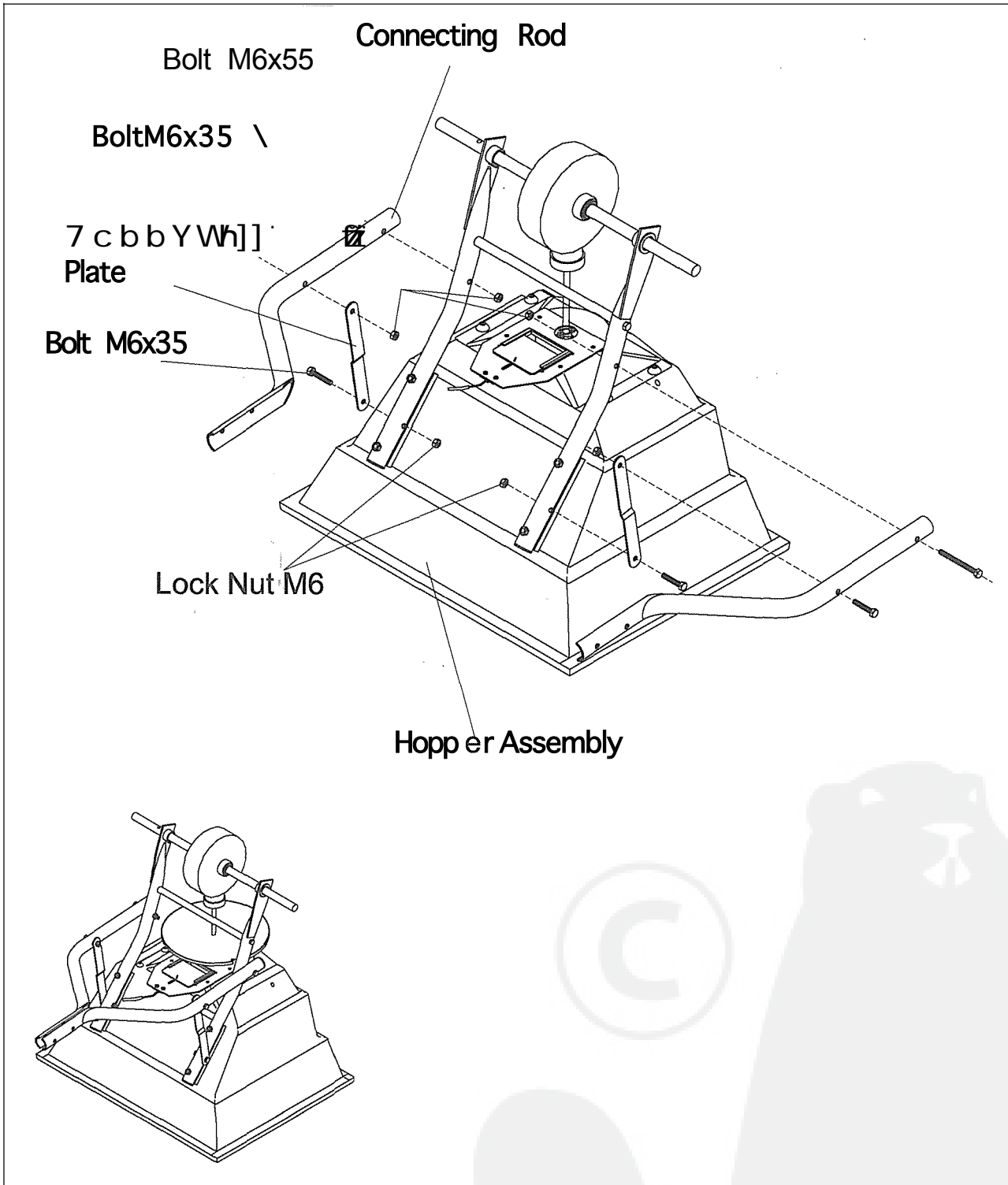

STEP 4: Insert Inner Axle Bushing into Outer Axle Bushing and make sure they are tight neatly. Install right Wheel Assembly to right Axle using inner hex bolt M5x45 and loek nut M5, and then install the Cap onto right Axle using a wooden or rubber hammer. Now install left Wheel Assembly to left Axle, put a flat washer 016 and install the Cap onto left Axle using a wooden or rubber hammer.

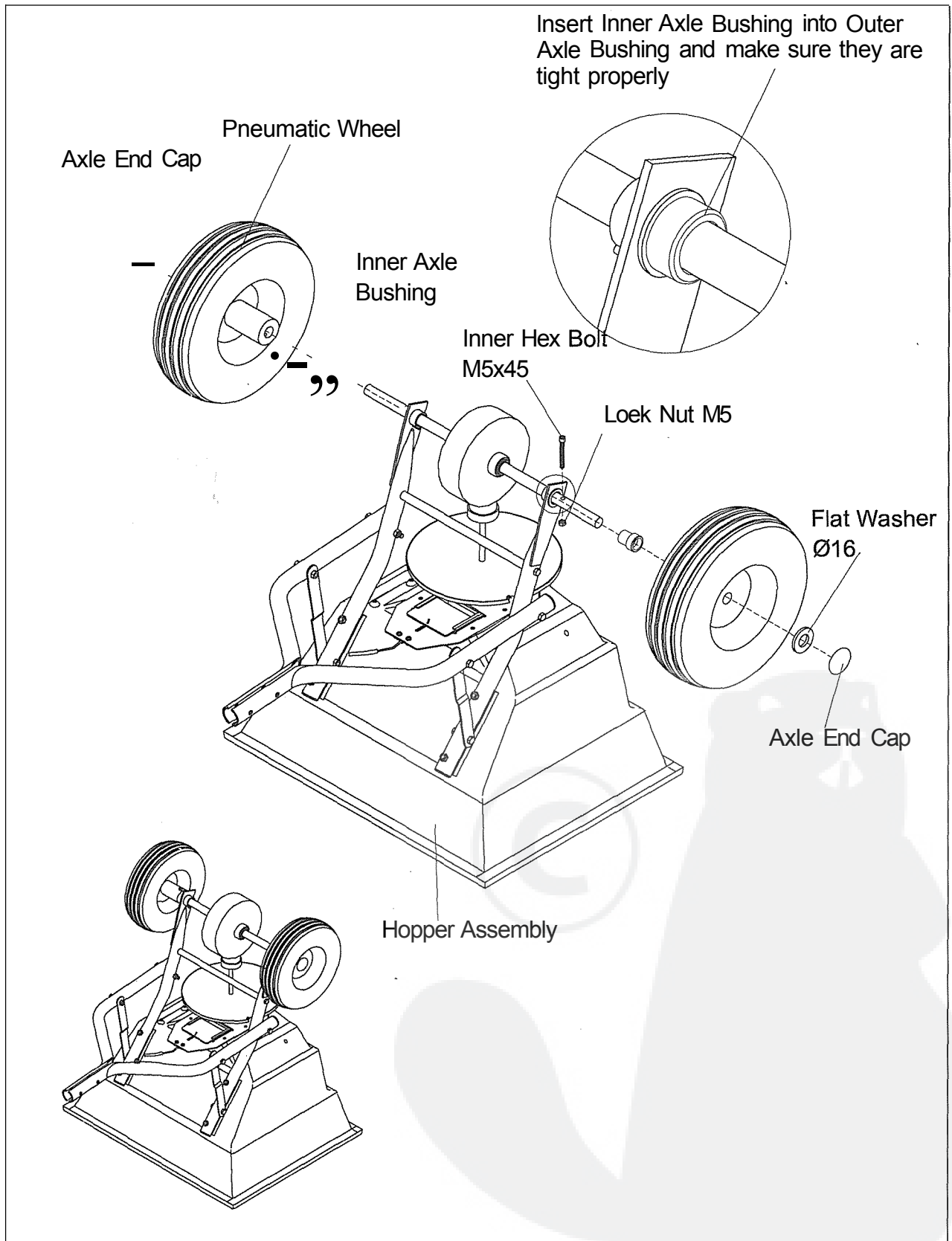

STEPS: Put the install tube assembly to hopper assembly using Bolt M6x40 and Loek Nut M6. NOW GO BACK AND TIGHTEN ALL NUTS AND BOLTS STARTING WITH FIRST STEP. DO NOT OVER TIGHTEN

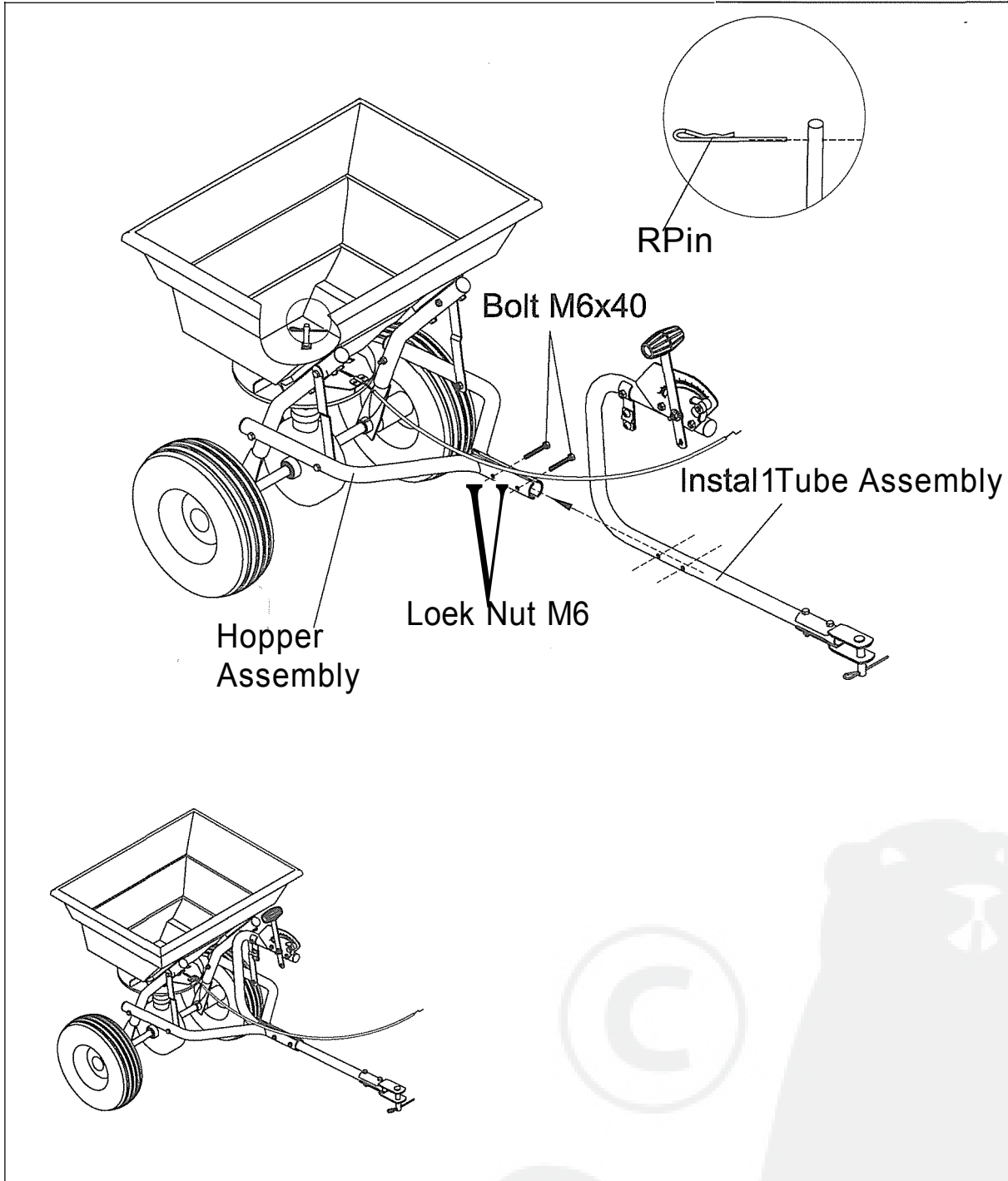

**STEP6: ADJUSTMENTS.** When you finished all above steps, You don't need to do the following steps. If they are not match neatly, you may need to do the following steps. To operate this spreader, push the handle to the top position (upwards). You may move the position of Wing nut on Gauge & Lever to adjust the spacer of three holes between hopper and adjustable plate as per your need when spreading.

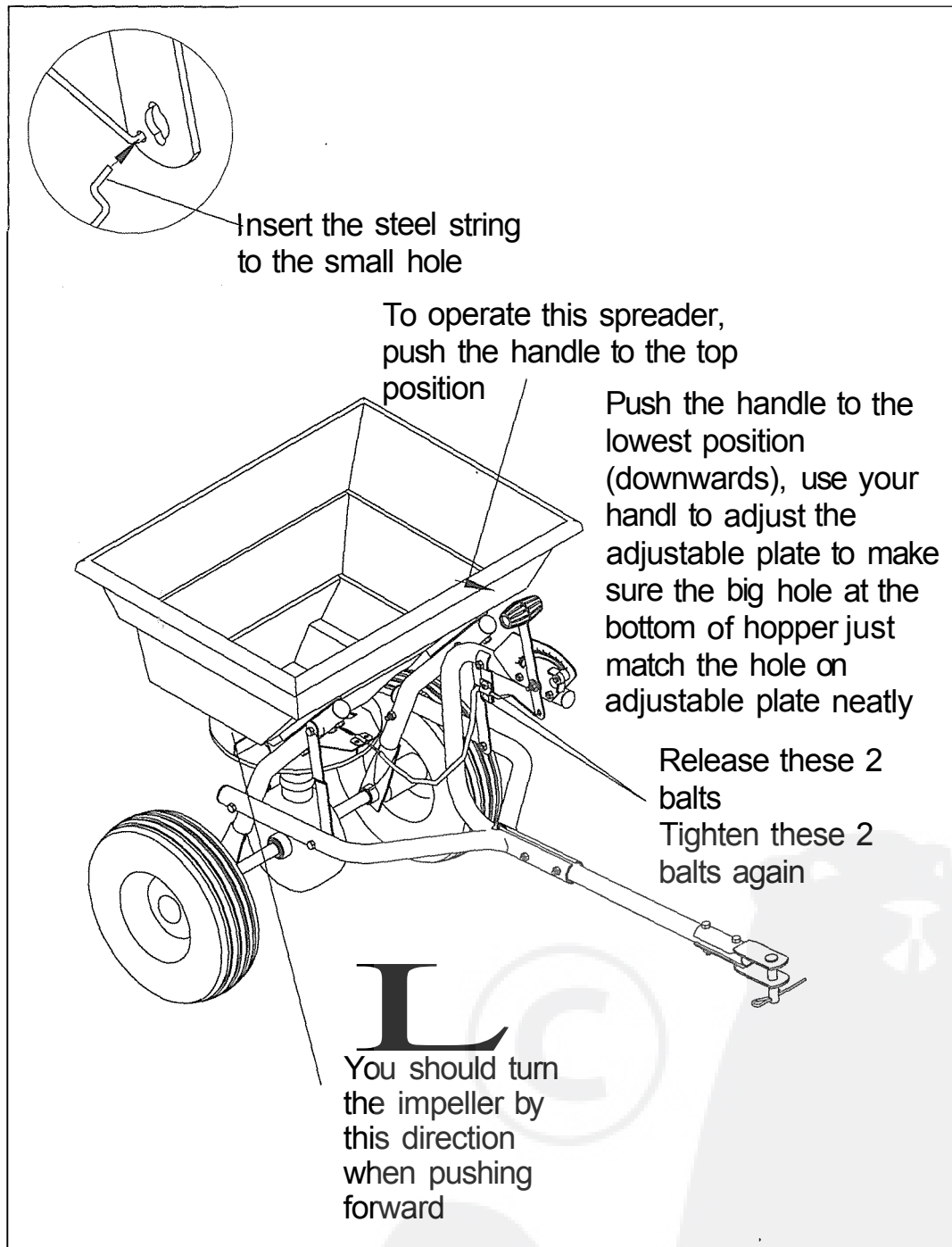



# PARTS DRAWING

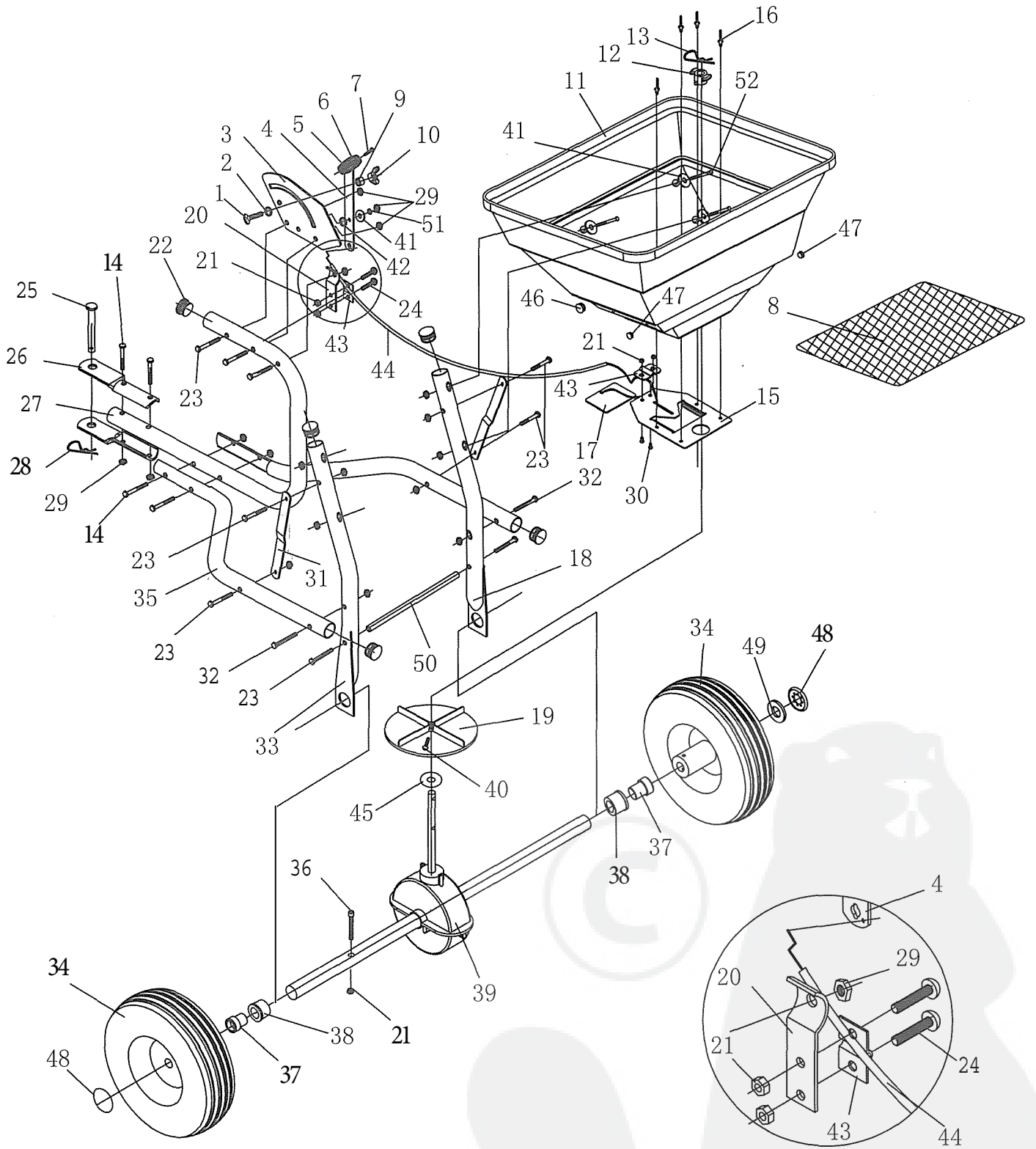

## PARTS LIST

Ref.No.	Drawing No.	Description	Qty
1	9114-06025-DG	Carriage Bolt M6x25	1
2	9315-08000-DG	Tooth Washer 08	1
3	N570-10000-DG	Gauge & Lever Assembly	1
4	N580-00005-DG	Adjust Handle Pole	1
5	N570-00014	Adjust Handle A	1
6	N570-00015	Adjust Handle B	1
7	9118-04018-DG	Screw M4x18	1
8	N511-00004	Hopper Screen	1
9	N510-00016	Spacer	1
10	N510-00019	Wing Nut M6	1
11	N580-00006	Hopper	1
12	N510-00004	Center Cover	1
13	N570-00017-DG	R Pin 02	1
14	9101-06040-DG	Bolt M6x40	4
15	N580-00019	Fixed Plate	1
16	9503-05012	Screw 05X12	4
17	N580-00020	Adjustable Plate	1
18	N580-00004	Wheel Frame Assembly (Left)	1
19	N510-00003	Impeller	1
20	N580-00008	Line Clamp Bottom Plate	1
21	9206-05000-DG	Loek Nut M5	5
22	T680-00003	Tube End Cap	5
23	9101-06035-DG	Hex Bolt M6x35	9
24	9110-05010-DG	Round Head Bolt M5x10	2
25	N390-00001-DG	Round Head Pin	1
26	N511-00003	Tow Bar Connect Plate	2
27	N511-00002-DG	Install Tube Assembly	1
28	9499-03000-DG	R Pin 03	1
29	9206-06000-DG	Loek Nut M6	18
30	9-110-05012-DG	Screw M5X12	2
31	N570-00010-DG	Connect plate	2
32	9101-06055-DG	Bolt M6x55	2
33	N580-00003-DG	Wheel Frame Assembly (Right)	1
34	N511-00005	Pneumatic Wheel	2
35	N511-00001	Connect Rad	2

## PARTS LIST

Ref.No.	Drawing No.	Description	Qty
36	9105-05045-DG	Inner Hex Bolt M5x45	1
37	N570-00018	Inner Axle Bushing	2
38	N570-00011	Outer Axle Bushing	2
39	N511-30000	Gear Box & Axle Assembly	1
40	9110-04020-DG	Screw M4x20	1
41	9302-06000-DG	Big Flat Washer 06	5
42	C130-00004	Nylon Washer	1
43	N580-00009	Line Clamp Press Plate	2
44	N511-20000	Control Rod	1
45	N570-00002	Thin Washer	1
46	N580-00011	Big End Cap	1
47	N580-00010	Small End Cap	2
48	N511-40000	Axle End Cover	2
49	9301-16000-DG	Flat Washer 016	1
50	N580-00013-DG	Fixing Connecting Rod	1
51	9306-06000-DG	Spring Washer 06	1
52	9301-06045-DG	Hex Bolt M6x45	4

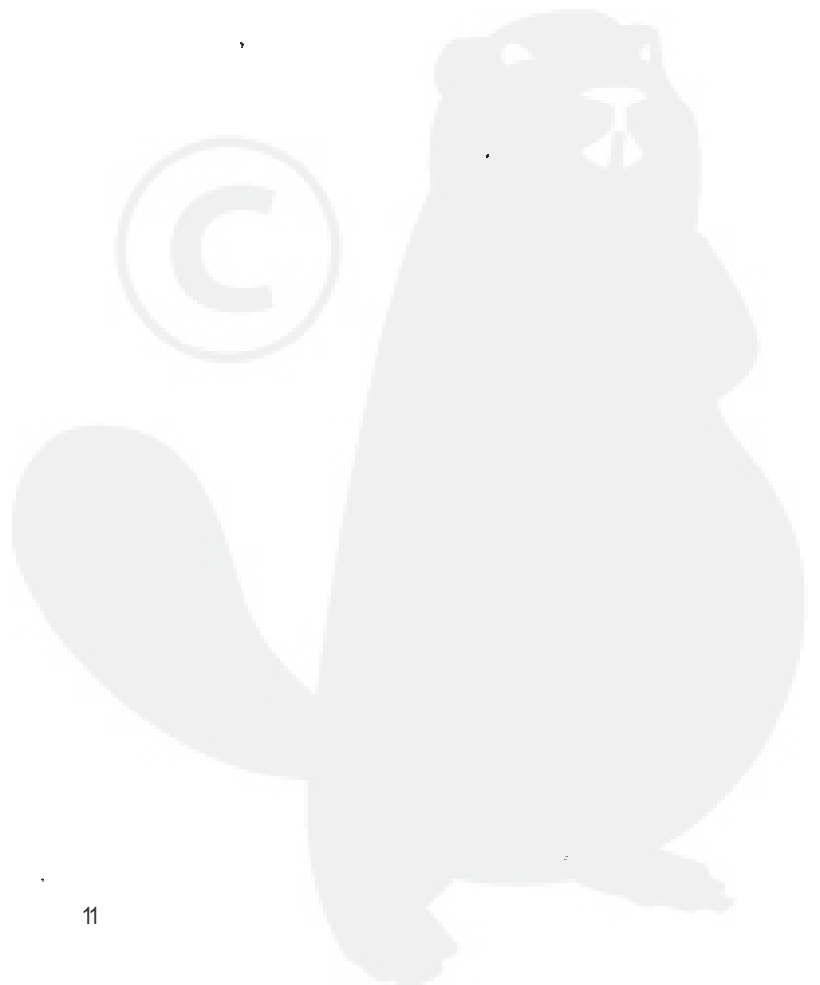



ENTE CERTIFICAZIONE MACCHINE  
NOTIFIED BODY 1282

# CERTIFICATE OF CONFORMITY

**CERTIFICATE NR. 100319/JST282**

MANUFACTURER :	
NAME	<b>JIASHAN SUPERPOWER TOOLS CO. LTD</b>
ADDRESS	<b>No.391, HUIMIN ROAD, HUIMIN TOWN, JIASHAN COUNTY, ZHEJIANG, CHINA</b>

WE CERTIFY THAT THE FOLLOWING PRODUCT (S) :

PRODUCT	<b>TOW-BEHIND SPREADER</b>
MODEL	<b>SP31507, SP31510, SP31511, SP31512</b>
YEAR	<b>2010</b>

HAS BEEN TYPE TESTED, CHECKED AND CERTIFIED BY ENTE CERTIFICAZIONE MACCHINE (NOTIFIED BODY NR. 1282) AND ALSO THAT THE SAMPLE PRODUCT IS IN CONFORMITY WITH THE TECHNICAL PROVISIONS OF THE FOLLOWING EUROPEAN REQUIREMENTS, INCLUDING THE LATEST AMENDMENTS, AND SAFETY STANDARDS :

<b>2006/42/EC</b>	<b>MACHINERY DIRECTIVE</b>
<b>SAFETY STANDARDS EN NORMS : EN 1050, EN 12100-1, EN 12100-2</b>	

NEVERTHELESS THE MANUFACTURER IS NOT EXEMPTED TO PERFORM ALL THE NECESSARY ACTIVITIES BEFORE ISSUING THE DECLARATION OF CONFORMITY. IN CASE THE APPLIANCE IS MODIFIED OR THE APPLIANCE WILL BE EQUIPPED WITH ACCESSORIES NOT SPECIFIED IN THE MANUFACTURER OPERATOR MANUAL, IT IS RECOMMENDED TO GET IN TOUCH WITH ENTE CERTIFICAZIONE MACCHINE FOR CE VALIDITY EXTENSION.

DATE OF ISSUE MARCH 2010

AREA MANAGER  
LUCAS BERTONNI  



GENERAL MANAGER  
ANTONIO BERTONNI  

**ENTE CERTIFICAZIONE MACCHINE**

NOTIFIED EUROPEAN BODY NR. 1282

HEADQUARTER

VIA MINCIO, 386 - 41056 SAVIGNANO S/P. (MO) - ITALY - ☎ +39 59 766306 ☎ +39 59 761838 ✉ INFO@ENTECERMA.IT 🌐 WWW.ENTECERMA.IT  
ECM CHINA

13F, JIAHE SUNSHINE BUILDING, No.76 JIUXIN ROAD, SONGJIANG DISTRICT, SHANGHAI ☎ +86-21-37829957 ✉ INFO@ECMCHINA.COM

