

CE

2000KG FOLDING SHOP CRANE





2000KG FOLDING SHOP CRANE

OWNER'S MANUAL

OWNER/OPERATOR RESPONSIBILITY

1. It is the owner/operator responsibility to properly use and maintain this equipment.
2. The instructions and warning contained in this manual shall be read and understood by the owner/operator prior to operating this equipment.

3. If an owner/operator does not understand English, the contents of this manual shall be explained in the owner/operators native language to assure that the owner/operator comprehends.
4. The owner/operator shall retain this manual for future reference to important warnings, operating and maintenance instructions.

WARNING

 **WARNING:** Do not overload. Overloading could cause damage or failure of the engine hoist.

 **WARNING:** Never use the hoist on an uneven floor surface as this could result in the hoist tipping over.

 **WARNING:** Always lock the legs and jib in position before lifting a load.

 **WARNING:** The nuts and bolts supplied with the hoist are all high strength and should not be substituted for inferior types.

 **WARNING:** Before each use ensure that all nuts and bolts are correctly fitted and tight.

 **WARNING:** Never exceed the safe working loads indicated on the jib.

 **WARNING: FAILURE TO FOLLOW THESE INSTRUCTIONS COULD RESULT IN LOSS OF LOAD AND/OR PERSONAL INJURY OR DAMAGE TO PROPERTY.**

⚠ WARNING: IMPORTANT: It is possible that air has got into the hydraulic system, causing poor lifting performance. Purge any air from the system by fully opening release valve (turn handle counterclockwise as shown), then while holding the boom down, operate pump handle rapidly several times.

TO RAISE LOAD

Close release valve by turning ram bleeder CLOCKWISE to a SNUG-TIGHT position. (DO NOT OVERTIGHTEN).

TO LOWER LOAD

Open release valve by turning handle COUNTERCLOCKWISE very slowly. The speed of lowering the load is controlled by how much you turn the hand.

⚠ WARNING: Front legs must always be locked in down position before applying load and/or raising boom.

⚠ WARNING: Boom must be in fully lowered position before raising legs. Legs must never be raised when crane is carrying load. Legs must be locked in place when raised.

OPERATING INSTRUCTIONS

⚠ WARNING: THIS LONG RAM JACK IS DESIGNED FOR LIFTING PURPOSES ONLY-NOT FOR SUPPORTING LOADS.

⚠ WARNING: DO NOT LOAD BEYOND ITS RATED CAPACITY.

SPECIFICATION

Max. Capacity.....	2000KG
Lifting capacity position 1.....	2000KG
Lifting capacity position 2.....	1500KG
Lifting capacity position 3.....	1000KG
Lifting capacity position 4.....	500KG
Max. Lifting height: 2Ton	1850MM
Max. Lifting height: ½Ton.....	2300MM

DIAGRAM

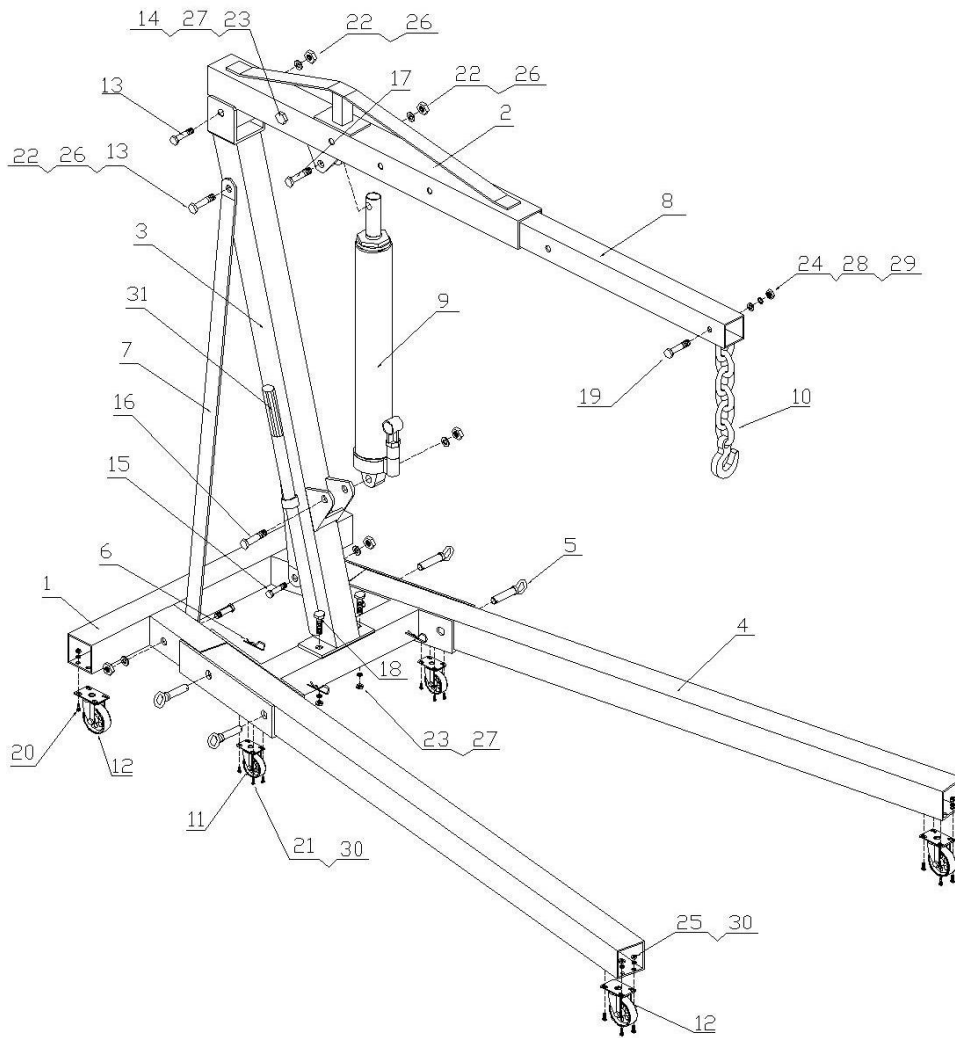

PARTS LIST

REF#	DESCRIPTION	QTY	REF#	DESCRIPTION	QTY
1	Base	1	17	Bolt M16x80	1
2	Boom	1	18	Bolt M14x110	2
3	Main Support Post	1	19	Bolt M14x95	1
4	Leg	2	20	Bolt M8x20	16
5	Lock Pin	4	21	Bolt M8x12	8
6	Split "R" Pin	4	22	Nut M16	6
7	Support Strap	2	23	Nut M14	3
8	Boom Extension	1	24	Nut M12	1
9	8Ton Log Ram Jack	1	25	Nut M8	16
10	Chain & Hook Assembly	1	26	Flat Washer Ø16	6
11	3" Swivel Caster	2	27	Flat Washer Ø14	3
12	3½" Swivel Caster	4	28	Flat Washer Ø12	1
13	Bolt M16x120	2	29	Lock Washer Ø12	1
14	Bolt M14x100	1	30	Lock Washer Ø8	24
15	Bolt M16x110	2	31	Jack Handle	1
16	Bolt M16x90	1			

INSPECTION

1. Visual inspection should be made before each use of the engine hoist.
2. Any engine hoist which appears to be damaged in any way is found to be badly worn, or operated abnormally must be removed from service.
3. If the engine hoist is accidentally subjected to an abnormal load or shock, it must be inspected by the manufacturer immediately.
4. It is recommended that an annual inspection of the engine hoist be made and that any defective parts, decals, or warning labels be replaced with manufacturer's specified parts.

ASSEMBLY INSTRUCTIONS

⚠ WARNING: During the assembly procedure, nuts and bolts should be hand tightened only. Once assembly is complete, nuts and bolts must be fully tightened.

1. Attach two 3½" swivel caster (#12) to base frame using bolts (#20), nuts (#25) and lock washers (#30).
2. Attach two 3" swivel caster (#11) to base frame using bolts (#21) and lock washers (#30).
3. Referring to the spare parts drawing, insert two legs (#4) into the base (#1) and lock the legs in place using four locking pins (#5). Secure these in place using four split-type pins (#6).
4. Attach the main support post (#3) to the base assembly (#1) using bolts (#18), nuts (#23) and flat washers (#27).
5. Attach support straps (#7) to top of main support post using bolt (#13), nut (#22) and flat washer (#26).
6. Attach support straps (#7) to the frame base using bolts (#15), nuts (#22) and flat washers (#26).
7. Connect bottom of ram unit (#9) to main support post (#3) using bolt (#16), nut (#22) and flat washer (#26).
8. Now secure the boom (#2) to the main support post (#3) using bolt (#13), nut (#22) and flat washer (#26).
9. While helper holds boom up. Connect top of hydraulic ram to boom using bolt (#17), nut (#22) and flat washer (#26).
10. Slide boom extension (#8) into the main boom(#2), secure in one of the four positions using bolt (#14), nut (#23) and flat washer(#27).

11. Tighten all nuts and bolts.

Page 2

