

10TON HYDRUALIC BENCH PRESS



Instruction & Assembly

SAVE THESE INSTRUCTIONS FOR FUTURE REFERENCE

Table of Contents

| | |
|---|------------|
| General Warnings and Rules | 3 |
| Controls and Features Identification..... | 5 |
| Assembly Instructions | 6, 7, 8, 9 |
| Operation Instructions | 10, 11 |
| Maintenance and Storage | 12 |
| Specification | 12 |
| Troubleshooting..... | 13 |
| Parts Drawing & Parts List..... | 14 |

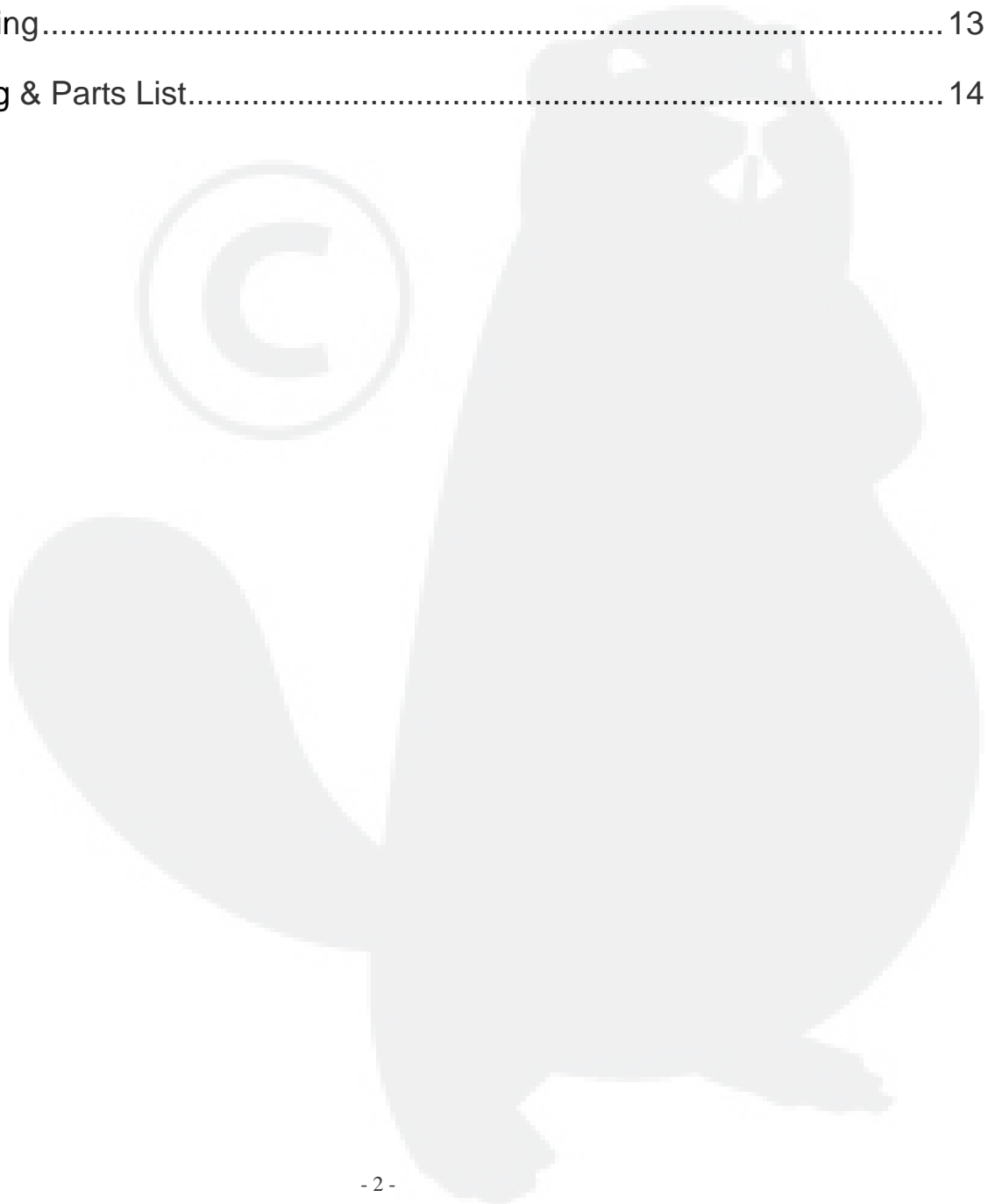

GENERAL WARNINGS

READ and UNDERSTAND this manual completely before using the Bench Press.

Operator must read and understand all safety and warning information, operating instructions, maintenance and storage instructions before operating this equipment. Failure to properly operate and maintain the bench press could result in serious injury to the operator or bystanders.

Operation Warnings

- To avoid distractions always keep children, visitors and bystander's away while operating the tool.
- Children must never be allowed in the work area. Do not allow children to handle machines, tools, or extension cords.
- Always lock up tools and keep them out of reach of children.
- Always keep work area clean and well lighted.
- Do not exceed rated capacity of 10 Tons.
- Do not use the equipment in damp or wet locations and don't expose it to rain.
- Do not operate the tool in explosive atmospheres of flammable liquids, gases, or dust this tool may create a spark which may ignite.
- Check for misalignment or binding of moving parts, breakage of parts, and any other condition that affects the tool's operation.
- Replace or repair damaged or worn parts and hoses immediately.
- Use only accessories that are identified by the manufacturer for the specific tool model.
- Always secure the bench press to a work bench that is on a solid, flat, level surface.
- Do not overreach when operating the equipment always keep proper footing and balance.
- Do not operate this tool while tired or under the influence of alcohol, drugs or medications.

Crush and Cut Hazards

- Always keep hands and feet clear from moving parts while operating the equipment.
- Always clear and keep work area clean when operating.
- Always wear safety gear, eye protection, gloves and work boots when operating the bench press.

WARNING

The warnings, cautions, and instructions outlined in this instruction manual cannot cover all possible conditions or situations that may occur. It must be understood by the operator that common sense and caution are factors which cannot be built into this product and must be supplied by the operator.





PROP 65 WARNING

This product contains chemicals known to the state of California to cause cancer, birth defects, or other reproductive harm.

Assembly Is Required

This product requires assembly before use. See "Assembly" section for instructions. Because of the weight and/or size of the bench press, it is recommended that another adult be present to assist with the assembly. **INSPECT ALL COMPONENTS** closely upon receipt to make sure no components are missing or damaged.

Hazard Signal Word Definitions

| | |
|---|---|
|  | <p>This is the safety alert symbol. It is used to alert you to potential personal injury hazards. Obey all safety messages that follow this symbol to avoid possible injury or death.</p> |
|  | <p>DANGER indicates an imminently hazardous situation which, if not avoided, will result in death or serious injury.</p> |
|  | <p>WARNING indicates a potentially hazardous situation which, if not avoided, could result in death or serious injury.</p> |
|  | <p>CAUTION indicates a potentially hazardous situation which, if not avoided, may result in minor or moderate injury.</p> |
|  | <p>CAUTION used without the safety alert symbol indicates a potentially hazardous situation which, if not avoided, may result in property damage.</p> |

ABOUT YOUR 10TON HYDRUALIC BENCH PRESS

This 10 ton hydraulic bench press has a heavy duty steel H-frame with steel-cross braces to prevent the frame from spreading under load. The bench press is engineered to be used for straightening, bending, holding, forming, pressing or other unique high pressure applications. Normal applications include installing bearings, bushings, gears, U joints, pulleys, ball joints, repairing engines & more. The unit has an automatic hydraulic bypass and overload systems protect ram and user. Use caution when operating the bench press and never exceed the rated capacity of 10 tons.

Technical specifications on the bench press are provided in the “Specifications” section of this manual.

Controls and Features Identification

Read this owner's manual before operating the equipment. Familiarize yourself with the location and function of the controls and features. Save this manual for future reference.



- 1) **Pressure Gauge** – Shows pressure.
- 2) **Ram** - 10 Ton capacity.
- 3) **Pump Handle** – Moves ram.
- 4) **Work Plate** - Raise and lower platform.
- 5) **Angle Base Feet** – Stabilizes the H-frame.
- 6) **Steel Press Plate** – Place the object on pad to work on.
- 7) **Press Frame** – H-frame design.



CAUTION

Read and follow all instructions for assembly and operation. Failure to properly assemble this equipment could result in serious injury to the user or bystanders, or cause equipment damage.

BENCH PRESS ASSEMBLY

Take all parts out of the shipping crate and inspect components to ensure there are no missing pieces before starting to assemble the bench press follow steps 1 through 6.

TOOLS REQUIRED

- Rubber or Wooden Hammer
- Heavy-Duty Drill
- Drill Bit
- 13mm & 17mm Wrenches

Assembly Instructions

STEP 1: Attach Feet to Frame

1. Attach angle steel feet (#13) to the frame (#4) using M8x25 bolt (#10), Ø8 lock washers (#11) and M8 nut (#12).

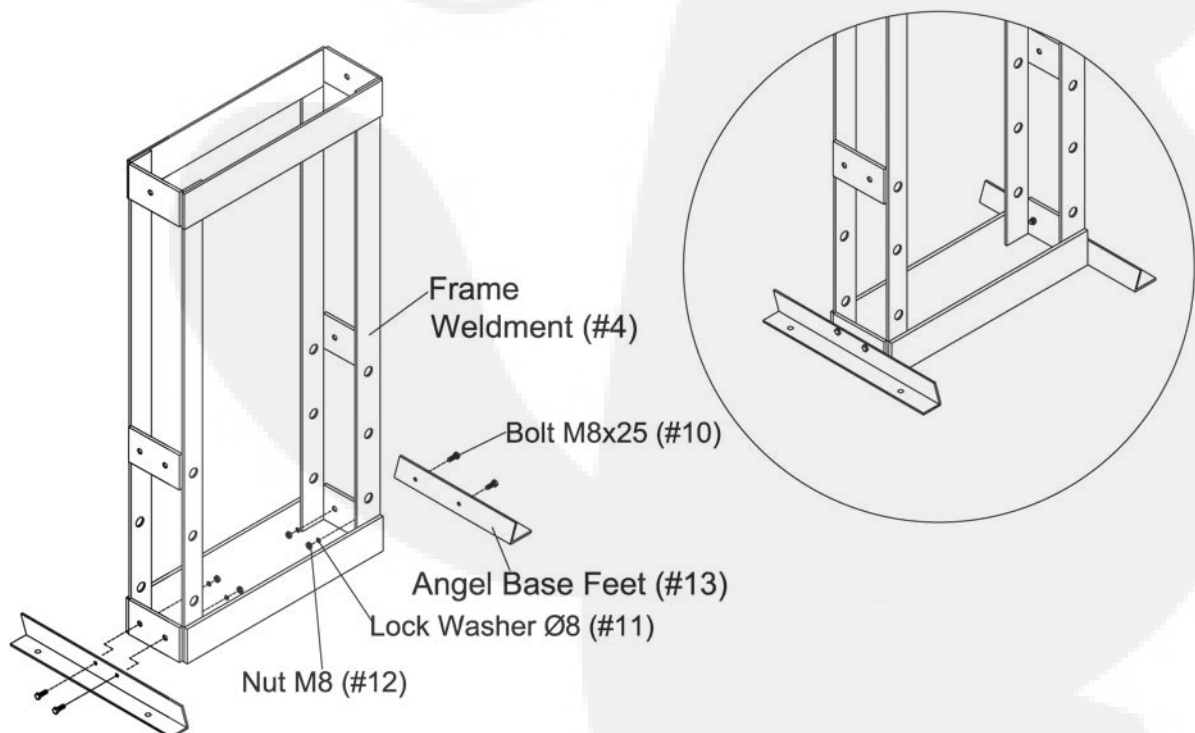

Assembly Instructions

STEP 2: Install the Working Plate to the Frame

1. Position the working plate (#8) between the frames and secure with the two support rods (#9).

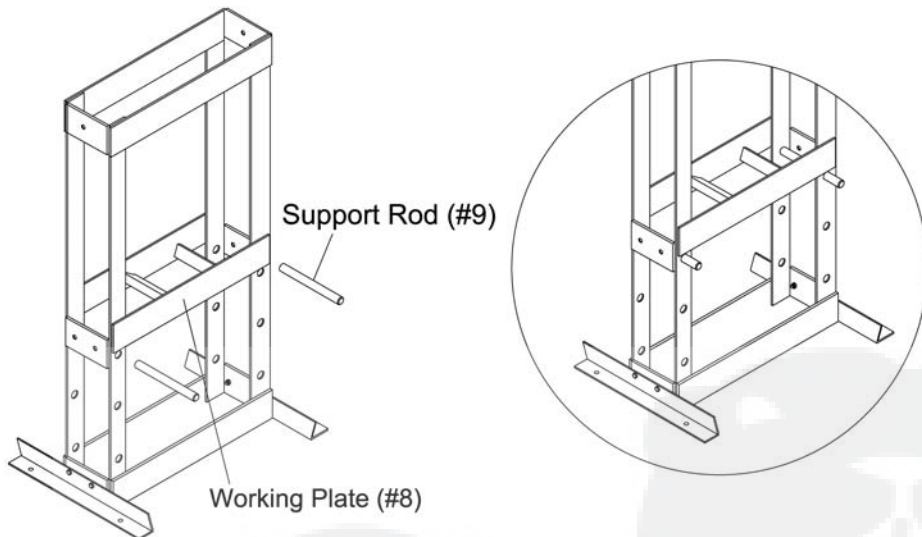

STEP 3: Attach Ram Fix Plates to the Frame

1. Attach the upper ram fix plate (#18) and ram fix base plate (#5) to the frame using M10x110 bolts (#2), Ø10 lock washers (#3), Ø10 flat washers (#15) and sleeves (#14). Loosely tighten the hardware.
2. Place the round nut I (#16) on ram fix base plate (#5).

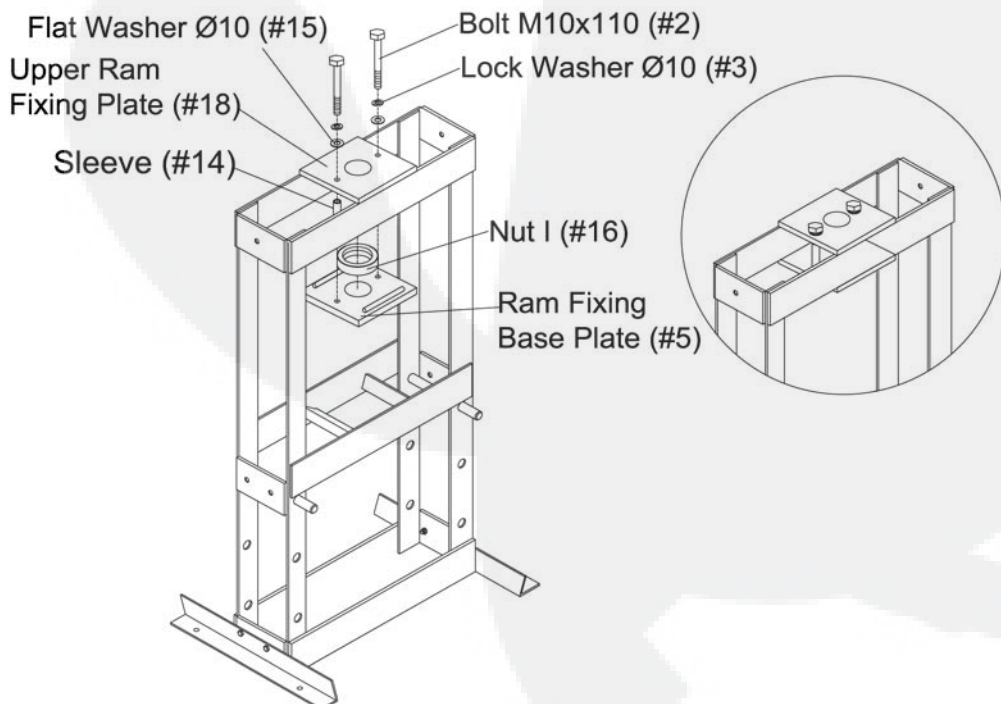

Assembly Instructions

STEP 4: Attach Gauge to Ram & Pump Assembly

1. Attach the gauge (#19) with seal washer (#20) to the top of the ram assembly (#1).
2. Insert the ram assembly through the hole on the ram fix plate (#18) and tighten the nut I (#16).
3. Use the nut II (#17) to secure the bottom of the ram assembly and tighten all hardware.
4. Attach the pump (#1) on left or right side of the frame using M10x16 bolts (#7), Ø10 lock washers (#3) and Ø10 flat washers (#15).

NOTE: Some applications or uses may work better with the pump attached to the work bench (hardware is not included but is available at your local hardware store).

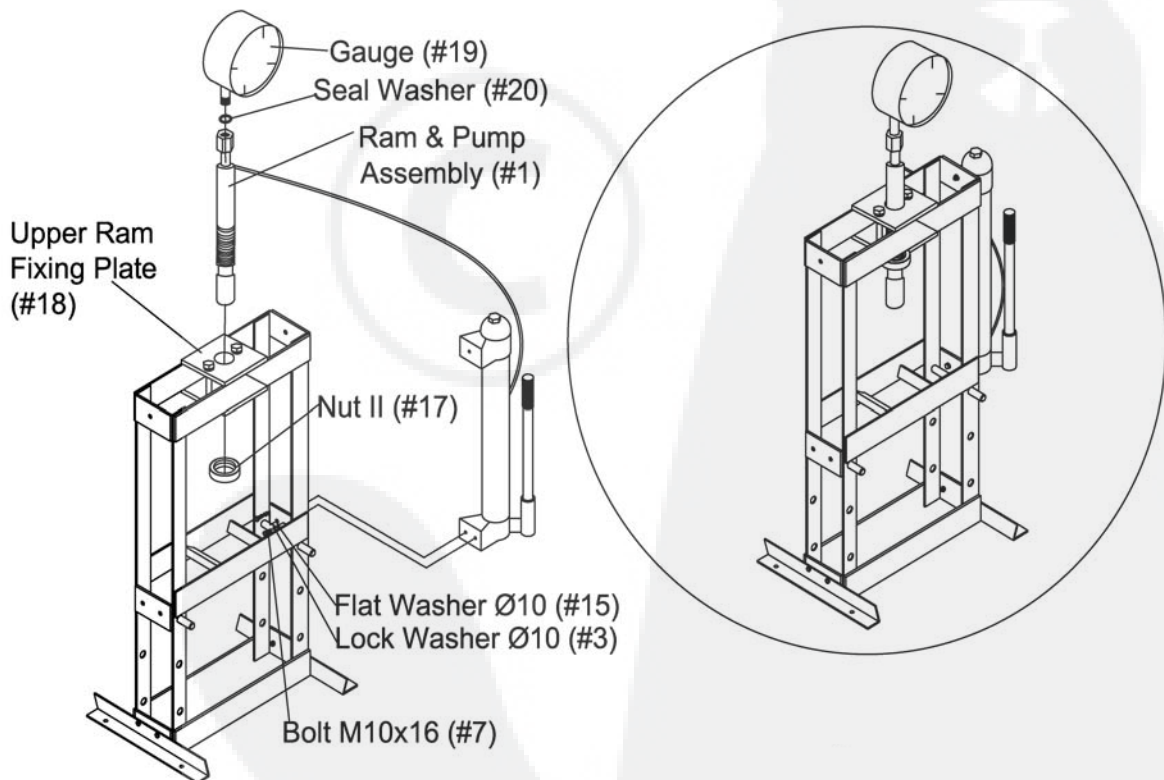

Assembly Instructions



WARNING

The bench press needs to be mounted or strapped to a stable work bench or table that is able to hold the weight of the bench press during operation.

The bench press needs to be secure before operating to avoid personal or property damage.

STEP 5: Bolt Bench Press to Work Bench

1. Always use another person when moving the bench press.

NOTE: The hardware for mounting or strapping the bench press to the work bench / table is not included but is available at your local hardware store.

2. Make a template of the holes in the bench press feet to mark the spot where the holes need to be drilled in the work bench or table.
3. Temporarily move the bench press to the side and use a drill bit to drill the four holes into the bench or table.
4. Position the bench press and align the holes in the feet with the holes in the bench / table.
5. Use four bolts, washers and nuts (not included) to secure the press to the work bench / table.

NOTE: Using straps instead of bolts make sure both the front and back of the feet are securely strapped down to a work bench to avoid movement during operation (hardware not included).

STEP 6: Install Press Plates on the Working Plate

1. Put the steel press plate (#6) onto the working plate (#8).
2. Before operating the bench press make sure all hardware is fully tighten.

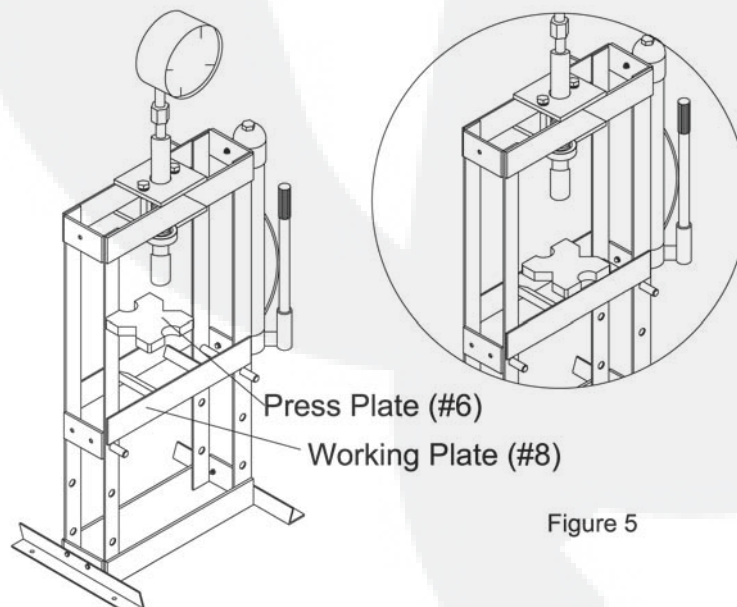

Figure 5

Operation Instructions

WARNING

Before operating the bench press, review the instructions and safety information below. Failure to follow these instructions may result in property damage or injury to the operator or bystanders.

GENERAL SAFETY INFORMATION

- Do not exceed rated capacity of 10 tons.
- Always maintain labels on the bench press as these contain important safety information.
- Inspect tool before use, looking for damaged, loose and missing parts. If any problems are found, do not use the tool until it is repaired.
- Always keep work area clean and bystanders out of work area.
- Keep hands away from steel press plates and press ram during use.
- Do not move the work piece while it is being compressed.
- Release load before service or maintenance.
- Secure the bench press to a work bench before use.
- Keep area under steel press plates clear from obstructions (bolt, debris and etc.), it will create an uneven press that will cause excess stress and possible breakage.
- Do not stand directly in front of the press when loaded.
- Do not leave the press unattended when it is loaded.
- Avoid off-center loads and do not continue to operate if work piece tilts or binds during compression, **STOP** and release compression. If you suspect structural failure to the work piece inspect thoroughly if it is safe, reposition before proceeding.
- Do not compress springs or other elastic objects they could disengage resulting in injury.
- Ram and pump assembly service must be performed by qualified repair personnel. Service or maintenance performed by unqualified personnel could result in a risk of injury.
- When servicing the ram and pump assembly, use only identical replacement parts. Refer to product specification, parts list and parts diagram.
- Only use with accessories that are rated to handle the forces exerted by this tool during operation.
- Use only with ram and pump assembly included with this bench press.
- Industrial applications must follow OSHA requirements.

WARNING

To prevent serious injury do not use damaged equipment. If abnormal noise or vibration occurs, have the problem corrected before further use.

BEFORE USING YOUR BENCH PRESS FOR THE FIRST TIME

1. Before using the bench press, check the hydraulic oil level and hoses.
2. Test the ram and pump several times to make sure it operates correctly before actual use. If the ram does not work properly, bleed the excess air by the following steps:
 - a. Open the release valve.
 - b. Remove the oil plug and fill with hydraulic fluid to full level.
 - c. Apply pressure and pump the handle up and down several times.
 - d. Check the oil level and if necessary top off with hydraulic oil.
 - e. Replace the oil plug and close the release valve.
 - f. Test the ram and pump several more times for proper operation before using.

NOTE: If after bleeding the excess air and the ram still will not operate properly do not use the tool until it has been repaired or replaced.

Operation Instructions

OPERATING THE BENCH PRESS

1. Use the support rods (#9) to adjust the height of the work plate (#8).

NOTE: The work plate needs to be in the highest position with the work piece as close as possible to the ram.

2. Place the work piece to be press on the steel press plates (#6).



WARNING

Make sure there is no obstruction under the steel press plates. Obstructions will create an uneven surface which can cause the steel press plates to break under pressure.

When pressing two items together the items need to line up vertically. If they are not lined up one item may forcefully eject sideways from the unit.

3. Pump the handle back and forth to move the ram until it makes contact with your work piece.

NOTE: Make sure when pressing two items together they are in vertical alignment. Continue to operate the handle to press the work piece.

4. When the task is completed, carefully release the pressure by turning the hand wheel counter clockwise on the pump.



WARNING

After pressing the work piece stay clear during the release process as the ram may rise quickly.

Maintenance and Storage



WARNING

Improper maintenance and storage of the bench press may void your warranty.

MAINTENANCE

- Before each use inspect the overall condition of the bench press for broken, cracked or bent parts and hoses that may affect the proper operation. Do not use damaged equipment.
- Before each use test the ram and pump for proper operation.
- Change the hydraulic oil every other year.

CHANGE HYDRAULIC OIL USING THE FOLLOWING STEPS:

1. With the ram in the lowered position remove the oil plug.
2. Turn the pump so the old hydraulic oil will drain out completely.
3. Fill with hydraulic jack oil until the oil begins to run out and reinstall the oil plug.

NOTE: Always dispose of the old hydraulic oil properly and in accordance with local and state regulations.

- Periodically clean the tool with a clean cloth using detergent or mild solvent and wipe dry.
- Use a glossy enamel spray paint to touch up scratched or worn painted metal surfaces.

IMPORTANT:

If a part needs replacement, only use parts that meet the manufacturer's specifications. Replacement parts that do not meet specifications may result in a safety hazard or poor operations.

STORAGE

- Keep in a safe, dry location and out of reach of un-authorized people.

Specifications

Max. Capacity 10 Ton

Oil TypeHydraulic Oil

Unit Weight 101.3lb / 46kg

Troubleshooting



WARNING

Always use caution when troubleshooting a malfunctioning ram and pump. Resolve any and all issues before using this piece of equipment. Never use damaged or malfunctioning equipment.

TROUBLESHOOTING:

If you are experiencing problems with your ram and pump operating correctly review the troubleshooting guide below for possible solutions. Always test the ram and pump several times to make sure it is operating properly before use.

NOTE: If the solutions presented do not solve the problem do not use and repair or replace the ram and pump.

TROUBLESHOOTING GUIDE

| Ram Will Not Operate | Ram Will Not Lift All The Way | Ram Lowers Under Load | Pump Stroke Feels Spongy | Handle Moves When Jack Is Under Load | Oil Leaks From Oil Plug | Possible Solutions |
|----------------------|-------------------------------|-----------------------|--------------------------|--------------------------------------|-------------------------|---|
| X | | X | | | | Make sure the release valve is closed. Check release valve. |
| X | | X | | X | | Valves may be blocked or may not be fully closed. To Flush Valves: 1) Lower the saddle and close the release valve. 2) Manually lift the saddle several inches. 3) Open the release valve and force the saddle down as quickly as possible. |
| X | X | | X | | | Check the hoses for leaking fluid. Replace if needed. |
| X | X | | X | | | Pump may be low on oil. Check and refill if needed. |
| X | X | | X | | | Pump may require bleeding the air out of the system. |
| | | | | | X | Unit may have too much hydraulic oil inside. Check fluid level. |

Parts Drawing & Parts List

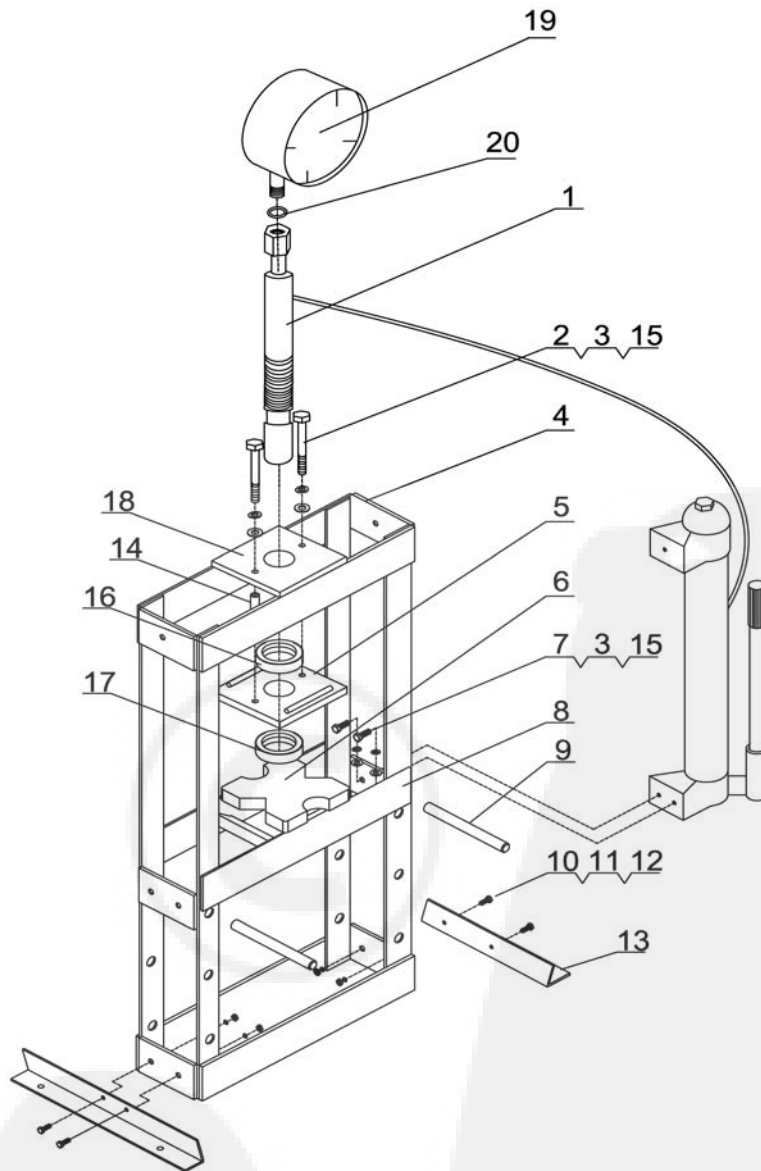

| PART# | DESCRIPTION | QTY | PART# | DESCRIPTION | QTY |
|-------|-----------------------|-----|-------|------------------------|-----|
| 1 | Ram & Pump Assembly | 1 | 11 | Lock Washer Ø8 | 4 |
| 2 | Bolt M10x110 | 2 | 12 | Nut M8 | 4 |
| 3 | Lock Washer Ø10 | 5 | 13 | Angle Base Feet | 2 |
| 4 | Frame Weldment | 1 | 14 | Sleeve | 2 |
| 5 | Ram Fixing Base Plate | 1 | 15 | Flat Washer Ø10 | 5 |
| 6 | Steel Press Plate | 2 | 16 | Nut I | 1 |
| 7 | Bolt M10x16 | 3 | 17 | Nut II | 1 |
| 8 | Working Plate | 1 | 18 | Upper Ram Fixing Plate | 1 |
| 9 | Support Rod | 2 | 19 | Gauge | 1 |
| 10 | Bolt M8x25 | 4 | 20 | Seal Washer | 1 |