

PWM600MH

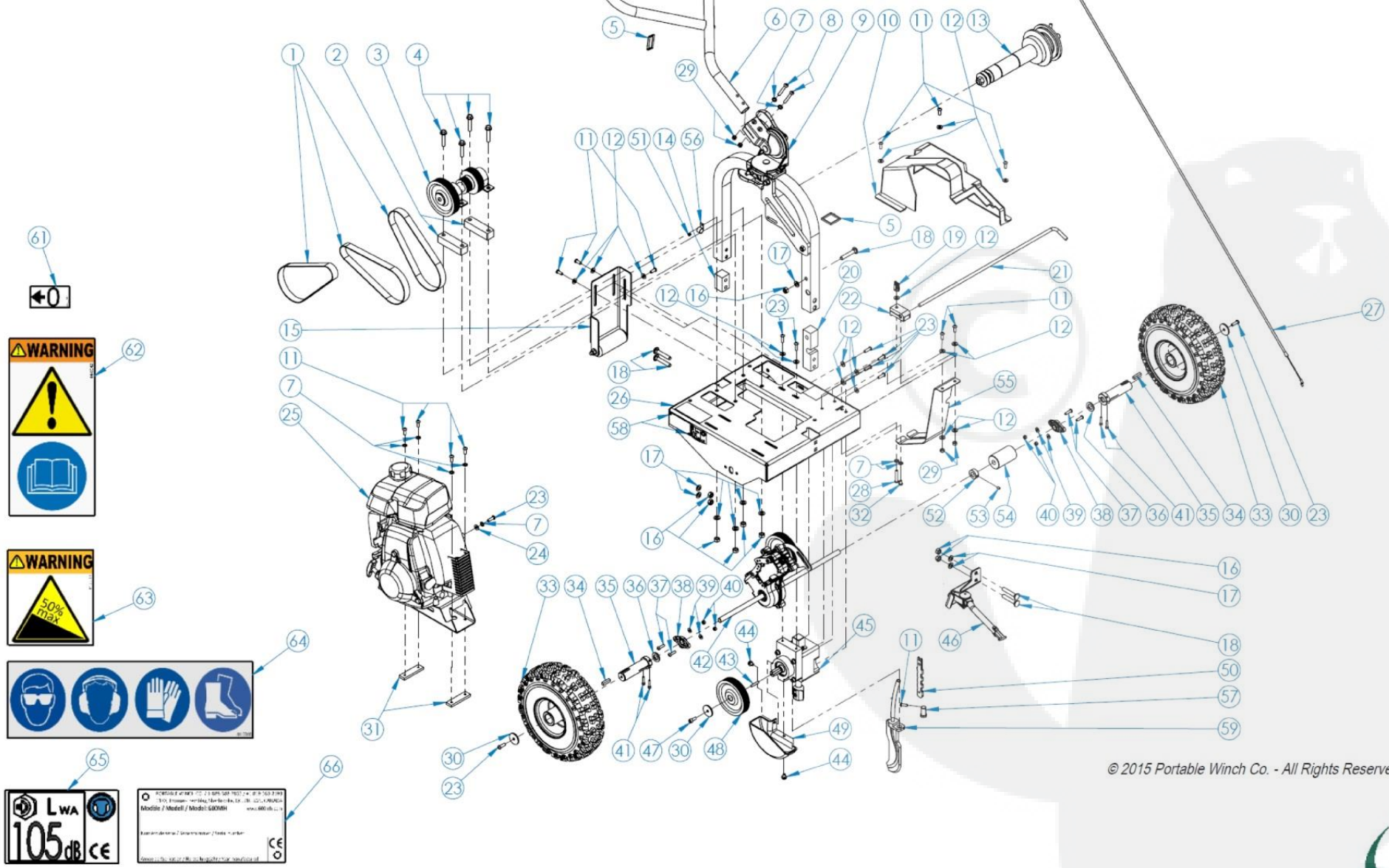

61

← 0

62

WARNING

! (Warning symbol)

📖 (Manual symbol)

63

WARNING

50% max (Noise symbol)

64

👁️ (Goggles symbol)

🧤 (Gloves symbol)

👢 (Boots symbol)

65

LWA 105 dB CE

66

PORTABLE WINCH CO. 21300 1000 7000 21300 1000 7000
 Modelle / Model / Model: 600MH www.600.ch
 Seriennummer / Seriennummer / Série number
 CE

© 2015 Portable Winch Co. - All Rights Reserved - Tous droits réservés



ITEM No.	PART NUMBER	DESCRIPTION	QTY	ITEM No.	PART NUMBER	DESCRIPTION	QTY
1	43-0035	BELT 220-J 8 GROOVES	3	30	10-0102	RETAINING WASHER (1/4 X 1-1/4 OD) - ZN	3
2	10-0213	PILLOW BLOCK SUPPORT	2	31	10-0238	ENGINE MOUNT BOLTING BAR	2
3	70-0045	INTERMEDIATE SHAFT ASS'Y	1	32	32-0033	BHCS M6-1 x 10mm - BLACK	1
4	32-0019	HCS M8-1.25 X 40mm - ZN	4	33	44-0038	TIRE AND HUB 4.10" X 10"	2
5	44-0045	CABLE TIE BLACK 5mm X 150mm	2	34	43-0034	KEY 1/4" X 1/4" X 1"	2
6	70-0039	HANDLE ASS'Y	1	35	10-0216	WHEEL CENTER HUB	2
7	35-0001	INTERNAL TOOTH LOCK WASHER TYPE-A 1/4 - ZN	9	36	43-0041	PLASTIC THRUST WASHER	2
8	32-0027	BHCS M6-1 X 45mm - ZN	2	37	32-0028	BHCS M5-0.8 X 20mm - ZN	4
9	70-0040	ARCH ASS'Y	1	38	43-0036	VERTICAL MOUNT PLASTIC BEARING IGUS EFOM-12	2
10	10-0243	BELT COVER	1	39	36-0006	FLAT WASHER M5 - ZN	4
11	32-0004	BHCS M6-1 X 16mm - SS	13	40	34-0006	NUT M5-0.8 NYLON - ZN	4
12	36-0001	FLAT WASHER M6 - ZN	17	41	32-0032	SHCS M4-0.7 X 20mm - BLACK	4
13	70-0052	SPOOL SUPPORT	1	42	70-0047	WHEEL TRANSMISSION ASS'Y	1
14	10-0308	SQUARE TUBE INSERT BACK	1	43	43-0040	KEY 5mm X 5mm X 25mm	1
15	70-0046	STABILIZING WHEEL ASS'Y	1	44	32-0037	HEX FLANGE BOLT M6-1.0 X 8mm - ZN	2
16	34-0004	NUT M8-1.25 NYLON - ZN	9	45	70-0035	BLADE TRANSMISSION ASS'Y	1
17	36-0004	FLAT WASHER M8 - ZN	9	46	70-0072	KICKSTAND ASSEMBLY	1
18	32-0024	CARRIAGE BOLT M8-1.25 X 50 - ZN	5	47	32-0039	SHCS M6-1 X 16mm - BLACK	1
19	32-0034	PLASTIC WING NUT W/BRASS M6-1.0 OPEN END	1	48	10-0237	PULLEY TYPE J 100mm - SHAFT 15mm	1
20	10-0309	SQUARE TUBE INSERT FRONT	1	49	10-0242	BLADE PULLEY COVER	1
21	10-0214	DISTANCE ROD	1	50	10-0303	BLADE TYPE 7	1
22	10-0218	DISTANCE ROD BLOCK	1	51	39-0041	POP RIVET 3/16" x 3/8" ALU/STEEL	1
23	32-0005	BHCS M6-1 x 20mm - SS	9	52	10-0312	SHAFT COLLAR 12mm	1
24	35-0019	FLAT WASHER 3/16 TYPE A	1	53	32-0030	SET SCREW M5-0.8 X 8mm - BLACK	1
25	70-0036	ENGINE ASS'Y	1	54	10-0258	LONG PLASTIC SPACER	1
26	10-0206	STEEL FRAME	1	55	10-0304	SLIDING FOOT	1
27	41-0015	THROTTLE CABLE ASS'Y	1	56	49-0020	CABLE CLAMP 1/2	1
28	32-0016	BHCS M6-1 X 35mm - SS	1	57	10-0249	WIRE GUIDE PIN	1
29	34-0008	NUT M6-1 NYLON - ZN	4	58	39-0036	POP RIVET 1/8" x 0.390" ALU/STEEL	2
	32-0014	Reamer bold M6-1x25	1	59	70-0056	WIRE GUIDE ASSEMBLY	1
				60	44-0044	LABEL - 600MH - 0 CM	1
				61	44-0042	LABEL - WARNING READ MANUAL	1
				62	44-0043	LABEL - WARNING WORKING IN SLOPES	1
				63	44-0040	LABEL - GLASSES, HEARING PROT., GLOVES, BOOTS	1
				64	44-0029	LABEL - 105 dB	1
				65	44-0039	LABEL - 600MH - TO ENGRAVE SERIAL NUMBER	1



The *PWM600MH™* perimeter wire machine is manufactured by:

Portable Winch Co.

1170, Thomas-Tremblay St.

Sherbrooke, Québec, J1G 5G5

CANADA

Telephone : +1 819 563-2193

Toll Free (Canada & USA): 1-888-388-PULL (7855)

Fax : + 1 514 227-5196

E-mail : info@portablewinch.com

Web site: www.600mh.com

