

V262W/V282W temporary ver.

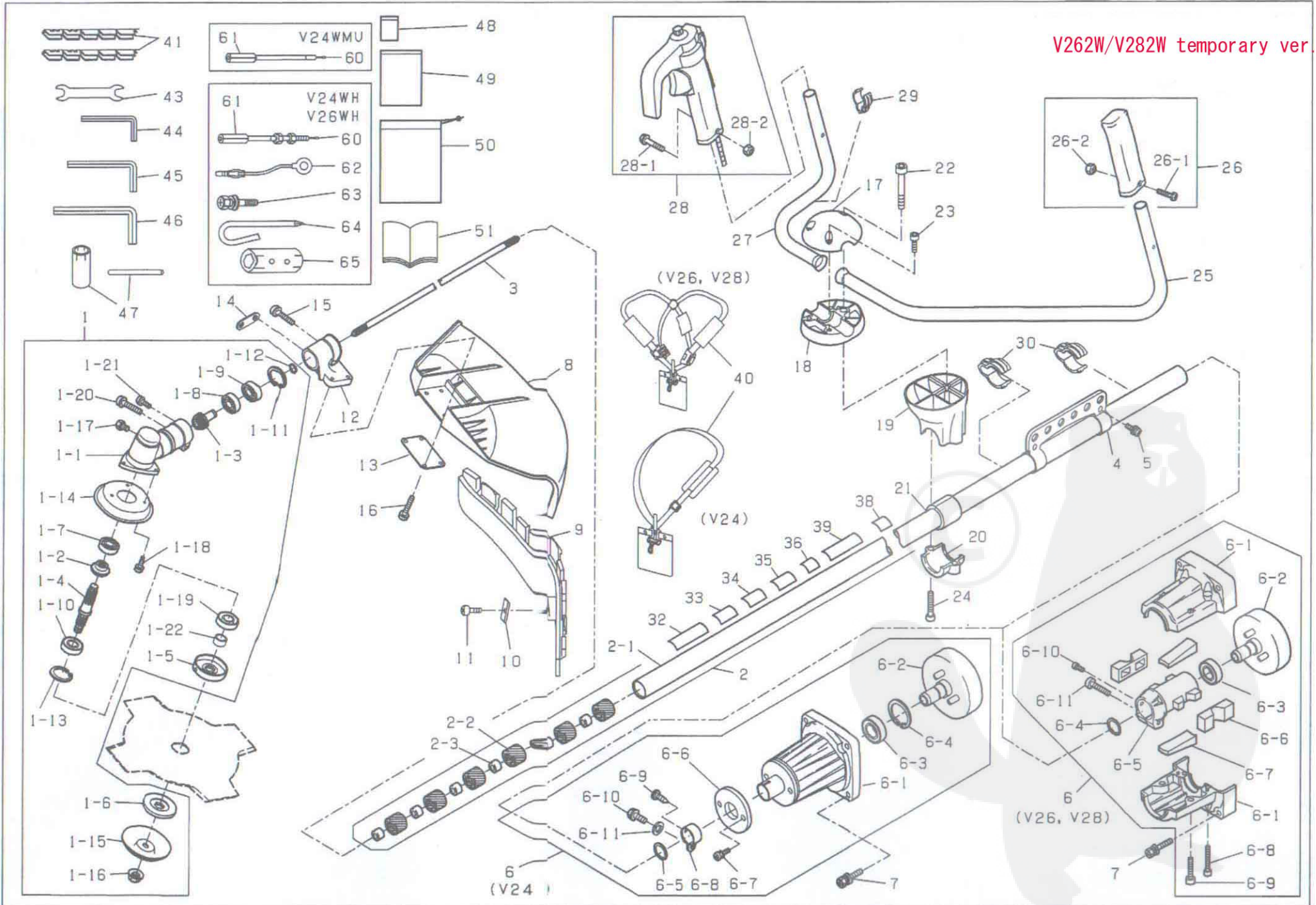

PARTS LIST MODEL:V262W,V282W						
REF No.	CODE	NAME	QTY		REMARKS	
			262W	282W	SIZE	ORIGINAL MODEL
1	801675707	GEAR CASE ASS'Y	1		26	V26W
	801675726			1	28	V28W
1-1	801676365	GEAR CASE	1		26	V26W
	801676377			1	28	V28W
1-2	801676366	BEVEL GEAR	1			V26W
	801676378			1		V28W
1-3	801676367	PINION	1			V26W
	801676379			1		V28W
1-4	801676368	GEAR SHAFT	1			V26W
	801676380			1		V28W
1-5	801676369	HOLDER(A)	1			V26W
	801676381			1		V28W
1-6	801676370	HOLDER(B)	1			V26W
	801676382			1		V28W
1-7	800045020	BEARING	1		6000	
	800045130			1	6001	
1-8	800045020	BEARING	1		6000	
	800045130			1	6001	
1-9	800045500	BEARING	1		6000Z	
	800045510			1	6001Z	
1-10	801676371	BEARING	1		6201	
	801676383			1	6202	
1-11	800083160	STOP RING	1		26	
	800083170			1	28	
1-12	800082010	STOP RING	1		10	
	800082030			1	12	
1-13	800083190	STOP RING	1		32	
	801668111			1	35	
1-14	801676372	GEAR CASE COVER	1		φ40×φ88	V26W
	801676385			1	φ44×φ88	V28W
1-15	801676373	NUT COVER	1	1	φ10×φ73	V26W
1-16	801676374	NUT	1	1	M10×1.25	
1-17	800010505	BOLT	1	1	M6×8	
1-18	801676360	SCREW	3	3	M4×8(+) 2P	
1-19	801676375	OIL SEAL	1		TC17327	V26W
	801676386			1	TC22357	V28W

PARTS LIST MODEL:V262W,V282W							
REF No.	CODE	NAME	QTY		REMARKS		
			262W	282W	SIZE	ORIGINAL MODEL	
	802041200			6		F-5	
2-3	800200029	OIL METAL	6	6	φ8×φ14×10	F-5	
3	801666942	DRIVE SHAFT	1	1		H26	
4	801675710	HANGER STRAP STEM	1		26	V26W	
	801675729			1	28	V28W	
5	800200001	SCREW	2	2	M6×12 (+)2P		
6	800200030	CLUTCH HOUSING ASS'Y	1				
	800200079			1		H28	
6-1	801667108	CLUTCH HOUSING SET (UPPER/LOWER)	1	1		H26	
6-2	800200031	CLUTCH DRUM	1	1		F-4	
6-3	800200004	BEARING	1	1	6002ZZ		
6-4	800200006	STOP RING	1	1	15		
6-5	801667109	CLUTCH HOUSING CORE	1		26	F-18	
	801666949			1	28	F-19	
6-6	801652132	HOUSING DAMPER	2	2		F-18	
6-7	801652258	HOUSING DAMPER	2	2		F-18	
6-8	800200032	CAP BOLT	2	2	M5×30		
6-9	800200033	CAP BOLT	2	2	M6×25		
6-10	800200034	SCREW	1	1	M5×10 (+)2P		
6-11	800200035	BOLT	1	1	M6×30 (+)3P		
7	800200035	BOLT	4	4	M6×30 (+)3P		
8	800201970	SAFETY GUARD(prev.1675697)	1	1		V26W	CHANGED AS FROM
9	800201974	SAFETY GUARD ASSY	1	1			SEP.2005
9-1	800201971	SAFETY GUARD(prev.1675698)	1	1			
9-2	800201973	SCREW	1	1			
9-3	800200553	NUT	1	1			
10	800201972	CUTTER(prev.1675699)	1	1			
11	801675700	SCREW	2	2	4×12(+)		
12	801675711	SAFETY GUARD HOLDER	1		26	V26W	
12	801675730	SAFETY GUARD HOLDER		1	28	V28W	
13	801675702	SAFETY GUARD HOLDER	1	1		V26W	
14	801675703	CONNECTOR	1	1		V26W	
15	800200012	CAP BOLT	1	1	M5×20		
16	800200013	CAP BOLT	4	4	M5×16		
17	801675712	HANDLE HOLDER	1	1		J28	
18	801675713	HANDLE HOLDER	1	1		J28	
19	801675714	HANDLE HOLDER	1	1		V26W	
20	801675715	HANDLE HOLDER	1	1		V26W	
21	800200036	HANDLE DAMPER	1			F-4	
	800200069			1		F-5	
22	800200037	CAP BOLT	1	1	M8×50		
23	800200038	CAP BOLT	2	2	M6×20		
24	800200039	CAP BOLT	2	2	M6×25		
25	801675716	HANDLE	1	1		V26W	
26	801655825	GRIP ASS'Y	1	1		H26W	

PARTS LIST MODEL:V262W,V282W						
REF No.	CODE	NAME	QTY		REMARKS	
			262W	282W	SIZE	ORIGINAL MODEL
26-1	801655775	SCREW	1	1	M5×30(+)	
26-2	800030080	NUT	1	1	M5	
27	801675717	HANDLE	1	1		V26W
28	801695932	THROTTLE LEVER ASS'Y V262W/V282W	1	1		V262W
28-1	801655775	SCREW	1	1	M5×30(+)	
28-2	800030080	NUT	2	2	M5	
29	801675722	WIRE GUIDE	1	1	19	V28W
30	801675723	WIRE GUIDE	2		26	V26W
	801675731			2	28	V28W
32		LABEL				
33		LABEL				
34		LABEL				
35		LABEL				
		LABEL				
36		LABEL				
38		LABEL				
		LABEL				
39		LABEL				
40	801668671	HARNESS ASS'Y	1	1		J28
41	801666953	PROTECTOR	1	1		H28
43	800200023	SPANNER	1	1	10×8	
44	800200022	SPANNER	1	1	4	
45	800200042	SPANNER	1	1	5	
46	800200043	SPANNER	1	1	6	
48	801689082	BAG	1	1		
49	800200025	BAG	1	1		
50	800200026	BAG	1	1		
51		MANUAL				
60		WIRE				
61		CONNECTOR				
62		CORD ASS'Y				
63		SCREW				
64	800200112	DRIVER				H26WH
65	800200113	SPANNER			16×19	H26WH

different part from
V26W/V28W

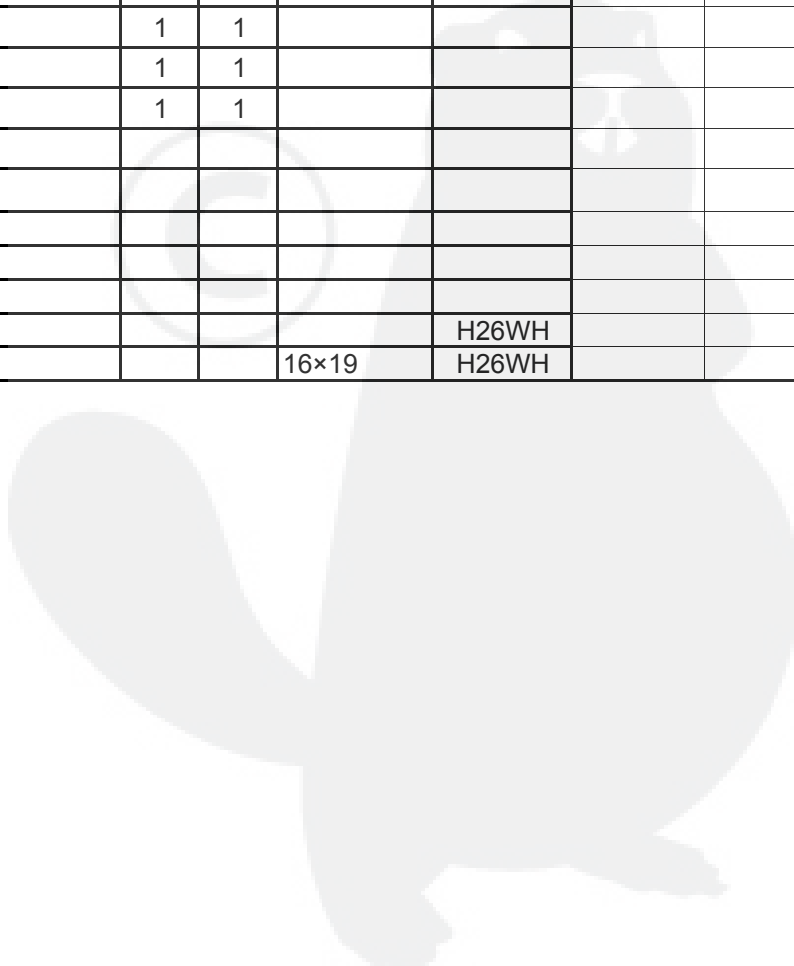

PARTS LIST MODEL:V262W,V282W					
REF No.	CODE	NAME	QTY		REMA
			262W	282W	SIZE
1	801675707	GEAR CASE ASS'Y	1		26
	801675726			1	28
1-1	801676365	GEAR CASE	1		26
	801676377			1	28
1-2	801676366	BEVEL GEAR	1		
	801676378			1	
1-3	801676367	PINION	1		
	801676379			1	
1-4	801676368	GEAR SHAFT	1		
	801676380			1	
1-5	801676369	HOLDER(A)	1		
	801676381			1	
1-6	801676370	HOLDER(B)	1		
	801676382			1	
1-7	800045020	BEARING	1		6000
	800045130			1	6001
1-8	800045020	BEARING	1		6000
	800045130			1	6001
1-9	800045500	BEARING	1		6000Z
	800045510			1	6001Z
1-10	801676371	BEARING	1		6201
	801676383			1	6202
1-11	800083160	STOP RING	1		26
	800083170			1	28
1-12	800082010	STOP RING	1		10
	800082030			1	12
1-13	800083190	STOP RING	1		32
	801668111			1	35
1-14	801676372	GEAR CASE COVER	1		φ40×φ88
	801676385			1	φ44×φ88
1-15	801676373	NUT COVER	1	1	φ10×φ73
1-16	801676374	NUT	1	1	M10×1.25
1-17	800010505	BOLT	1	1	M6×8
1-18	801676360	SCREW	3	3	M4×8(+) 2P
1-19	801676375	OIL SEAL	1		TC17327
	801676386			1	TC22357

PARTS LIST MODEL:V262W,V282W					
REF No.	CODE	NAME	QTY		REMA
			262W	282W	SIZE
	802041200			6	
2-3	800200029	OIL METAL	6	6	φ8×φ14×10
3	801666942	DRIVE SHAFT	1	1	
4	801675710	HANGER STRAP STEM	1		26
	801675729			1	28
5	800200001	SCREW	2	2	M6×12 (+)2P
6	800200030	CLUTCH HOUSING ASS'Y	1		
	800200079			1	
6-1	801667108	CLUTCH HOUSING SET (UPPER/LOWER)	1	1	
6-2	800200031	CLUTCH DRUM	1	1	
6-3	800200004	BEARING	1	1	6002ZZ
6-4	800200006	STOP RING	1	1	15
6-5	801667109	CLUTCH HOUSING CORE	1		26
	801666949			1	28
6-6	801652132	HOUSING DAMPER	2	2	
6-7	801652258	HOUSING DAMPER	2	2	
6-8	800200032	CAP BOLT	2	2	M5×30
6-9	800200033	CAP BOLT	2	2	M6×25
6-10	800200034	SCREW	1	1	M5×10 (+)2P
6-11	800200035	BOLT	1	1	M6×30 (+)3P
7	800200035	BOLT	4	4	M6×30 (+)3P
8	800201970	SAFETY GUARD(prev.1675697)	1	1	
9	800201974	SAFETY GUARD ASSY	1	1	
9-1	800201971	SAFETY GUARD(prev.1675698)	1	1	
9-2	800201973	SCREW	1	1	
9-3	800200553	NUT	1	1	
10	800201972	CUTTER(prev.1675699)	1	1	
11	801675700	SCREW	2	2	4×12(+)
12	801675711	SAFETY GUARD HOLDER	1		26
12	801675730	SAFETY GUARD HOLDER		1	28
13	801675702	SAFETY GUARD HOLDER	1	1	
14	801675703	CONNECTOR	1	1	
15	800200012	CAP BOLT	1	1	M5×20
16	800200013	CAP BOLT	4	4	M5×16
17	801675712	HANDLE HOLDER	1	1	
18	801675713	HANDLE HOLDER	1	1	
19	801675714	HANDLE HOLDER	1	1	
20	801675715	HANDLE HOLDER	1	1	
21	800200036	HANDLE DAMPER	1		
	800200069			1	
22	800200037	CAP BOLT	1	1	M8×50
23	800200038	CAP BOLT	2	2	M6×20
24	800200039	CAP BOLT	2	2	M6×25
25	801675716	HANDLE	1	1	
26	801655825	GRIP ASS'Y	1	1	

PARTS LIST MODEL:V262W,V282W					
REF No.	CODE	NAME	QTY		REMA
			262W	282W	SIZE
26-1	801655775	SCREW	1	1	M5×30(+)
26-2	800030080	NUT	1	1	M5
27	801675717	HANDLE	1	1	
28	801695932	THROTTLE LEVER ASS'Y V262W/V282W	1	1	
28-1	801655775	SCREW	1	1	M5×30(+)
28-2	800030080	NUT	2	2	M5
29	801675722	WIRE GUIDE	1	1	19
30	801675723	WIRE GUIDE	2		26
	801675731			2	28
32		LABEL			
33		LABEL			
34		LABEL			
35		LABEL			
		LABEL			
36		LABEL			
38		LABEL			
		LABEL			
39		LABEL			
40	801668671	HARNESS ASS'Y	1	1	
41	801666953	PROTECTOR	1	1	
43	800200023	SPANNER	1	1	10×8
44	800200022	SPANNER	1	1	4
45	800200042	SPANNER	1	1	5
46	800200043	SPANNER	1	1	6
48	801689082	BAG	1	1	
49	800200025	BAG	1	1	
50	800200026	BAG	1	1	
51		MANUAL			
60		WIRE			
61		CONNECTOR			
62		CORD ASS'Y			
63		SCREW			
64	800200112	DRIVER			
65	800200113	SPANNER			16×19