

# Service Schematic

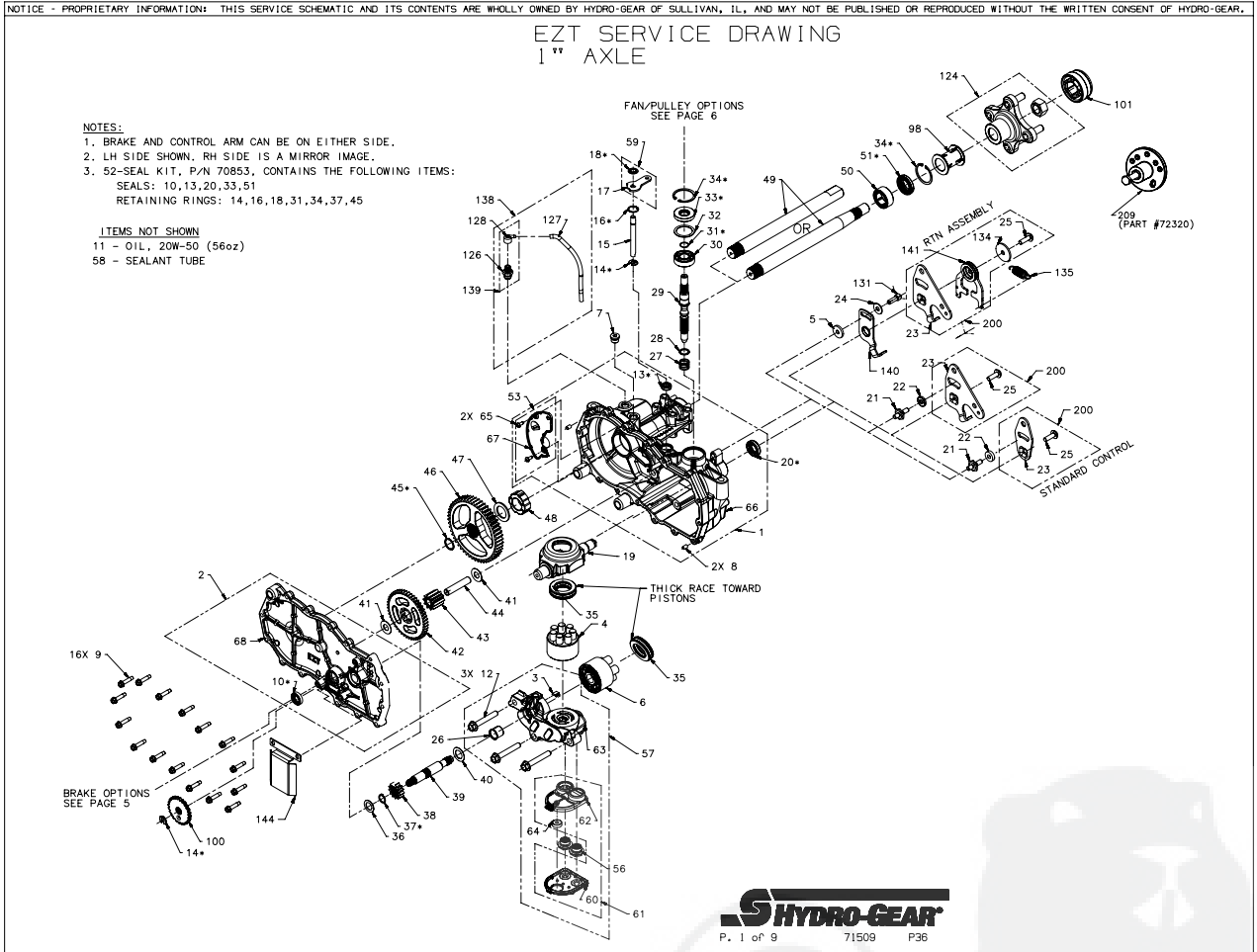

## Service Schematic

| #  | PART #       | DESCRIPTION                             | QTY | Note |
|----|--------------|---|-----|------|
| 1  | 70862R       | KIT, MAIN HOUSING-RH                    | 1   |      |
| 2  | 70863R       | KIT, SIDE HOUSING RH                    | 1   |      |
| 4  | 70723        | ASSY, BLOCK 7 PISTON                    | 1   |      |
| 5  | 54315        | SPACER 0.320 ID X 1.005 OD X 0.1495 THK | 1   |      |
| 6  | 70331        | KIT, BLOCK, 10CC CYLINDER               | 1   |      |
| 7  | 9005110-5600 | PLUG 9/16-18 METAL                      | 1   |      |
| 9  | 53246        | SCREW 1/4-20 X 1.125 HEX WASHER         | 16  |      |
| 15 | 51625        | ROD BYPASS                              | 1   |      |
| 19 | 51048        | TRUNNION, SWASHPLATE                    | 1   |      |
| 24 | 44130        | WASHER .34 X .88 X .06                  | 1   |      |
| 27 | 2003014      | SPRING, BLOCK                           | 1   |      |
| 28 | 2003017      | WASHER .59 X .79 X .04                  | 1   |      |
| 29 | 51062        | SHAFT INPUT                             | 1   |      |
| 30 | 50315        | BEARING 17X40X12 BALL OPEN 6203         | 1   |      |
| 32 | 50951        | WASHER 1.23 X 1.57 X .04                | 1   |      |
| 35 | 50551        | BEARING 30X52X13 BALL THRUST            | 2   |      |
| 36 | 44371        | WASHER .63 X 1.0 X .05 FLAT             | 1   |      |
| 37 | 44145        | RING RET 62 EXT                         | 1   |      |
| 38 | 51767        | GEAR, 12T PINNION                       | 1   |      |
| 40 | 51069        | WASHER .71 X 1.16 X .04                 | 1   |      |
| 41 | 50132        | WASHER .51 X 1.10 X .03 FLAT            | 2   |      |
| 42 | 51766        | GEAR, 10T/49T                           | 1   |      |
| 43 | 51043        | GEAR, 10T JACKSHAFT                     | 1   |      |
| 44 | 51083        | JACK SHAFT (PIN)                        | 1   |      |
| 46 | 52541        | GEAR, 52T BULL                          | 1   |      |
| 47 | 52532        | WASHER 1.013 X 1.750 X .105 FLAT        | 1   |      |
| 48 | 52542        | SLEEVE BEARING (INBOARD)                | 1   |      |
| 49 | 53706        | SHAFT AXLE                              | 1   |      |
| 50 | 51517        | BUSHING 1.003X1.571X.625                | 1   |      |
| 52 | 70853        | KIT, SEALS AND RETAINING RINGS          | 1   |      |
| 10 |              | SEAL. LIP .625 X 1.000 X .2501          | 1   |      |
|    |              | SEAL. LIP .50 X .88 X .25               | 1   |      |
| 13 |              | SEAL. LIP .375 X .75 X .25              | 1   |      |
| 14 |              | RING RETAINING .375 EXT                 | 2   |      |
| 16 |              | RING RETAINING .750 INT                 | 1   |      |
| 18 |              | RING RETAINING .375 EXT (PUSHNUT)       | 1   |      |
| 20 |              | SEAL. LIP 18 X 32 X 7                   | 1   |      |
| 31 |              | RING RETAINING WIRE .561 ID             | 1   |      |
| 33 |              | SEAL LIP 17 X 40 X 7                    | 1   |      |
| 34 |              | RING RETAINING                          | 2   |      |
| 37 |              | RING RETAINING                          | 1   |      |
| 45 |              | RING SPIRAL RETAINING                   | 1   |      |
| 51 |              | SEAL LIP 1.00 X 1.57 X .25              | 1   |      |
|    |              | SEAL LIP .375 X .75 X .25               | 1   |      |
| 53 | 70868R       | KIT, EXPANSION PLATE RH                 | 1   |      |
| 57 | 71530        | KIT, CENTER SECTION W/ FILTER - RH      | 1   |      |

## Service Schematic

| #     | PART # | DESCRIPTION                       | QTY | Note |
|-------|--------|-----------------------------------|-----|------|
| (63)  |        | CENTER SECTION, LH, 7P            | 1   |      |
| (3)   |        | PLATE, BYPASS                     | 1   |      |
| (26)  |        | BUSHING, .711 X .799 X .778       | 1   |      |
| (12)  |        | BOLT, HEX FLANGE 3/8-24 X 2.5     | 3   |      |
| (60)  |        | ASSEMBLY, COVER                   | 1   |      |
| (62)  |        | FILTER, BASE                      | 1   |      |
| (64)  |        | MAGNET                            | 1   |      |
| (56)  |        | CHECK PLUG ASSEMBLY, .027, WASHER | 2   |      |
| 58    | 50928  | SEALANT TUBE                      | 1   |      |
| 59    | 71357  | KIT, BYPASS ARM                   | 1   |      |
| 61    | 71497  | KIT, FILTER                       | 1   |      |
| (60)  |        | ASSEMBLY, COVER                   | 1   |      |
| (62)  |        | FILTER, BASE                      | 1   |      |
| (64)  |        | MAGNET                            | 1   |      |
| 98    | 53731  | TUBE AXLE 1.835                   | 1   |      |
| 101   | 53088  | CAP, AXLE                         | 1   |      |
| 124   | 71405  | KIT, HUB, 4 BOLT                  | 1   |      |
| 135   | 52401  | SPRING EXT .63 X 2.05             | 1   |      |
| 131   | 71341  | KIT, RTN SCREWS                   | 1   |      |
| 138   | 71510  | KIT, BREATHER                     | 1   |      |
| (126) |        | ASSEMBLY, FITTING 9/16            | 1   |      |
| (127) |        | HOSE, EXP TANK                    | 1   |      |
| (128) |        | CAP, BARBED VENT                  | 1   |      |
| 139   | 71524  | KIT, BREATHER                     | 1   |      |
| (128) |        | CAP, BARBED VENT                  | 1   |      |
| (126) |        | ASSEMBLY, FITTING 9/16            | 1   |      |
| 140   | 51946  | ARM, NEUTRAL LEFT                 | 1   |      |
| 209   | 72320  | KIT HUB PULLER                    | 1   |      |

# Brake Assembly

NOTICE - PROPRIETARY INFORMATION: THIS SERVICE SCHEMATIC AND ITS CONTENTS ARE WHOLLY OWNED BY HYDRO-GEAR OF SULLIVAN, IL. AND MAY NOT BE PUBLISHED OR REPRODUCED WITHOUT THE WRITTEN CONSENT OF HYDRO-GEAR.

## EZT SERVICE DRAWING 1" AXLE

MODEL NUMBER: Z - \* - \* - \*  
 CHARACTER #: 1 2 - 3 4 5 6 - 7 8 9 10 - 11 12 13 14

### COG BRAKE KITS

| CHAR 3  | CHAR 7     | CHAR 8 | ITEM # | COMPONENT # | DESCRIPTION                       | QTY |
|---------|------------|--------|--------|-------------|-----------------------------------|-----|
| A, B    | A, C, K, M | 2      | 55     | 71069       | KIT, BRAKE ARMW/CLEVIS PIN, LH    | 1   |
|         |            |        | (74)   |             | ARM, BRAKE                        | 1   |
|         |            |        | (70)   |             | PIN, CLEVIS                       | 1   |
|         |            |        | (71)   |             | BOLT, 1/4-20X1 SHOULDER W/PATCH   | 1   |
|         |            |        | 55     | 71070       | KIT, BRAKE ARMW/CLEVIS PIN, RH    | 1   |
|         |            |        | (74)   |             | ARM, BRAKE                        | 1   |
| D       | B, D, J, L | 2      | (70)   |             | PIN, CLEVIS                       | 1   |
|         |            |        | 55     | 71069       | KIT, BRAKE ARMW/CLEVIS PIN, LH    | 1   |
|         |            |        | (74)   |             | ARM, BRAKE                        | 1   |
|         |            |        | (70)   |             | PIN, CLEVIS                       | 1   |
|         |            |        | (71)   |             | BOLT, 1/4-20X1 SHOULDER W/PATCH   | 1   |
|         |            |        | 55     | 71070       | KIT, BRAKE ARMW/CLEVIS PIN, RH    | 1   |
| A, B, D | A, C, K, M | 3      | (74)   |             | ARM, BRAKE                        | 1   |
|         |            |        | 55     | 70885       | KIT, BRAKE ARM, THROUGH HOLE      | 1   |
|         |            |        | (71)   |             | BOLT, 1/4-20X1 SHOULDER W/PATCH   | 1   |
| A, B, D | A, C, K, M | 4      | 55     | 71356       | KIT, BRAKE ARM W/ SPRING          | 1   |
|         |            |        | (74)   |             | ARM, BRAKE                        | 1   |
| A, B, D | B, D, J, L | 5      | (75)   |             | SPRING, EXTENSION                 | 1   |
|         |            |        | (71)   |             | BOLT, 1/4-20X1 SHOULDER W/PATCH   | 2   |
|         |            |        | 55     | 71560       | KIT, BRAKE ARM, TOP MOUNT         | 1   |
| A, B, D | W          | 5      | (71)   |             | SPACER                            | 1   |
|         |            |        | (74)   |             | ARM, BRAKE                        | 1   |
|         |            |        | (73)   |             | HFHCS 1/4-20 X 2.0 (PATCH)        | 1   |
| A, B, D | A, C, K, M | 6      | 55     | 72578       | KIT, BRAKE ARM                    | 1   |
|         |            |        | (71)   |             | BOLT, 1/4-20 X 1 SHOULDER W/PATCH | 1   |
|         |            |        | (74)   |             | ARM, BRAKE                        | 1   |

### COG/MOTOR SHAFTS

| CHAR 7           | CHAR 8            | ITEM #     | COMPONENT #  | DESCRIPTION     | QTY          |              |
|------------------|-------------------|------------|--------------|-----------------|--------------|--------------|
| 2, 3, 4, 5, 6, X | A-D, J-M, W, Y, Z | A-D        | 39           | 51632           | SHAFT, MOTOR | 1            |
|                  |                   | 100        | 51635        | DISC, COG BRAKE | 1            |              |
|                  |                   | J-M, W     | 39           | 51845           | SHAFT, MOTOR | 1            |
|                  |                   | 100        | 51635        | DISC, COG BRAKE | 1            |              |
|                  |                   | Y, Z       | 39           | 51845           | SHAFT, MOTOR | 1            |
|                  |                   | B, C, D, E | A-D          | 39              | 52579        | SHAFT, MOTOR |
| J-M              | 39                | 52580      | SHAFT, MOTOR | 1               |              |              |

### DISC BRAKE

| CHAR 7 | ITEM # | COMPONENT # | DESCRIPTION | QTY |
|--------|--------|-------------|-------------|-----|
| B      | 55     | 71846       | KIT, BRAKE  | 1   |
| C      | 55     | 71892       | KIT, BRAKE  | 1   |
| D      | 55     | 71893       | KIT, BRAKE  | 1   |
| E      | 55     | 72082       | KIT, BRAKE  | 1   |

KITS INCLUDE ITEMS: 73, 74, 75, 100, 150, 151, 153, 154, 155, 156, 157, 158, 159, 160

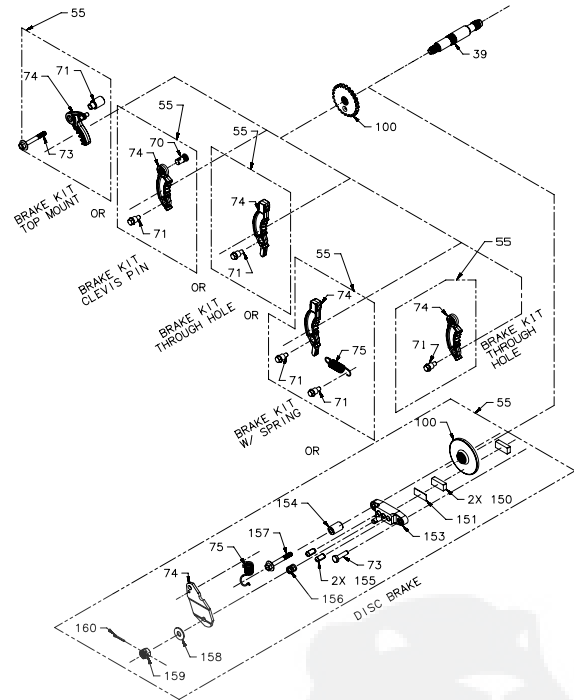

# Brake Assembly

| #    | PART # | DESCRIPTION                       | QTY | Note |
|------|--------|-----------------------------------|-----|------|
| 39   | 51632  | SHAFT MOTOR                       | 1   |      |
| 55   | 71069  | KIT, BRAKE ARM LH                 | 1   |      |
| (74) |        | ARM, BRAKE                        | 1   |      |
| (70) |        | PIN, CLEVIS                       | 1   |      |
| (71) |        | BOLT, 1/4 - 20X1 SHOULDER W/PATCH | 1   |      |
| 100  | 51635  | DISC, COG BRAKE                   | 1   |      |

