

312-1500

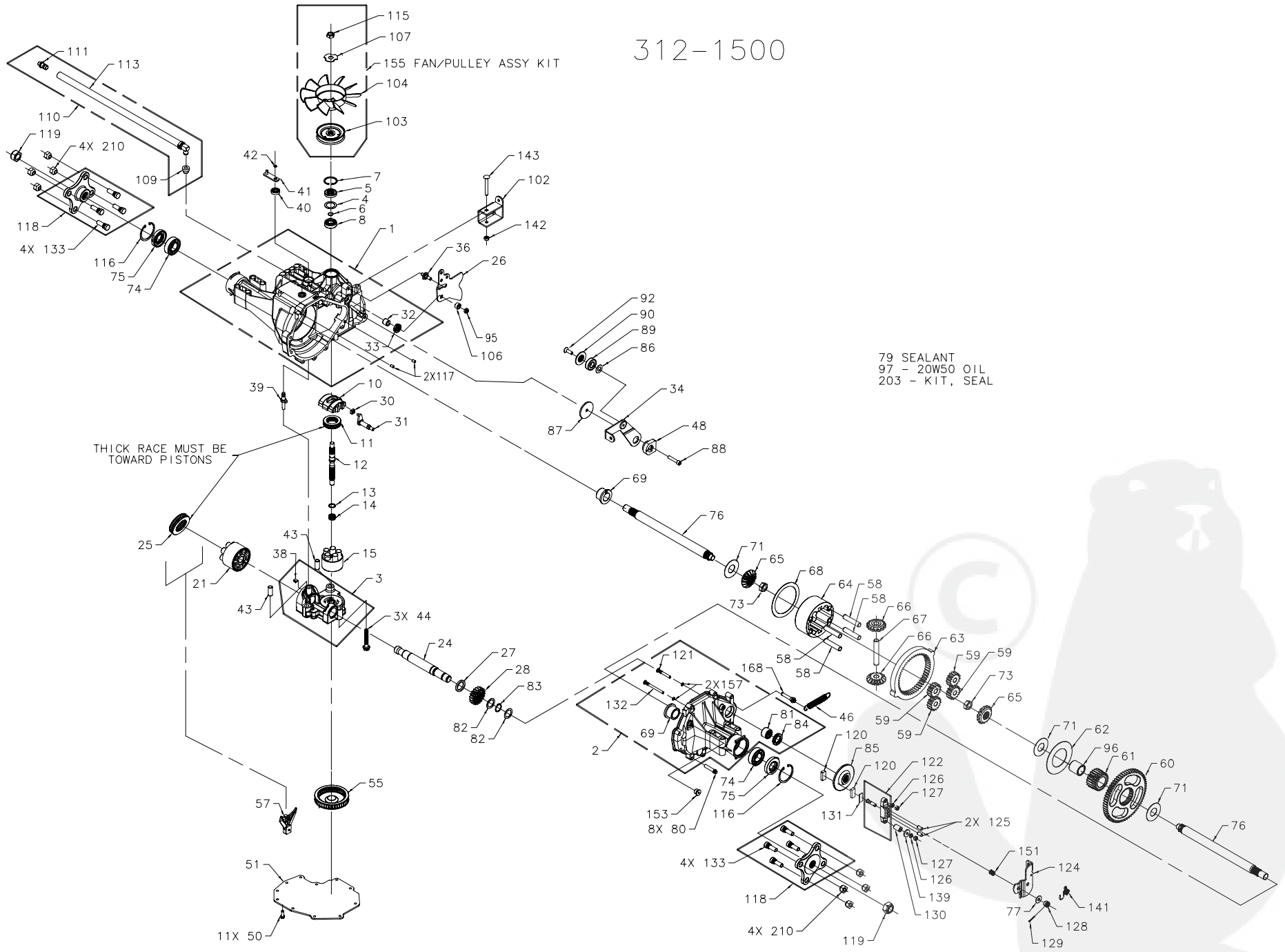

79 SEALANT
97 - 20W50 OIL
203 - KIT, SEAL

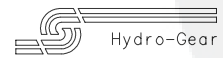

312-1500

ITEM#	PART #	QTY	DESCRIPTION
1	70297	1	MAIN HOUSING ASSEMBLY
		1	MAIN HOUSING
		1	LIP SEAL
		1	FLANGE BEARING
		1	TRUNNION BUSHING
		2	CRADLE BEARING
2	70298	1	R. H. HOUSING ASSEMBLY
		1	R. H. HOUSING
		1	FLANGE BEARING
		2	O-RING
		1	RIB NECK BOLT, 2"
		1	RIB NECK BOLT, 3"
		1	NEEDLE BEARING (SCE1412)
		1	LIP SEAL (.875 ID X 1.30 OD X .25)
3	70913	1	KIT, CENTER SECTION
		1	CENTER SECTION
		1	BUSHING .90 X 1.02 X .75
		1	PLATE, BYPASS
		1	CHECK PLUG ASSEMBLY, .027
		1	CHECK PLUG ASSEMBLY, BLANK
		1	SPACER
4	2003018	1	LIP, SEAL 15 X 35 X 7
5	9008000-0128	1	RING, WIRE RETAINING
6	2003016	1	RING, RETAINING
7	2003052	1	BEARING, BALL 15 X 35 X 11
8	2003043	1	SWASHPLATE, VARIABLE
10	2003087	1	BEARING, THRUST 30 X 52 X 13
11	50551	1	SHAFT, INPUT
12	50005	1	WASHER, THRUST .591 X .787 X .040
13	2003017	1	SPRING, BLOCK
14	2003014	1	BLOCK ASSEMBLY, 5 PISTON 10cc
15	70331	1	BLOCK CYLINDER, 5 PISTON 10cc
		5	PISTON
		5	SPRING, PISTON
		5	WASHER, THRUST
21	70082	1	21cc CYLINDER BLOCK ASSEMBLY
		1	21cc CYLINDER BLOCK
		7	21cc PISTON
		7	21cc PISTON SPRING
		7	PISTON SEAT WASHER
24	50662	1	SHAFT, MOTOR
25	50552	1	BEARING, THRUST 42 X 68 X 16
26	51250	1	ARM, CONTROL
27	50774	1	SPACER
28	51600	1	GEAR, 19T PINION
30	2000015	1	SLOT GUIDE
31	50807	1	ARM, TRUNNION TAPERED SQUARE
32	2003009	1	BUSHING, TRUNNION
33	9008000-0126	1	SEAL, LIP 12 X 25 X 7
34	51127	1	ARM, RETURN
36	50426	1	STUD, SHORT 5/16-24
38	70680	1	KIT, BYPASS PLATE
39	2003555	1	ACTUATOR, BYPASS
40	45074	1	SEAL, LIP 10 X 25 X 7
41	50270	1	ARM, BYPASS - STUD & HOLE
42	44870	1	RING, RETAINING
43	50002	2	PIN
44	50016	3	SCREW 3/8-24 X 2.5

ITEM#	PART #	QTY	DESCRIPTION
46	51199	1	SPRING, NEUTRAL
48	51097	1	PUCK, ADJUSTING
50	50752	11	SCREW, 1/4-20 X .75
51	51128	1	COVER, LOWER W/O KIDNEYS
55	50990	1	FILTER
57	50796	1	RETAINER, MOTOR BEARING
58	50776	4	PIN, CARRIER
59	50763	4	GEAR, 15T PLANET
60	51599	1	GEAR, 64T SPUR
61	50645	1	GEAR, 21 TOOTH SUN
62	50769	1	PLATE, PLANET THRUST
63	50764	1	GEAR, 51T RING
64	50765	1	CARRIER, PLANETARY
65	50647	2	GEAR, BEVEL (SPLINED)
66	50648	2	GEAR, BEVEL (CROSS SHAFT)
67	50766	1	SHAFT, DIFFERENTIAL
68	50767	1	PLATE, DIFF. THRUST
69	50768	2	BEARING, FLANGE
71	50788	3	WASHER 1.0 X 2.25 X .04
73	50791	2	NUT, HEX JAM 5/8-18
74	50771	2	BEARING, BALL 6205-1
75	50772	2	SEAL 1 ID X 2.0472 X .375
76	50825	2	SHAFT, AXLE, 1 X 14.2 SPLINED
77	44130	1	WASHER .343 X .880 X .062
79	50928	1	SEALANT
80	50868	8	SCREW, TORX HEAD 5/16-18
81	44752	1	BEARING, NEEDLE (SCE1412)
82	50777	2	WASHER .885 X 1.250 X .038
83	50775	1	RING, RETAINING
84	50773	1	SEAL, LIP .875 I.D. X 1.3 O.D. X .25
85	50779	1	DISK, BRAKE
86	50132	1	WASHER .5 X 1.0 X .03
87	50836	1	WASHER .324 X 1.960 X .146
88	50837	1	SCREW, 5/16-24 X 1-1/2
89	44147	1	BEARING
90	51200	1	SPACER, LOCATING
92	50870	1	SCREW, COUNTERSUNK 5/16-18
95	50108	1	NUT, HEX LOCK 5/16-24
96	50866	1	BEARING, SLEEVE
97		126.7oz	20W-50 OIL
102	50813	1	BRACKET, TORQUE
103	51925	1	ASSEMBLY, HUB/PULLEY 3.25
104	51862	1	FAN 7.0 (10 BLADE)
106	50850	1	SPACER, TRUNNION
107	51523	1	WASHER, OD SLOTTED .53 X 1.55 X .06
109	50133	1	BUSHING-VENT (RUBBER)
110	70302	1	FITTING KIT
		1	BUSHING, RUBBER
		1	CAP-VENT ASSEMBLY
		1	KIT, 90° FITTING & HOSE ASSEMBLY
111	70109	1	VENT, CAP ASS'Y
		1	VENT, PLASTIC
		1	VENT, CAP

ITEM#	PART #	QTY	DESCRIPTION
113	70301	1	KIT, 90° FITTING & HOSE ASS'Y
		1	FITTING, 90° METAL
		1	CLAMP, PINCH
		1	HOSE, .5" X 20" LONG
115	44133	1	NUT, JAM 1/2-20 PATCH
116	50859	2	RING, RETAINING
117	9004800-2506	2	PIN, STD HDLS
118	70276	2	HUB ASSEMBLY
		4	STUD, 7/16-14
		1	HUB
		2	NUT, HEX 3/4-16
119	50863	2	PUCK, BRAKE
120	44132	2	BOLT, RIB NECK 2"
121	50874	1	YOKE, BRAKE ASSEMBLY
122	70633	1	ARM, BRAKE
124	50916	1	PINS, BRAKE
125	44127	2	LOCKWASHER, 1/4"
126	43177	2	NUT, 1/4-20
127	43178	2	NUT, CASTLE 5/16-24
128	44142	1	PIN, COTTER
129	44101	1	SPACER
130	23711	1	PUCK, PLATE
131	44134	1	BOLT, RIB NECK 3"
132	50865	8	STUD, 7/16-14 X 1.35 (RIB NECK)
133	50869	1	WASHER, 7/8 OD X .265 ID X .125 THK
139	44278	1	SPRING, BRAKE ARM BIAS
141	50884	1	NUT, HEX 5/16-18 LOCK
142	43064	1	BOLT, 5/16-18 X 2.5
143	50886	1	COMP SPRING, BRAKE ANTI-DRAG
151	50919	1	PLUG, STRAIGHT THREAD
153	9005110-5600	1	KIT, FAN/PULLEY
155	70995	1	NUT, JAM 1/2-20
		1	ASSEMBLY, HUB/PULLEY 3.25
		1	FAN 7.0 (10 BLADE)
		1	WASHER, OD SLOTTED .53 X 1.55 X .06
		2	O-RING, .070 X .239
157	50977	1	SCREW, SHOULDERED TORX HEAD 5/16-18
168	51151	1	KIT, SEAL
203	70492	1	SEAL-LIP 15 X 5 X 37
		1	SEAL-LIP 12 X 25 X 7
		1	SEAL-LIP 10 X 25 X 7
		1	O-RING, .103 X 1.862
		2	SEAL, LIP 1.000 X 2.049 X .375
		1	SEAL, LIP (.875 I.D. X 1.375 O.D. X .25)
		2	O-RING, .070 X .239
		1	KIT, O-RING, MANIFOLD
210	51656	8	NUT, LUG 7/16-14

