

28701D03  
317-0710

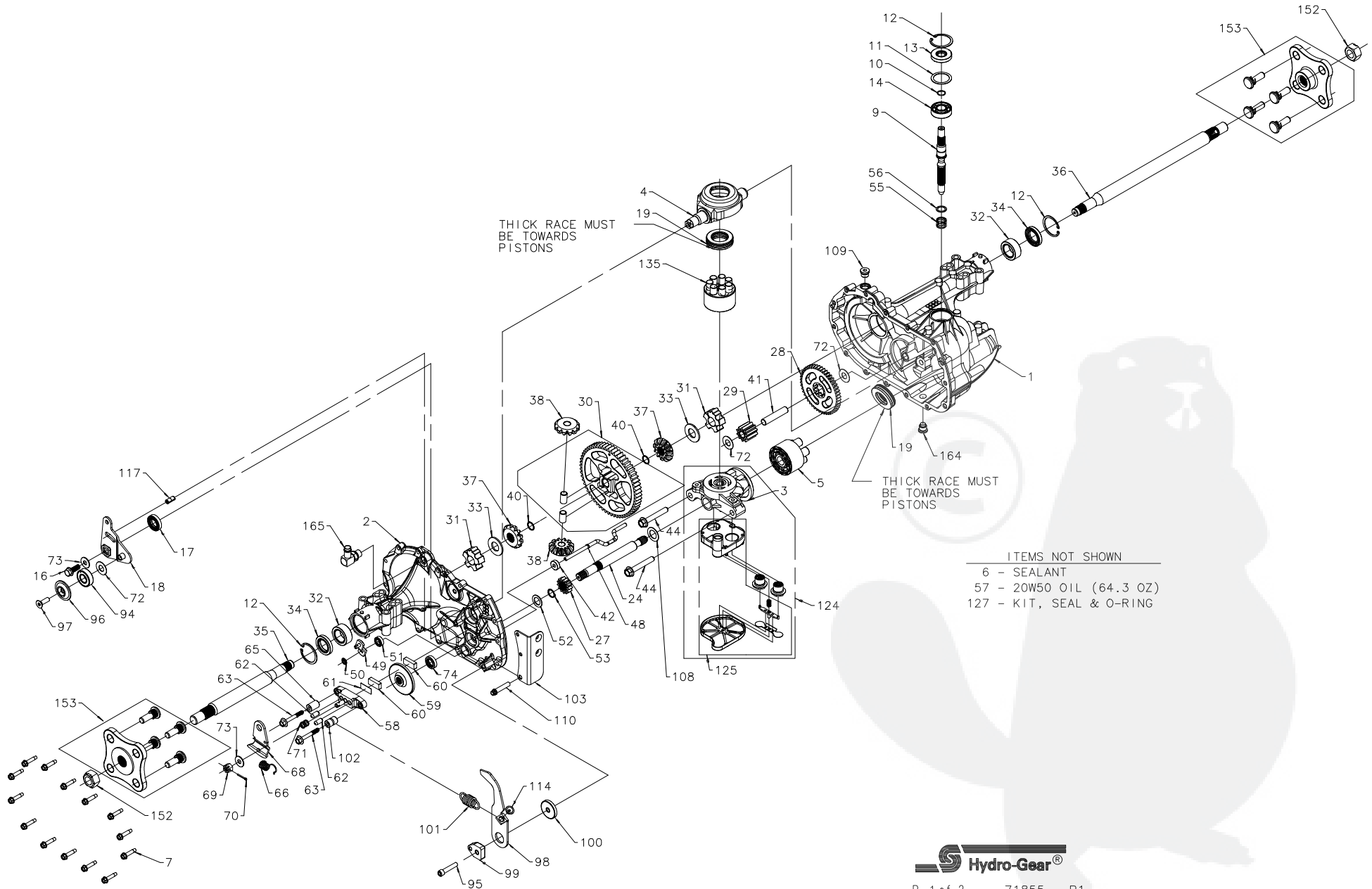

28701D03  
317-0710

ITEM	PART NUMBER	QTY	DESCRIPTION
1	71623	1	ASSEMBLY, MAIN HOUSING
		1	HOUSING, EP MAIN, DRAIN, SHOT
		1	BUSHING .865 X .985 X .790
		2	PIN, STANDARD HEADLESS
2	71624	1	ASSEMBLY, SIDE HOUSING
		1	HOUSING, EP SIDE, SHOT
		1	BUSHING .865 X .985 X .790
		1	BUSHING, .624 X .719 X .562
3	70724	1	ASSEMBLY, CENTER SECTION
		1	CENTER SECTION (7-PISTON)
		1	BUSHING, .707 X .788 X .591
4	51048	1	TRUNNION, SWASHPLATE
5	70331	1	ASSEMBLY, BLOCK
		1	BLOCK, CYLINDER
		5	PISTON
		5	SPRING, COMPRESSION
		5	WASHER, THRUST
6	50928	10.1 OZ	SEALANT
7	53246	14	SCREW, HEX WASHER 1/4-20 X 1.125
9	51062	1	SHAFT, INPUT
10	2000022	1	RING, RETAINING
11	50951	1	WASHER, FLAT 1.23 X 1.57 X .04
12	50329	3	RING, RETAINING
13	51161	1	SEAL, LIP 17 X 40 X 7
14	50315	1	BEARING, BALL 17 X 40 X 12
16	51064	1	BOLT, HEX FLANGE 5/16-24 X .94 W/PATCH
17	51140	1	SEAL, LIP 18 X 32 X 7
18	51121	1	ARM, CONTROL
19	50551	2	BEARING, THRUST 30 X 52 X 13
24	50966	1	SHAFT, MOTOR
27	51130	1	GEAR, 13T PINION
28	51129	1	GEAR, 10T/48T
29	51043	1	GEAR, 10T JACKSHAFT
31	51088	2	BUSHING, SLEEVE (INBOARD)
32	51517	2	BUSHING, SLEEVE 1.002 X 1.571 X .625
33	44875	2	WASHER, FLAT .77 X 1.5 X .10
34	51518	2	SEAL, LIP 1.00 X 1.577 X .250
35	52218	1	SHAFT, AXLE, BLACK 1.00/.75 X 10.65 (FLANGE, RH)
36	52219	1	SHAFT, AXLE, BLACK 1.00/.75 X 16.25 (FLANGE, RH)
37	51829	2	GEAR, STEEL MITER 12T (SPLINED)
38	51830	2	GEAR, STEEL MITER 12T (.50 ID)
40	44871	2	RING, SPIRAL RETAINING
41	51083	1	PIN, JACKSHAFT .50 X 2.43
42	51100	1	MAGNET, RING
44	50016	2	BOLT, HEX FLANGE 3/8-24 X 2.5
48	51098	1	ROD, ACTUATOR BYPASS
49	52223	1	ARM, BYPASS
50	51116	1	RING, RETAINING .250 EXTERNAL
51	51081	1	SEAL, LIP .250 X .750 X .250 TC
52	44371	1	WASHER, FLAT .63 X 1.00 X .05
53	44145	1	RING, RETAINING
54	51071	1	BUSHING, CENTER BLOCK
55	2003014	1	SPRING, BLOCK
56	2003017	1	WASHER, THRUST .59 X .79 X .04
57		64.3 OZ	OIL, 20W50
58	62589	1	KIT, BRAKE YOKE
		1	YOKE, BRAKE
		1	BOLT, SQ.HD. 5/16-24 RIBBED
59	51072	1	DISK, BRAKE
60	44132	2	PUCK, BRAKE
61	44134	1	PLATE, PUCK
62	44127	2	PIN, BRAKE ACTUATING
63	51146	2	BOLT, HEX HD 1/4-20 X 2 W/PATCH
65	23711	1	SPACER, .26 X .57 X .87
66	50884	1	SPRING, BRAKE ARM BIAS
68	51142	1	ARM, BRAKE

ITEM	PART NUMBER	QTY	DESCRIPTION
69	44142	1	NUT, CASTLE 5/16-24
70	44101	1	PIN, COTTER 3/32 X 3/4
71	50919	1	SPRING, COMPRESSION BRAKE ANTI-DRAG
72	50132	3	WASHER, FLAT .51 X 1.0 X .03
73	44130	2	WASHER, FLAT .34 X .88 X .06
74	70719	1	KIT, SEAL
		1	SEAL, LIP .625 X 1.0 X .25
		1	RING, RET - STAR WASHER
		1	BULLETIN, SHAFT SEAL
94	44147	1	BEARING, BALL .62 X 1.38 X .44
95	50837	1	SCREW, SOCKET HD CAP 5/16-24 X 1.5
96	51200	1	SPACER, LOCATING
97	50870	1	SCREW, COUNTERSUNK 5/16-18 X 1.0
98	51356	1	ARM, RETURN
99	51097	1	PUCK, ADJUSTING
100	52493	1	WASHER, FLAT .32 X 1.60 X .24
101	51131	1	SPRING, EXTENSION DOUBLE LOOP
102	51123	1	SPACER, .26 X .56 X .87
103	51223	1	BRACKET, TORQUE
108	51069	1	WASHER, FLAT .71 X 1.16 X .04
109	9005110-5600	1	PLUG, 9/16-18 (METAL)
110	50868	1	SCREW, TORX HD 5/16-18 x 1.5
114	51184	1	SPRING GUIDE
117	51124	1	PIN, SPRING .304 x .75
124	71297	1	ASSEMBLY, CENTER SECTION, FILTER, BYPASS
		1	CENTER SECTION (7-PISTON)
		1	BASE, FILTER W/POPPET
		1	CHECK PLUG ASSEMBLY, .044 BLEED, WASHER
		1	CHECK PLUG ASSEMBLY, NO BLEED, WASHER
		1	SPRING, BYPASS .50 IN
		1	ACTUATOR, BYPASS
		1	DEFLECTOR
		1	BOTTOM, FILTER
		1	BUSHING, .707 X .788 X .591
125	70756	1	ASSEMBLY, FILTER
		1	BASE, FILTER W/POPPET
		1	SPRING, BYPASS .50 IN
		1	ACTUATOR, BYPASS
		1	DEFLECTOR
		1	BOTTOM, FILTER
127	70722	1	KIT, SEAL & O-RING
		1	SEAL, LIP 17 X 40 X 7
		1	SEAL, LIP 18 X 32 X 7
		2	SEAL, LIP 1.00 X 1.577 X .250
		1	SEAL, LIP .250 X .750 X .250
		1	SEAL, LIP .625 X 1.0 X .25
		1	O-RING, .299 x .505 x .103
135	70723	1	ASSEMBLY, BLOCK
		1	BLOCK, CYLINDER
		7	PISTON
		7	SPRING, COMPRESSION
		7	WASHER, THRUST
152	50863	2	NUT, HEX LOCK 3/4-16
153	71298	2	ASSEMBLY, HUB
		1	HUB, 4 STUD METRIC (PAINTED)
		4	STUD, M12 X 1.5 (RIB NECK)
164	51932	1	PLUG, 9/16-18 (MAGNETIC)
165	50589	1	FITTING, 90° 9/16 SAE BEADED
200	71829	1	KIT, 60T BULL GEAR DIFF PINS
		1	GEAR, 60T
		2	PIN, 0.5 OD
		1	BULLETIN, BULL GEAR

