

# XGS-PH3000BS

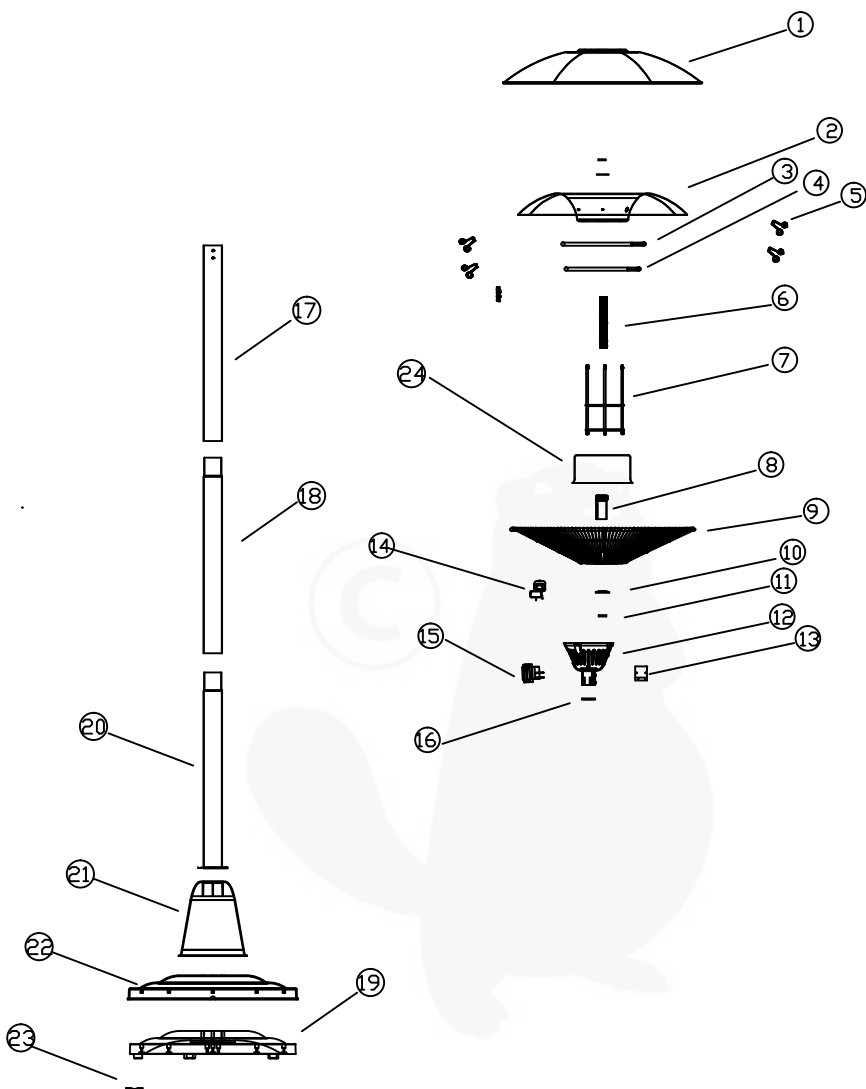

	<b>Réf.</b>	<b>Déscription</b>	<b>Qt</b>
1	GS-PH3000BS-1	Upper shield	1
2	GS-PH3000BS-2	Lamp cover support	1
3	GS-PH3000BS-3	Lamp A	1
4	GS-PH3000BS-4	Lamp B	5
5	GS-PH3000BS-5	Lamp fixed buckle	1
6	GS-PH3000BS-6	Center link rod	1
7	GS-PH3000BS-7	Support frame	1
8	GS-PH3000BS-8	Connecting screw rod set	1
9	GS-PH3000BS-9	Mesh enclosure	1
10	GS-PH3000BS-10	Big spacer	1
11	GS-PH3000BS-11	Nut	1
12	GS-PH3000BS-12	Terminal cover	1
13	GS-PH3000BS-13	Tip-over stand	1
14	GS-PH3000BS-14	Tip-over switch	1
15	GS-PH3000BS-15	Switch	2
16	GS-PH3000BS-16	Stator line hole	1
17	GS-PH3000BS-17	Top tube	1
18	GS-PH3000BS-18	Central casting pipe	1
19	GS-PH3000BS-19	Balancing weight	1
20	GS-PH3000BS-20	Bottom tube	1
21	GS-PH3000BS-21	Decorate cap	1
22	GS-PH3000BS-22	Chassis	1
23	GS-PH3000BS-23	Tension disc	1
24	GS-PH3000BS-24	Heat shield	1

