

# PNBC415、PNBC520引擎（动力总成）爆炸图

[普通、易启动2种装置]

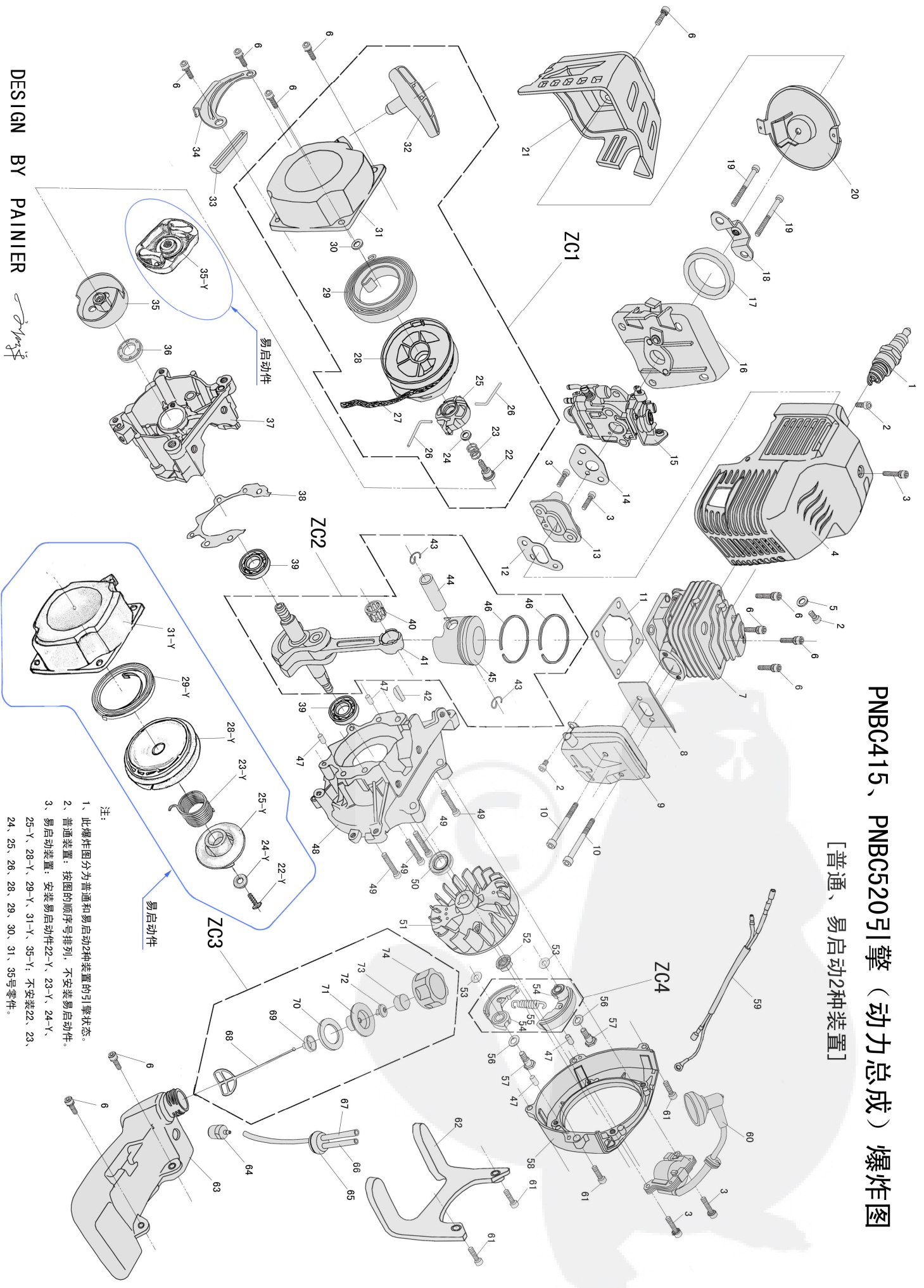

注：

- 1、此爆炸图分为普通和易启动2种装置的引擎状态。
- 2、普通装置：按图的顺序号排列，不安装易启动件。
- 3、易启动装置：安装易启动件22-Y、23-Y、24-Y、25-Y、28-Y、29-Y、31-Y、35-Y；不安装22、23、24、25、26、28、29、30、31、35号零件。

DESIGN BY PAINIER *zhong*

## PNBC415 ENGINE

EXPLOED NUMBER	Référence	DISCRIPTION	
1	PNBC415-1	SPARK PLUG	
2	PNBC415-2	SCREW M5*10	
3	PNBC415-3	SCREW M5X25	
4	PNBC415-4	COVER CYLINDER	
5	PNBC415-5	GASKET Ø5	
6	PNBC415-6	SCREW M5X20	
7	PNBC415-7	CYLINDER	
8	PNBC415-8	GASKET-MUFFLER	
9	PNBC415-9	MUFFLER	
10	PNBC415-10	SCREW M6X55	
11	PNBC415-11	GASKET-CYLINDER	
12	PNBC415-12	GASKET-INTAKE	
13	PNBC415-13	BOOT-INTAKE	
14	PNBC415-14	GASKET-CARBURETOR	
15	PNBC415-15	CARBURETOR	
16	PNBC415-16	AIR FILTER	
17	PNBC415-17	SPONGE-AIR FILTER	
18	PNBC415-18	AIR FILTER SUPPORTER	
19	PNBC415-19	SCREW M5X55	
20	PNBC415-20	SPONGE FIXED BOARD	
21	PNBC415-21	COVER- AIR FILTER	
22	PNBC415-22	SCREW	
22-Y	PNBC415-22Y	SCREW ST408X12	
23	PNBC415-23	SPRING	
23-Y	PNBC415-23Y	EASY START SPRING	
24	PNBC415-24	GASKET	
24-Y	PNBC415-24Y	GASKET Ø5	
25	PNBC415-25	SMALL PULLEY STARTER	
25-Y	PNBC415-25Y	PULLEY STARTERr-EASY START	
26	PNBC415-26	START STEM	
27	PNBC415-27	ROPE-STARTER	
28	PNBC415-28	PULLEY STARTER	
28-Y	PNBC415-28Y	PULLEY STARTER-EASY START	
29	PNBC415-29	SPRING -START	
29-Y	PNBC415-29Y	EASY START SPRING	
30	PNBC415-30	GASKET	
31	PNBC415-31	START COVER	
31-Y	PNBC415-31Y	EASY START COVER	
32	PNBC415-32	HANDLE-START	
33	PNBC415-33	RUBBER	
34	PNBC415-34	OIL TANK SUPPORTER	
35	PNBC415-35	COMMON START PULLEY	
35-Y	PNBC415-35Y	EASY START PULLEY	
36	PNBC415-36	SMALL OIL SEAL	
37	PNBC415-37	LEFT-CRANK CASE	

38	PNBC415-38	CRANKCASE- GASKET	
39	PNBC415-39	BEARING-BALL	
40	PNBC415-40	NEEDLE BEARING-BALL	
41	PNBC415-41	CRANK SHAFT	
42	PNBC415-42	WOODRUFF KEY 3x13	
43	PNBC415-43	RING-SNAP	
44	PNBC415-44	PIN-PISTON	
45	PNBC415-45	PISTON	
46	PNBC415-46	PISTON-RING	
47	PNBC415-47	PIN $\Phi$ 5X10	
48	PNBC415-48	RIGHT-CRANK CASE	
49	PNBC415-49	SCREW M5X30	
50	PNBC415-50	BIG OIL SEAL	
51	PNBC415-51	FLY-WHEEL-ASSY elec	
52	PNBC415-52	NUT M8	
53	PNBC415-53	GASKET $\Phi$ 8	
54	PNBC415-54	CLUTCH SUPPORT	
55	PNBC415-55	SPRING CLUTCH	
56	PNBC415-56	SPRING $\phi$ 10	
57	PNBC415-57	SCREW	
58	PNBC415-58	SIDE COVER	
59	PNBC415-59	WIRE-SWITCH	
60	PNBC415-60	ELECTRIC IGNITION ASSY	
61	PNBC415-61	SCREW M5X20	
62	PNBC415-62	OIL TANK SUPPORTER	
63	PNBC415-63	TANK	
64	PNBC415-64	FUEL FILTER	
65	PNBC415-65	SUPPORT-HOSE OIL	
66	PNBC415-66	HOSE CHAIN OIL	
67	PNBC415-67	FUEL INTAKE	
68	PNBC415-68	HOLDING-OIL CAP	
69	PNBC415-69	HOLDING-OIL CAP SUPPORTER	
70	PNBC415-70	WASHER-FUEL OIL CAP	
71	PNBC415-71	SUPPORT-WENTHOLE	
72	PNBC415-72	VENTHOLE	
73	PNBC415-73	FILTER PULP	
74	PNBC415-74	CAP-FUEL OIL	
ZC1	PNBC415-ZC1	START-ASSY	
ZC2	PNBC415-ZC2	CRANKSHAFT ASSY	
ZC3	PNBC415-ZC3	FUEL CAP ASSY	
ZC4	PNBC415-ZC4	CLUTCH ASSY	

# PNM430多功能机爆炸图

[2010年03月版]

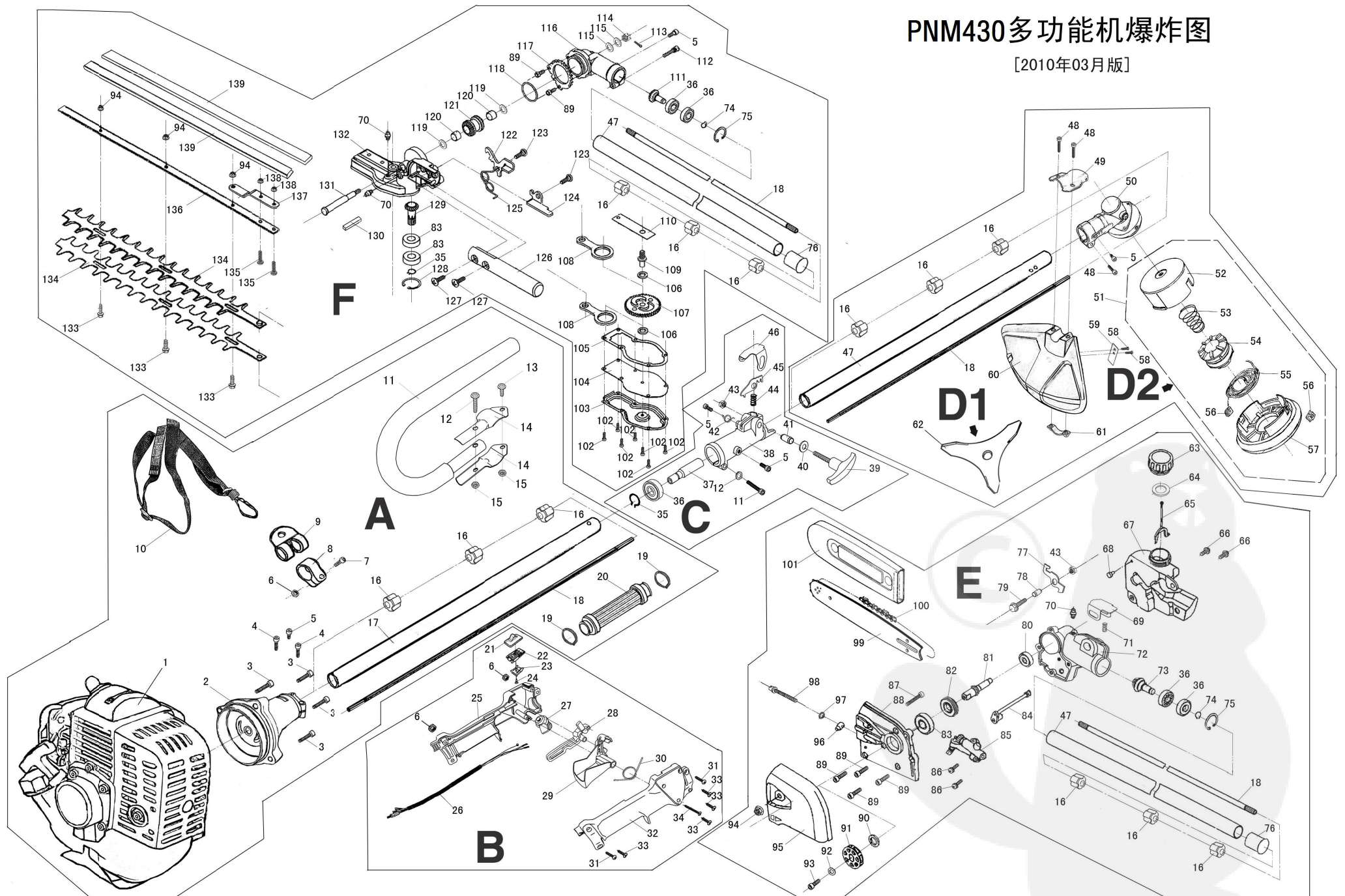

DESIGN BY PAINIER 

Screw blade (M10x125): 640-0818

## PNM430 EXPLOED VIEW LIST

EXPLOED NUMBER	Référence	QTY	DISCRIPTION
1	PNM430-1	1	engine assy
2	PNM430-2	1	output support
<a href="#">3</a>	PNM430-3	4	screw M6X16
4	PNM430-4	2	screw M5X22
5	PNM430-5	5	screw M5X10
6	PNM430-6	5	nut M5
7	PNM430-7	1	screw M5X20
8	PNM430-8	1	support-pothook
9	PNM430-9	1	POTHOOK
10	PNM430-10	1	belt assy
11	PNM430-11	3	screw M5X30
12	PNM430-12	3	washer
13	PNM430-13	1	D-HANDLE
14	PNM430-14	1	round set
15	PNM430-15	2	plate-handle (1)
16	PNM430-16	12	Oil Bearing
17	PNM430-17	1	ALUMINOUS PIPE
18	PNM430-18	4	DRIVE SHAFT
19	PNM430-19	2	spring
20	PNM430-20	1	middle support
21	PNM430-21	1	switch cover
22	PNM430-22	1	switch board
23	PNM430-23	1	plate-stop
24	PNM430-24	1	screw ST2.5X6
25	PNM430-25	1	left cover-control handle
26	PNM430-26	1	SWITCH WIRE ASSY
27	PNM430-27	1	spring trigger adjustor
28	PNM430-28	1	LEVER-SAFETY TRIGGER
29	PNM430-29	1	trigger
30	PNM430-30	1	spring
31	PNM430-31	2	screw M5X18
32	PNM430-32	1	right cover-control handle
33	PNM430-33	4	screw ST3.9X16
34	PNM430-34	1	screw ST2.9X30
35	PNM430-35	2	spring ring Φ12

36	PNM430-36	5	bearing-ball
37	PNM430-37	1	Connector shaft
38	PNM430-38	1	cover-connector
39	PNM430-39	1	Knob
40	PNM430-40	1	washer
41	PNM430-41	1	knob support
42	PNM430-42	1	spring
43	PNM430-43	2	nut M6
44	PNM430-44	1	spring
45	PNM430-45	1	jaw
46	PNM430-46	1	platr
47	PNM430-47	3	Output tube
48	PNM430-48	2	screw M6X25
49	PNM430-49	1	cover-Block grass plate
50	PNM430-50	1	BIG GAER BOX ASSY
51	PNM430-51	1	big nylon cutter assy
52	PNM430-52	1	COVER-NYLON CUTTER
53	PNM430-53	1	SPRING-NYLON CUTTER
54	PNM430-54	1	ROPE SHAFT-NYLON CUTTER
55	PNM430-55	1	ROPE-NYLON CUTTER
56	PNM430-56	2	JACKET-NYLON CUTTER
57	PNM430-57	1	SUPPORT-NYLON CUTTER
58	PNM430-58	2	screw ST4.2X16
59	PNM430-59	1	small blade
60	PNM430-60	1	Block grass plate
61	PNM430-61	1	plate-Block grass plate
62	PNM430-62	1	3 teeth blade
63	PNM430-63	1	cap-hous oil
64	PNM430-64	1	washer-oil tank
65	PNM430-65	1	washer-oil tank
66	PNM430-66	2	screw M5X12
67	PNM430-67	1	oil tank
68	PNM430-68	1	VENTHOLE
69	PNM430-69	1	cover
70	PNM430-70	3	NOTE GREASE NIPPLE
71	PNM430-71	1	COILER
72	PNM430-72	1	Drive Box
73	PNM430-73	1	OUTPUT GEAR

74	PNM430-74	1	spring ring $\Phi$ 9
75	PNM430-75	1	ring $\Phi$ 24
76	PNM430-76	2	Anti-block out
77	PNM430-77	1	Limit board
78	PNM430-78	1	suppotr-Limit board
79	PNM430-79	1	nut M6X30
80	PNM430-80	1	BEARING-BALL
81	PNM430-81	1	Gear shaft
82	PNM430-82	1	worm
83	PNM430-83	1	BEARING-BALL
84	PNM430-84	1	hous oil
85	PNM430-85	1	oil pump assy
86	PNM430-86	2	screw M4X10
87	PNM430-87	1	screw M6X30
88	PNM430-88	1	cover-Drive Box
89	PNM430-89	6	screw M5X12
90	PNM430-90	1	big washer
91	PNM430-91	1	sprock
92	PNM430-92	1	washer
93	PNM430-93	1	screw M6X10
94	PNM430-94	4	nut M6
95	PNM430-95	1	left housing cover
96	PNM430-96	1	Tension axis
97	PNM430-97	1	spring washer
98	PNM430-98	1	screw
99	PNM430-99	1	bar
100	PNM430-100	1	chain assy
101	PNM430-101	1	cover-bar
102	PNM430-102	7	screw M4
103	PNM430-103	1	cover-box
104	PNM430-104	1	plate-box
105	PNM430-105	1	washer-tank
106	PNM430-106	2	ANTI-FRICTION PAD
107	PNM430-107	1	round gear box
108	PNM430-108	2	CAM PLATE
109	PNM430-109	1	FIXED SHAFT
110	PNM430-110	1	plate
111	PNM430-111	1	INPUT GEAR SHAFT

112	PNM430-112	1	screw M5X25
113	PNM430-113	1	pin
114	PNM430-114	1	nut M6
115	PNM430-115	2	washer
116	PNM430-116	1	GEAR-SMALL BOX
117	PNM430-117	1	GEAR PLATE
118	PNM430-118	1	O type ring
119	PNM430-119	2	ANTI-FRICTION PAD
120	PNM430-120	2	NEEDLE BEARING-BALL
121	PNM430-121	1	BILATERAL HELICAL GEAR
122	PNM430-122	1	location bayonet
123	PNM430-123	2	screw
124	PNM430-124	1	Locking Buckle
125	PNM430-125	1	spring
126	PNM430-126	1	grip
127	PNM430-127	2	screw M5X20
128	PNM430-128	1	ring $\Phi$ 28
129	PNM430-129	1	OUTPUT GEAR SHAFT
130	PNM430-130	1	felt
131	PNM430-131	1	gear box-drive shaft
132	PNM430-132	1	GEAR-BIG BOX
133	PNM430-133	3	screw
134	PNM430-134	2	big blade
135	PNM430-135	2	screw M5X20
136	PNM430-136	1	BLADE RACK
137	PNM430-137	1	plate-blade rack
138	PNM430-138	2	nut M5
139	PNM430-139	2	support-blade
A	PNM430-A	1	Power output assy
B	PNM430-B	1	contracting handle assy
C	PNM430-C	1	Connectors assy
D1	PNM430-D1	1	blade assy
D2	PNM430-D2	1	nylon cutter
E	PNM430-E	1	Pole Chainsaw assy
F	PNM430-F	1	Hedge Shear assy