

# 80LB SPREADER

## ASSEMBLY AND OPERATING INSTRUCTION MANUAL



# IMPORTANT INSTRUCTIONS

## 1. HELPFUL HINTS:

READ THE DIRECTIONS BEFORE ASSEMBLY

WHEN ALL ELSE FAILS, READ THE DIRECTIONS AGAIN

- If your spreader does not spread evenly, be sure the FRONT on the gear box points to the front of the spreader. The impeller must turn clockwise. Reversing the gear box will cause the impeller to turn counter clockwise. Clean the impeller plate after each use. Fertilizer stuck on the impeller blades will cause uneven spreading.
- Your spreader is designed to be pushed at three miles per hour, which is a brisk walking speed. Slower or faster speeds will change the spread patterns. Wet fertilizer will also change the spread pattern and flow rate. Clean your spreader thoroughly after each use. Wash between the shut off plate and bottom of the hopper.
- Gears are permanently lubricated at the factory. Do not open the gear box or dirt may enter.

## 2. Remove and identify loose parts from carton and bag.

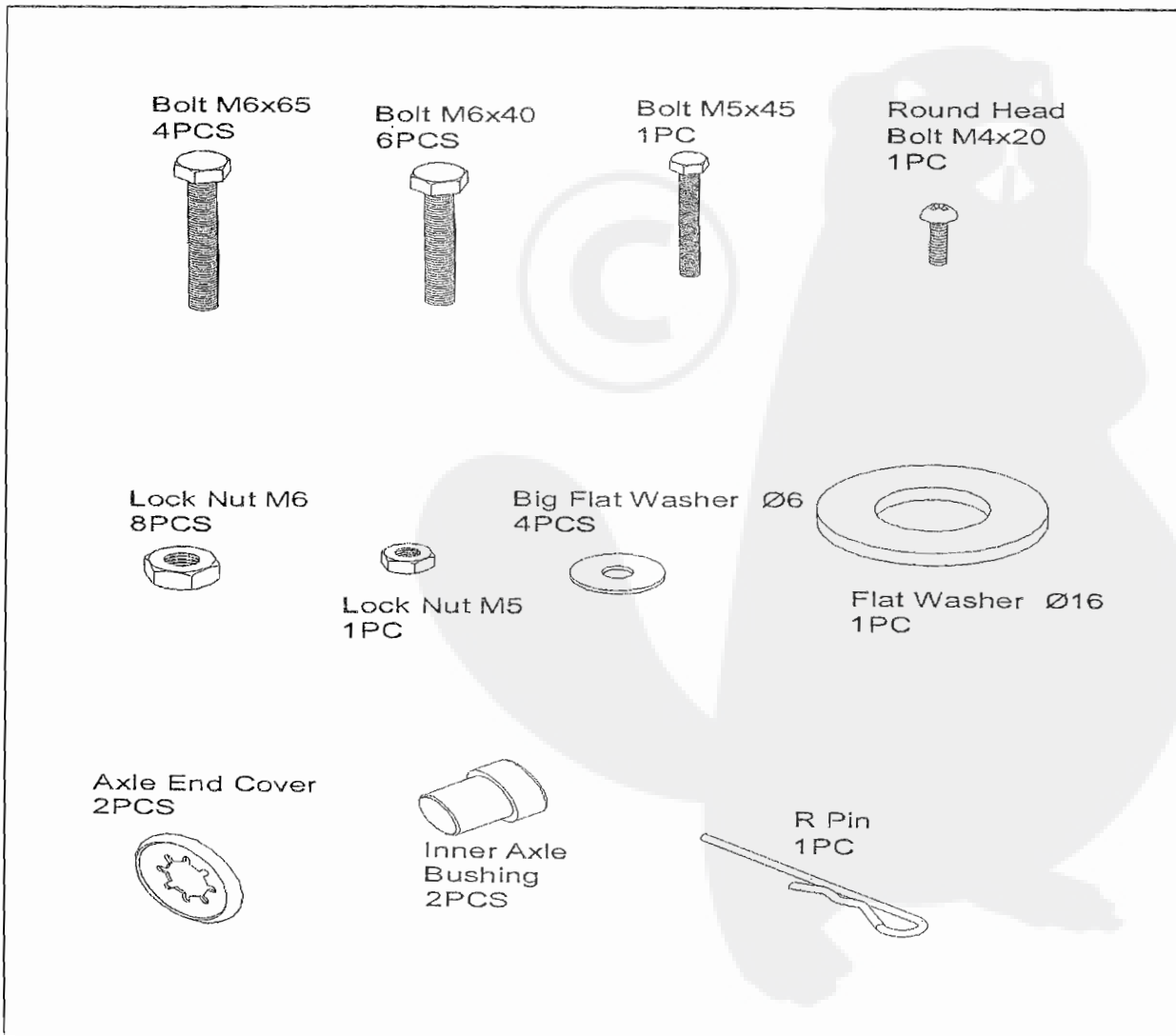

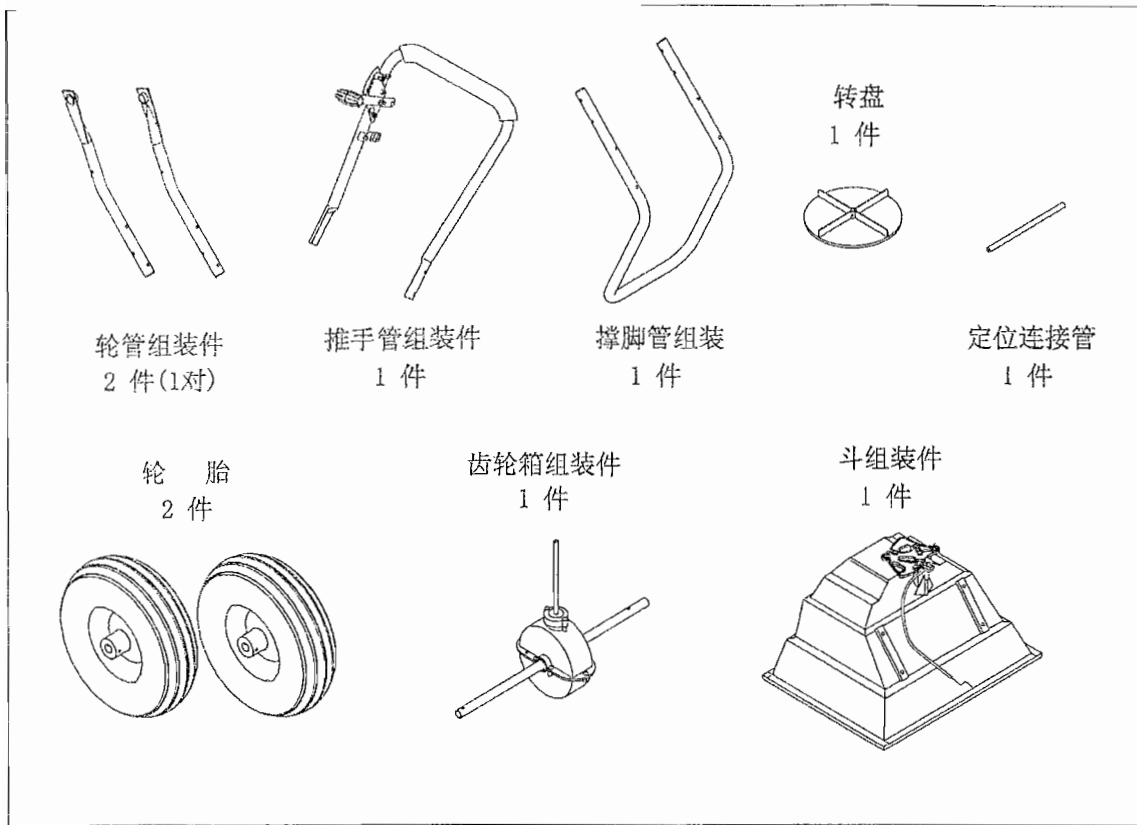

**STEP 1:** Install impeller onto the Gear Box & Axle Assembly. Insert Screw M4x20 through impeller then through Gear Box Axle.

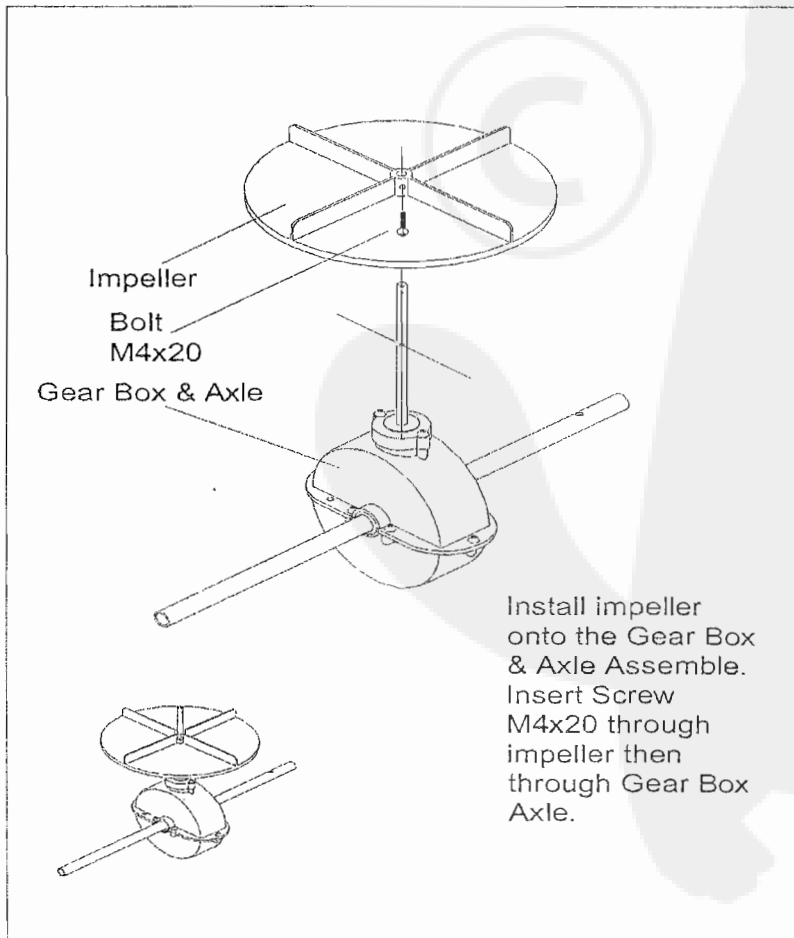

**STEP 2:** Attach the Wheel Assembly Frame on each side of the Gear Box Axle and Fixing Connecting Rod, insert two bolts M6x40 into the Fixing Connecting Rod through Wheel Assembly Frame. Make sure the hole on Axle of Gear Box is to be on the right side when assembly as shown. Attach Wheel Assembly Frames and Support Leg onto Hopper using bolts M6x65, lock nuts M6 and Flat Washers Ø6. Note: The bolts and nuts needn't be tightened yet.

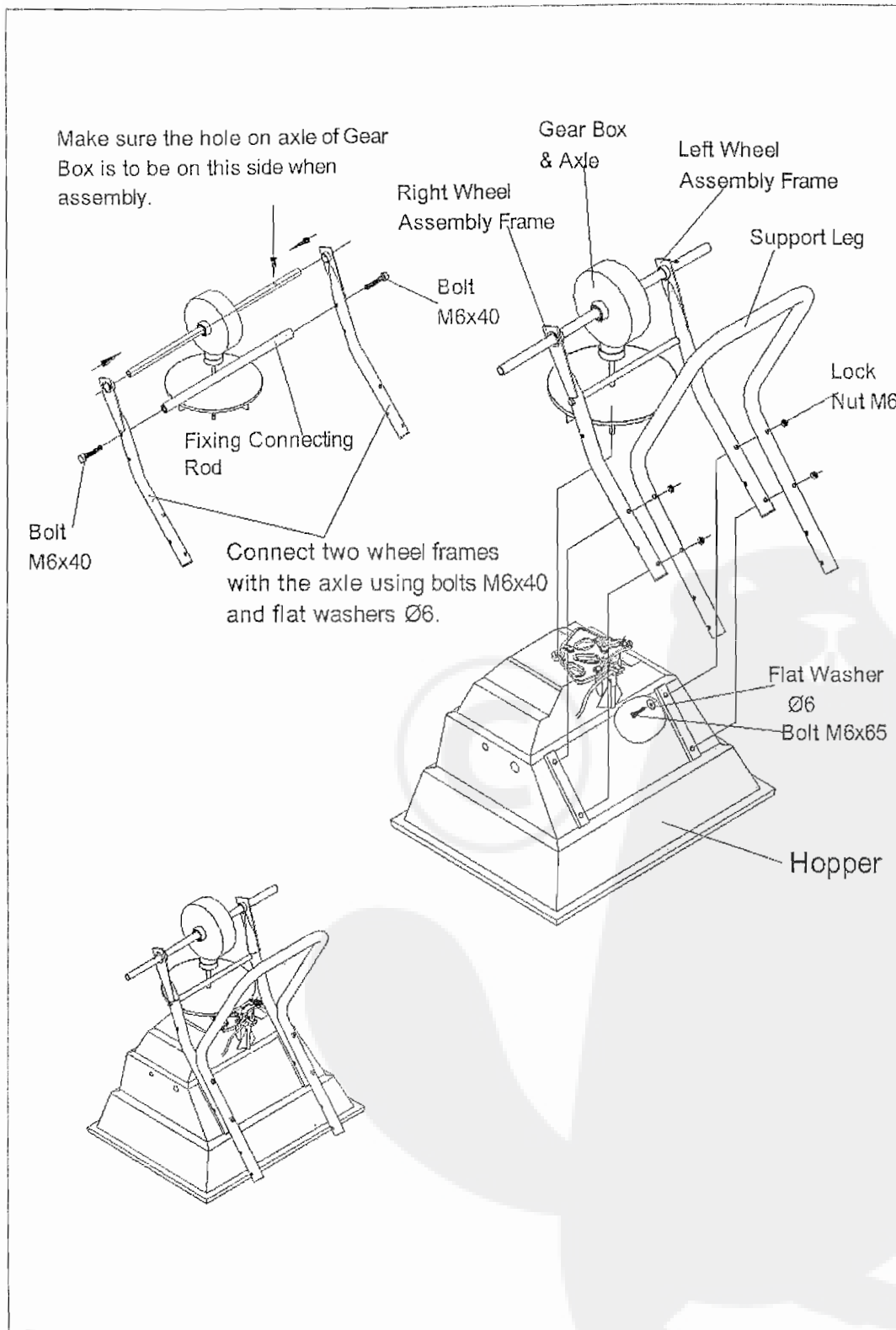

**STEP 3:** Insert Inner Axle Bushing into Outer Axle Bushing and make sure they are tight neatly. Install right Tire Assembly to right Axle using bolt M5x45 and lock nut M5, and then install the Cap onto right Axle using a wooden or rubber hammer. Now install left Tire Assembly to left Axle, put a flat washer  $\varnothing$  16 and install the Cap onto left Axle using a wooden or rubber hammer.

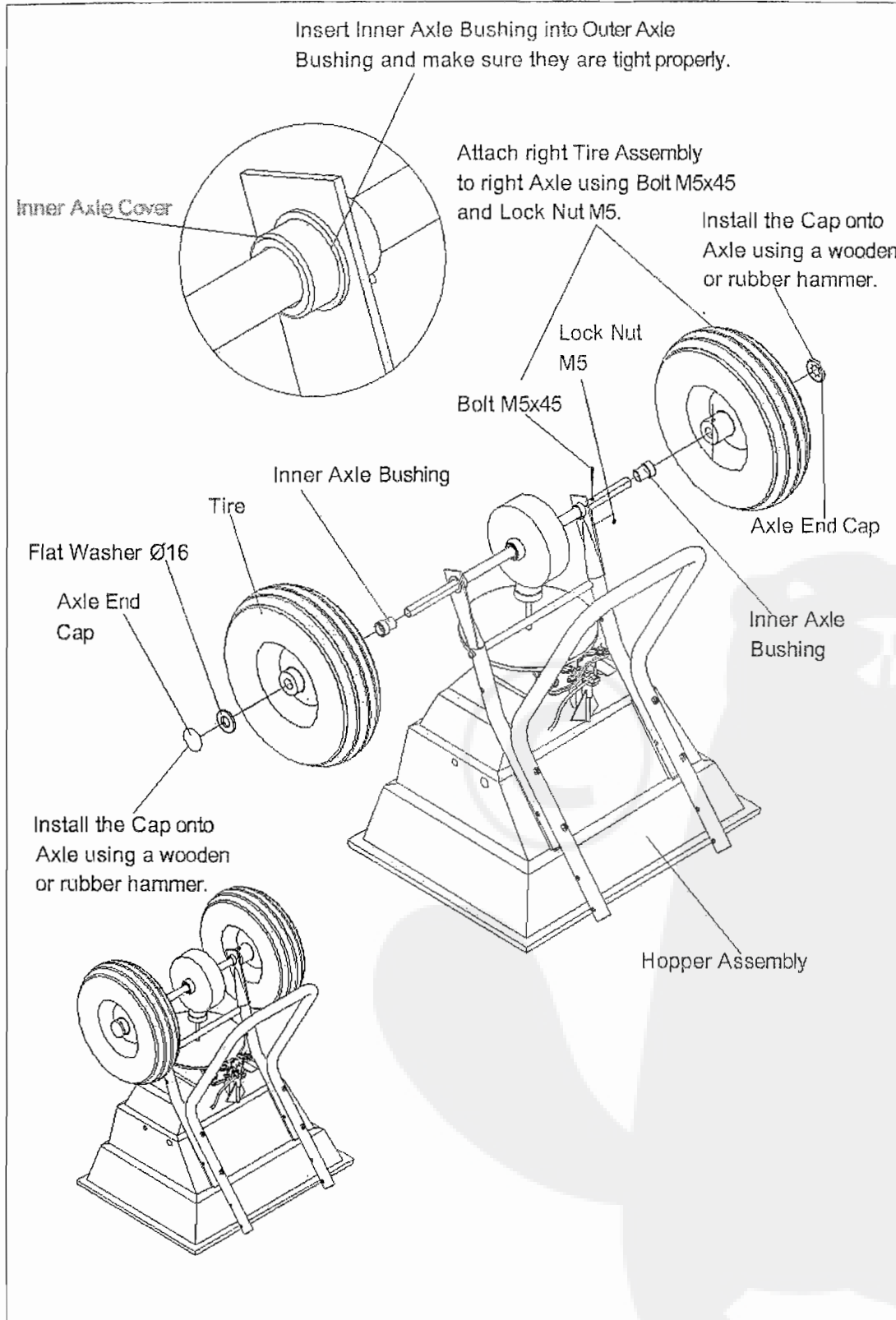

**STEP 4:** Insert Upper Handle into the Support Leg and tight using bolts M6x40 and Lock Nuts M6. **NOW GO BACK AND TIGHTEN ALL NUTS AND BOLTS STARTING WITH FIRST STEP. DO NOT OVER TIGHTEN.**

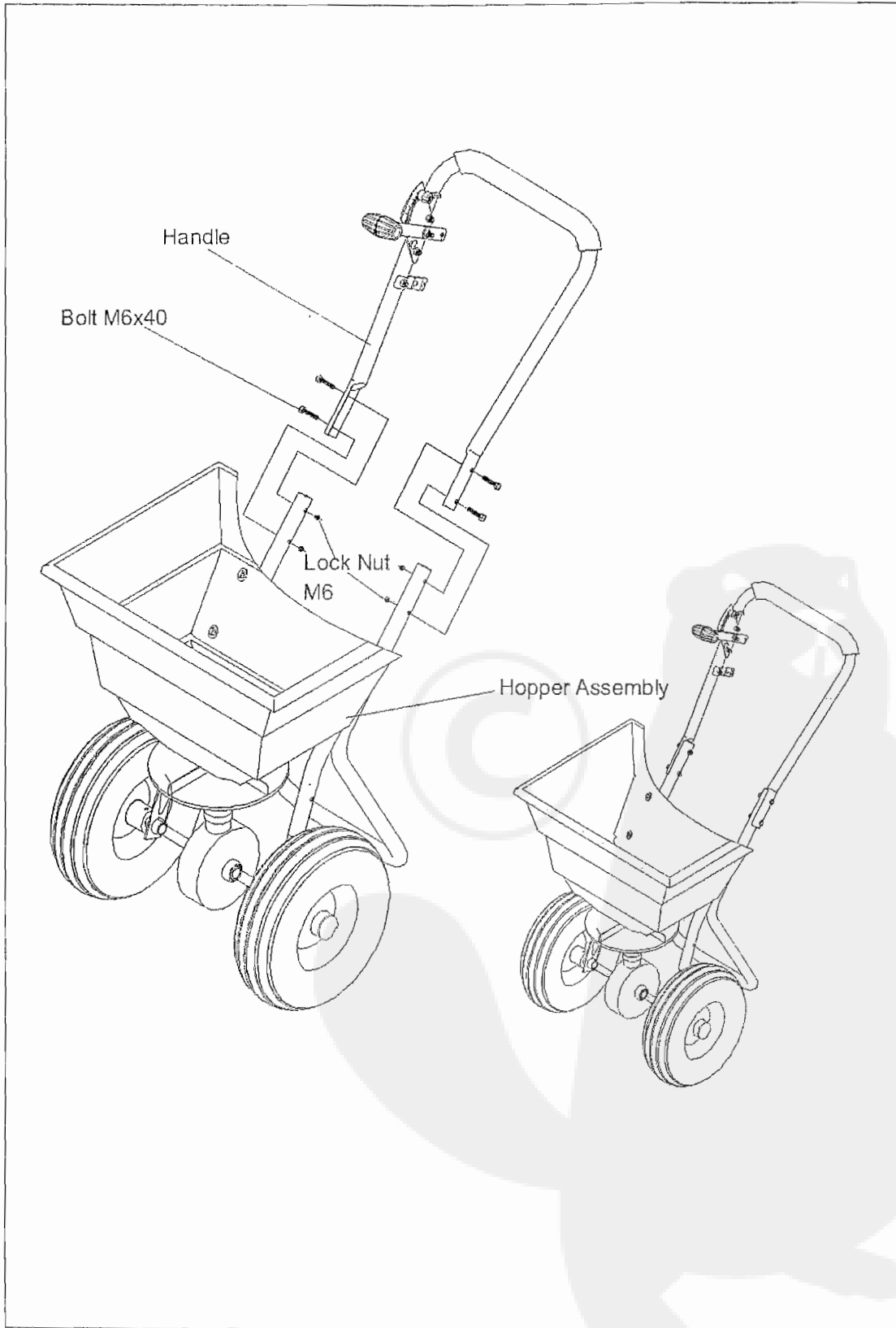

**STEP 5:** (1) Insert the Steel Wire head of control cable into the small hole on Gauge and Lever Assembly. (2) Release two bolts M5x10 and lock nuts on Press Plate. (3) Put the Plastic Tube into the slot of Press Plate. (4). Tight two bolts M5x10 and lock nuts again.

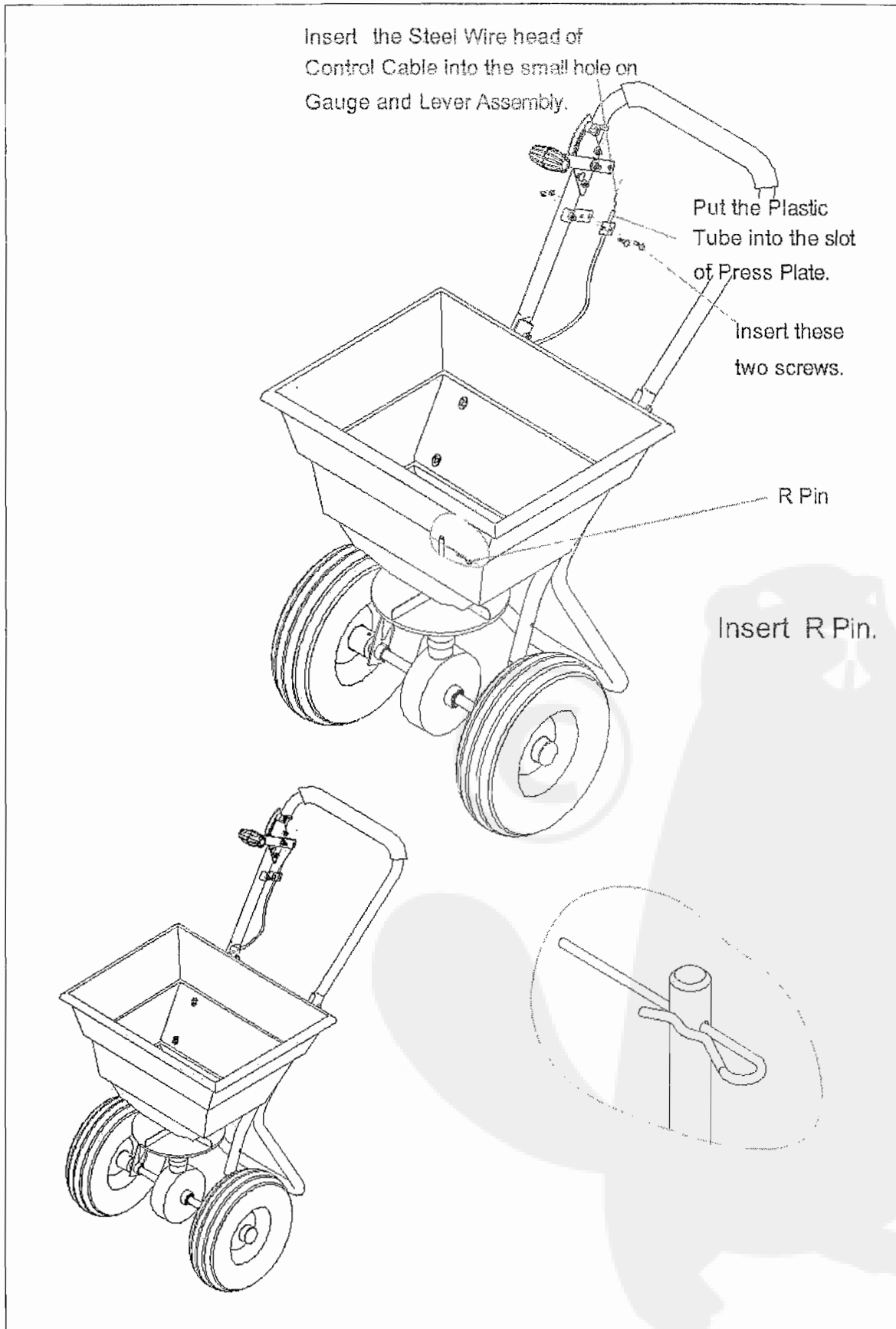

**STEP 6: ADJUSTABLE.** When you finished all above steps, if you find the three big holes at the bottom of hopper just match the three holes of adjustable plate. You don't need to do the following steps. If they are not match neatly, you may need to do the following steps. (1)Release two bolts M5x10 on clamp as shown. (2). Push the handle to the lowest position <downwards>, use your hand to adjust the adjustable plate so as to make sure three big holes at the bottom of hopper just match the three holes of adjustable plate neatly. (3). And then tight the bolts and nuts on clamp again.

To operate this spreader, push the handle to the top position (upwards). You may move the position of Wing nut on Gauge & Lever to adjust the spacer of three holes between hopper and adjustable plate as per your need when spreading.

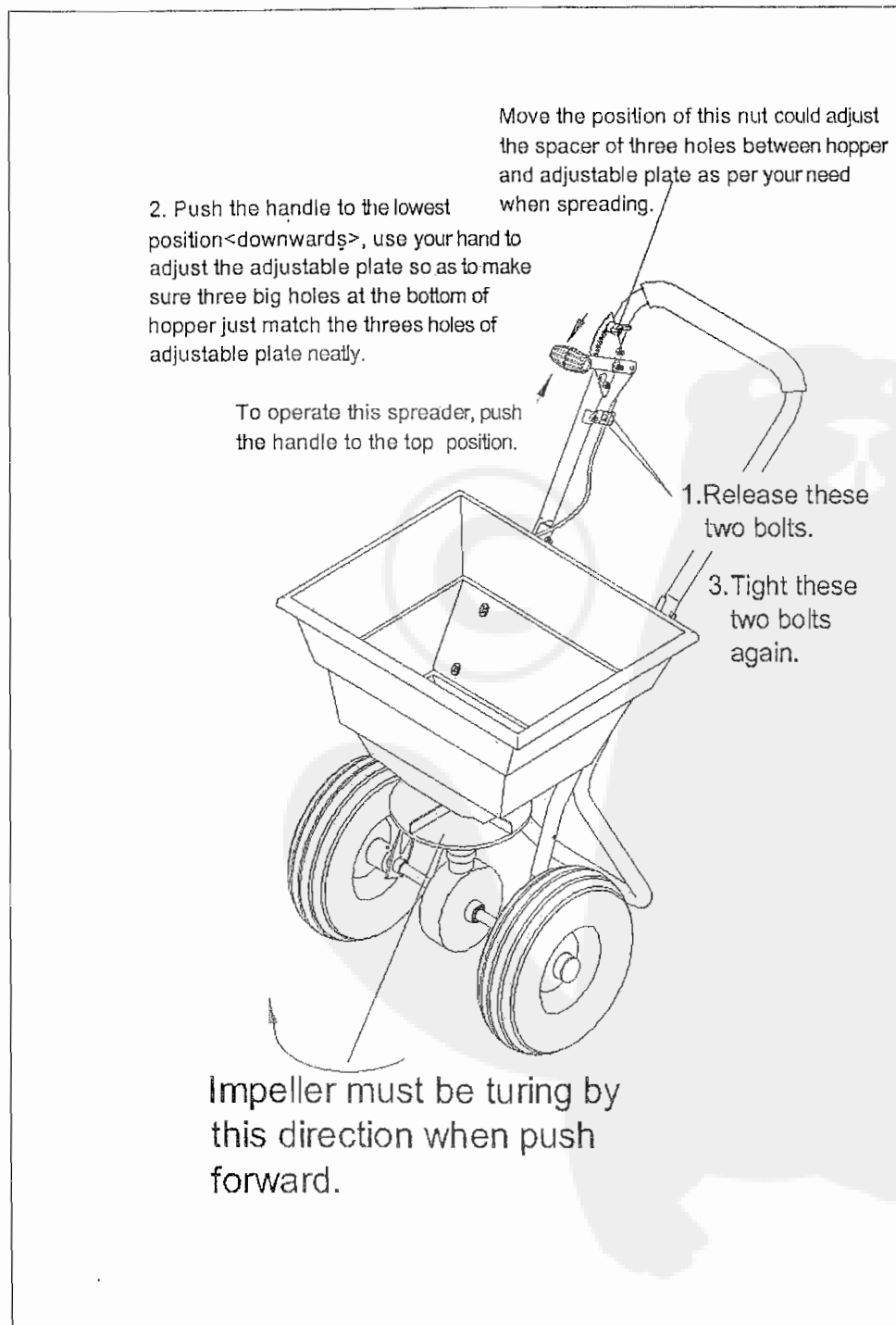



## OPERATING INSTRUCTIONS

Before filling hopper, become familiar with the operation of this spreader.

- 1- Move stop bolt on rate gauge assembly to the proper setting.
- 2- While pushing spreader forward, pull control lever back to stop bolts.
- 3- Top stop, push lever forward to close flow holes before you stop moving.
- 4- When finished, empty any remaining material from hopper.
- 5- Thoroughly wash spreader and allow to dry before storing.
- 6- No ciling is necessary.
- 7- Stay clear while spinner is turning.

## SUGGESTED WALKING PATTERN

### FULL RATE SETTINGS

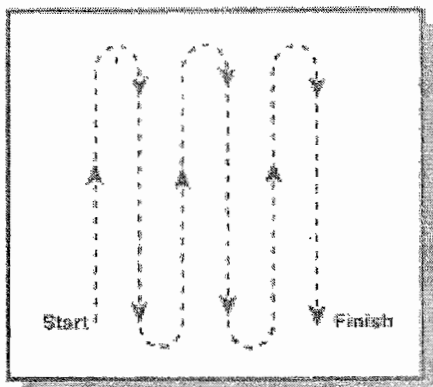

### HALF RATE SETTINGS

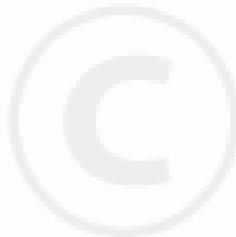
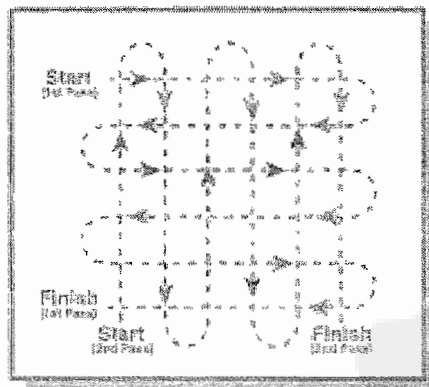

# PARTS DRAWING

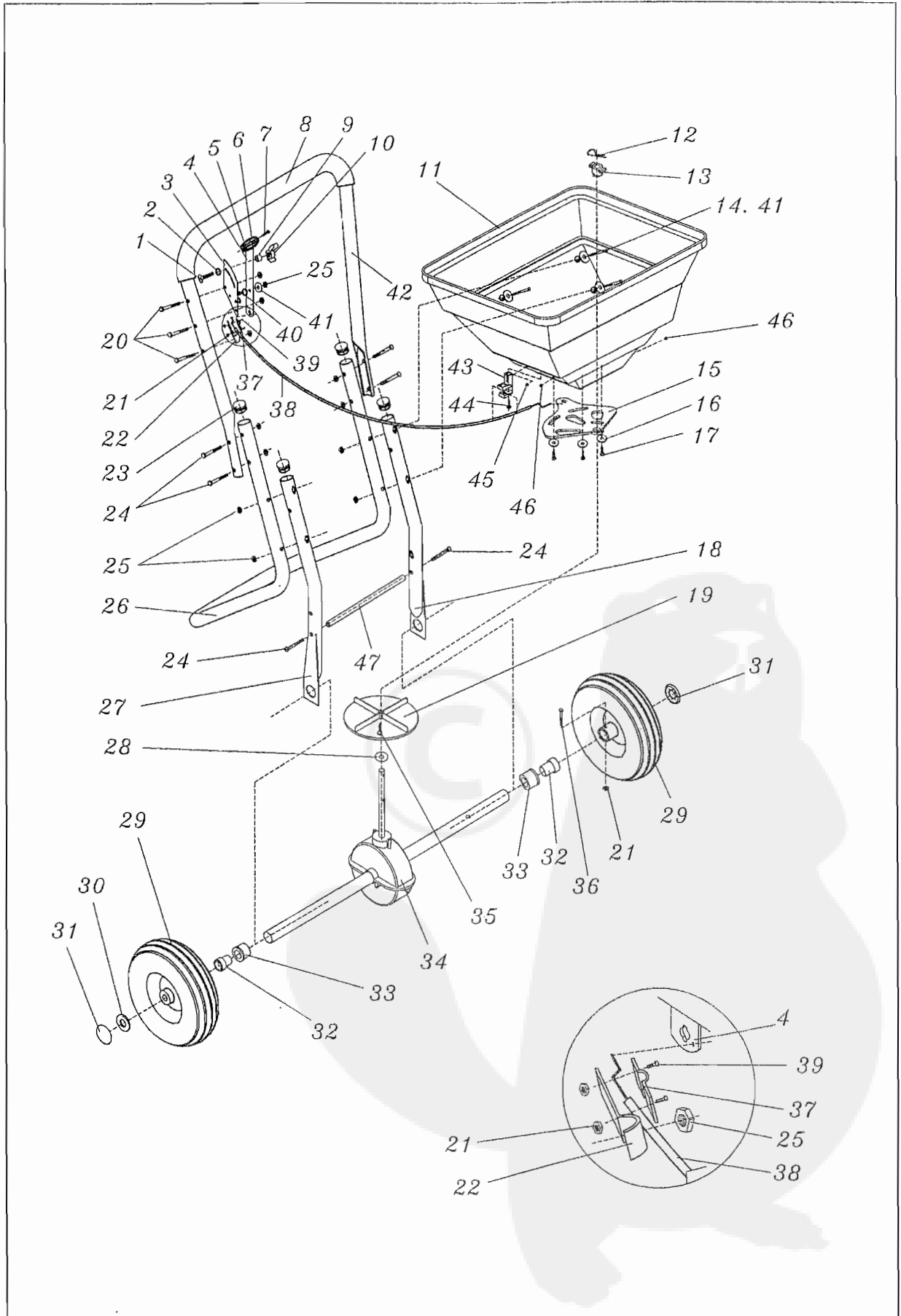

# PARTS LIST

Ref#	Description	Qty	Ref#	Description	Qty
1	Carriage Bolt M6x25	1	25	Lock Nut M6	12
2	External Tooth Washer Ø8	1	26	Support Leg	1
3	Gauge and Lever Assembly	1	27	Wheel Assembly Frame(Right)	1
4	Adjust Handle Pole	1	28	Thin Washer	1
5	Adjust Handle A	1	29	Pneumatic Wheel	2
6	Adjust Handle B	1	30	Flat Washer Ø16	1
7	Screw M4x18	1	31	Axle End Cover	2
8	Handle Grip	1	32	Inner Axle Bushing	2
9	Spacer	1	33	Outer Axle Bushing	2
10	Wing Nut M6	1	34	Gear Box & Axle Assemble	1
11	Hopper	1	35	Screw M4x20	1
12	R Pin Ø2x60	1	36	Bolt M5x45	1
13	Center Cover	1	37	Line Clamp Press Plate	1
14	Bolt M6x65	4	38	Control Rod	1
15	Adjustable Plate	1	39	Screw M5x10	2
16	Big Flat Washer Ø4	3	40	Nylon Washer	1
17	Screw M4x12	3	41	Big Flat Washer Ø6	5
18	Wheel Assembly Frame(Left)	1	42	Handle	1
19	Impeller	1	43	Line Clamp	1
20	Bolt M6x35	3	44	Screw M5x15	1
21	Lock Nut M5	3	45	Big End Cap	1
22	Line Clamp Bottom Plate	1	46	Small End Cap	2
23	Tube End Cap	4	47	Fixing Connection Rod	1
24	Bolt M6x40	6			