

26" WALK-BEHIND SWEEPER



Instruction & Assembly

SAVE THESE INSTRUCTIONS FOR FUTURE REFERENCE

Table of Contents

General Warnings and Rules	3
Hazard Signal Word Definitions.....	4
Controls and Features Identification.....	5
Component & Hardware.....	6
Assembly Instructions	7, 8, 9
Operation Instructions	10
Maintenance and Storage	11, 12, 13
Specification	13
Parts Drawing & Parts List.....	14, 15

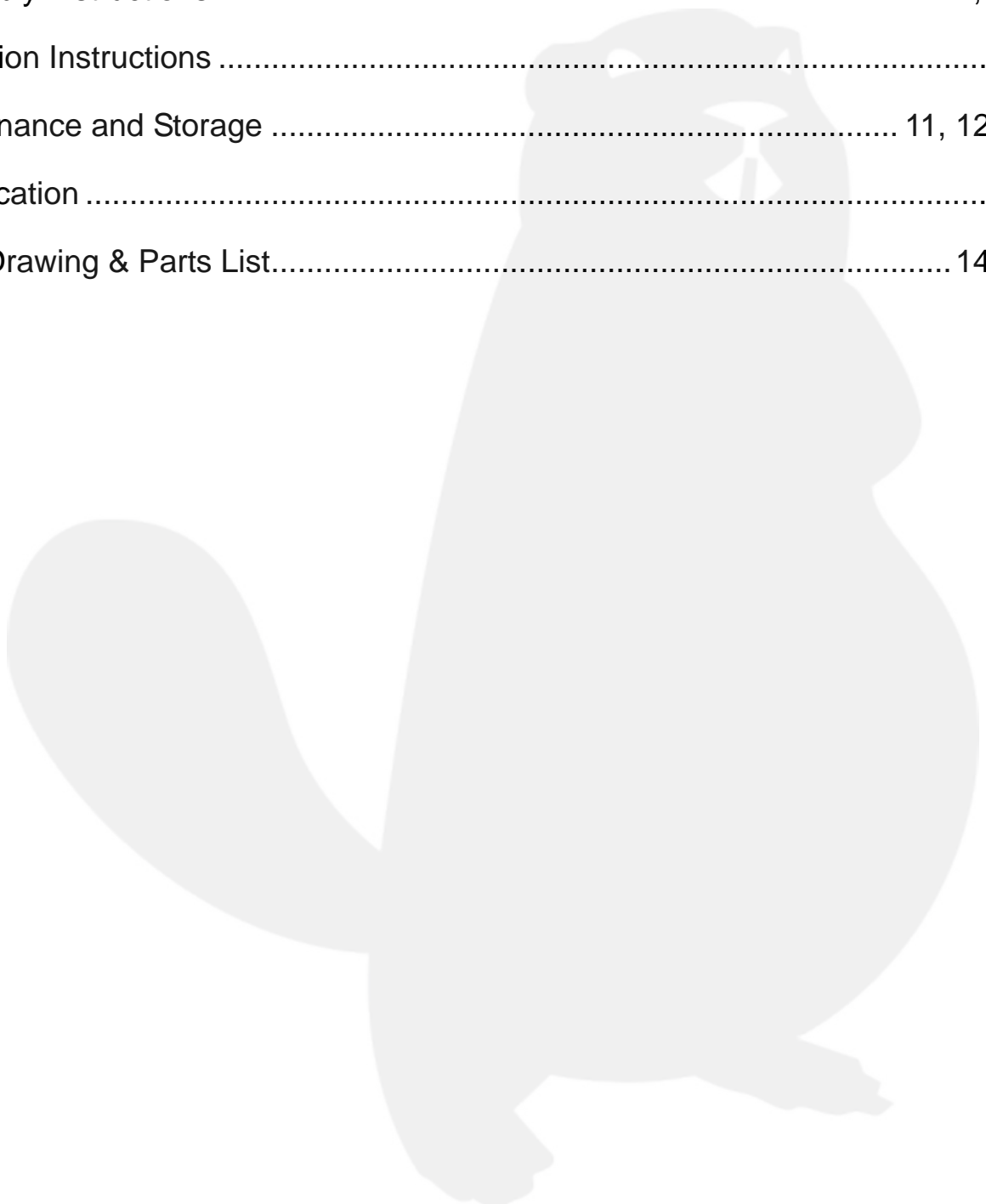

GENERAL WARNINGS

READ and UNDERSTAND this manual completely before using the Push Sweeper.

Operator must read and understand all safety and warning information, operating instructions, maintenance and storage instructions before operating this equipment. Failure to properly operate and maintain the push sweeper could result in serious injury to the operator or bystanders.

Operation Warnings

- Do not at any time carry passengers, sit or stand on the sweeper.
- Do not allow children to play on, stand upon or climb in the sweeper.
- Always inspect the sweeper before using to assure it is in good working condition.
- Replace or repair damaged or worn parts immediately.
- Always check and tighten hardware and assembled parts before operation.
- Avoid large holes and ditches when using the sweeper.
- Be careful when operating on steep grades (hill) the sweeper may tip over.
- Do not push close to creeks, ditches and public highways.
- Always use caution when unloading sweeper.
- Never tow the sweeper with a motorized vehicle.

Crush and Cut Hazards

- Always keep hands and feet clear from moving parts while operating the equipment.
- Always clear and keep work area clean when operating.
- Always wear safety gear, eye protection, gloves and work boots when operating the sweeper.

WARNING

The warnings, cautions, and instructions outlined in this instruction manual cannot cover all possible conditions or situations that may occur. It must be understood by the operator that common sense and caution are factors which cannot be built into this product and must be supplied by the operator.





PROP 65 WARNING

This product contains chemicals known to the state of California to cause cancer, birth defects, or other reproductive harm.

Assembly Is Required

This product requires assembly before use. See "Assembly" section for instructions. Because of the weight and/or size of the push sweeper, it is recommended that another adult be present to assist with the assembly. **INSPECT ALL COMPONENTS** closely upon receipt to make sure no components are missing or damaged.

Hazard Signal Word Definitions

	<p>This is the safety alert symbol. It is used to alert you to potential personal injury hazards. Obey all safety messages that follow this symbol to avoid possible injury or death.</p>
	<p>DANGER indicates an imminently hazardous situation which, if not avoided, will result in death or serious injury.</p>
	<p>WARNING indicates a potentially hazardous situation which, if not avoided, could result in death or serious injury.</p>
	<p>CAUTION indicates a potentially hazardous situation which, if not avoided, may result in minor or moderate injury.</p>
	<p>CAUTION used without the safety alert symbol indicates a potentially hazardous situation which, if not avoided, may result in property damage.</p>

ABOUT YOUR PUSH SWEEPER

This heavy duty push sweeper makes yard work a breeze. The steel and poly construction is durable and lightweight making it easy to push, rust resistant and easy to clean. The extra large sweeping span makes the job easy and saves time when cleaning different types of debris from grass, twigs, paper, leaves and much more. The push sweeper features an easy one-handed turn function to adjust the brush height. It can be stored in a shed, garage or on the wall. The large 7 cubic-foot hopper makes loading and unloading fast and convenient.

Technical specifications on the push sweeper are provided in the “Specifications” section of this manual.

Controls and Features Identification

Read this owner's manual before operating the equipment. Familiarize yourself with the location and function of the controls and features. Save this manual for future reference.



- 1) **Handle** – Pushes and moves the sweeper easily.
- 2) **Hopper Bag** – Do not exceed the rated load capacity 7 Cu. Ft.
- 3) **Support Leg** – Stabilizes load and sweeper.
- 4) **Tires / Wheel** – Heavy duty 10" tires.
- 5) **Hand Knob** – Adjust brush height.



CAUTION

Read and follow all instructions for assembly and operation. Failure to properly assemble this equipment could result in serious injury to the user or bystanders, or cause equipment damage.

PUSH SWEEPER COMPONENT PARTS AND ASSEMBLY

Take all parts out of the shipping crate and inspect components to ensure there are no missing pieces before starting to assemble the push sweeper follow steps 1 through 5.

TOOLS REQUIRED

- Pliers
- 10mm Wrenches

Component Parts

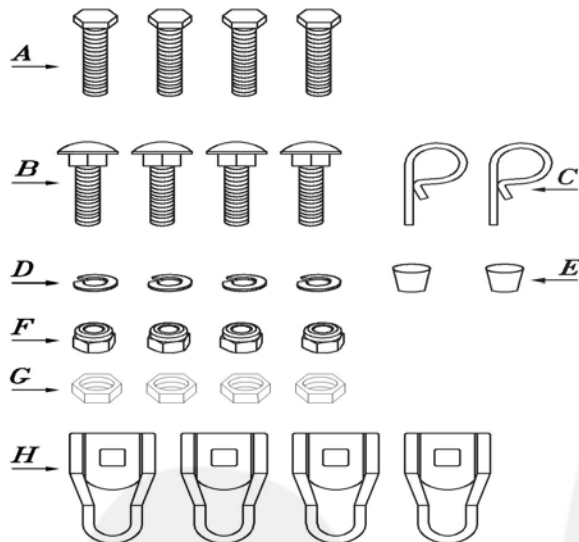

REF.	QTY.	DESCRIPTION
A	4	M6x30 Hex Bolt
B	4	M6x30 Carriage Bolt
C	2	R Pin
D	4	Ø6 Lock Washer
E	2	Plastic Cap
F	4	M6 Nylon Lock Nut
G	4	M6 Hex Nut
H	4	Bag Rod Clips

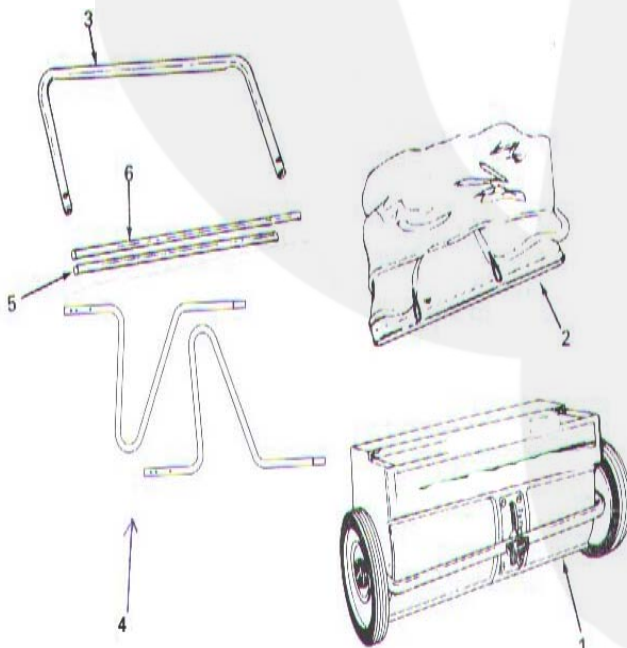

REF.	QTY.	DESCRIPTION
1	1	Sweeper Assembly
2	1	Hopper Bag
3	1	Handle Frame
4	2	Support Leg
5	1	Bag Frame Strap
6	1	Rear Hopper Frame Tube

Assembly Instructions

STEP 1: Install Support Legs to Sweeper Housing

1. Attach the lower leg support (4) to the sweeper housing (1) and secure with two M6x30 hex bolts (A) and M6 hex lock nut (F).
2. Loosely tighten all hardware.

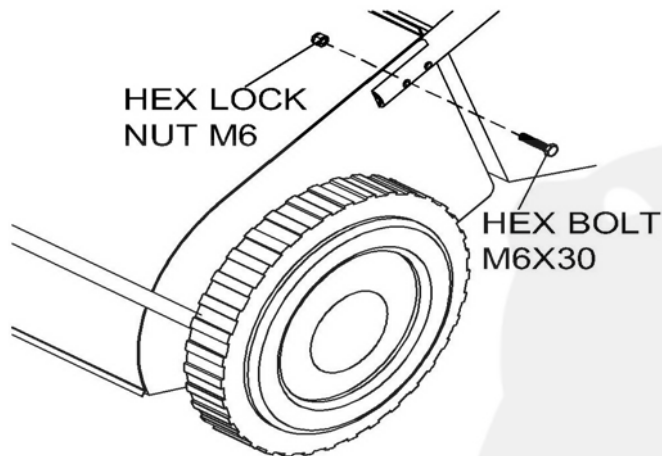

STEP 2: Attach Handle to Support Legs

1. Assemble the handle (3) over the lower support leg tubes (4).
2. Align the holes in handle and support legs and put the bag rod clips (H) on top.
3. Secure with two M6x30 carriage bolts (B), Ø6 lock washer (D) and M6 hex nut (G).
4. Now fully tighten all hardware in steps 1 and 2.

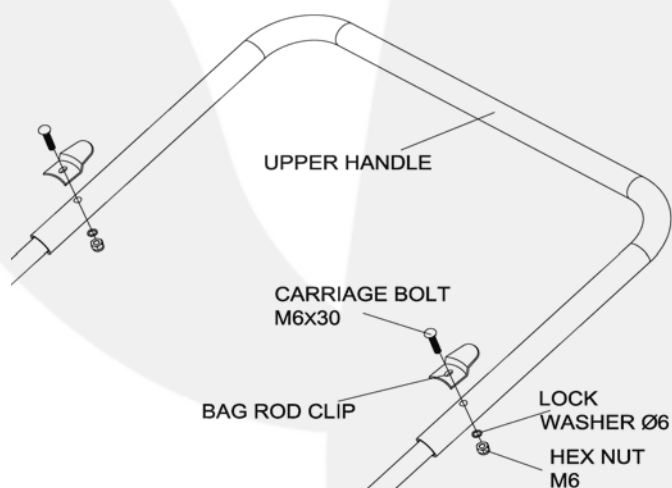

STEP 3: Attach Lower Bag Rod Clips

1. Put two bag clip (H) on the inside of each lower handle tube using a M6x 30 carriage bolt (B), secure the rod clip using a $\text{Ø}6$ lock washer (D) and M6 hex nut (G).

NOTE: The open end of the rod clips needs to face towards the sweeper housing.

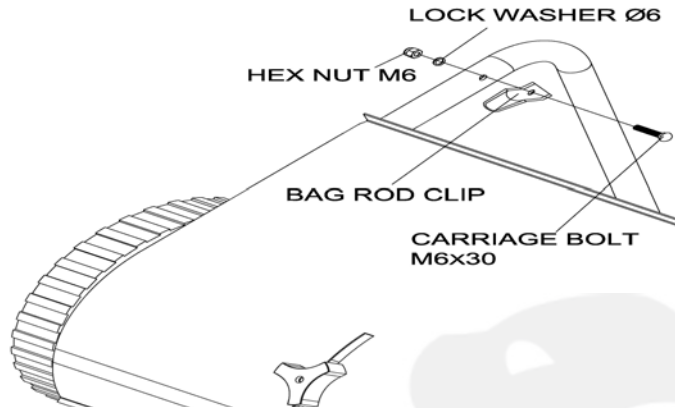

STEP 4: Assemble Hopper Bag Hardware

1. Slide the long rod (6) through the top of the hopper bag (2) along the stitched area.
2. Push the short rod (5) through the bottom hopper bag along the stitched area.

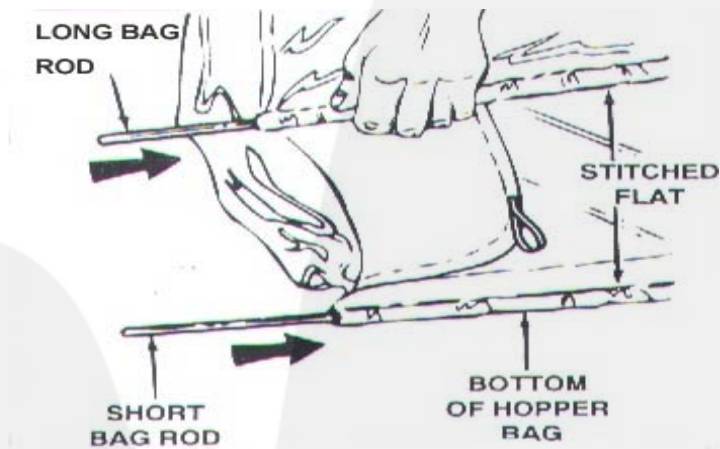

3. Attach the two plastic caps (E) on each end of the bottom bag rod.
4. On the top of the bag insert the R Pins (C) on each end.

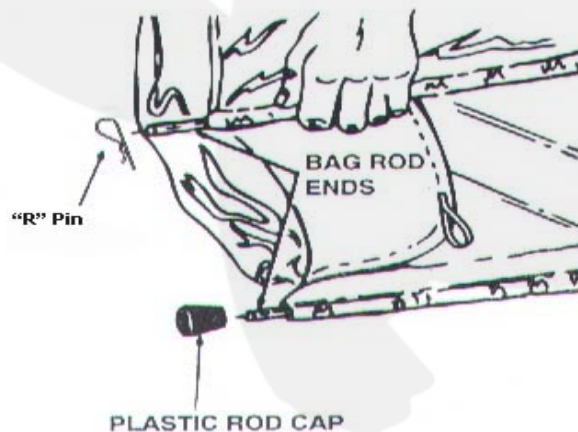

STEP 5: Attach Hopper Bag to Sweeper

1. Place the upper hopper bag into the bag clips in the on upper handle.

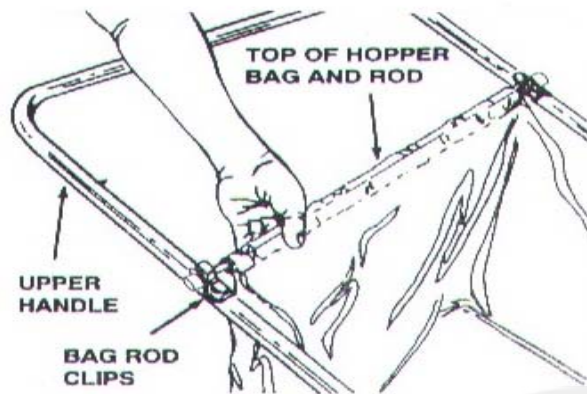

2. Place the lower hopper bag and bag rod into the opening on the sweeper housing.



3. Hook the elastic straps on the bag flaps under the bag clips on the lower support leg tubes.

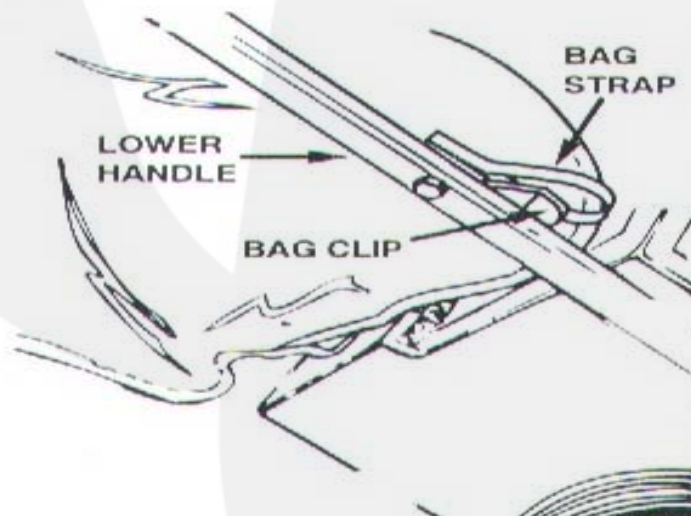

4. Make sure all hardware and the hopper bag is installed correctly before operating the sweeper.

Operation Instructions

WARNING

Before using the push sweeper, review the instructions below and safety information. Failure to follow these instructions may result in property damage or injury to the operator or bystanders.

USING YOUR SWEEPER

1. Always instruct other users before allowing them to operate the sweeper.
2. Do not allow anyone to operate the sweeper without proper instructions.
3. Do not at any time carry passengers sit or stand on the sweeper.
4. Do not permit children to operate sweeper.
5. Do not push sweeper too close to a fire, the hopper and the brushes will burn.
6. Do not exceed the maximum capacity of the hopper 7 Cu. Ft.
7. Use caution when operating the sweeper on rough terrain, ditches and hillsides to prevent tipping.
8. This sweeper is not meant for street or highway use. Watch for traffic when sweeping near road ways
9. Keep all nuts, bolts and screws tight to be sure the equipment is safe to operate.
10. Sweeper should be inspected for damage after striking a foreign object.
11. Replace or repair damaged or worn parts immediately before operate the equipment.
12. Follow all maintenance instructions outlined in this Manual.

BRUSH HEIGHT ADJUSTMENT

Adjust your sweeper brushes for the best results, loosen the hand knob and slide the height adjustment tube down to raise the brushes or up to lower the brushes. Make sure the brushes are no more than ½” down into the grass.

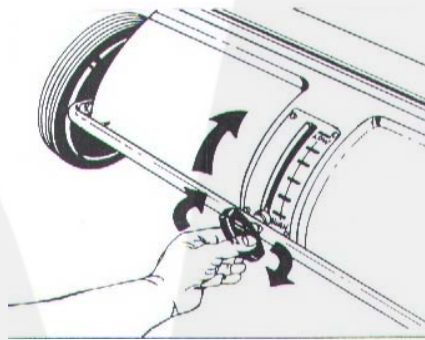

NOTE: Always mow the grass to an even height before sweeping.

DUMPING HOPPER BAG

To dump hopper bag, tip the sweeper forward allowing the material to fall out or take the hopper bag off of the frame and sweeper to dump.

Always dump hopper after each use. Damp or wet grass and leaves will cause damage to hopper if stored for an extended period of time.

CAUTION

DO NOT dump or unload the sweeper too close to a fire as the brushes and hopper bag can be destroyed by excessive heat or flame.

Maintenance and Storage



WARNING

Improper maintenance and storage of the push sweeper may void your warranty.

MAINTENANCE

- After each use clean material out of hopper.
- Rinse/dry inside and outside of the sweeper after each use.
- Periodically check all fasteners for tightness.
- Twice a year apply a few drops of light multipurpose oil to the brush shaft bearings.
- Annually clean and lightly lubricate all moving parts.
- Every two years remove and clean gears and apply an even coat of light synthetic grease.
- Use a glossy enamel spray paint to touch up scratched or worn painted metal surfaces.
- Never exceed the hopper load capacity rating of 7 Cu. Ft. it will damage the bag.

LUBRICATION

The bearings in the sweeper have been pre-lubricated at the factory; however it is recommended that a few drops of light multipurpose oil should be added to the brush shaft bearings twice a year. Also, the wheels should be removed too clean gears every two years. After cleaning apply an even coat of light synthetic grease.

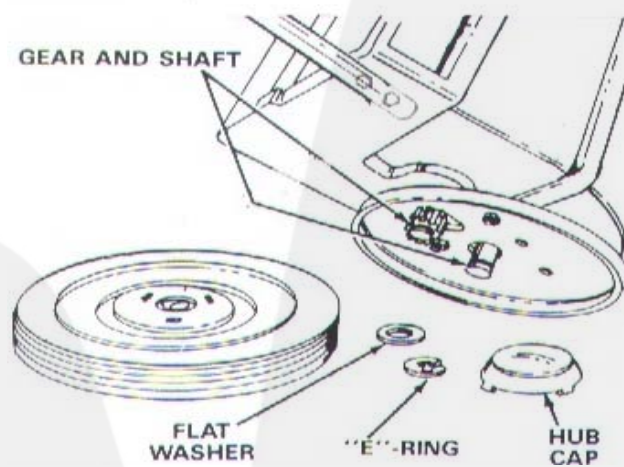

NOTE: To remove wheel, use a screwdriver to pop off hub cap, remove the “E” ring and flat washer.

Maintenance and Storage

WHEEL GEARS/PAWL SERVICE

DO NOT remove both wheels at the same time. Remove one wheel at a time to prevent use the wrong parts for the opposite side (left and right sides are different). When removing gears make notes on position of all washers and retaining rings.

The pawl, inside ratchet gear, has a curved end (side) and a flat end (side). When re-assembling the ratchet gear and pawl, fill the inside with grease. Re-assemble the wheel and turn wheel, if the brush drive rotates in both directions, the pawl is assembled **INCORRECTLY**. To be assembled **CORRECTLY**, flip the pawl over so the brush drive rotates in one direction.

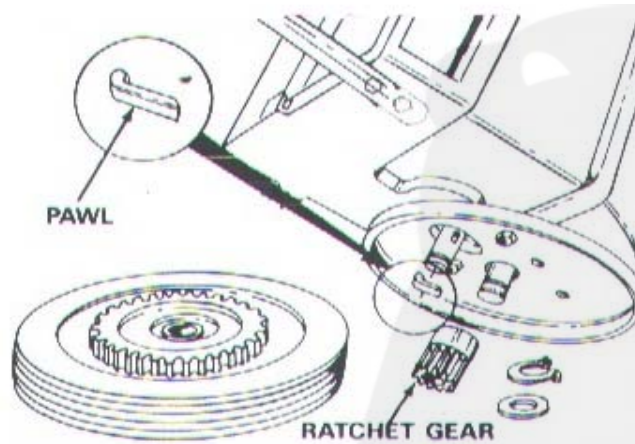

BRUSH REPLACEMENT

1. Remove the hopper bag from lawn sweeper.
2. Only replace one brush at a time.
3. Tip the sweeper forward on housing. Do not remove the hex bolts from double brush retainers.
4. Loosen hex bolts and hex lock nuts from single brush retainers. Slide brush out of retainers, making note of over-lap bristles position.
5. Install new brush, make sure the over-lap bristles are in the positioned as before

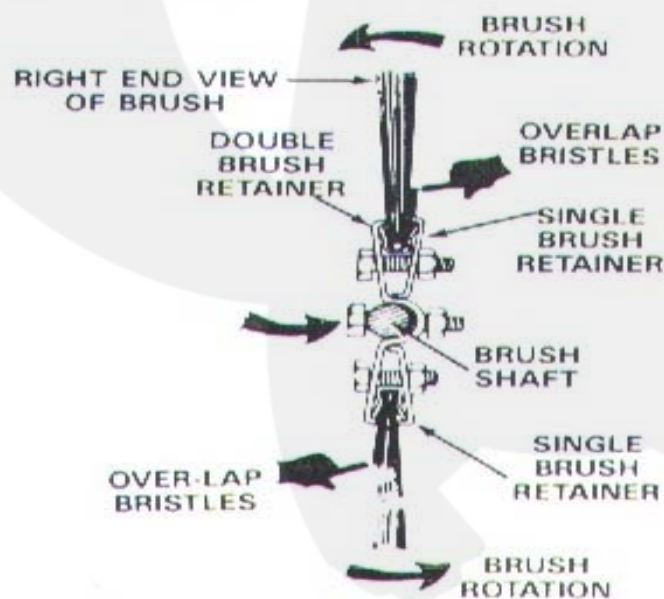

Maintenance and Storage

IMPORTANT:

If a part needs replacement, only use parts that meet the manufacturer's specifications. Replacement parts that do not meet specifications may result in a safety hazard or poor operation.

STORAGE

- Never allow material to remain in the hopper for extended periods of time.
- Before storing make sure the sweeper is clean and dry for years of trouble free service.
- Store indoors or protected area during severe weather and winter months.

NOTE: This unit is designed to be hung on a wall or the hopper bag may be removed for storage.

Specifications

Load Capacity	7 CU FT
Sweeper Type	Push
Hopper Material	Polyester
Hopper Dimensions	24.8" x 17.3" x 23.6"
Overall Dimensions.....	51.2" x 31.5" x 30.5"
Wheel size	10"
Unit Weight	37lb

Parts Drawing & Parts List

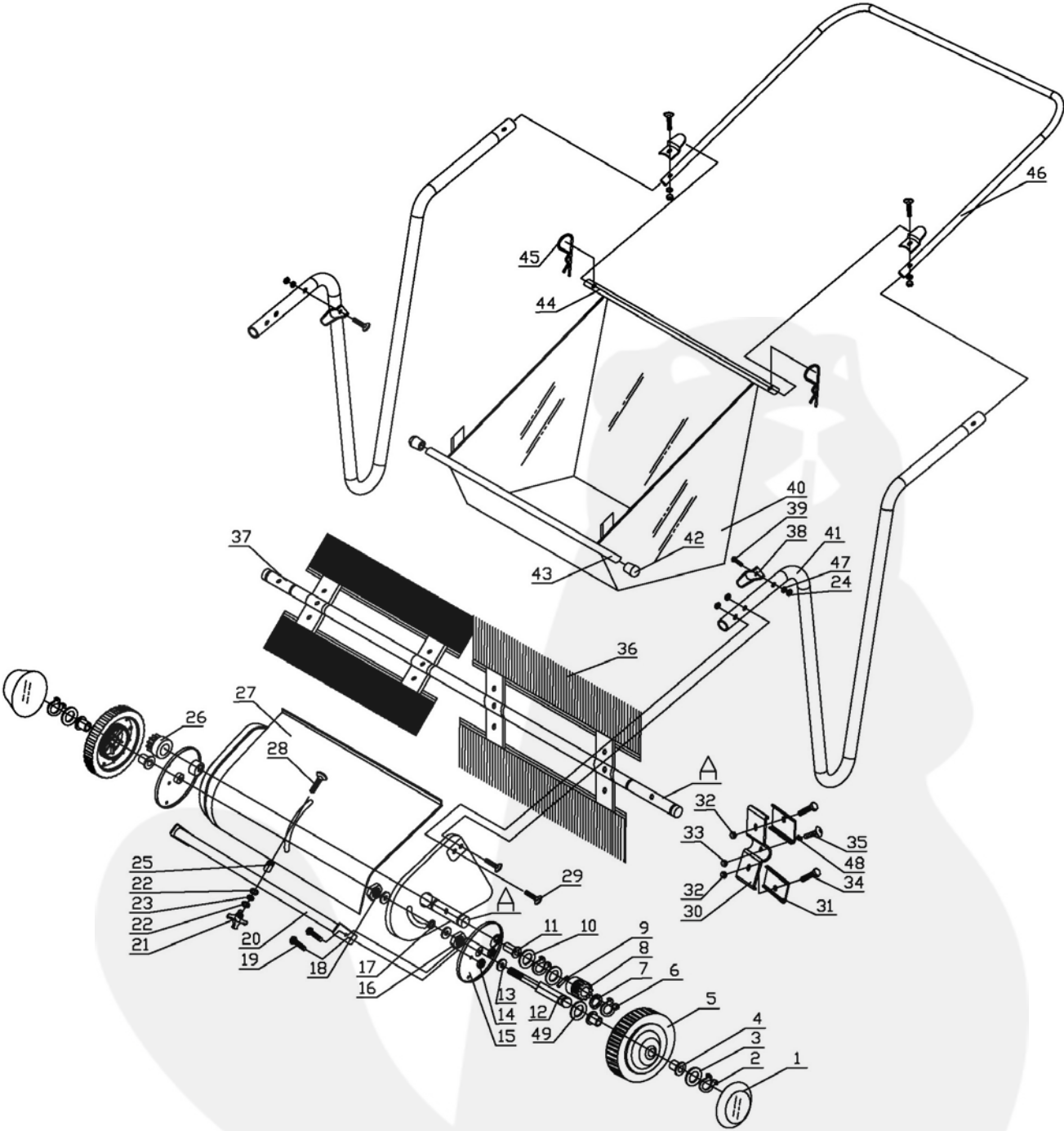

Parts Drawing & Parts List

Part No	Description	Qty	Part No	Description	Qty
1	Plastic Cover for wheel	2	26	Pinion Gear R.H.	1
2	Back Ring Ø16	2	27	Wrapper	1
3	Flat Washer Ø16	2	28	Carriage Bolt M8x55	1
4	Bushing	4	29	Hex Bolt M6x30	4
5	Wheel	2	30	Brush Clamp	4
6	Back Ring Ø15	4	31	Brush Retainer	8
7	Washer for Adjustment B	2	32	Nylon Lock Nut M6	12
8	Pinion Gear Left	1	33	Nylon Lock Nut M5	4
9	Pin of Gear	2	34	Hex Bolt M6x20	8
10	Washer for Adjustment A	4	35	Hex Bolt M5x25	4
11	Bearing for Brush	2	36	Brush Assembly	4
12	Wheel Axle	2	37	Brush Axle	1
13	Big Washer Ø10	6	38	Z-style Plate	4
14	Nylon Lock Nut M8	4	39	Carriage Bolt M6x30	4
15	Dust Cover Assembly	2	40	Hopper Bag	1
16	Hex Nut M10	2	41	Support Leg	2
17	Endplate Bushing	2	42	Plastic End Cover	2
18	Nylon Lock Nut M10	2	43	Bag Frame Strap	1
19	Hex Bolt M8x12	4	44	Rear Hopper Frame Tube	1
20	Connect Tube	1	45	Pin Ø2	2
21	Knob	1	46	Handle Frame	1
22	Big Washer Ø8	2	47	Lock Washer Ø6	4
23	Lock Washer Ø8 w/ teeth	1	48	Star Washer Ø5	4
24	Hex Nut M6	4	49	Washer for Adjustment F	2
25	Cushion Washer	1			