

GT - AK 60 S 3V

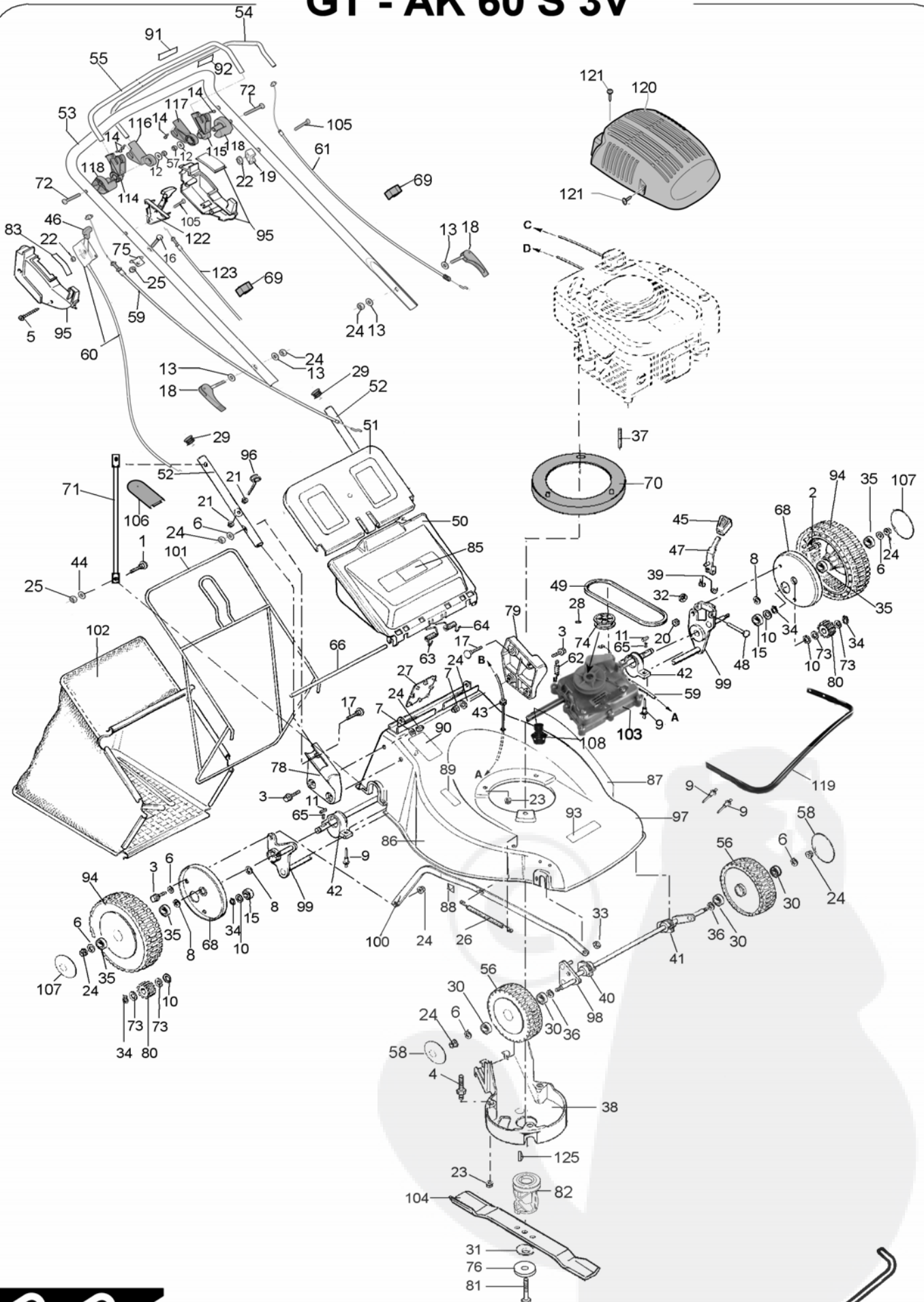

| POS. | CODICE | I | F | D | GB | E | GT | AK |
|------|-------------|--------------------|-------------------|------------------|----------------|------------------|---------------------|----|
| 1 | CP060616 | VITE TC | VIS | SCHRAUBE | SCREW | TORNILLO | 2 | 2 |
| 2 | CP030812 | VITE TE | VIS | SCHRAUBE | SCREW | TORNILLO | 1 | 1 |
| 3 | CP030825 | VITE TE | VIS | SCHRAUBE | SCREW | TORNILLO | 5 | 5 |
| 4 | CP047925 | VITE TRILOB. | VIS | SCHRAUBE | SCREW | TORNILLO | 3 - B&S - Honda GCV | |
| 4 | CP030860 | VITE TE | VIS | SCHRAUBE | SCREW | TORNILLO | 2 - Honda GXV 160 | |
| 5 | CP025040 | VITE AUTOF. | VIS | SCHRAUBE | SCREW | TORNILLO | 2 | 2 |
| 6 | CP032908 | RONDELLA | RONDELLE | SCHEIBE | WASHER | ARANDELA | 10 | 10 |
| 7 | CP032909 | RONDELLA | RONDELLE | SCHEIBE | WASHER | ARANDELA | 4 | 4 |
| 8 | CP032913 | RONDELLA | RONDELLE | SCHEIBE | WASHER | ARANDELA | 6 | 2 |
| 9 | CP034615 | RIVETTO | RIVET | NIET | RIVET | CLAVO | 8 | 8 |
| 10 | CP035905 | RASAMENTO | RONDELLE | SCHEIBE | WASHER | ARANDELA | 4 | 4 |
| 11 | CP037305 | CHIAVETTA | CLAVETTE | SCHLÜSSELCHEN | WOODRUFF KEY | CHAVETA | 2 | 2 |
| 12 | CP032926 | RONDELLA | RONDELLE | SCHEIBE | WASHER | ARANDELA | 2 | 2 |
| 13 | CP032924 | RONDELLA | RONDELLE | SCHEIBE | WASHER | ARANDELA | 4 | 4 |
| 14 | CP023595 | VITE | VIS | SCHRAUBE | SCREW | TORNILLO | 4 | 4 |
| 15 | CP038228 | CUSCINETTO | ROULEMENT | KUGELLAGER | BALL BEARING | COJINETE | 2 | 2 |
| 16 | CP040630 | VITE TTQST | VIS | SCHRAUBE | SCREW | TORNILLO | 1 | 1 |
| 17 | CP040835 | VITE TTQST | VIS | SCHRAUBE | SCREW | TORNILLO | 2 | 2 |
| 18 | CP047222 | LEVA COMPLETA COR | LEVIER | STANGE | LEVER | LEVA | 2 | 2 |
| 19 | CP042216 | BLOCCHETTO CAVO F | ATTACHE CABLE FRE | KABELBESCHWERER | CLIP | FIJADOR CABLE | 1 | 1 |
| 20 | CP042708 | DADO | ÉCROU | MUTTER | KNOB | ESPARRAGO | 1 | 1 |
| 21 | CP042805 | DADO | ÉCROU | MUTTER | KNOB | ESPARRAGO | 2 | 2 |
| 22 | CP042806 | DADO | ÉCROU | MUTTER | KNOB | ESPARRAGO | 2 | 2 |
| 23 | CP042808 | DADO | ÉCROU | MUTTER | KNOB | ESPARRAGO | 6 | 6 |
| 24 | CP044708 | DADO | ÉCROU | MUTTER | KNOB | ESPARRAGO | 13 | 13 |
| 25 | CP044906 | DADO | ÉCROU | MUTTER | KNOB | ESPARRAGO | 3 | 3 |
| 26 | CP045192 | MOLLA | RESSORT | FEDER | SPRING | MUELLE | 1 | 1 |
| 27 | CP045225 | COPERCHIETTO | COUVERCLE | KAPPE | CAP | TAPA | 1 | 1 |
| 28 | CP045530 | SPINA | GOUPILLE | DORN | PIN | PASADOR | 1 | 1 |
| 29 | CP045722 | TAPPO | COUVERCLE | KAPPE | CAP | TAPA | 2 | 2 |
| 30 | CP038228 | CUSCINETTO | ROULEMENT | KUGELLAGER | BALL BEARING | COJINETE | 4 | |
| 30 | CP038227 | CUSCINETTO 12X27 | ROULEMENT | KUGELLAGER | BALL BEARING | COJINETE | | 4 |
| 31 | CP045911 | MOLLA A TAZZA | RONDELLE | SCHEIBE | WASHER | MUELLE | 1 | 1 |
| 32 | CP046606 | RITEGNO | CLIP | RÜCKHALT | RETAINER | ANILLO CLIP | 1 | 1 |
| 33 | CP046607 | RITEGNO | CLIP | RÜCKHALT | RETAINER | ANILLO CLIP | 1 | 1 |
| 34 | CP046812 | SEEGER | SEEGER | RÜCKHALT | RETAINER | ANILLO CLIP | 4 | 4 |
| 35 | CP038228 | CUSCINETTO | ROULEMENT | KUGELLAGER | BALL BEARING | COJINETE | 4 | |
| 35 | CP038226 | CUSCINETTO 12X26 | ROULEMENT | KUGELLAGER | BALL BEARING | COJINETE | | 4 |
| 36 | CP032814 | RONDELLA | RONDELLE | SCHEIBE | WASHER | ARANDELA | | 2 |
| 37 | CP042257 | VITE 8X50 | VIS | SCHRAUBE | SCREW | TORNILLO | 1 - Honda GXV 160 | |
| 38 | CP047096 | COPRICINGHIA | COUVERCLE COURRO | RIEMENSCHUTZ | BELT COVER | TAPA | 1 | 1 |
| 39 | CP047191 | MOLLA | RESSORT | FEDER | SPRING | MUELLE | 1 | 1 |
| 40 | CP053212 | SUPPORTO ASSALE | SUPPORT | ACHSELAGER | SUPPORT | SOPORTE | 1 | 1 |
| 41 | CP053213 | SUPPORTO ASSALE | SUPPORT | ACHSELAGER | SUPPORT | SOPORTE | 1 | 1 |
| 42 | CP047215 | SUPPORTO ASSALE | SUPPORT | ACHSELAGER | SUPPORT | SOPORTE | 2 | 2 |
| 43 | CP047217 | PASSACAVO | JOINTE | RING | RING | ANILLO | 1 | 1 |
| 44 | CP032907 | RONDELLA | RONDELLE | SCHEIBE | WASHER | ARANDELA | 2 | 2 |
| 45 | CP047236 | CAPPUCCIO | CACHE MOYEU | KAPPE | HOOD | POMO | 1 | 1 |
| 46 | CP047250 | COMANDO ACCELE | LEVIER | STANGE | THROTTLE LEVER | LEVA | 1 | 1 |
| 47 | CP047255 | LEVA ALZO | LEVIER | STANGE | LEVER | LEVA ALTURAS | 1 | 1 |
| 48 | CP047267 | PERNO | GOUJON | ZAPFEN | PIN | PERNO | 1 | 1 |
| 49 | CP047838 | CINGHIA Z 38 | COURROIE | RIEMEN | BELT | CORREA | 1 | 1 |
| 50 | CP050018 | PARASASSI | DEFLECTEUR | DEFLEKTOR | REAR DOOR | DEFLECTÓR | 1 | 1 |
| 51 | CP050023 | COPRICESTO NERO | COUVERCLE | GRASFANFSACKDECK | BAG COVER | CARCASA | 1 | |
| 52 | CP060033 | MANICO INF. | GUIDON | STIEL | HANDLE | MANILLAR | 2 | 2 |
| 53 | CP060043 | MANICO SUP. | GUIDON | STIEL | HANDLE | MANILLAR | 1 | 1 |
| 54 | CP052068 | LEVA INNESTO | LEVIER EMBRAYAGE | STANGE | LEVER CLUTCH | LEVA | 1 | 1 |
| 55 | CP052073 | LEVA FRENO | LEVIER FREIN | STANGE | LEVER | LEVA | 1 | 1 |
| 56 | CP047118.98 | RUOTA 180 PH ZINCA | ROUE ACIER | VERZINKTES RAD | ZINC WHEEL | RUEDA ZINC | 2 | |
| 56 | CP050106 | RUOTA 180 | ROUE | RAD | WHEEL | RUEDA | | 2 |
| 57 | CP044726 | DADO | ÉCROU | MUTTER | KNOB | ESPARRAGO | 2 | 2 |
| 58 | CP047133 | COPRIRUOTA | CACHE MOYEU | RADDECKUNG | HUB CAP | TAPA RUEDA | 2 | |
| 58 | CP050127 | COPRIRUOTA 180 | CACHE MOYEU | RADDECKUNG | HUB CAP | TAPA RUEDA | | 2 |
| 59 | CP052138 | CAVO SEMOVENZA | CABLE D'EMBAYAGE | SELBSTBEWEGLICHK | CABLE CLUTCH | CABLE TRACCION | 1 | 1 |
| 60 | CP050143 | CAVO ACCELERATOR | CABLE GAZ | BESCHLEUNIGER | THROTTLE CABLE | ACELERADOR | 1 - B&S | |
| 60 | CP056143 | CAVO ACCELERATOR | CABLE GAZ | BESCHLEUNIGER | THROTTLE CABLE | ACELERADOR | 1 - HONDA GCV | |
| 60 | CP047143 | CAVO ACCELERATOR | CABLE GAZ | BESCHLEUNIGER | THROTTLE CABLE | ACELERADOR | 1 - Honda GXV 160 | |
| 61 | CP052146 | CAVO FRENO | CABLE FREIN | KABEL | CABLE | CABLE | 1 - B&S - Honda GCV | |
| 61 | CP057148 | CAVO FRENO | CABLE FREIN | KABEL | CABLE | CABLE | 1 - Honda GXV 160 | |
| 62 | CP050191 | MOLLA | RESSORT | FEDER | SPRING | MUELLE | 1 | 1 |
| 63 | CP050193 | MOLLA PARASASSI | RESSORT | FEDER | SPRING | MUELLE | 1 | 1 |
| 64 | CP050192 | MOLLA PARASASSI | RESSORT | FEDER | SPRING | MUELLE | 1 | 1 |
| 65 | CP050194 | MOLLA | RESSORT | FEDER | SPRING | MUELLE | 2 | 2 |
| 66 | CP050203 | ASTINA | AXE PIVOT | STANGE | HINGE PIN | EJE DEFLECTOR | 1 | 1 |
| 68 | CP050214 | COPRIRUOTA INTERN | CACHE MOYEU | RADDECKUNG | HUB CAP | TAPA RUEDA | 2 | 2 |
| 69 | CP050222 | FERMACAVO | ATTACHE CABLE | KABELBESCHWERER | CLIP | FIJADOR CABLE | 2 | 2 |
| 70 | CP047174 | ANELLO DISTANZIAT | ANNEAU | RING | RING | ANILLO | 1 - Honda GXV 160 | |
| 71 | CP060062 | TIRANTE | BARRE | GESTÄNGE | LINK | TIRANTE | 2 | 2 |
| 72 | CP060656 | VITE | VIS | SCHRAUBE | SCREW | TORNILLO | 2 | 2 |
| 73 | CP050238 | RONDELLA | RONDELLE | SCHEIBE | WASHER | ARANDELA | 4 | 4 |
| 74 | CP050241 | PULEGGIA D.60 | POULIE | RIEMENSCHLEIBE | PULLEY | POLEA | 1 | 1 |
| 75 | CP052243 | STAFFETTA REGISTR | EQUARRRE | WINKELMASS | BRACKET | ABRAZADERA CABLE | 1 | 1 |
| 76 | CP053250 | RONDELLA | RONDELLE | SCHEIBE | WASHER | ARANDELA | 1 | 1 |

| POS. | CODICE | I | F | D | GB | E | GT | AK |
|------|-------------|---------------------|--------------------|------------------|-------------------|-------------------|---------------------|-----------|
| 78 | CP050268 | PIASTRA | PLAQUE | PLÄTTCHEN | PLATE | PLANCHA | 1 | 1 |
| 79 | CP050269 | PIASTRA | PLAQUE | PLÄTTCHEN | PLATE | PLANCHA | 1 | 1 |
| 80 | CP050298 | INGRANAGGIO | PIGNON | GETRIEBE | PINION | ENGRANAJE | 2 | 2 |
| 81 | CP050965 | VITE LAMA 10.9 | VIS 10.9 | SCHRAUBE 10.9 | SCREW 10.9 | TORNILLO 10.9 | 1 | 1 |
| 82 | CP053274B22 | MOZZO D.22.2 +PULEG | PORTE LAME + POULI | MESSERHALTER | BLADE ADAPTOR+PUL | PORTA CUCHILLA+PO | 1 - B&S - Honda GCV | |
| 82 | CP053274M | MOZZO CON PULEGG | PORTE LAME + POULI | MESSERHALTER | BLADE ADAPTOR+PUL | PORTA CUCHILLA+PO | 1 - Honda GXV 160 | |
| 83 | CP053710 | DECALCO | DECALQUE | ETIKETTE | DECAL | CARTEL | 1 | 1 |
| 85 | CP053715 | DECALCO | DECALQUE | ETIKETTE | DECAL | CARTEL | 1 | 1 |
| 86 | CP053732 | DECALCO | DECALQUE | ETIKETTE | DECAL | CARTEL | 1 | 1 |
| 87 | CP053733 | DECALCO | DECALQUE | ETIKETTE | DECAL | CARTEL | 1 | 1 |
| 88 | CP053802 | DECALCO | DECALQUE | ETIKETTE | DECAL | CARTEL | 1 | 1 |
| 89 | CP053806 | DECALCO | DECALQUE | ETIKETTE | DECAL | CARTEL | 1 | 1 |
| 90 | CP053813 | DECALCO | DECALQUE | ETIKETTE | DECAL | CARTEL | 1 | 1 |
| 91 | CP053842 | DECALCO | DECALQUE | ETIKETTE | DECAL | CARTEL | 1 | 1 |
| 92 | CP053843 | DECALCO | DECALQUE | ETIKETTE | DECAL | CARTEL | 1 | 1 |
| 93 | CP053910 | DECALCO GREENTEA | DECALQUE | ETIKETTE | DECAL | CARTEL | 1 | |
| 93 | CP053663 | DECALCO AKITA | DECALQUE | ETIKETTE | DECAL | CARTEL | | 1 |
| 94 | CP057128.98 | RUOTA 235T PH ZINC | ROUE ACIER | VERZINKTES RAD | ZINC WHEEL | RUEDA ZINC | 2 | |
| 94 | CP056116 | RUOTA 230 | ROUE | RAD | WHEEL | RUEDA | | 2 |
| 95 | CP056226 | COPRIACCELERATOR | COUVERCLE | DECKEL | COVER | COPA PROTECTORA | 1 | 1 |
| 96 | CP056242 | VITE | VIS | SCHRAUBE | SCREW | TORNILLO | 1 | 1 |
| 97 | CP060001 | CHASSIS VERDE | CARTER | GEHÄUSE | DECK | CHASIS | 1 | |
| 97 | CP060001.03 | CHASSIS ARGENTO | CARTER | GEHÄUSE | DECK | CHASIS | | 1 |
| 98 | CP057048 | ASSALE ANT | AXE AVANT | VORDERACHSE | FRONT AXLE | EJE ANTERIOR | 1 | 1 |
| 99 | CP057058 | ASSALE POS | AXE ARRIERE | HINTERACHSE | REAR AXLE | EJE POSTERIOR | 1 | 1 |
| 100 | CP060063 | TIRANTE ASSALE | BARRE | GESTÄNGE | LINK ROD | TIRANTE EJE | 1 | 1 |
| 101 | CP057078 | TELAIO CESTO | ATTELAGE | GRASFANGRAHMEN | FRAME | ARMAZON SACO | 1 | 1 |
| 102 | CP057083 | TELA CESTO BIANCA | SAC RAMASSEUR | GRASFANGSACK | GRASS BAG | SACO TELA | 1 | 1 |
| 103 | CP057091 | CAMBIO A 3 VELOCITA | REDUCTEUR | UNTERSETZUNGGETR | GEAR BOX 3 SPEED | TRANSMISION | 1 | 1 |
| 104 | CP060013 | LAMA | LAME | MESSER | BLADE | CUCHILLA | 1 | 1 |
| 105 | CP060640 | VITE TC | VIS | SCHRAUBE | SCREW | TORNILLO | 2 | 2 |
| 106 | CP046225 | IMPUGNATURA | COUVERCLE | SCHUTZ | COVER | TAPA | 1 OPTIONAL | |
| 107 | CP047133 | COPRIRUOTA | CACHE MOYEU | RADDECKUNG | HUB CAP | TAPA RUEDA | 2 | |
| 107 | CP050132 | COPRIRUOTA 200-230 | CACHE MOYEU | RADDECKUNG | HUB CAP | TAPA RUEDA | | 2 |
| 108 | CP052225 | INNESTO RAPIDO | RACCORD DE L'EAU | SPUELDUESE | WATER CONNECTOR | ENLACE | 1 | 1 |
| 114 | CP052216 | SUPPORTO LEVA FRE | SUPPORT | AUFNAHMEBÜGEL | SUPPORT | SOPORTE | 1 | 1 |
| 115 | CP052217 | SUPPORTO LEVA FRE | SUPPORT | AUFNAHMEBÜGEL | SUPPORT | SOPORTE | 1 | 1 |
| 116 | CP052218 | SUPPORTO LEVA SEM | SUPPORT | AUFNAHMEBÜGEL | SUPPORT | SOPORTE | 1 | 1 |
| 117 | CP052219 | SUPPORTO LEVA SEM | SUPPORT | AUFNAHMEBÜGEL | SUPPORT | SOPORTE | 1 | 1 |
| 118 | CP052220 | SUPPORTO PER SUPP | SUPPORT | AUFNAHMEBÜGEL | SUPPORT | SOPORTE | 2 | 2 |
| 119 | CP057252 | MANIGLIA | POIGNEE | GRIFF | HANDLE | MANGO | 1 | 1 |
| 120 | CP052105 | CUPOLINA NERA | CALOTTE | VERKLEIDUNG | COVER | CARCASA | Honda GCV | |
| 120 | CP052105.02 | CUPOLINA ROSSA | CALOTTE | VERKLEIDUNG | COVER | CARCASA | | Honda GCV |
| 121 | CP024216 | VITE | VIS | SCHRAUBE | SCREW | TORNILLO | 3 Honda GCV | |
| 122 | CP057250 | COMANDO CAMBIO | MANETTE | STANGE | LEVER | LEVA | 1 | 1 |
| 123 | CP057154 | CAVO CAMBIO DX | CABLE | KABEL | CABLE | CABLE | 1 | 1 |
| 125 | CP037406 | CHIAVETTA | CLAVETTE | SCHLÜSSELCHEN | WOODRUFF KEY | CHAVETA | 1 - Honda GXV 160 | |