

# Service Schematic

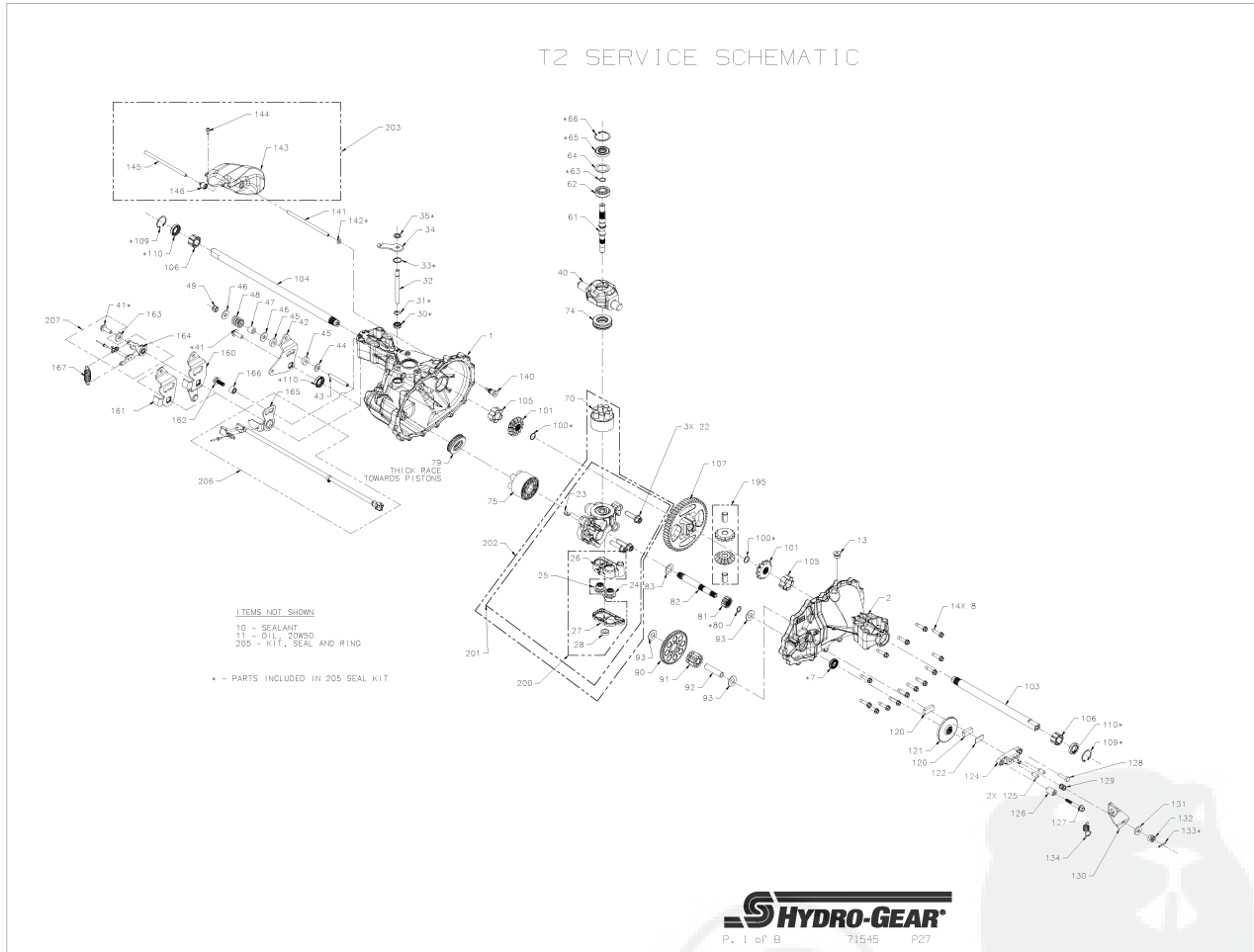

## Service Schematic

#	PART #	DESCRIPTION	QTY	Note
1	71546	KIT, MAIN HOUSING	1	
2	71547	KIT, SIDE HOUSING	1	
7	52820	SEAL .50 X 1.00 X .25 TC LIP	1	
8	51190	SCREW, HEX FLANGE 1/4-20 X 1.25	14	
10	50928	SEALANT TUBE	1	
11		OIL, 20W50	69.3oz	
13	9005110-5600	PLUG 9/16-18 METAL	1	
22	52137	SCREW 3/8-16 X 1.50 HFH	3	
23	54738	PLATE, BYPASS	1	
24	51084	CHK PLUG ASSY/WASHER,.027"	1	
25	51084	CHK PLUG ASSY/WASHER,.027"	1	
30	51626	SEAL .375 X .75 X .25 LIP	1	
31	51628	RING RET 37 EXT KLIPRING	1	
32	52459	ROD BYPASS .375 X 3.81	1	
33	51627	RING RET 75 INT	1	
34	52460	ARM, BYPASS	1	
35	51630	RING RET 37 EXT PUSH	1	
40	52450	SWASHPLATE TRUNNION	1	
41	51812	SCREW 5/16-24 X 1.00 TWHCS PATCH	1	
61	52462	SHAFT INPUT	1	
62	2003043	BEARING 15X35X11 BALL OPEN 6202	1	
63	2003016	RING RET 59 EXT WIRE	1	
64	2003018	WASHER .98 X 1.37 X .04	1	
65	9008000-0128	SEAL 15 X 35 X 7 LIP PTC	1	
66	2003052	RING RET 137 INT	1	
70	72228	KIT, BLOCK, 7 PISTON, 8CC	1	
74	52465	BEARING 28X47X14 BALL THRUST	1	
75	70331	KIT, BLOCK, 10CC CYLINDER	1	
79	50551	BEARING 30X52X13 BALL THRUST	1	
80	44354	RING RET 50 EXT	1	
81	52466	GEAR, 13T	1	
82	52467	SHAFT MOTOR	1	
83	52468	WASHER .60 X 1.00 X .03 FLAT	1	
90	52469	GEAR, 48T/11T	1	
91	52470	GEAR, 11T	1	
92	52471	PIN JACKSHAFT	1	
93	50132	WASHER .51 X 1.10 X .03 FLAT	3	
100	44871	RING RET 62 EXT SPIRAL	2	
101	51769	GEAR, MITER 12T (SPLINED)	2	
103	53507	SHAFT .75 X 11.39 (RH) AXLE KEY	1	
104	53506	SHAFT .75 X 16.99 (LH) AXLE KEY	1	
105	52280	BUSHING, AXLE INBOARD	2	
106	52278	BUSHING, AXLE OUTBOARD	2	
109	52275	RING RET 112 INT	2	
110	53901	SEAL .75 X 1.125 X .25 LIP	3	
120	44132	PUCK, BRAKE	2	

## Service Schematic

#	PART #	DESCRIPTION	QTY	Note
121	52473	ROTOR, BRAKE	1	
122	44134	PLATE, PUCK	1	
124	62589	KIT, BRAKE YOKE	1	
125	44127	PIN BRAKE .31 X .73 PLATED	2	
126	23711	SPACER .26X.57X.87	1	
127	51146	BOLT 1/4-20 X 2 W/ PATCH SPECIAL FLANGE	1	
128	44433	SCREW 1/4-20 X 1 HH W/PATCH	1	
129	50919	SPRING COMP .48 X .50	1	
130	52374	ARM, BRAKE	1	
131	44130	WASHER .34 X .88 X .06	1	
132	44142	CASTLE NUT, 5/16-24	1	
133	44101	PIN 3/32 X 3/4 COTTER	1	
134	51529	SPRING EXT .53 X 1.55	1	
140	51143	FITTING 5/16 SAE, 5/32 TUBE	1	
141	52474	TUBE .16 X .28 X 5.5	1	
142	51144	O-RING -109 .103 X .299	1	
161	52478	ARM, CONTROL RTN	1	
162	51064	BOLT 5/16-24 X .94 HF (PATCH)	1	
163	44130	WASHER .34 X .88 X .06	1	
164	52611	ASSEMBLY, RTN BI-DIRECTIONAL	1	
165	52618	ARM, NEUTRAL ASSEMBLY	1	
166	52481	BUSHING .330 X .618 X .405	1	
167	52401	SPRING EXT .63 X 2.05	1	
180	53319	SPRING CLIP HOUSING THRUST	2	
195	72314	KIT MITER GEAR PINS	1	
200	71553	KIT, FILTER	1	
201	72497	KIT, CENTERSECTION WITH FILTER	1	
203	71549	KIT, EXPANSION TANK	1	
205	71554	KIT, SEAL	1	

# Fans, Pulleys, and Fan & Pulley Kits

## T2 SERVICE SCHEMATIC

MODEL NUMBER: 

1	2
3	4

 : 

5	6
7	8

 : 

9	10
11	12

 : 

13	14
15	16

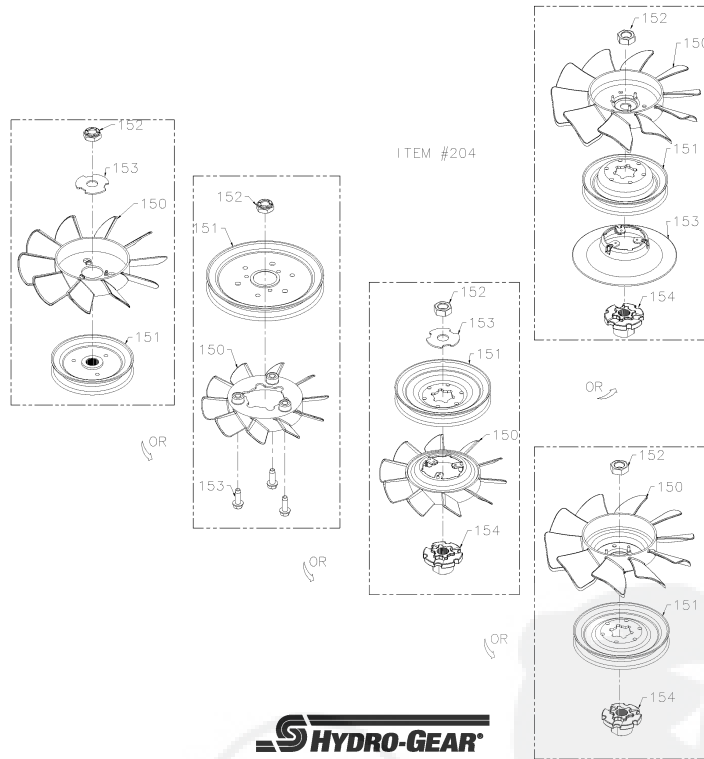

**HYDRO-GEAR**  
P. 7 of 8 71545 P27

## Fans, Pulleys, and Fan &amp; Pulley Kits

#	PART #	DESCRIPTION	QTY	Note
150	53822	FAN, 7.0" (10 BLADE) W/INSERT	1	
151	53804	DISC, PULLEY CUPPED, 4.5 INCH	1	
152	44133	NUT 1/2-20 HEX JAM W/ PATCH	1	
153	53812	HUB, PULLEY	1	
204	72131	KIT, FAN/PULLEY	1	

