

# REPAIR PARTS

GIANT-TILLER MODEL NO. D84351R1  
TRANSAXLE

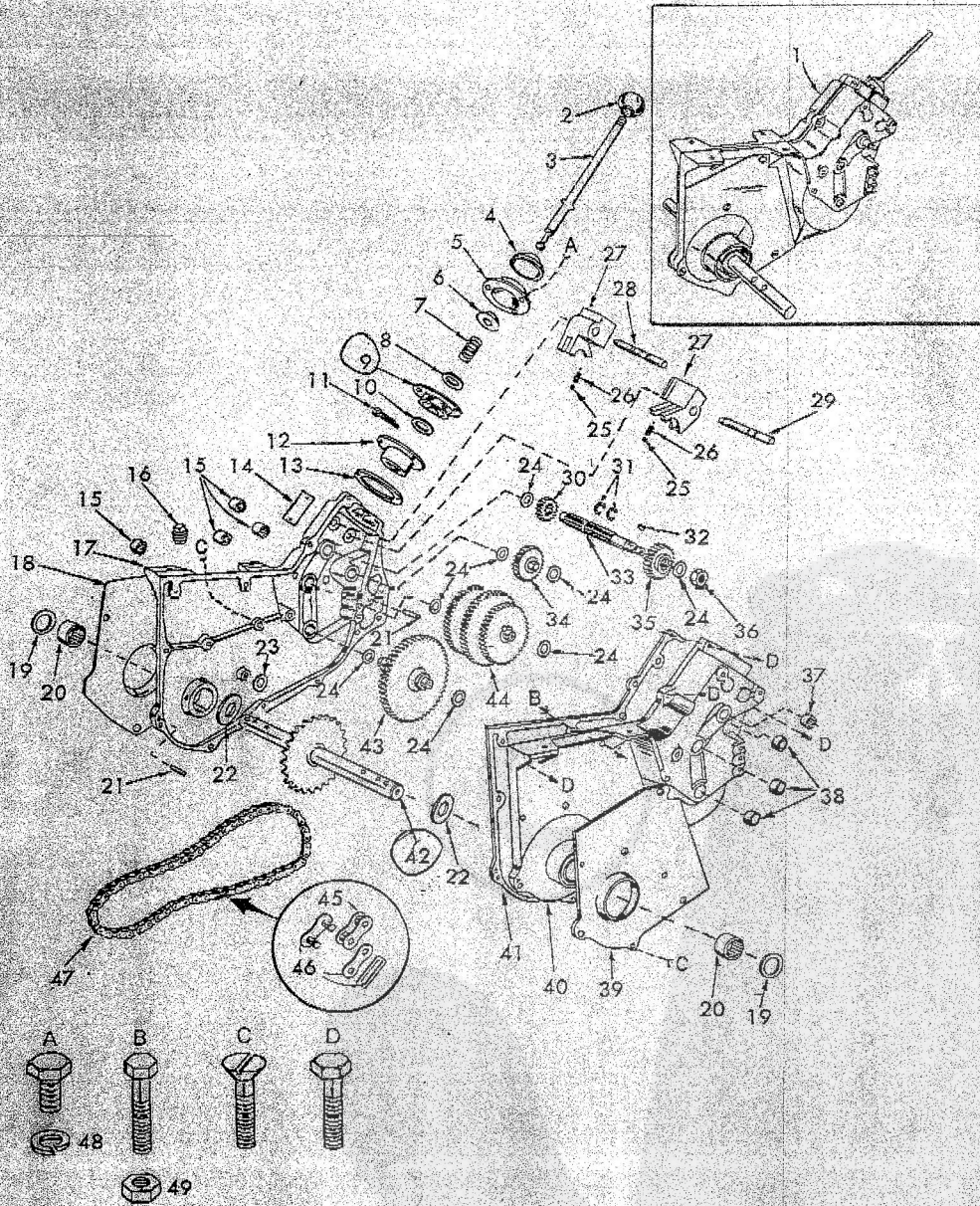



## REPAIR PARTS

GIANT-TILLER MODEL NO. D84351R1

KEY NO.	PART NO.	DESCRIPTION
1	624A58	Transmission (includes Bell Crank) Key No. 18 Page 11
2	6364H	Control Knob
3	6213H1	Gear Shift Lever
4	4869H1	Shift Lever Cap
5	4871H	Gear Shift Cover
6	6259H	Shift Lever Guide Ball
7	4924H	Spring
8	1544P	Washer 15/32 x 59/64 x 16 Ga.
9	3139R	Shift Mechanism Seal
10	1569P	Washer 9/16 x 15/16 x 11 Ga.
11	2505P	Cotter Pin 1/8 x 3/4
12	624A36	Shift Lever Gate and Reinforcement
13	4913H	Gasket
14		Model Plate
15	4895H	Needle Bearing
16	4002P	Pipe Plug 1/2-14 N.P.T.
17	624A57	Gear Case and Bearings-R.H. (Includes Key No. 15, 20 and 22)
18	4878H1	Gear Case Shield R.H.
19	4910H	Oil Seal
20	4896H	Needle Bearing
21	9880M	Dowel Pin
22	4870H	Thrust Cap
23	4912H	Gasket
24	1370H	Thrust Bearing Race
25	8127M	Steel Ball
26	4923H	Detent Spring
27	3149R	Shift Lever Yoke
28	4838H	Shift Block Guide (3 Grooves)
29	4839H	Shift Block Guide (2 Grooves)
30	3140R	Low Speed Pinion
31	4926H	Snap Ring
32	9858M1	Woodruff Key 3/16 x 5/8
33	4841H1	Input Shaft
34	624A42	Reverse Idler and Shaft
35	3142R	High Speed Pinion
36	9204H	Locknut 1/2-20
37	3136R	Needle Bearing
38	4895H1	Needle Bearing
39	4877H1	Gear Case Shield L.H.
40	624A56	Gear Case and Bearings L.H. (Includes Key No. 15, 20 and 22)
41	2601R	Gasket
42	624A73	Time Shaft and Sprocket
43	624A3	3rd Reduction Shaft and Gears
44	624A41	2nd Reduction Shaft and Gears
45	4950H	Roller Link
46	4949H	Connecting Link
47	2600R	Roller Chain ASA No. 50
48	1003P	Lockwasher 5/16
49	504P	Hex Nut 5/16-18
A	3010P	Hex Hd. Mach. Screw 5/16-18 x 3/4
B	3015P	Hex Bolt 5/16-18 x 2
C	5585P	Slotted Flat Hd. Roll Lok Thread Forming Screw 5/16-18 x 1 1/2
D	5586P	Hex Hd. Roll Lok Thread Forming Screw 5/16-18 x 1 1/2
---	7041R	Owners Manual