

# REPAIR PARTS

## ROTARY LAWN MOWER -- MODEL NO. RE2A271H

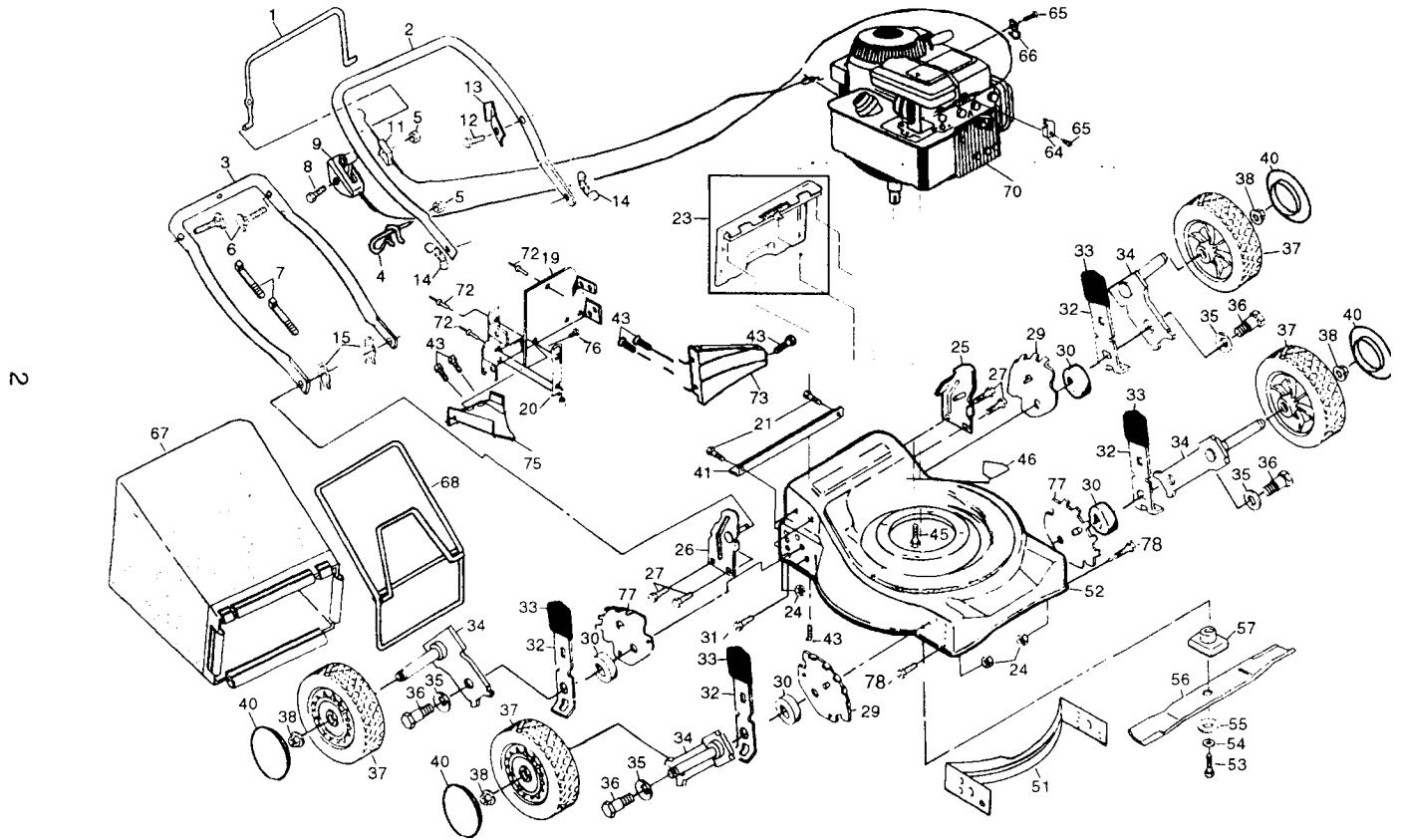

# REPAIR PARTS

## ROTARY LAWN MOWER -- MODEL NO. RE2A271H

KEY PART NO. NO.	DESCRIPTION	KEY PART NO. NO.	DESCRIPTION
1	86902 Control Bar	36	142748 Shoulder Bolt 3/8-16
2	<b>165452X479</b> Upper Handle	37	148438 Wheel Assembly
3	157081X479 Lower Handle	38	83923 Washer
4	132001 Rope Guide	40	77400 Hubcap
5	63601 Locknut 1/4-20	41	146143X479 Foot Guard
6	131959 Handle Bolt	43	54583 Hex Tapping Screw 1/4-20 x 1/2
7	66426 Wire Ties	45	150406 Hex Head Thread Rolling Screw 3/8-16 x 2
8	158755 Hex Washer Head Screw 1/4-20 x 2-1/8	46	145494 Danger Decal
9	851462 Throttle Control	51	<b>170635</b> Front Baffle Kit
11	130861 Engine Zone Control Cable	52	<b>170658</b> Housing Assembly (Incl. Ref. #46)
12	750097 Hex Washer Head Screw #10-24 x 1/2	53	851084 Hex Head Screw 3/8-24 x 1-3/8 Grd. 8
13	850733X004 Up-Stop Bracket	54	850263 Helical Lock Washer
14	128638 Wing Nut	55	851074 Hardened Washer
15	51793 Hairpin Cotter	56	850792 20" Blade
19	156445X479 Back Plate	57	850977 Blade Adapter
20	700363X479 Side Baffle	65	83816 Screw #10 x 5/8
21	146694 Screw	64	213146 Cable Clamp
23	147613 Rear Door Assembly Kit	66	87930 Cable Clamp
24	751592 Locknut 3/8-16	67	149619 Grass Bag
25	151589X479 Handle Bracket Assembly (Left)	68	149555 Catcher Frame
26	151588X479 Handle Bracket Assembly (Right)	70	----- Engine - Briggs/Stratton Model No. 98902
27	150078 Screw 5/16-18 x 3/4		Order parts from engine manufacturer
29	134340 Wheel Adjusting Bracket (LR/RF)	72	128415 Pop Rivet
30	146630 Spacer	73	<b>169207X479</b> Rear Baffle
31	88652 Hinge Screw	75	133188X479 Discharge Baffle
32	850862X004 Selector Spring	76	150050 Screw
33	87877 Selector Knob	77	134341 Wheel Adjusting Bracket (LF/RR)
34	145937X004 Axle Arm Assembly	78	<b>17600406</b> Screw
35	62335 Belleville Washer	--	<b>173534</b> Operator's Manual (Euro.)
		--	<b>173535</b> Operator's Manual (Scand.)
		--	<b>172279</b> Replacement Parts Manual