

Your complimentary use period has ended. Thank you for using PDF Complete.

Click Here to upgrade to Unlimited Pages and Expanded Features

**About the Company**  
For generations, Brinly-Hardy has been serving the growing needs of farmers, gardeners, lawn professionals and homeowners. Our first mower was introduced in 1899, and ever since, we have been forging a tradition in the production of quality-crafted lawn, farm, and garden tools. It's a proud heritage one you can trust in caring for your lawn.

**Our Quality Products**

**Aerators**

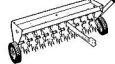

Our Spike Aerators allow seed, fertilizer, etc. and water to reach the lawn's root system, where they do the most good. This means fewer chemical applications and less frequent watering.

Our Plug-type Aerators are designed for the lawn care enthusiast who demands the ultimate in turf aerator performance.



It's actually "pull" plugs of soil to remove soil compaction and deposits them on top of the lawn where they'll quickly break down. You, too, can have a healthy looking lawn, once only affordable to golf courses!

You can actually handle two jobs at once with our Airflow-Spreader! The annual combination allows the 30" Aerator to perforate the soil, and the spreader immediately follows with seed, lime, or fertilizer - putting it INTO the ground so it'll be needed soon!



**Broadcast Spreaders**



Our Rotary Spreaders handle everything from seed to ice-melters. Equipped with Adjustable™, the material flows right and stays where the rider desires. No need to worry about "blow" or "bridging" on the lawn. Our gears are fully enclosed, so they'll last and last!

Our larger 2.5 and 3.5 cu. ft. Spreaders offer a unique, Directional Spread Pattern Control that lets you CHOOSE your spread pattern; adjust it to spread to either side or to center. Also, a clear, vinyl cover is included to protect material from moisture.



If left alone, matted leaves and large grass clippings can form on your lawn which prevents air circulation and breeds disease. Our patented design De-thatcher with spring steel tines gently comb thatch and clippings to the surface where they can be re-mulched, collected, or left exposed to the elements to break down.

**Carts**



Our Dumping Utility Carts have a patented, rounded corner design which prevents soil, gravel, mulch, sand, etc. from getting trapped along the edges (where they can cause rust), and the truck-like, removable tailgate has NO obstructions to catch material when dumping. These carts are built to last with our solid steel axles, heavy steel hubs, and our state-of-the-art powder coated paint finish.

**Sweepers**



A Brinly-Hardy Sweeper is sure to make your outside chores much easier! Forget the brooms and rakes, you can quickly sweep up grass clippings, leaves, and even debris from the pavement and quickly dump them into compost bins or bags. The spring-loaded Compost Clip makes it a snap!

For even more versatility, attach our new De-thatcher Kit to either our 30" or 36" Sweeper, and tackle two jobs at once!

These sweepers are built for all seasons and will last for years and years.

L-1411-I

SINCE 1899  
**BRINLY**  
**OWNER'S MANUAL**



DT-30 BH  
DE-THATCHER  
**MODEL DT300**

**IMPORTANT: THIS MANUAL CONTAINS INFORMATION FOR THE SAFETY OF PERSONS AND PROPERTY. READ IT CAREFULLY BEFORE ASSEMBLY AND OPERATION OF THE EQUIPMENT!**

**LIMITED WARRANTY**

Brinly-Hardy Company warrants only to the original retail purchaser that this product will remain free of defects in workmanship and materials under normal use and service for a period of two (2) years (NOTE: ninety (90) days for commercial or rental use) commencing with the date of purchase.

Any parts found to be defective within the warranty period will be replaced, with proof of date of purchase, at Brinly-Hardy Company's expense. Our obligation under this warranty is expressly limited to replacement or repair, at our option of parts which are defective in material or workmanship within thirty (30) days of receipt of the parts. This warranty does not apply to damage caused by unreasonable use, including failure to provide necessary maintenance, nor does it apply to any transportation or labor charges.

**WE MAKE NO OTHER EXPRESS WARRANTY NOR IS ANYONE AUTHORIZED TO MAKE ANY ON OUR BEHALF. ANY IMPLIED OR STATUTORY WARRANTIES, INCLUDING ANY WARRANTY OF MERCHANTABILITY OR FITNESS FOR A PARTICULAR PURPOSE, ARE LIMITED TO THE DURATION OF THIS WRITTEN WARRANTY. WE SHALL NOT BE LIABLE FOR CONSEQUENTIAL OR INCIDENTAL DAMAGES OF ANY KIND.**

BRINLY-HARDY COMPANY (877) 728-8224 **MADE IN U.S.A.**

**INTRODUCTION**

The regular removal of thatch is critical to the maintenance of a healthy lawn. The de-thatcher will effectively dislodge excessive thatch from your lawn. Thatch is a layer of stems, clippings, runners, roots, and leaves that have not decayed. Excessive thatch prevents air, water and fertilizer from reaching the roots.

The de-thatcher is recommended for use with riders, and lawn/garden tractors.

Fold out the carton and lay on a flat surface for use as a pad during assembly.

**NOTE:** Before starting assembly, arrange each kind of hardware into a group to ease assembly.

**NOTE:** It is recommended that you carefully read this Owner's Manual BEFORE starting assembly.

**Warranty Registration Card**  
Please complete the Warranty Registration Card, place in an envelope and mail to us so that we will have a record of your purchase and your comments.

**BRINLY-HARDY COMPANY**  
P.O. BOX 18  
JEFFERSONVILLE, IN 47131-0018

REF. NO.	PART NO.	DESCRIPTION	QTY.
2	8-6922	Decal, Logo	1
3	R-825	Gauge Wheel	2
7	R-837	5/16" Wing Nut	2
9	R-653	Thatching tine	8
10	R-874	Safety wire	2
11	R-820-10	Drawer	1
12	R-821-10	Clevis	1
14	R-1541	Decal, Warning	1
16	R-832	Special carriage bolt, 5/16" x 3"	2
17	R-1545-10	Time Tray	1
18	1M164P	1/2" x 3" Hex Bolt	2
21	20M1012P	5/16" x 3/4" Round Head Screw	2
23	30M100P	3/8" Hex Nut	2
24	30M160P	1/2" Hex Nut	2
25	40M100P	5/16" Lock Washer	4
26	40M160P	1/2" Lock Washer	2
27	45M111P	5/16" Plain Washer	2
28	45M112P	1/2" Plain Washer	8
29	31M160P	Hex Jam Nut, 1/2"	2

- TOOLS REQUIRED FOR ASSEMBLY:**
- 1 - hammer
  - 1 - screwdriver (Flat Blade)
  - 1 - pair of pliers (8-in. pair recommended)
  - 1 - 1/2" wrench
  - 1 - 3/4" wrench
  - 1 - adjustable wrench
  - 1 - adjustable wrenches

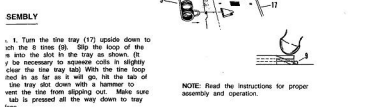

**SEMI**

1. Turn the time tray (17) upside down to set the time (8) into the slot in the tray as shown. If it is necessary to remove either (8) or (17) clear the time tray tab. With the time tray held in its set position, set the top of the time tray slot down with a hammer to set the time from slipping out. Make sure the time tray is pressed all the way down to lock.

2. Thread each safety wire (10) right through the time tray and each wire ends with plastic sleeves (11) tightly. A. Be sure each wire is bare safety wire at the straight portion of safety wire.

**E. FAILURE TO INSTALL THE SAFETY WIRES WILL RESULT IN PERSONAL INJURY IF A THEILD DISSENABLE FROM THE TRAY!**

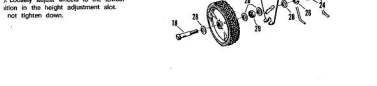

3. Attach each of the wheels to the axle as shown. B. Use the 1/2" x 3" hex head bolts (18), 1/2" x 3/4" washers (23), 1/2" x 3/4" hex-nuts (24), and 1/2" x 3/4" lock washers (25). Loosely adjust wheels to the lowest slot in the height adjustment slot on the axle.

**FIG. 4. Turn de-thatcher right side up.**  
Loosely attach the decal (1) to the time tray (17), using two 5/16" x 3/4" special carriage bolts (16), 5/16" flat washers (27), 5/16" lock washers (25) and 5/16" wing nut (7).

Next attach the clevis bracket (12) to the drawer (11) as shown using two 5/16" x 3/4" round head screws (21), 5/16" flat washers (23) and 5/16" hex nuts (23). Tighten securely.

**MOUNTING AND ADJUSTMENT**

**LEVELING ADJUSTMENT**  
Select a smooth, flat level surface such as a sidewalk, garage floor, driveway, etc. Attach the de-thatcher to the tractor chassis. With both wheels in the lowest position in the height adjustment slot, level the time tray by loosening and tightening (as required) the two wing nuts on the drawer.

**HEIGHT ADJUSTMENT**  
Next, loosen the 1/2" hex bolts on the wheels to adjust the height. Move the wheels up or down in size of the wheel mounting bracket until the time tray (17) sits flat on the surface when in free position and touch the flat surface when manually deflated. Tighten all nuts securely.

**OPERATION**

**CAUTION!** When backing - carefully back to engage to avoid jackknifing, which could result in damage to equipment.

The de-thatcher will quickly clean lawns of excessive thatch and allow the grass to grow. De-thatching can be done in a single independent operation or in conjunction with other lawn care tasks. For best results, use a "V"-cross-hatch pattern on the lawn. The key to good performance with the de-thatcher is the "tipping" action of the tines.

Most lawn conditions will not require extra weights on the tray. In some cases, concrete "yank blocks" may be needed. **NOTE:** Yank blocks are recommended for weight because of their low profile. However, any type of weight is suitable if it can be fastened to the time tray. If the de-thatcher appears to be "walking" or

L-1411-I

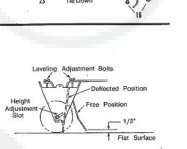
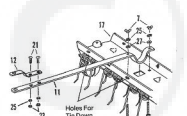

**MAINTENANCE**  
The de-thatcher is essentially maintenance-free. However, as with any steel product, it can rust.

In the case of commercial or frequent use, one of the slots may have to be replaced. A screw driver may be used to pry up the tab on the tab may be tapped down from the top wire to release the time.

To prevent or eliminate rust on tines, apply a light coat of oil. For rust appearing on tray or mounting brackets, just sand lightly and use wire enamel. Always store in a dry area.

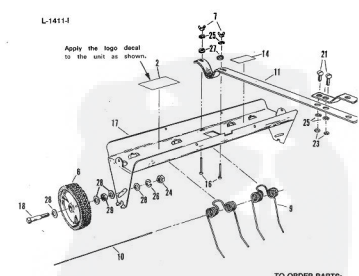

**TO ORDER PARTS:**  
BRINLY-HARDY COMPANY  
P.O. BOX 18  
JEFFERSONVILLE, IN.  
47131-0018  
(877) 728-8224

**Quality Insurance**

Dear Customer, We are very proud of our quality and endeavor to produce each product to meet high standards. Should your purchase not meet your expectations, we have a Quality Insurance Policy.

If you purchase a product and a part is missing or defective, please return it to the dealer or to the factory. Complete the Warranty Registration Card below, and mail the card to us or, you may call us toll free at (877) 728-8224.

We will make every effort to ship a new replacement part to you within 24 hours at no charge.

Thank you,  
*John*  
President  
Brinly-Hardy Company

**WARRANTY REGISTRATION CARD**

To register your new product for warranty, please complete and return this card Name: \_\_\_\_\_ Phone: \_\_\_\_\_

Address: \_\_\_\_\_ State: \_\_\_\_\_ Zip: \_\_\_\_\_ Country: \_\_\_\_\_

Product Purchased: \_\_\_\_\_ Model No.: \_\_\_\_\_

Packing No. (On Carton): \_\_\_\_\_ Date Purchased: \_\_\_\_\_

Where Purchased: \_\_\_\_\_ Date Purchased: \_\_\_\_\_

Type of tractor/rider owned? Make: \_\_\_\_\_ Model: \_\_\_\_\_ HP: \_\_\_\_\_

Size of Lawn?  1/4 to 1/2 acre  1 to 5 acres  over 5 acres

Do you garden?  yes  no Use tractor?  tiller?

Your occupation: \_\_\_\_\_

**YOUR COMMENTS WILL BE APPRECIATED:**

\_\_\_\_\_

\_\_\_\_\_

\_\_\_\_\_